

Showing  
 Land sought to be condemned  
 for the widening of  
 Thomas Street  
 between  
 Barbee Street and Alhambra Avenue.  
 City of Los Angeles

45846  
 THE CITY OF LOS ANGELES  
 vs  
 ALBERT TIFFANY LEONARD et al  
 Filed Mar 21-06

Harry F. Stafford, City Engineer

October 1904

EXHIBIT C

Jan 7  
 2 6 7  
 11-1

Found For Plaintiff

Index #8

Map Approved  
 Harry F. Stafford  
 City Engineer

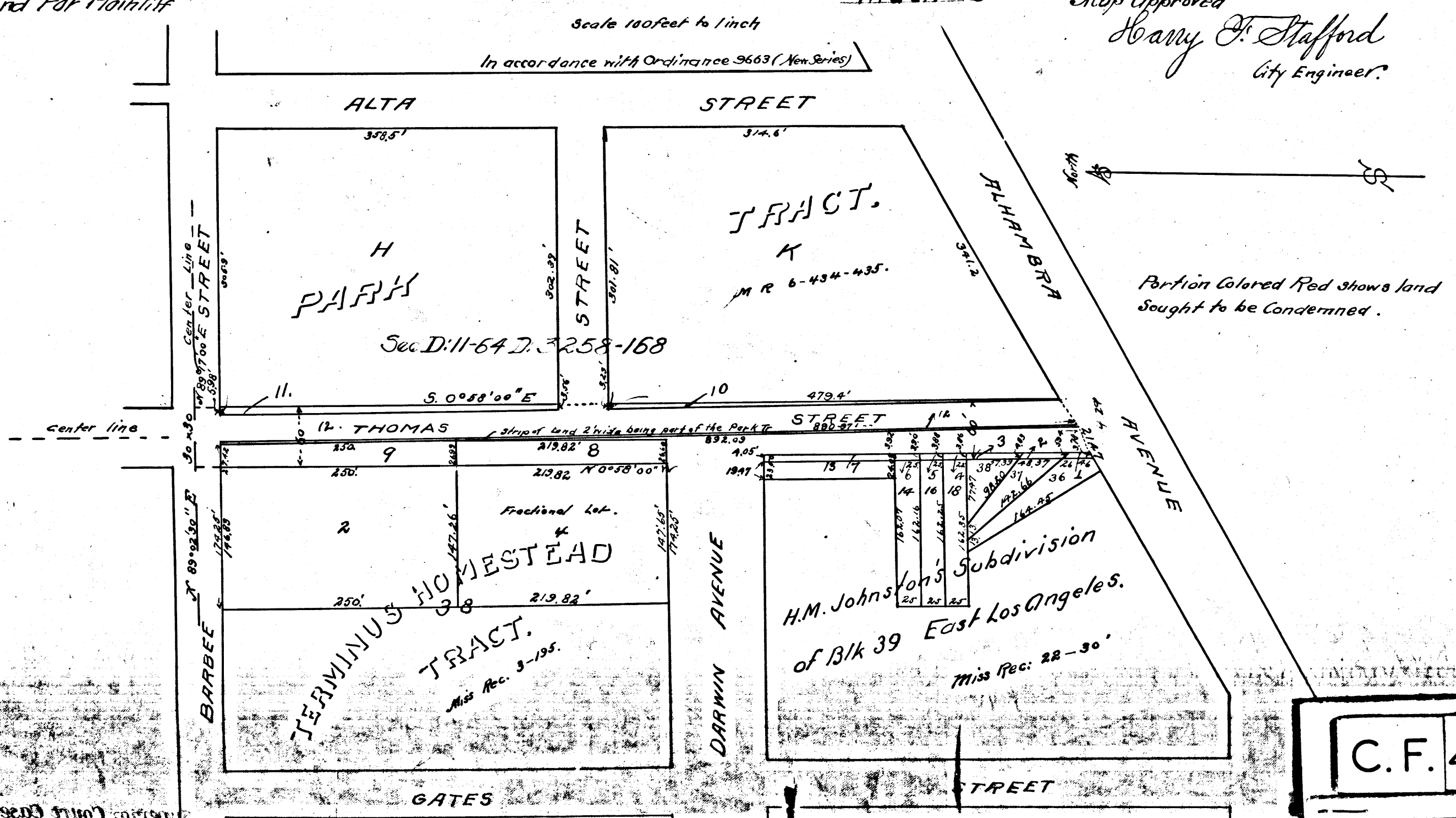

C.F. 418

