

City of Los Angeles vs. Martin C. Marsh et al.
Filed Jan. 6th 1906

MAP
Showing Land Sought to be condemned for the Widening
OF
BEAUDRY AVENUE

From the most southerly corner of Lot 6 Block 16 of the Park Tract
as per map recorded in Book 7 pages 26 and 27. Miscellaneous
Records of Los Angeles County, to the northerly line of First Street
in the
CITY OF LOS ANGELES CAL.
Under Ordinance Number 10255 (New Series)
Scale; 1 inch = 50 Feet.
Harry F. Stafford, City Engineer. April, 5th 1905

Note: Portion colored red indicates
land to be condemned.

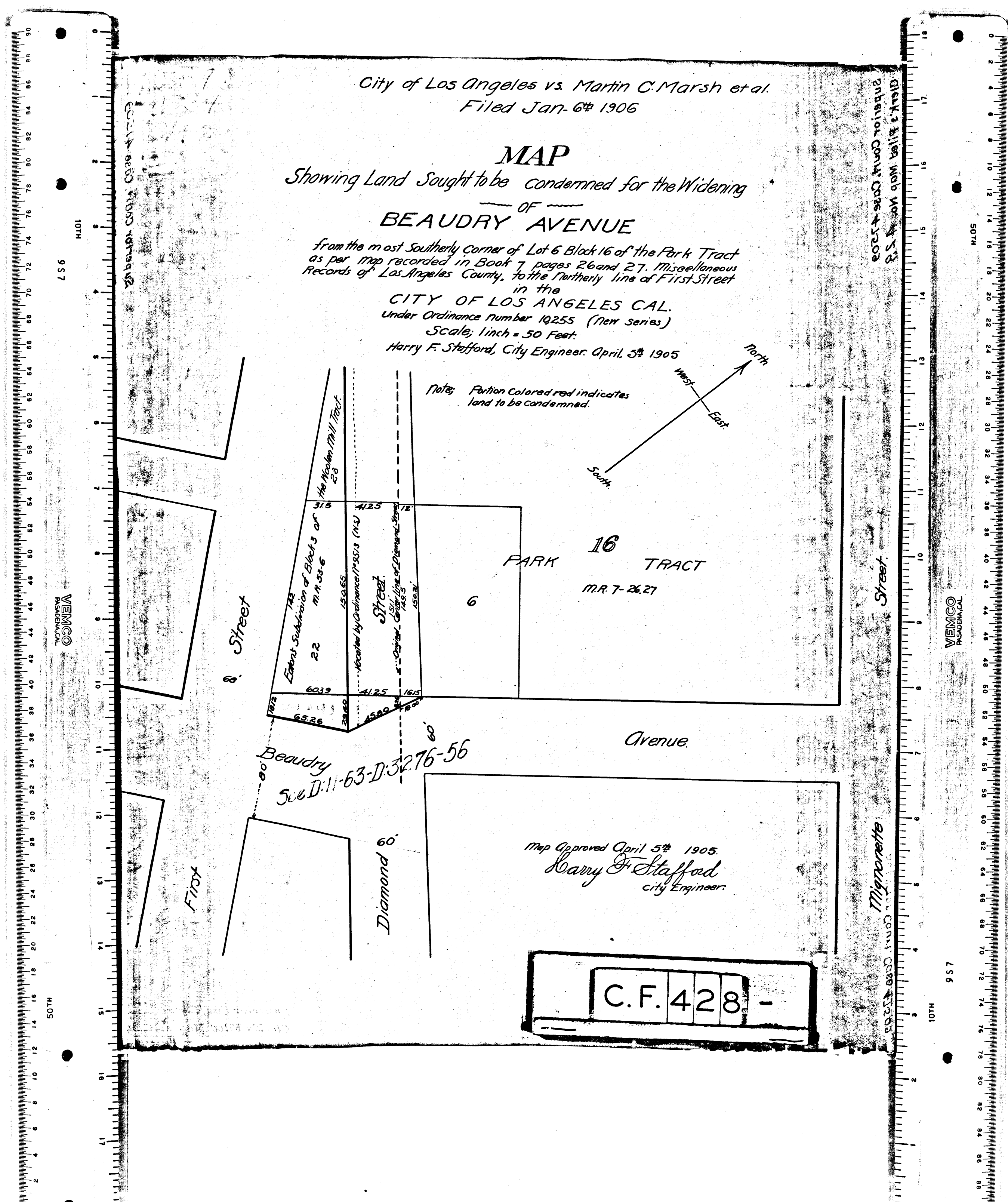
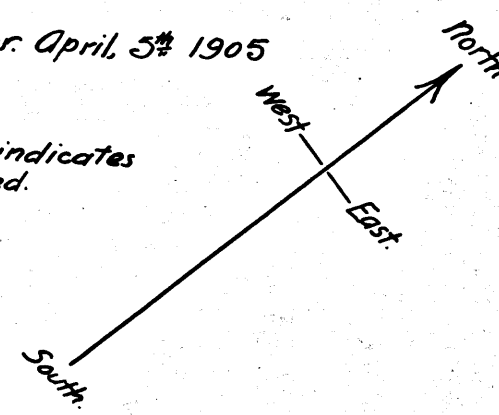

C.F. 428 -