

CITY OF LOS ANGELES
vs.
I. H. Preston et al.

Filed Apr 27-05
See D. 3170-1692/11-30

EXHIBIT C

MAP

Showing Land Sought to be Condemned for the Opening and Widening of
IMOGEN AVENUE
from the westerly line of Sunset Boulevard to the northerly line of Belvedere Street

in the
CITY OF LOS ANGELES CAL
Under Ordinance Number 19162 2nd Series
Scale: 1 inch = 100 feet
Harry F. Stafford, City Engineer, April 21st 1905.

Note: portion colored red indicates land to be condemned

Map approved April 22-1905
Harry F. Stafford
City Engineer

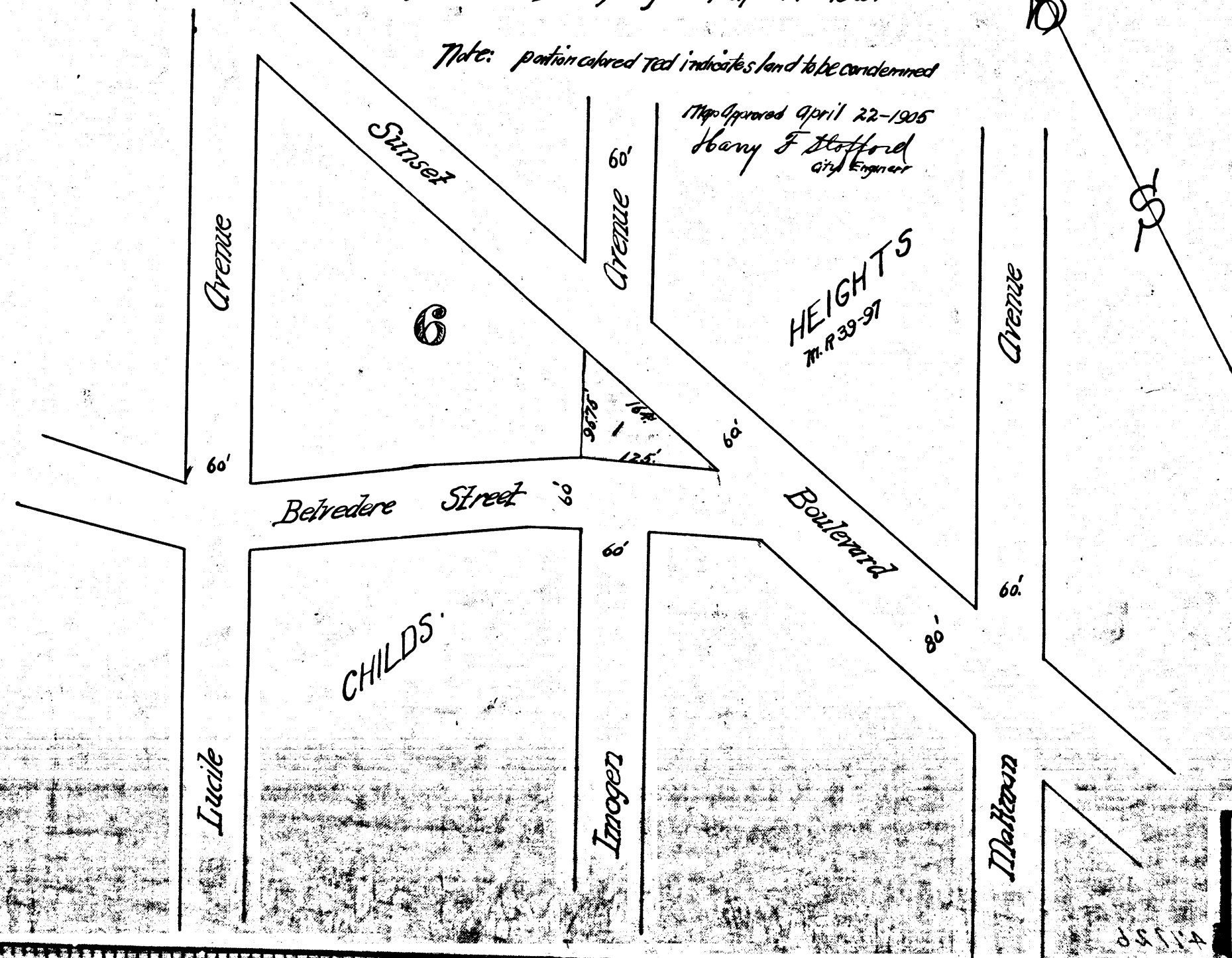

AD 34
D 38
S 42

C.F. 429 -