

# MAP

Showing land sought to be condemned for the opening of  
**FORTY-THIRD STREET**

BETWEEN  
Central Avenue and Hooper Avenue

in the  
**City of Los Angeles Cal.**

Under Ordinance No 11568 (New Series)

Harry F. Stafford - City Engineer - Jan. 13<sup>th</sup> 1906

Map approved Jan 13<sup>th</sup> 1906

*Harry F. Stafford*  
City Engineer

Note: Portion colored red indicates land to be condemned  
43<sup>rd</sup> St. chg. to 43<sup>rd</sup> Pl. - Ord. 78063, Sec. 12.  
Scale: 1" = 100'

Sht. 7

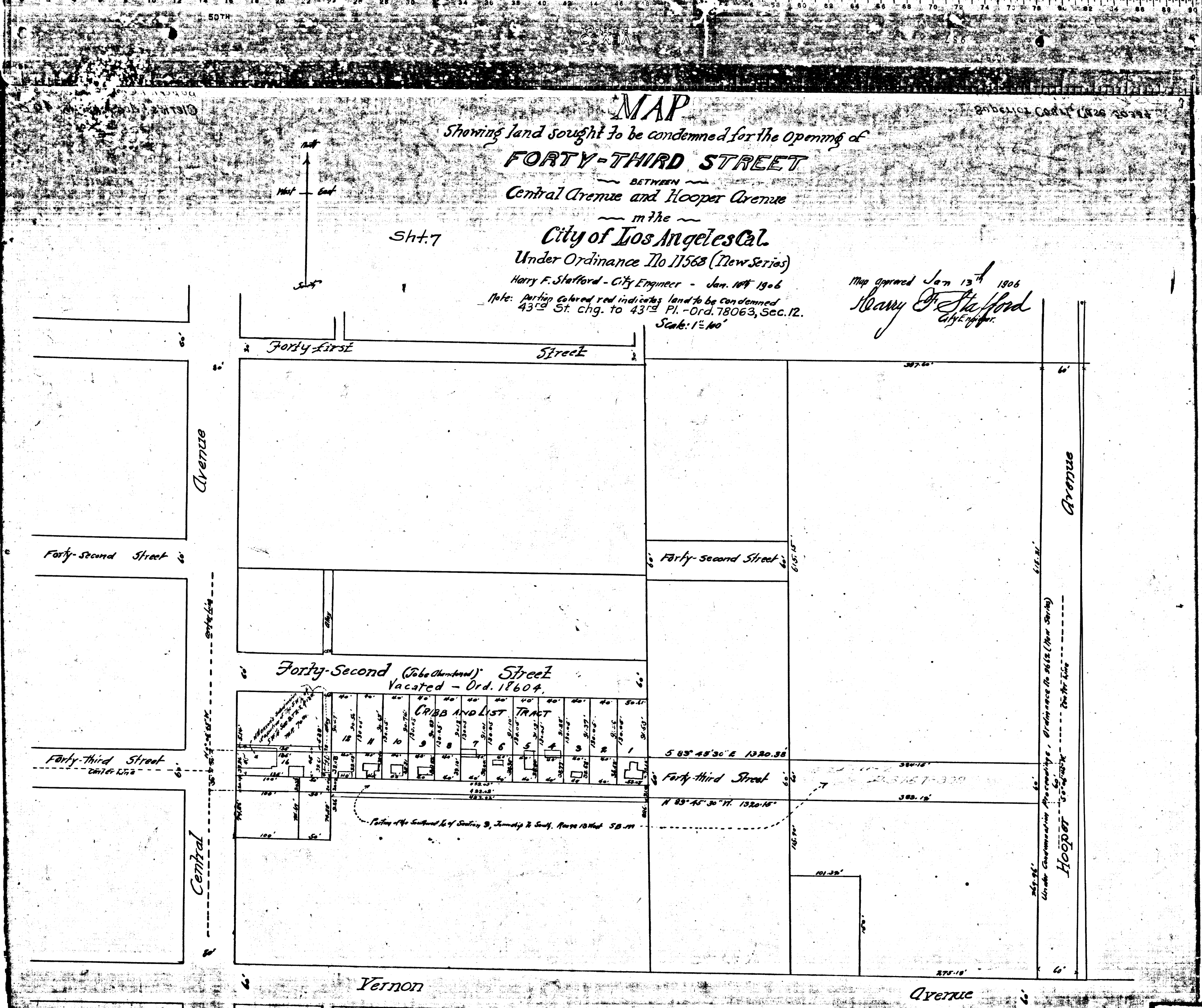

No 50334  
City of Los Angeles, a corporation.  
Newton B. Evans, et al.

C.F. 458