



EXHIBIT C

MAP
 SHOWING LAND
 TO BE CONDEMNED
 FOR THE OPENING OF
THIRTY-EIGHTH PLACE
 BETWEEN
VAN NESS AVENUE
 AND
THE WESTERLY BOUNDARY LINE
OF THE CITY OF LOS ANGELES

IN THE CITY OF LOS ANGELES, CALIF.
 In accordance with Ordinances Nos 32825, 33125 (New Series).
 Homer Hamlin, City Engineer, October 1915
 Scale 1 inch = 40 feet

B 31203

Note: Land to be condemned shown colored red

City of Los Angeles - Plaintiff
 vs
 Harry Runnells, et al

Case No. 10000 Pending - Sept 1, 1915

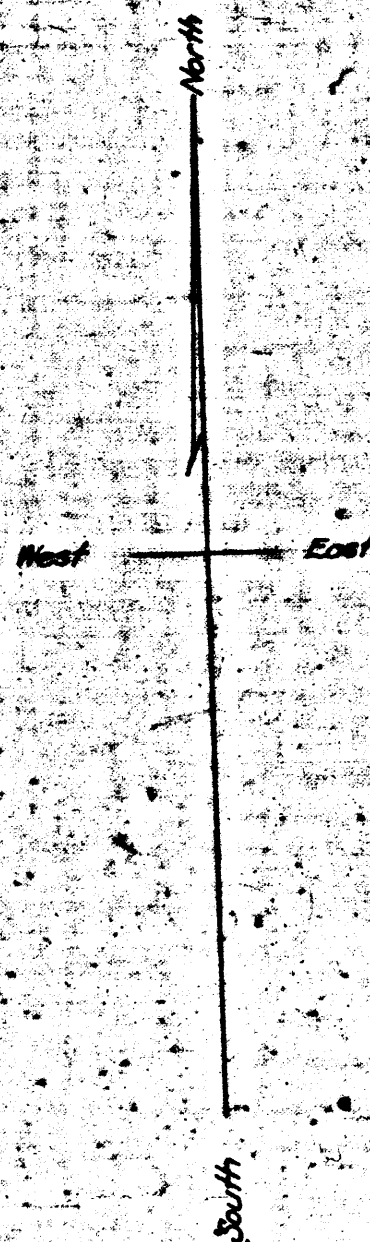

R.S.G.

H.V.H.

