

O.S.W. ONYX DR. 299' E. TO 411' E. OF WLY. TERM. ED.
FILE NO. 7312-28
CHARGE NO. 80069

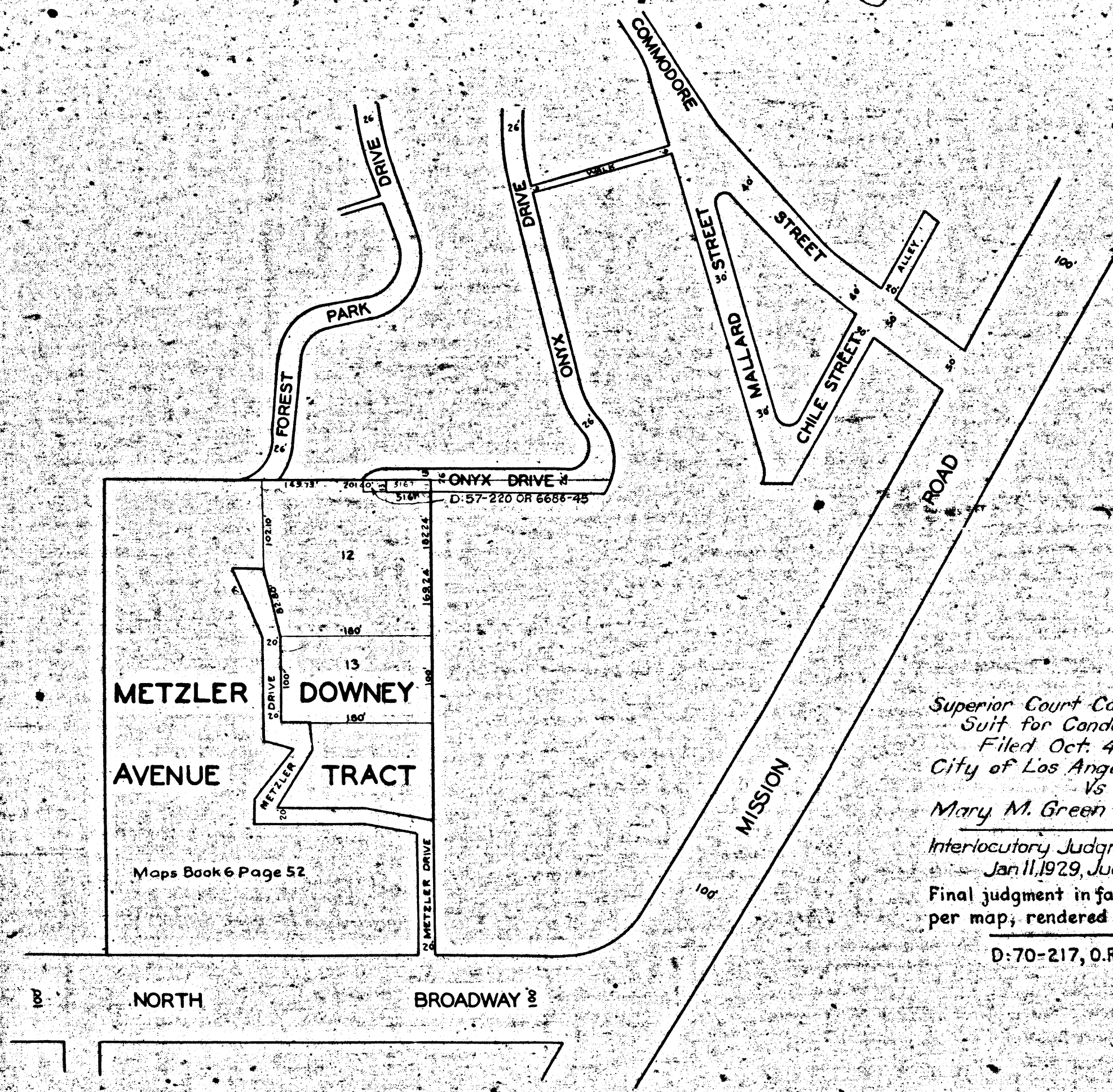
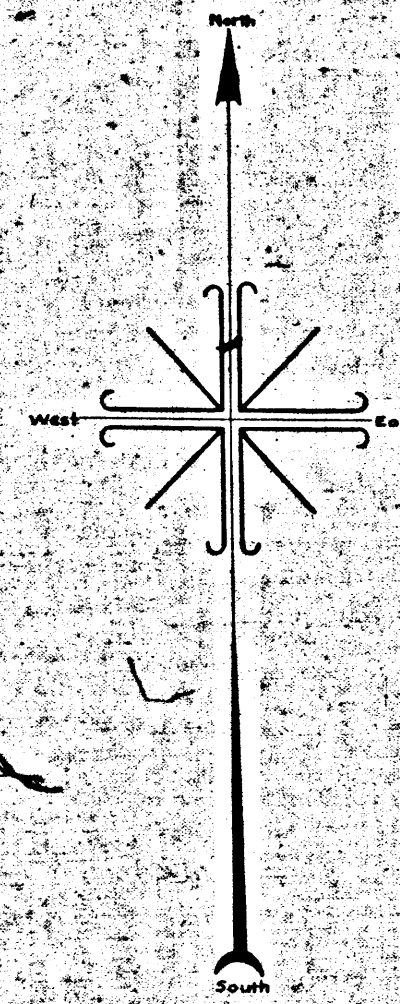

MAP
SHOWING THE LAND TO BE CONDEMNED
FOR THE WIDENING
OF
ONYX DRIVE

ALONG THE SOUTHERLY LINE THEREOF BY THE
CONDEMNATION OF A PORTION OF LOT 12 METZLER DOWNEY
AVENUE TRACT AS PER MAP RECORDED IN BOOK 6 PAGE 52
OF MAPS RECORDS OF LOS ANGELES COUNTY
BETWEEN
A POINT APPROXIMATELY ONE HUNDRED EIGHTY (180) FEET
EASTERLY OF THE EASTERLY LINE OF FOREST PARK DRIVE
AND
A POINT APPROXIMATELY ONE HUNDRED TWENTY (120) FEET
EASTERLY OF THE EASTERLY LINE OF FOREST PARK DRIVE
MEASURED ALONG THE NORTHERLY LINE OF SAID LOT 12
IN THE
CITY OF LOS ANGELES CAL
IN ACCORDANCE WITH ORDINANCE NO 61773
JOHN C. SHAW CITY ENGINEER SEPTEMBER 1928
SCALE 1 IN=100 FT

*Superior Court Case No. 262760
Suit for Condemnation
Filed Oct. 4th 1928
City of Los Angeles, Plaintiff
Vs
Mary M. Green et al., Def.
Interlocutory Judgment rendered
Jan. 11, 1929, Judg. Bk. 701281
Final judgment in favor of Pl'ff., as
per map, rendered Feb. 1st, 1929.
D:70-217, O.R. 7464-56.*

NOTE Land to be condemned, shown colored red

Index 18

88SC-A

A-5288

