

1432-A

1434-A

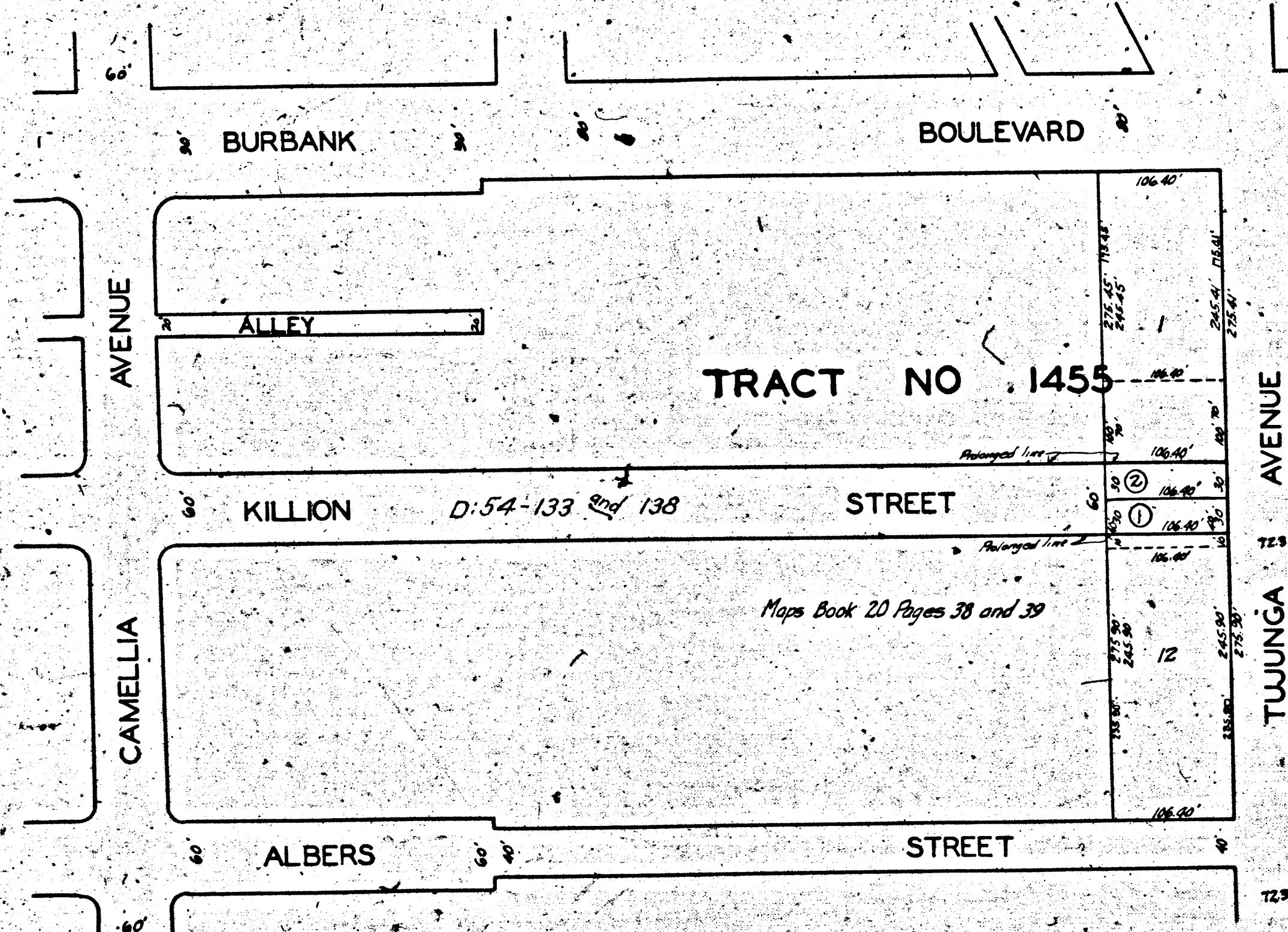

**MAP**  
 SHOWING THE LAND TO BE CONDEMNED  
 FOR THE  
 OPENING AND EXTENDING  
 OF  
**KILLION STREET**  
 FROM  
 THE EASTERLY TERMINUS THEREOF  
 APPROXIMATELY EIGHT HUNDRED FIFTEEN (815) FEET  
 EASTERLY OF CAMELLIA AVENUE  
 TO  
 TUJUNGA AVENUE  
 IN THE  
 CITY OF LOS ANGELES CAL.  
 IN ACCORDANCE WITH ORDINANCES NOS. 60884 AND 62190  
 JOHN C SHAW CITY ENGINEER  
 SCALE 1 INCH = 100 FEET  
 OCTOBER 1928

*Notes*  
 Land to be condemned shown colored red  
 Dotted lines and dimensions show property holdings in those  
 cases where they differ from the recorded subdivision.  
 Figures in circles indicate the parcel numbers as set forth  
 in paragraph VIII of the complaint.

Sheet 54  
 Superior Court Case No. 268580  
 Suit for Condemnation  
 Filed Dec. 29<sup>th</sup> 1928  
 City of Los Angeles, P'tff.  
 Vs  
 Ellen J. Cornwell et al., Def.  
 Interlocutory judgment as per  
 map, rendered Aug. 20<sup>th</sup> 1929.  
 Judg. Bk. 732-363.  
 Case dismissed by order of the  
 Court, Aug. 22<sup>nd</sup> 1930. Judg.  
 Bk. 203-144.

