

Crescent Avenue

Avalon
Santa Catalina Island

as located in June 1897.

By E. I. Wright, Co. Sur.

Scale 40 ft = 1 in
F.B. 13-45

COUNTY SURVEYORS MAP NO. 3422

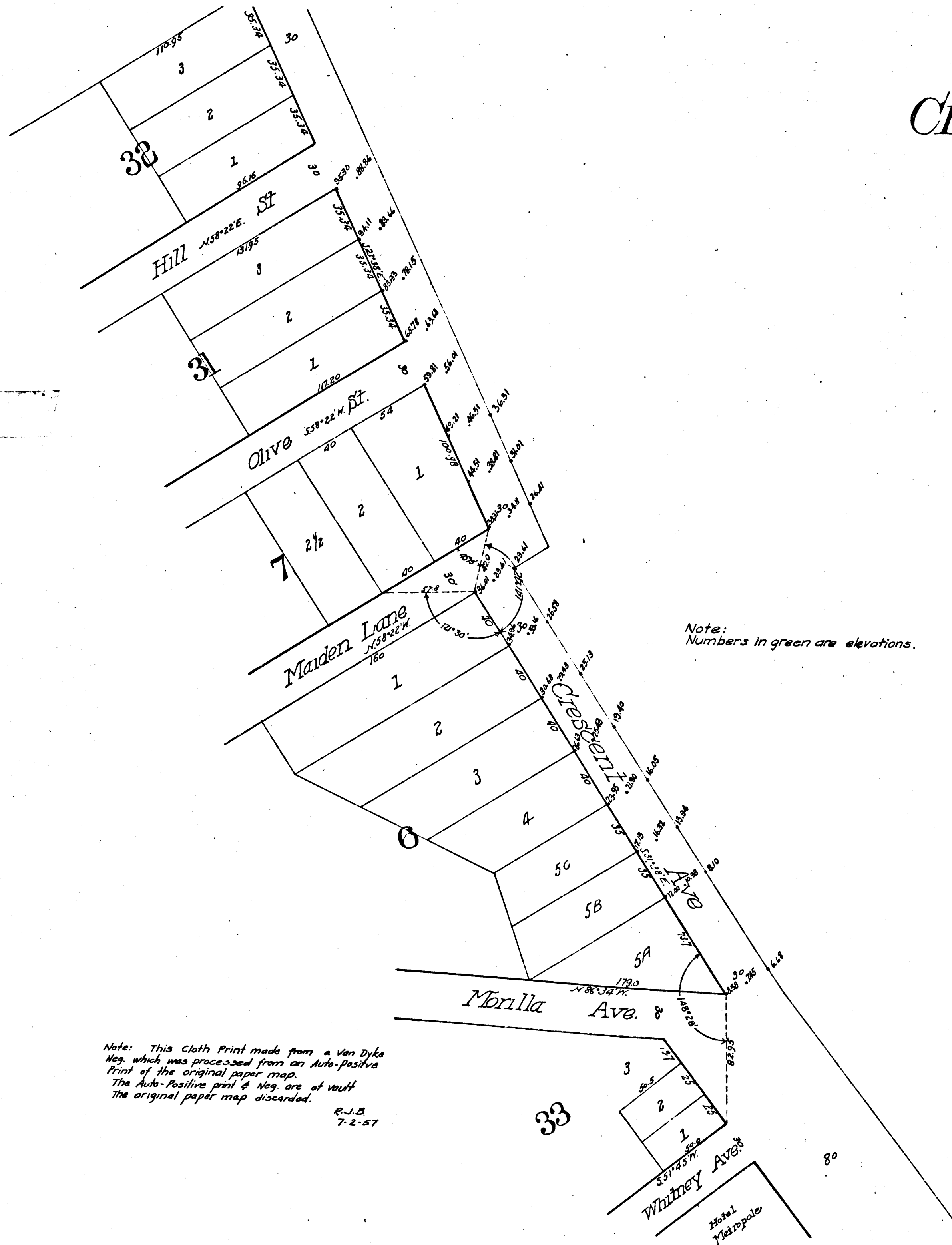

Note:
Numbers in green are elevations.

Note: This Cloth Print made from a Van Dyke
Neg. which was processed from an Auto-Positive
Print of the original paper map.
The Auto-Positive print & Neg. are at vault
The original paper map discarded.

R.J.B.
7-2-57

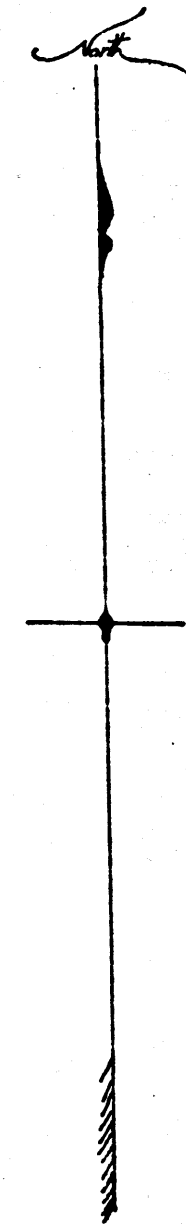

CS 3422