

WILMINGTON AND SAN PIEDRO

Showing line of Present Traveled Road

As located in April 1896

under instructions of honorable Board of Supervisors

E. T. Wright, Co. Secy.

by W. E. Richardson, Dep.

Scale 400 ft. = 1 in.

Notebook M. P. 22

Sec. D: 1180-11-12 D: 10-93
For new location of portion of this road
See Filed Map No. 17600

For vacation of part of road See: Ord 22136

INDEX 28

This photostatic tracing made April, 1958 from the cloth mounted original map which has been discarded.

Retouched by: Franklin Stone July 1958
Checked by: R. J. O.

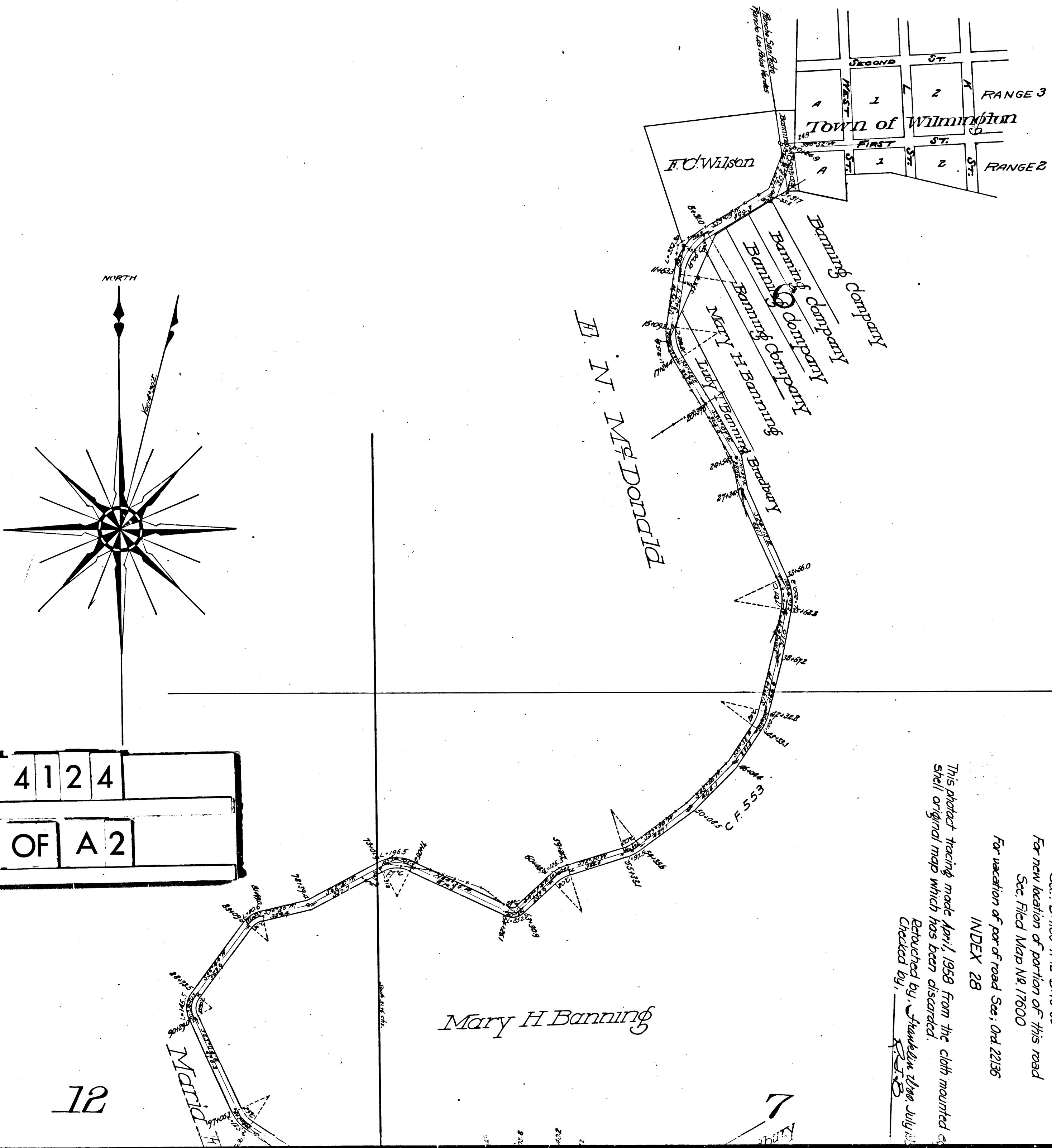

CS	4	1	2	4
A	1	OF	A	2

