

FILED MAP, NO. 10841

FILED MAP, NO. 10841

Patent Jura 23 August, 1872.

A.B. G. J. J.

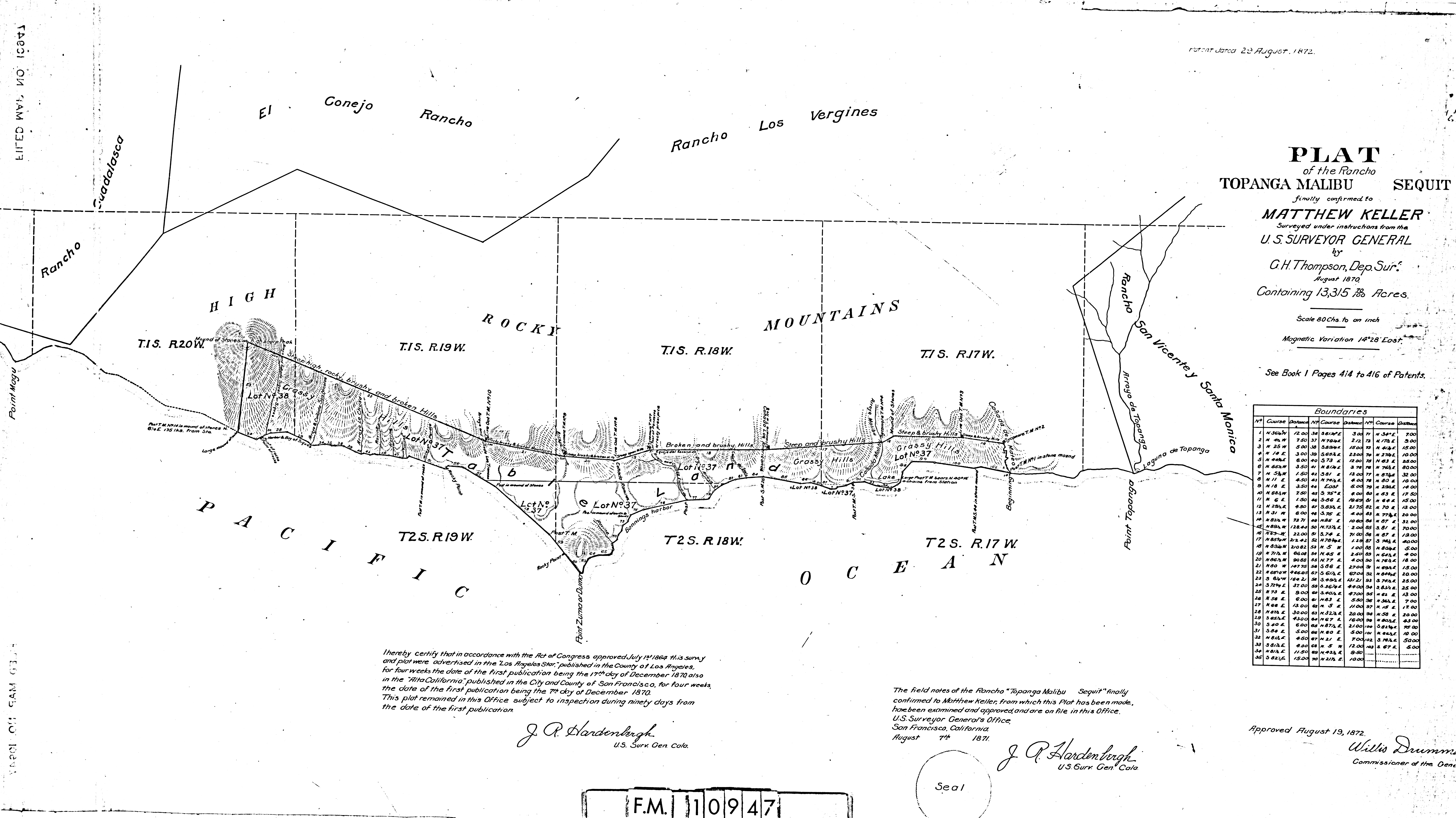

**PLAT**  
of the Rancho  
**TOPANGA MALIBU SEQUIT**

finally confirmed to  
**MATTHEW KELLER**  
Surveyed under instructions from the  
**U. S. SURVEYOR GENERAL**  
by  
*G. H. Thompson, Dep. Sur.*  
August 1870.  
Containing 13,315 7/8 Acres.

Scale 80 Chs. to an inch  
Magnetic Variation 14° 28' East.

See Book 1 Pages 414 to 416 of Patents.

Boundaries					
N <sup>o</sup>	Course	Distance	N <sup>o</sup>	Course	Distance
1	N 36 1/2 W	12.00	36	S 61 1/2 E	3.00
2	N 70 W	7.50	37	N 70 E	3.00
3	N 25 W	5.00	38	S 89 1/2 E	15.00
4	N 14 E	3.00	39	S 89 1/2 E	10.00
5	N 44 E	6.00	40	S 73 E	10.00
6	N 65 1/2 W	3.50	41	N 81 1/2 E	80.00
7	N 5 1/2 W	1.50	42	N 87 1/2 E	32.00
8	N 11 E	4.50	43	N 80 E	10.00
9	N 11 E	3.50	44	S 20 1/2 E	14.00
10	N 68 1/2 W	7.50	45	S 75 E	17.50
11	N 6 E	1.50	46	S 66 E	15.00
12	N 25 1/2 E	4.50	47	S 63 1/2 E	18.00
13	N 31 W	6.00	48	S 55 E	20.00
14	N 82 1/2 W	23.75	49	N 85 E	10.00
15	N 80 1/2 W	12.84	50	N 73 1/2 E	70.00
16	N 78 1/2 W	22.00	51	S 7 1/2 E	18.00
17	N 85 1/2 W	23.42	52	N 78 1/2 E	40.00
18	N 83 1/2 W	20.82	53	N 5 W	5.00
19	N 77 1/2 W	66.08	54	N 45 E	4.00
20	N 66 1/2 W	90.88	55	N 77 E	18.00
21	N 60 W	147.75	56	S 66 E	13.00
22	N 57 1/2 W	146.85	57	S 57 1/2 E	67.00
23	S 64 1/2 W	164.21	58	S 49 1/2 E	20.00
24	S 72 1/2 W	47.00	59	S 36 1/2 E	25.00
25	N 73 E	9.00	60	S 30 1/2 E	13.00
26	N 58 E	9.00	61	N 43 E	7.00
27	N 48 E	13.00	62	N 35 E	7.00
28	N 37 1/2 E	30.00	63	N 32 1/2 E	20.00
29	S 65 1/2 E	43.00	64	N 27 E	43.00
30	S 50 E	6.00	65	N 17 1/2 E	70.00
31	S 30 E	5.00	66	N 10 E	10.00
32	N 8 1/2 E	4.50	67	N 2 E	50.00
33	S 6 1/2 E	4.00	68	N 5 W	5.00
34	N 8 1/2 E	11.50	69	N 43 1/2 E	9.50
35	S 82 1/2 E	15.00	70	N 27 1/2 E	10.00

Thereby certify that in accordance with the Act of Congress approved July 1<sup>st</sup> 1864 this survey and plat were advertised in the Los Angeles Star, published in the County of Los Angeles, for four weeks the date of the first publication being the 17<sup>th</sup> day of December 1870 also in the Alta California, published in the City and County of San Francisco, for four weeks the date of the first publication being the 7<sup>th</sup> day of December 1870. This plat remained in this Office subject to inspection during ninety days from the date of the first publication.

*J. R. Hardenbergh*  
U.S. Sur. Gen. Cal.

The field notes of the Rancho "Topanga Malibu Sequit" finally confirmed to Matthew Keller, from which this Plat has been made, have been examined and approved, and are on file in this Office.  
U.S. Surveyor General's Office,  
San Francisco, California,  
August 7<sup>th</sup> 1871.

*J. R. Hardenbergh*  
U.S. Sur. Gen. Cal.

Approved August 19, 1872.

*Willis Drummond*  
Commissioner of the General Land Office

F.M. 110947

