

Copied from Photographic Copies
furnished by
U. S. General Land Office
Washington, D. C.

Note, \ Blue, \ lines run by A. G. Ruxton - 1888
Vermilion, \ W. P. Reynolds - 1876

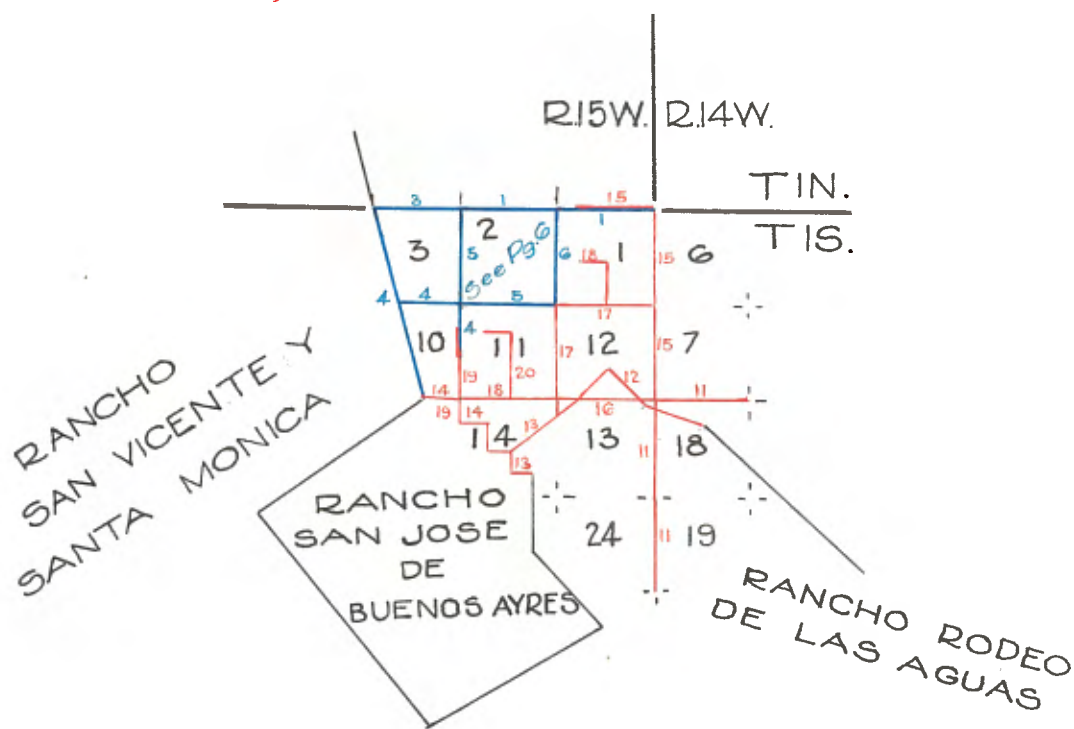

SAN BERNARDINO BASE LINE.

chs.

- From the established standard corner to Secs. 31 and 36, Ts. 1 N. Rs. 14 and 15 W. S.S.B.B. and M. the elder post in mound of rocks still standing and being 37 lks west of an elder post at the northeast corner of Secs. 1, T. 1 S., R. 15 W.
West on sth. bdy. of Sec. 36,
Mag. Var. $14\frac{3}{4}$ 45' East.
- 4.00 Cross deep ravine 50 lks. wide, course N. 20° E 70 feet
7.34 Brow of ridge, course N and S + 110 feet and descend broken west slope through chaparral (dense).
25.00 Leave west slope and descend across N. slope
32.00 N. point of grassy spur
40.00 Point for $\frac{1}{4}$ sec. cor. on S. bdy of Sec. 36,
42.08 To the Palo Colorado tree now burned but still standing and plainly marked for $\frac{1}{4}$ sec. cor.,
This is the $\frac{1}{4}$ sec. cor. on the north bdy of Sec. 1 by approved survey of T. 1 S., R. 15 W.,
55.00 Cross gully, 20 lks. wide, course N. 45° W. 180 feet.
57.50 Point of low brushy hill
62.00 The house of C. Tullis at mouth of ravine, coming from east, bears North 1.94 chs. distant.
62.08 Failed to find any trace of sand rock in mound of rock at point for cor. to frac. Sec. 1.,
Set an oak post $36 \times 4 \times 4$ in. 12 inches in the ground in a mound of earth 36 in. base and 24 in. high, marked $11/8$ S.
64.00 Enter Bottom of Franklin Canon comes from N. $10\frac{1}{2}$ ° E. 10 feet.
The N.E. corner of a small corral bears south 27 lks. distant,
64.50 The S.E. corner of a stable bears North 45 lks. dist., cross road, course North and S. 20° W.,
65.60 Leave bottom of Franklin Canon, course S.W. and ascend steep brushy east slope.
69.00 Brow of brushy hill + 90 ft.
72.00 Cross wash 20 links wide, course S. $80\frac{1}{2}$ ° E.
79.80 Cross rocky wash, 10 lks wide, runs N. 20° E about 2 chains into wash last named,
80.00 Set a conglomerate sand rock $16 \times 12 \times 8$ inches 12 in. in the ground marked with 1 notch on the east and 5 notches on the west side for standard corner to Secs. 35 and 36, and raised a mound of granite boulders and conglomerate rock 36 in. base and 18 in. high, around sand conglomerate sand rock from which a (burned and dead) live oak tree 10 in. diam., marked S. 35, T. 1 N., R. 15 W., B.T., bears, N. $84\frac{1}{2}$ ° W. 1.42 chs. distant,
Land mountainous, very rough, and broken, covered with chamisal, and sage brush, with some scattering live oak trees.

NOTE:

I commenced with an assumed variation which I found agreed with the line from the section to the $\frac{1}{4}$ sec. cor., but the distance I found to be 42.08 chains, I, therefore, remeasured the line and found the distance as above,

I failed to find any trace of the sand rock in mound of sand rock, as per off survey at cor. to frac. Sec. 1,

West on south bdy of Sec. 35,

Mag. Var. $14\frac{1}{2}$ 45' E.

Ascending steep brushy east slope of mountain.

- 1.28 Brow of dividing ridge, course N. $10\frac{1}{2}$ ° E and S. $10\frac{1}{2}$ ° W + 160 feet, descend brushy west slope

- 40 Enter barley patch in Higgin's Canon (this was formerly known as Spanish Canon)

- 66 The S.W. corner of house of P. Higgins bears S. $31\frac{1}{2}$ ° E. 2.57 chs. dis.

The S.E. corner of stable, bears North 2.35 chs. dis.

The S.W. corner of barn bears,

N. 17 E. 2.38 chs. dis.

SAN BERNARDINO BASE LINE.

CHAINS:

- . The S.E. corner of first house built by P. Higgins,
bears N. $7\frac{1}{2}$ E. 6.31 chs. dis.
- 11.50 Cross road, N. 18° E. and S. 18° W. at west edge of barley patch,
which extends up and down the Canon about 10 chs. each way.
- 12.20 Cross wash 10 lks.wide, course S. 18° W. 70 feet.
- Leave Higgins Canon, which comes from N. 10° E. and runs S. 18° W. and ascend across point of brushy hill.
- 14.75 To the N. E. corner of about 3 acres cleared and ploughed land
on steep hill side, cross wash 10 lks.wide, course S. 70° E. and
ascend steep brushy ravine.
- 32.50 Head of ravine and enter barley patch on summit of ridge, course
North and S. 20° W + 130 feet.
- 34.30 Leave barley patch which North about 10 chs. and South 50 lks.
and enter cleared and ploughed land.
- 40.00 Set a lime rock 16 x 12 x 7 in. 12 in. in the ground for standard
 $\frac{1}{4}$ sec.cor., marked $\frac{1}{4}$ on the north side and raised a mound of
lime rock, 24 in. base and 18 in. high around said lime rock and
from which a live oak tree, 6 in. dia., bears N. $17\frac{1}{2}$ E. 93 lks.
dis., marked $\frac{1}{4}$ S. B. T.
- Brow of hill at south point of cleared land bears,
South about 5 chs. dis.
- The head of a deep brushy ravine, course West, bears
N. 45° E. about 3

CHS.

SAN BERNARDINO BASE LINE.

- chains distant
Leave brow of ridge and descend west slope through grass and brush
59.50 Cross wire fence in ravine, which comes from S. 80° E - 170 feet and along same
62.50 This ravine forms the head of east fork of Benedict Canon, Cross wash 10 lks wide, course N. 80° W and run over low point of hill through live oak trees,
71.50 Enter last named ravine,
73.90 Cross wire fence and wash 10 lks wide, course S 70 W and enter barley patch ascending.
76.70 Leave barley patch and run over brushy point
78.50 South point of brushy ridge and descend, west slope.
80.00 Set a sand rock 24 x 12 x 8 in. 16 in. in the ground for standard corner to Secs. 34 and 35, marked with 2 notches on the east and 4 notches on the west side and 1 on top and raised a small mound of stone alongside and from which the S.E. corner of house of John Levell in Canon bears N. 21° 35' W 10.05 chs. distant,
Land mountainous, last ½ mile over grassy hills with young live oak trees,

March 28th, 1888.

- West on south bdy Sec. 34,
Mag. Var. 14° 45' E.
Through barley patch,
1.00 Cross gully 5 lks. wide, course S. 10° E and leave barley patch, which extends about 7 chains up canon
1.50 Cross road N 10° W and S 10° E.
2.00 West edge of bottom of Levell Canon, which comes from N 13° W and runs S 26 W - 50 feet, ascend brushy hill.
10.00 Brow of ridge, course N 20° W and S 10 W + 90 feet, descend.
20.26 To a clump of young elder trees in grassy ravine, course S. 23° E., this is the west fork of Benedict Canon,
20.50 Cross wash 20 lks. wide, course S. 23 E. - 100 feet ascend grassy east slope of mountain
33.00 Enter small grassy flat.
36.00 Ascend north slope.
40.00 Set a grey granite rock 20 x 8 x 6 in. 12 in. in the ground for standard ¼ sec. cor., marked ¼ on north side and raised a mound of grey granite 18 in. base and 12 in high, around said rock and from which,
A walnut tree 4 in. diam., marked ¼ S.B.T. in a clump of 4 walnut trees bears S 56½ W. 50 lks. dis.
46.00 Ascend steep brushy East slope
51.25 Summit of divide, course N and S. + 500 feet
Descend steep brushy west slope.
53.50 Grassy west slope
65.25 Enter bottom of Canon, (Arroyo Seco), course south
66.90 The N.E. cor. of a chicken house bears South 81 lks. dis.
67.25 Cross gully 12 lks. wide, with small stream, course south - 300 feet.
The house of Griffith bears North 1.06 chs. dist.
Honey house S. 127 ch. dist.,
Ascend grassy east slope.
76.25 Ascend through brush.
80.00 Set a lime rock 16 x 12 x 8 in. 12 in. in the ground for standard corner to Secs. 33 and 34, marked with 3 notches on the east and 3 notches on the west side and raised a small mound of lime rock alongside + 200 feet.
The summit of ridge, course N. and S. bears West 1.50 chs. distant,
Land mountainous, good for grazing with scattering live oak trees, some chemisal, and sage brush.

March 29th, 1888.

EAST BOUNDARY OF RANCHO SAN VICENTE Y SANTA MONICA.

SAN BERNARDINO BASE LINE.

East Boundary of Rancho San Vicente y Santa Monica,
From the post marked, S.V.S.M. 25 and S.J. B.A. 14 in mound of earth
and slate rock with pits at the common corner to the Rancho San
Vicente y Sta. Monica and San Jose de Buenos Ayres, N. 19° 15' W.,
Mag. Var., 14° 45' E.

Along the easterly boundary of the Rancho San Vicente y Santa
Monica,

- 19.50 Browned spur, course S. 60° W. into Arroyo Seco. + 50 feet and run
across broken brushy west slope of m't'n.
- 90.00 Brow of ridge course N.E. and S.E. + 250 feet.
The Arroyo Seco, course S. 20° E. bears W. about 15 chs. dist.,
Descend across broken brushy west slope
- 137.00 Cross road in Arroyo Seco, course N. 10° E and S 10° W.
- 137.50 Cross wash of Arroyo Seco 10 lks wide, course S. 10° W. 175 feet, ascend
across steep brushy east slope of mountain.
- 170.00 Intersect the San Bernardino Base Line 1.37 ch. East of Standard
corner to Secs. 33 and 34, Set an oak post 48 x 5 x 5 in for cor. to
frac. sec. 3 with a lime rock 20 x 14 x 8 in 14 in. in the ground Post
marked S.V.S.M. on west side S. 34, T. 1 N., R. 15 W. on N.E. side,
S. 3 T. 1 S., R. 15 W. on S.E. side,
Lime rock marked S.V.S.M. on west side and raised a mound of lime
rock 32 in base, and 20 in high around post and rock + 220 feet,
Land mountainous, very rough and broken and covered with chaparral
almost worthless.

March 30th, 1888.

SUB-DIVISION OF FRAC. T. 1 S., R. 15 W., S.B.B. and M.

- CHAINS From the established $\frac{1}{4}$ sec. cor., between Secs. 10 and 11, an elder
post in a mound of slate rock on rocky east slope of ridge North
between Secs. 10 and 11
Mag. Var. 14° 45' E.
- 3.00 Foot of ridge and enter Benedict Canon 20 feet
- 7.50 Cross bottom of Benedict Canon, comes from N. 40° W, runs S. 20 E.
- 12.00 Brow of spur, course S.W.
- 17.60 Brow of ridge, course S. 70° W + 200 feet and descend
- 20.00 Find no trace of cor. to frac. secs. 10 and 11,
Set a sand rock 14 x 9 x 6 in, 10 inches in the ground and raised a
small mound of sand rock around rock,
- 27.90 Brow of spur, course N. 60° E and S. 60° W + 100 feet
- 35.90 Brow of spur, course E. and W. + 40 feet, Descend.
- 40.00 Set a slate rock 24 x 18 x 2 in. 18 inches in the ground for cor. to
Secs. 2, 3, 10 and 11, marked with 5 notches on the south and 2 notches
on the east edge, and raised a mound of slate rock 36 in. base and
18 in. high, around said slate rock,
Land rough and broken,
Covered with chamisal and sage brush
West between Secs. 3 and 10,
Mag. Var. 14° 45' E.
- 5.00 Head of brushy ravine, course S.W. and descend.
- 25.00 Set an elder stake at the east side of bottom of Benedict Canon -
275 feet
- 28.00 Leave bottom of Benedict Canon, comes from N. 10 E and runs South and
ascend steep east slope of mountain through dense chaparral.
- 40.00 Set an elder post 3 ft. long, 3 in. square with marked stone 12 in. in
the ground for $\frac{1}{4}$ sec. cor., marked post $\frac{1}{4}$ S. on north face, dug
pits 18 x 18 x 12 in E and W of post $5\frac{1}{2}$ feet distant and raised a
mound of earth 24 in. base and 12 in. high around post.

SUB DIVISION OF FRAC.T.18.,R.15 W.,S.B.B.
AND M.

- 47.25 Cross gully 10 lks wide course S.
50.40 Summit of ridge course N.W.and S.E.+ 300 feet
51.10 Intersect east boundary of Rancho San Vicente y Santa Monica
Set a sand rock 14 x 11 x 8 in.12 inches in the ground for cor.to
frac.secs. 3 and 10, marked S.V.S.M. on the West side, S.3 on the
north, and S 10 on the south and raised a mound of sand rock 36
in base and 18 in high around said rock and from which
The post marked S.V.S.M. 25 and S.B.J.A.14 at the Southeasterly
corner of the Rancho San Vicente y Santa Monica bears S.19°15'E
84.83 chs.dist.
North between Secs. 2 and 3,
Mag.Var.14° 45' E.
- 9.00 Brow of spur N.80° E and S 80° W +30 feet
24.90 Brow of spur N 75° E and S 75° W + 40 feet
35.00 Brow of spur N 77° E and S 77° W - 20 feet.
Descend steep brushy N slope
39.30 Enter ravine, course S 80° W - 150 feet
40.00 Set a sand rock boulder 15 x 15 x 12 in.for $\frac{1}{4}$ sec.cor.,marked $\frac{1}{4}$
on West face with marked stone 12 in.in the ground and raised a
mound of conglomerate rock 24 in base and 18 in high around said
boulder and from which,
An elder tree 5 in.dia.,bears S.42 3/4° E 51 lks.distant,marked
 $\frac{1}{4}$ S.B.T.
A live oak tree 5 in.dia.,bears N 75° W 47 lks.dis.,marked $\frac{1}{4}$ S.B.T.
- 40.30 Cross road N.70° E and S.70° W and ascend rocky south slope
46.60 Brow of ridge N 70 E and S 70° W + 120 feet,and descend grassy
north slope through young live oak trees,
64.00 Cross ravine, course W.- 50 feet
75.68 Enter east fork of Benedict Canon, course S.30 W.-60 feet
75.80 Cross wash 10 lks.wide,S.30 W.
77.80 Cross wire fence N.85° E & S 85° W
80.68 Set a sandrock 19 x 8 x 8 in.15 in.in the ground for closing corner
to Secs. 2 and 3,marked C.O.with 2 notches on the east face and 4
notches on the west face and raised a mound of earth and lime rock
48 in base and 36 in high around said sand rock,on brushy hill side
and from which,
The standard corner to Secs.34 and 35, bears West 31 lks.dist.,
Land mountainous.
First half mile very rough and covered with chaparral.
Last $\frac{1}{2}$ mile ~~very~~ good grazing.
- East on a random line between Secs. 2 and 11,
Mag.Var.14°45' E.
- 40.00 Set temporary $\frac{1}{4}$ sec cor.
80.10 Intersect N and S line 98 links N of the established corner to Secs.
1,2,11, and 12, a conglomerate quartz rock 22 x 16 x 14 in
From which corner I run N 89° 18' W on a true line between Secs.2
and 11,
Mag.Var.14°45' E.
- 0.75 Enter Vineyard at foot of low point of spur on east side of Franklin
Canon
Vineyard and orchard extend about 10 chains up the Canon
2.30 Cross road N 10° W and S.E.
3.50 Cross wash, course S.E.
4.90 Leave bottom Franklin Canon, which comes from N 10° W, runs S.45° E.
about 5 chs.,thence S.20° E, Elevation 550 feet above sea level.
Ascend steep brushy east slope
11.00 Brow of divide course N 6° E and S 6° W + 200 feet.Descend steep
brushy W slope
16.00 Enter bottom of Higgins Canon, course S 5° E.-175 feet
16.77 Cross road N.5° W and S.5° E set stake

SUBDIVISION OF FRAC.T.1 S.,R.15 W.,S.B.B.and M.

19.40 Leave Canon and ascend steep brushy east slope
 33.00 Brow of divide course N.10° W and S. 10° E + 400 feet
 Descend steep brushy West slope
 40.05 Set an elder post, 4 feet long, 4 in.square for $\frac{1}{4}$ sec.cor.,
 marked $\frac{1}{4}$ S.on the north side,with marked slate rock 12 in.in
 the ground and raised a mound of earth and slate rock 36 in.base
 and 24 in high around post.
 44.50 Enter Pea Vine Canon,Course south 200 feet
 49.00 Leave canon and ascend steep brushy East slope
 69.00 Summit of divide,course N 20° E and S 20 W x 300 feet and descend.
 80.10 To the corner to Secs.2,3,10 and 11, 90 feet.
 Land mountainous,very rough and covered with chaparral.
 April 2nd,1888.

North,between Secs.1 and 2,
 Mag.Var.14°45' E.

6.00 Enter small ravine
 The house of Noah Levering bears West 1.00 ch.dist.
 7.00 Cross ravine with small stream,course S.80° W and ascend.
 14.90 Brow of brushy spur course West + 100 feet. Summit of ridge bears
 East about 3 chains distant.
 35.80 Brow of brushy spur,course West + 100 feet,Descend steep brushy
 north slope.
 40.00 Set a grey granite rock 18 x 7 x 5 in.12 in.in the ground for $\frac{1}{4}$
 sec.cor.,marked, $\frac{1}{4}$ on west face and raised a mound of grey granite
 54 in.base and 16 in high around rock,
 40.75 Cross wash,50 links wide,course west with large granite boulders
 50 feet
 Ascend steep brushy S.slope
 44.50 Brow of brushy spur,course S.70° W + 50 feet Descend
 55.50 Brush fence at southwesterly end of small garden patch on hill side.
 56.47 To a sycamore tree 22 in dia in bottom of Franklin Canon
 57.70 Cross stream in rocky wash 10 lks.wide, course S.20 W.-90 feet
 58.10 Cross road N.20 E and S.20 W.
 A spring bears S.76 $\frac{1}{2}$ ° E 4.65 chains distant
 Leave bottom of Canon and ascend low brushy point
 67.50 Brow of spur N 68 W and S 68 E + 110 feet and Descend N slope
 75.60 Brow of grassy spur E & W + 40 feet
 79.57 Set a redwood post 5 feet long 4 in square with charred stake and
 12 small granite rocks 15 in.in the ground for closing corner to
 Secs.1 and 2, on the Base Line.
 Post marked O.C.T.1 S., R.15 W. on S.side S.1 on E. side, S.2 on W.
 side and raised a mound of earth and granite boulders 60 in.base
 and 36 in high around post,from which,
 The standard corner to Secs.35 and 36, bears West 64 lks.distant.
 Land mountainous,very rough and broken and covered with chamisal
 poisonoak and sage brush.

April 3rd,1888.

Traverse to locate house on Sec.2,
 From the stake in Higgins Canon
 N.89° 18' W 16.77 chs.from corner to Secs.1,2,11,and 12,
 N.3° 15' W.

Mag.Var.14°45' E.

Up Higgin's Canon.
 5.50 To Sta. thence,
 N.9° W.
 13.20 To Sta. thence,
 N.23 $\frac{1}{4}$ ° W.
 10.75 To the center of east side of house (front) of L.Sarnon.

SUBDIVISION OF FRACTIONAL T.1 S., R.15 W., S.B.B.
AND M.

Traverses locating house in Benedict Canon Traverse No.1, From the closing corner to Sections 2 and 3, S.32° 15' W.
Mag.Var.14°45' E.

Down Canon

3.50 Cross wire fence N 35° E & S.85° W.
10.00 To sta.in center of Canon 4 chs.wide,thence,
S.11°45' W.
2.50 To sta, canon 2 chs wide,thence,
S.23° W.
8.70 To sta.thence,
S.65°45' W.
5.00 To sta, thence,
N.23° W.
2.15 To the S.E.corner of the house of E.Parrish at foot of point of divide between the east and west forks of Benedict Canon
Traverse No.2
From the elder stake 25.00 chs.West of corner to Secs.2,3,10,and 11,
N.4° E.

Mag.Var.14°45' E.

Up Canon

1.00 Cross wire fence, course E. and W. across Benedict Canon
3.50 To Sta.thence,
N.27° E
2.50 To Sta.thence,
N.14° E.
3.20 To Sta.thence,
N.8° E
4.50 To sta.thence,
46.55 N.19° E.
4.50 To sta.thence,
North
4.00 To sta.thence,
N.43°45' E.
3.80 To sta.thence,
N.13° W.
7.60 To S.W.cor.of house of Dietrich on W side Benedict Canon, 4 chs. wide,
Traverse No. 3,
From the elder stake 25.00 chs.west of corner to Secs.2,3,10,and 11, S.12° W.

Mag.Var.14°45' E.

Down Benedict Canon.

5.20 To sta in center of canon 3 chs wide,thence,
S.11°15' W.
4.50 To sta.,thence,
S.15° E.
7.90 To the N.E.corner of the house of J.Schaefer, thence,
S.49° E.
7.20 To sta.thence,
S.8°15' E.
4.90 To the S.E.corner of the house of O.Hanson on the S.west side of
49.60 Canon, 4 chs.wide,.

GENERAL REPORT.

The land in this fractional township consists of rough broken and brushy hills which form part of the chain of mountains dividing the Los Angeles and San Fernando Valleys. In the canons which are deep and narrow there is a little land under cultivation. The hills are mostly used for grazing purposes. There is very little timber small live oak trees and some willows,

SUBDIVISION OF FRAC.T.1 S.,R.15 W.,S.B.B.
AND M.

Sycamores in the canons.

In Section 2 there are deposits of granite.

The improvements are permanent and the houses noted occupied by actual settlers.

In order to correctly locate the houses I was obliged to run the traverse lines that preceed this report.

ALBERT GEORGE RUXTON,
U. S. Deputy Surveyor,
Los Angeles, June 11th, 1888.

SOWN STATEMENT OF ALTERATION:

I, Albert George Ruxton, United States Deputy Surveyor, do solemnly swear that in pursuance of special instructions received from R.P.Hammond, jun., United States Surveyor General for California, dated June 8th, 1889, under contract No.12, dated September 27th, 1887, I have well, faithfully and truly and in my own proper person made the following alterations on the ground in surveys executed by me in T.1 S., R.15 W., S.B.M. viz:

At $\frac{1}{4}$ sec.cor. between Secs. 3 and 10, I set an elder post 3 ft. long, 3 in.square, with marked stone 12 in.in the ground for $\frac{1}{4}$ sec. cor.marked post $\frac{1}{4}$ S.on north face, dug pits 18 x 18 x 12 in E.and W.of post, 5 $\frac{1}{2}$ ft.distant, and raised a mound of earth 24 in.base, and 12 in. high round post, as per notes on pages 20 and 21.

At $\frac{1}{4}$ sec.cor.between Secs.2 and 3, I set a sand rock boulder 15x 15x12 in for $\frac{1}{4}$ sec.cor.,marked $\frac{1}{4}$ on west face with marked stone 12 in.in the ground and raised a mound of conglomerate rock 24 in.base and 18 in high around said boulder, and from which, an elder tree 5 in.diam., bears S.42 $\frac{3}{4}$ E 51 lks.dist., marked $\frac{1}{4}$ S.B.T.

A Live oak tree 5 in.diam.bears N.75° W. 47 lks.dist., marked $\frac{1}{4}$ S.B.T. as per notes on page 22 and 23.

At closing corner to Secs. 2 and 3, I set a sand rock 19 x 8 x 8 in., 15 in.in the ground for closing corner to Secs.2 and 3, marked C.C. with 2 notches on the east face and 4 notches on the west face and raised a mound of earth and lime rock 48 in base and 36 in high, around said sand rock, on brushy hillside, and from which The standard corner to Secs.34 and 35, bears West 31 lks.distant.

ALBERT GEORGE RUXTON,
United States Deputy Surveyor,
STATE OF CALIFORNIA, }
COUNTY OF LOS ANGELES. } ss.

SUBSCRIBED AND SWORN to before me this 20th day of May,
A.D. 1890.

R. H. CHAPMAN,
Notary Public.

(SEAL).

FINAL OATHS FOR SURVEYS.

LIST OF NAMES.

A list of the names of the individuals employed by Albert George Ruxton, United States Deputy Surveyor, to assist in running, measuring, and marking the lines and corners described in the foregoing field-notes of the survey of FRACTIONAL TOWNSHIP 1 SOUTH, RANGE 15 WEST, SAN BERNARDINO BASE AND MERIDIAN, showing the respective capacities in which they acted.

.....Compassman.
Ludolph George Sarnow, Chainman.
William Horace Ensign, Chainman.
....., Chainman.
....., Chainman.
....., Axman.
....., Axman.
James Henry Levering, Flagman.
.....

FINAL OATHS OF ASSISTANTS.

We hereby certify that we assisted Albert George Ruxton, United States Deputy Surveyor, in surveying all those parts or portions of the FRACTIONAL TOWNSHIP ONE SOUTH, RANGE 15 WEST, of the SAN BERNARDINO base and Meridian, of California, as are represented in the foregoing field-notes as having been surveyed by him and under his direction; and that said survey has been in all respects to the best of our knowledge and belief, well and faithfully surveyed, and the corner monuments established according to the instructions furnished by the United States Surveyor-General for California.

.....Compassman.
Ludolph George Sarnow, Chainman.
William Horace Ensign, Chainman.
....., Chainman.
....., Chainman.
....., Axman.
....., Axman.
James Henry Levering, Flagman.

SUBSCRIBED AND SWORN to before me this 26th day of May, 1888.

(SEAL)

R. H. CHAPMAN
Notary Public.

FINAL OATH OF UNITED STATES DEPUTY SURVEYOR.

I, ALBERT GEORGE RUXTON, United States Deputy Surveyor, do solemnly swear that in pursuance of instructions received from the United States Surveyor-General for California, bearing date of the 30th day of November, 1887, I have well, faithfully, and truly in my own proper person, and in strict conformity with the instructions furnished by the United States Surveyor-General for California, the surveying manual, and the laws of the United States, surveyed all those parts or portions of TOWNSHIP ONE SOUTH, RANGE FIFTEEN WEST, of the SAN BERNARDINO BASE and MERIDIAN, of California, as represented in the foregoing field-notes as having been surveyed by me and under my directions; and I do further solemnly swear that all the corners of said survey have been established and perpetuated in strict accordance with the surveying manual, printed instructions, the special written

SUB-DIVISION OF FRAC. T.1 S., R. 15 W., S.B.M. (CONT'D)

FINAL OATH OF UNITED STATES DEPUTY SURVEYOR

instructions of the United States Surveyor-General for California, and in the specific manner described in the field-notes; and that the foregoing are the true field-notes of such survey; and should any fraud be detected, I will suffer the penalty of perjury, under the provisions of an act of Congress, approved August 8, 1846.

ALBERT GEORGE RUXTON,
United States Deputy Surveyor.

SUBSCRIBED AND SWORN to before me this 11th day of June, 1888.

(SEAL). R. H. CHAPMAN,
Notary Public.

PRELIMINARY OATH OF ASSISTANTS.

I,, do solemnly swear that I will well and truly perform the duties of Compassman, according to instructions given me, and to the best of my skill and ability.

.....
SUBSCRIBED AND SWORN to before me, this.....day of, 187 .
.....U.S. Deputy Surveyor.

We, ALBERT G. RUXTON and D.C.CAGE, do solemnly swear that we will faithfully execute the duties of Chain Carriers; that we will level the chain upon uneven ground, and plum the tally pins, whether by sticking or dropping the same; that we will report the true distance to all notable objects, and the true length of all lines; that we will assist in measuring to the best of our skill and ability.

D. C. CAGE,
ALBERT G. RUXTON.

SUBSCRIBED AND SWORN to before me, this 8th day of November, 1876.

J.J. WARNER,
Notary Public.

I,, do solemnly swear that I will well and truly perform the duties of according to instructions given me, and to the best of my skill and ability.

.....1.....
SUBSCRIBED AND SWORN to before me, this day of, 187 .
.....U. S. Deputy Surveyor.

FRAC.TP.1 S., R. 15 W., S. B. M.

To find the line bet. Ranges 14 and 15 West in Township 1 S. of the San Bernardino Base and Meridian,
I cause a flag to be placed at a post in a mound of earth the established $\frac{1}{4}$ Sec. corner bet. Secs. 7 and 8, Tp. 1 S., R. 14 W., and begin at a mound of earth with 4 pits - the established corner to Sections 7, 8, 17, 18, and run,
S. 89° 17' W. on true line bet. Secs. 7 and 18, as established by Deputy Goldworthy in his Subdivision of the last mentioned Township,

Var. 14° 06' E.

20.00 Post marked L.B. 6 Station of Rancho La Brea
40.00 Post in mound for $\frac{1}{4}$ Sec. cor.
80.10 To a post in a mound of earth with pits N.W. and S.E. and one North, which indicated an intersection mound instead of a Section mound.,
I therefore run,
North, bet. Secs. 7 and 12,
0.86 To a post in a mound of earth with 4 pits which I assume for cor. to Secs. 7, 12, 13, 18, T. 18., R. 15 W. and 14 W.
This intersection being so much at variance with that as given in the Exhibit Map as furnished me by the office - I deem it necessary to ascertain the correctness of the position to the corner, I assume for Secs. 7, 12, 13, 18, and I therefore run South on Range line bet. Secs. 13 and 18,
Var. 15° 06' E.
Descending the table land from the foot of the south slope of the Coast Range of Mountains.
0.86 Cross Road, N. 70 W. and S. 69° E at mound before mentioned.
1.50 Cross another road N 60° W and S 80 E
21.00 Leave sage brush E. & W.
27.00 Cross road S.E.
40.00 Drove temporary Stake and set a flag at point for $\frac{1}{4}$ sec. cor.
41.00 Cross road N. 70 W and S. 60 E.
43.00 Foot of table land and run over level plain
80.00 Drove a stake and set a flag at point for corner to Sections 13, 18, 19, 24,
Land slopes South 1st 20 chs. bushy, balance grazing land, soil 2nd rate.

South bet Secs. 19 and 24,

Var. 15° 06' E.

40.00 The mound at the established $\frac{1}{4}$ Sec. cor. East. 6 lks. dist.,
80.00 The mound at the established cor. for Sec. 19, 24, 25, 30, bears East 8 lks. dist., I re-establish this corner by setting an Elder post 48 x 3 x 3 and 18 in. deep and rebuilding the mound, and renewing the pits. Land level, soil 2nd rate.

The $\frac{1}{4}$ sec. mound bet. Secs. 24 and 19,

I rebuild and renew the 4 pits, set at the cardinal points.

At the place where I set a temporary stake and flag for the corner to Secs 13, 18, 19, 24, I run East 4 lks. and

Set a Redwood post 40 x 3 x 3 and 17 in. deep and raised a mound of earth with 4 pits 24 x 24 and 12 in deep for cor. to said Sections 13, 18, 24, 19,

At the place where I set a temporary stake and flag for the $\frac{1}{4}$ sec. cor. bet. Secs. 13 and 18, I run,

East 2 lks. and set a Redwood post 30 x 2 x 2 and 12 in. deep and raised a mound of earth with 4 pits at the cardinal points each 20 x 20 and 12 in deep for true point for said $\frac{1}{4}$ sec. cor.

I now cause a flag to be placed at Station 5 of the Rancho San Antonio or Rodeo de las Aguas and another flag on the East slope

FRAC.TP.1 S.,R.15 W.,S.B.M.

Rancho San Antonio.

of a hill on the prolongation of Stations 5 and 6, of the same Rancho, I then proceed to the mound at 86 lks. south of the corner to Secs.7,12,13,18, and find the said mound to be in line between said Stations 5 and 6,

The variation corresponding to the line bet.Ranges 14 and 15 W. is $15^{\circ} 08' E$.

The angle from said mound at 86 lks.

South of corner to Secs.7,12,13,18 and the line bet.Ranges 14 and 15, W.from the South and the flag at Station 5, of the Rancho San Antonio or Rodeo de las Aguas is $69^{\circ} 51'$ making the course from Station 5 to Station 6, N. $69^{\circ} 51'$ W.

November 8th,1876.

I now proceed to Sta.5 of Rancho San Antonio or Rodeo de las Rancho San Antonio or Rodeo de las Aguas.
It being a Granite Rock 11 x 10 and 14 in.above the surface of the ground marked S.A.5 an L.B.4 Station of Rancho La Brea, and run, N $69^{\circ} 51'$ W along the line of the official survey of said rancho San Antonio or Rodeo de las Aguas.
Var. $15^{\circ} 08' E$.

16.50 Cross cañal 150 lks.wide.

49.50 Cross road N $70^{\circ} W$. and S. $80^{\circ} E$.

50.22 To mound at intersection with line bet Ranges 14 and 15 W. 0.86 lks.South of corner to Sections 7,12,13,18.

Set a Redwood post 40 x 4 x 4 and 15 in.deep and rebuilt the mound and renewed the pits,being on line of Rancho and on Range line North, each 24 x 24 and 12 in.deep for cor.to frac.Secs.13 and 18

57.00 Cross road N & S

57.50 Brow of Bank and descend.

The house of Charles Lindley bears N $8^{\circ} E$.11 chs.dist.

58.00 Foot of bank

58.50 Cross dry Ravine. 20 lks.wide,course South

68.38 To a stake marked SA 6 Station in a mound of stones, at the foot of the East slope of hill,thence, N.44 W.along the line of the official survey of said Rancho San Antonio ascending across the East slope of hill

8.50 Brow of hill-

10.00 Cross summit of hill,course N. $15^{\circ} E$ and S. $20^{\circ} W$.

14.00 Cross the head of a dry gully 50 lks.wide, course S. $60^{\circ} E$.

16.00 Cross summit of main ridge and descend into valley

19.00 Foot of ridge and enter valley

21.00 Cross valley,course N. $36^{\circ} E$ and S $36^{\circ} W$

23.00 Cross point of Ridge,course N.E.

24.50 Into dry Ravine,runs S. $10^{\circ} W$.

26.00 Cross ravine and ascend ridge.

31.50 Top of ridge N.E. and S. $20^{\circ} W$.

37.00 Foot of Ridge and enter cañada de las Aguas,course S $12^{\circ} W$.

42.62 To a point from which a Sycamore tree 20 in.dia.,bears N. $39^{\circ} E$. 108 lks.dist. making the true bearing back to Station 6, S. $42^{\circ} 34' E$.-42.77 chs.dist.

The above mentioned Sycamore tree is marked S.A. No.7,Station of the Rancho San Antonio or Rodeo de las Aguas,

From said Sycamore tree the S.W.corner of the house of George Wilt-fong bears N $79^{\circ} E$ 7.64 chs.dist.,thence S. $36^{\circ} 4'$ W along the line of the official Survey of Rancho San Antonio.

3.00 Foot of Ridge and ascend across steep east slope.

8.50 Top of Ridge N & S.

13.00 Foot of Ridge.

FRAC.TP.1 S.,R.15 W.,S.B.M.
Rancho San Antonio.

14.00 Cross Bushy Ravine, runs South.
18.50 Top of ridge N and S
22.00 Foot of ridge
28.00 Summit of Main Ridge course N 20° E.
House of Charles Knowles on the right and west side of Franklin Canon bears N 15° W about 15 chs. dist.,
34.00 Foot of ridge at the junction of canada de las Aguas, which comes in from N. 61° E 5 chs. wide, Franklin canon which comes in from N 10° W. about 3 chs. wide, and Spanish Canon which comes in from N 80 W 3 chs. wide
38.00 Enter dry wash from Franklin canon S 10° W
39.00 Cross do.
40.00 " road N & S.
45.95 The stump of the Elder S.A. 8, Station of the Rancho San Antonio bears S 52½° W 223 lks. dist.
The true bearing from the Sycamore S.A. 7 to the elder stump S.A. 8 Station is S 37° 28' W 48.10 chs. dist.
The difference from the official course being so much at variance with my measurements that I retrace the line N 37° 28' E and at 48.12 chs. to the Sycamore S.A. 7, Station, which corresponding so nearly with my first measurement I take 48.11 chs. as the mean of the two for the true distance, thence, S. 48½° W. from S.A. 8 Station of the Rancho San Antonio along the line of the official survey of the same.
5.50 Cross road at foot of hill runs S 80° E and N 80° W
8.50 Top of hill
13.00 Cross road at foot of hill N.W. and S.E.
16.00 Top of hill N.W. and S.E.
19.60 Cross a dry Ravine 60 lks. wide, course S. 15° E
27.00 Top of hill N.W. and S.E.
29.50 Cross sandy gully 20 lks wide, course S 20 E.
31.00 Top of hill N.W. and S.E.
36.50 Cross deep dry ravine 50 lks wide, course S. 30 E.
41.00 Top of hill N 20° W. and S. 22 E.
46.00 House of E. A. Benedict N 41½° W.
48.80 Foot of hill and enter bottom land runs South and North 20° W.
51.80 Cross Road N 30 W and S. 30° E.
61.34 Black walnut post marked S.A. No. 9 Station of Rancho San Antonio bears S. 41½° E 16 lks. dist., making the true course from Stations 8 to 9, S. 48° 21 W. 6134 chs. dist.
From the Black Walnut stake S.A. No. 9 Station Black Walnut tree 20 in. dia., bears N. 29½° W 228 lks.
The house E.A. Benedict bears N 15° E.
To prove the correctness of the position of the stake S.A. No. 9 Station - I run,

South on line bet. RANCHOS SAN ANTONIO and SAN JOSE DE BUENOS AYRES,

3.80 To foot of low hill,
5.00 Top of hill and run over rolling table land
11.50 Cross dry Arroyo 20 lks wide, course S.E.
20.00 To a pile of stones as marked on the Exhibit Map for Station 10 of Rancho San Antonio and Station 8 of Rancho San Jose de Buenos Ayres, thence, East between the aforesaid ranchos.
0.50 Cross road, course N 70° E and S 80° W
3.00 Cross dry Arroyo last mentioned 20 lks wide, course S. 15° E.
20.00 To a pile of stones designated as Station 11 of Rancho San Antonio and Station 7 of Rancho San Jose de Buenos Ayres,

FRAC. TP. 1 S. R.15 W., S. B. M.
Rancho San Antonio
and
San Jose de Buenos Ayres Rancho.

From the last two lines by having proven the correctness of the position of Station 9, of the Rancho San Antonio and also Station 9 of the Rancho San Jose de Buenos Ayres,
I run from the same West along the line of the said rancho San Jose de Buenos Ayres

- 1.50 Foot of hill, Ascend.
3.50 Top of hill, bearing N. and S.
6.50 Foot of hill and cross a dry wash 20 lks. wide, course S. 20° E.
10.00 Top of low ridge, N. & S.
14.00 Foot of low ridge and ascend across North slope of another ridge
18.00 Top of slope
20.00 Set an Elder post 40 x 4 x 4 and 15 in. deep S.J.B.A. 10 Station and raised a mound of earth with pits East and North 20 x 20 & 12 in. deep, thence,
North,
1.50 Brow of hill and descend
3.50 Foot of same and cross a dry gully 20 lks. wide, course S.E.
8.50 Top of hill E. & W.
10.00 Foot of hill.
12.50 Top of hill.
16.50 Cross canon 150 lks. wide, and ascend,
Course S.E.
20.00 Top of hill and set an elder post 40 x 2 x 2 and 15 in. deep S.J.B.A. 11, Station and raised a mound of earth with pits on the line, 20x20 and 12 in. deep, thence west,
3.50 Brow of hill and descend.
6.50 Cross same, canon course S. 20 E 100 lks. wide at foot of hill.
13.50 Top of hill N. & S. and descend.
16.50 Cross a deep gully 20 lks. wide,
Course S 10° W comes from N 80° W,
Ascend across N. slope of hill.
20.00 Set an elder post 40 x 2 x 2 and 15 in. deep S.J.B.A. 12 Station and raised a mound with pits on the lines 20 x 20 and 12 in. deep, thence North
3.00 Cross same gully 40 lks. wide, course S. 80 E.
8.50 Top of hill and run over rolling table land
20.00 Set a sand rock 18 x 9 x 6 and 8 in. deep S.J.B.A. 13, Station in a mound of sand rock,
thence N 81½° W.
7.00 Cross a dry ravine 50 lks. wide, course S.E.
14.00 Foot of ridge.
18.50 Top of ridge N 10 E and S 15 W.
21.50 Cross dry gully 10 lks wide in the East branch of the Arroyo Seco.
22.50 Cross dry branch of Arroyo Seco.
23.00 Set an Elder post 40 x 2 x 2 and 15 in. deep S.J.B.A. 14 Station and S.V.S.M. 25 Station of the Rancho San Vicente y Santa Monica.
Raise a mound of conglomerate rock with 30 in. base and 30 in. high.
I found no mounds, or posts, at any of the Stations after leaving Sta. No. 9 of San Jose de Buenos Ayres,
November 9th, 1876.

FRAC.TP. 1 S., R. 15 W., S.B.M.
BET.RANGES 14 & 15 WEST.

From the corner to Sections 7,12,13,18, I run
North on the East Boundary of Sec.12,
Var.15°06' East.

- 7.50 Foot of hill.
- 12.45 An old mound of earth and stone
- 13.50 Top of ridge, course N 25° E.
- 16.80 Cross summit of ridge and run across west slope of same.
- 29.00 Foot of ridge and enter canon, course S.12° W.
- 35.00 The center of a mouth of canon 3 chs.wide bears N 40° E. 4 chs.
dist, comes in from the N.E.
- 40.00 Set a sycamore post 36 x 2 x 2 and 12 in.deep for $\frac{1}{4}$ sec.cor.and
raised a mound of sand rock with 30 in.base and 24 in.high
- 42.00 Leave canon, coming from N 6° E. and ascend across the steep East
slope of Ridge forming the west side of canon.
- 54.50 Top of ridge, S.10° W and N 22° E.
- 56.00 Leave ridge and across the steep west slope of do.
- 58.00 A spring at the mount of a dry ravine running S.W.bears N.69° W.
3 chs.dist.
- 62.00 Cross the dry Ravine 40 lks.wide, runs S.W.
- 65.50 Summit of spur E.& W.
- 68.50 Cross dry Ravine at the foot of spur, 30 lks. wide, S.50° W.
- 71.00 Cross the west end of spur
- 76.50 Cross dry Ravine 40 lks.wide, course S.75° W.
- 80.00 Set a sumach post 48 x 3 x 3 and 18 in.deep and raised a mound of
quartz and slate rock with 30 in.base and 30 in.high for cor.to
Secs.1,6,7,12,
Land broken and hilly with sage brush and scattering chaparral,
soil 3rd rate.
Note: The variation at 54 chs.was 15° 15' E.

North on the East boundary of Sec.1,
Var.15° 15' E.

- 1.50 Top of ridge bears N 10° E and S.W.
- 10.00 Foot of west slope of do.
- 14.00 Cross canada 50 lks.wide, runs S.10° W.
- 23.50 Top of ridge E.and W.
- 32.00 Foot of same ridge, and enter small valley which heads N 60 E.about
15 chs.
- 38.50 Cross valley and ascend ridge, course of valley S 70 W.
- 40.00 Set a Palo Colorado post 36 x 2 x 2 and 12 in.deep and raised a
mound of stone with 20 in.base and 24 in high for $\frac{1}{4}$ sec.cor.
- 44.50 Top of ridge N 60° E and S 60° W.
- 49.00 Foot of ridge and enter small valley, which bears East 15 chs.
dist and runs S 56° W.
A small wood house bears N 70° E 2.50 chs.dist.
- 52.00 Cross valley and ascend.
- 61.00 Top of ridge.
- 70.00 Cross summit and descend.
- 80.00 Set an elder post 48 x 4 x 4 and 20 in.deep and raised a mound of
sand rock with 30 in.base and 36 in.high for closing corner to
Secs.1 and 6 on base line,
Land broken and hilly, soil 3rd rate, bushy.

West, on the North Boundary of Sec.1,
Var.15°15' E.

- 0.37 A flag which I caused to be placed at the established cor.to Secs.
25,30,31,36, Tp.1 N., Rs.14 & 15, W. on the South slope of a high
hill, about 1 ch South of its summit bears North,
Set an Elder post 48 x 4 x 4 and 20 in.deep for standard cor.to
Secs. 36 and 31, in a mound of sand rock with a base of 30 in.and
36 in.high.
- 10.00 Cross a deep ravine 50 lks.wide, course N 20 E.

FRAC. TP. 1 S., R. 15 W., S.B.M.

17.00 Top of hill runs N & S.
 22.50 Cross a dry ravine, 20 lks wide, course N 85° W and run along N. face of hill.
 27.00 Cross a dry gully 20 lks. wide, course North
 33.00 Enter main Ravine 50 lks wide, course West
 35.00 Leave main ravine, course N 84° W.
 40.00 To a Palo Colorado tree 4 in. dia. for $\frac{1}{4}$ sec. cor.
 48.00 Cross the summit of a low ridge, course N 30° W. and S. 30° E.
 52.00 Cross a dry ravine 20 lks. wide, course N.W.
 60.00 Set a sand rock 16 x 8 x 8 - 8 ins. deep in a mound of sand rock for cor. to fractional Sec. 1,
 Land hilly and broken with dense brush, soil 3rd rate.

NOTE: At the $\frac{1}{4}$ sec. cor. the angle from the flag at the cor. to Secs. 25, 30, 31, 36, to the base line is 63° 38' 50" which makes the distance from said cor. to the standard cor. to Secs. 36 and 31 = 80.00 chs.

The roughness of the country and dense growth of brush renders it impracticable to continue the line any farther west on south.

November 10th, 1876.

From the corner to Secs. 7, 12, 13, 18, I run West on true line bet. Secs. 12 and 13, Var. 15° 06' E.
 2.38 Intersected line of Rancho San Antonio and Set a redwood post 40 x 4 x 4 and 15 in. deep and raised a mound of earth with pits on the lines each 20 x 20 and 12 in. deep for cor. to Frac. Secs. 12 and 13, from which the post at the cor. to frac. Secs. 13 & 18, bears S. 69° 51' E. 2.53 chs. dist. and the stake in the mound of stones at Station 6 of Rancho San Antonio bears N. 69° 51' W. 15.69 chs. dist.
 I continue the line West in Rancho San Antonio with the distance from the corner of the Sections, started from and at
 4.50 Cross road, N. 60° W. and S. 75° E.
 7.50 Cross road from the House of Charles Lindley, runs S. 5° W.
 8.00 To edge of bank and descend.
 11.50 Cross ravine 40 lks wide and S. 20° W
 15.00 Cross another ravine 30 lks wide, runs S. 10° E.
 17.70 Top of low hill N & S.
 18.50 To cacti patch North 70 lks and south 100 lks
 21.00 Leave cacti and run along the south base of the hills from the coast range of mountains.
 39.50 Cross dry ravine
 40.00 Point for $\frac{1}{4}$ sec. cor. raised a stone mound.
 41.50 Top of hill, N. & S.
 The variation here changes to 15° 15' E.
 60.00 Summit of spur N.E. and S. 20° W.
 65.00 West brow of spur and descend.
 69.00 Foot of spur and enter canada de las agaus, course South.
 73.75 Intersected line of Rancho San Antonio and set an Elder post 40x3x3 and 15 in. deep and raised a mound of earth with 3 pits on the lines each 20 x 20 and 12 in deep for cor. to Secs. 12 and 13, from which the elder stump at Sta. S.A. No. 8 bears S. 37° 28' W. 1.86 chs. dist.
 76.00 Leave canada de las aguas and ascend low hill
 80.00 Top of hill and set a black walnut post 48 x 3 x 3 and 18 in. deep and raised a mound of Slate rock with 30 in. base and 30 in. high for cor. to Secs. 11, 12, 13, 14,
 Land outside of Rancho, broken and hilly, with scattering sage & chaparral
 Soil 3rd rate.

FRAC.TP.1 S.,R.15 W.,S.B.M.

South bet.Secs.14 and 13,
Var.15°15' E.
1.50 Brow of hill and descend.
3.00 Enter a canon at foot of hill
5.00 Cross road at foot of hill, ascend.
6.00 Intersected the line of Rancho San Antonio and set an elder post
40x2x2 and 15 in.deep and raised a mound of earth with 3 pits on
the lines each 20 x 20 and 12 in deep for corner to frac.Secs.
13 and 14, from which the elder stump at Station S.A.No.8,bears
N.48° 21' E. 6.78 chs.dist.
Land broken,soil 3rd rate.

From the cor.to Secs.11,12,13,14, I run
North bet.Secs.11 and 12,
Var.15°15' E.
0.50 Brow of hill and descend
1.50 Foot of hill
2.00 Cross canon 50 lks wide,S.E.
12.00 Top of ridge N 80° W and S 80 E.
19.50 Foot of ridge and enter Spanish canon,comes from N 5° W. and S.
60° E about 10 chs.to Franklin canon,running South. Spanish
canon is about 5 chs.wide.
24.50 South point of ridge East 3.50 chs.dist.
27.00 Foot of west slope of ridge and ascend.
40.00 Set a black oak post 36 x 2 x 2 and 12 in.deep in a mound of earth
and stone with pits 18 x 18 and 12 in.deep for $\frac{1}{4}$ sec.cor.
47.00 Summit of ridge bears N 25° W and south
53.00 Cross summit and descend across the steep east slope.
75.00 Foot of east slope and enter Franklin Canon,which comes in from N.
10° W and runs S 20° E.
78.50 Cross canon and ascend low spur
80.00 Top of spur,bears West 150 lks and East to high ridge.
Set a conglomerate quartz rock 22x16x14 and 10 in.deep for cor.to
Secs.1,2,11,12,
Land hilly and broken,the ridges are covered with scattering
sage and chaparral brush,soil 3rd rate.

East on a random line bet.Secs.1 and 12,
Var.15° 15' E.
4.00 Leave spur and ascend the steep west slope of high ridge.
12.00 Summit of ridge N & S.
14.00 Cross summit and descend
18.50 Cross a dry ravine 40 lks wide,course S 20° W.
28.00 Summit of high ridge
29.50 Cross summit and descend.
38.50 Foot of ridge and enter canada de las aguas,course S 20° W.
40.00 Set a temp. $\frac{1}{4}$ sec.post.
45.00 To the East side of canada and enter a canon 3 chs.wide,course West
51.50 Foot of ridge at head of canon and ascend steep west slope.
63.00 Summit of ridge N 10° E and S 10° W
64.50 Cross summit and descend
71.00 Enter ravine in canada S.
72.00 Cross canada S 10° W.
75.00 Ascend across S slope of hill
80.32 Intersected E boundary of Township 9 lks North of cor to Secs.1,6,
7,12, from which cor. I run,

North 89° 56' W.on true line bet.Secs.1 and 12,
Var.15°15' E.

FRAC.TP.1 S., R.15 W., S. B. M.

- 40.16 Set a black walnut post 40 x 2 x 2 15 ins. deep and raised a mound of earth with pits each 18 x 14 and 12 in. deep for $\frac{1}{4}$ sec. cor.
House of A.T. Tullis bears N $43\frac{1}{2}^{\circ}$ E. 8.00 chs.
80.32 The cor. to Secs. 1, 2, 11, 12,
Land hilly and broken with chaparral.
And sage brush; soil: 3rd rate.

I find it impracticable to continue my survey either North or West owing to the rough character of the country, I, therefore, proceed to the $\frac{1}{4}$ sec. cor. bet Secs. 1 and 12, and run North in Sec. 1.

Var. $15^{\circ}15'$ E.

In Canada de las Aguas.

- 26.00 To foot of East slope of Ridge and ascend.

- 40.00 Set an elder stake 24 x 2 x 2 and 10 in. deep in a mound of sand rock,

Finding it impracticable to measure accurately the line any further North owing to the roughness of the country I run West on a true line,

Var. $15^{\circ}15'$ E.

- 10.00 Summit of hill

- 14.00 Cross summit

- 16.00 Cross a dry ravine 40 lks wide, runs S.W.

- 20.00 Set a conglomerate sand rock 24 x 10 x 8 and 12 in. deep and raised a mound of said rock for fractional Sec. 1.

Land on the last two lines hilly and broken, Soil 3rd rate. I discontinue the line any farther or north as it is impossible to measure accurately owing to the broken character of the country.
November 11th, 1876.

From the corner to Secs. 11, 12, 13, 14, I run, West bet. Secs. 11, and 14,

Var. $15^{\circ}15'$ E.

- 1.00 Brow of hill and descend.

- 2.50 Foot of hill and enter canon N.W. and S.E.

- 10.00 Cross canon and ascend low ridge.

- 12.50 Summit of ridge N 40° W and S.E.

- 20.50 Cross head of dry gully 20 lks wide, course S.E.

House of L.K. Riley N 40° E about 12 chs

- 22.00 Top of low ridge N & S.

- 28.00 Descend into canon.

- 29.50 Enter Pea Vine canon S 30° W.

- 32.50 Cross canon and ascend ridge N 25° E. and S. 30° W.

- 36.00 Top of ridge.

- 38.00 Cross summit and descend west slope of ridge

- 40.00 Set an elder post 40x2x2 and 15 in. deep and raise a mound of slate rock with a base of 30 in. and 30 in. high for $\frac{1}{4}$ sec. cor. on the west slope of hill

- 42.50 Cross a dry gully 20 lks wide, course South.

- 44.00 Summit of ridge N & S.

- 46.00 Foot of ridge and enter ravine.

- 51.00 Cross ravine, course S. 20 E.

- 56.00 Summit of hill, N. and S. Descend.

- 69.00 Foot of hill and enter Benedict Canon, comes from N 30° W and runs S.E.

FRAC.Tp. 1 S., R. 15 E., S. B. M.

62.00 Cross road N & S.
 70.00 Cross canon and ascend across North base of table land.
 80.00 Set a Black Walnut post 48 x 3 x 3 and 18 in. deep and raised a mound of sand rock for corner to Secs. 10, 11, 14, 15, Land hilly with sage and chaparral brush, Soil 2nd rate.
 House of P.E. Benedict N 30 E 21 chs. dist.

South bet. Secs. 14 & 15,
 Var. 15° 15' E.
 1.00 Top of table land
 2.34 Station 13 of Rancho San Jose de Buenos Ayres, West 70 lks.
 16.00 Brow of table land & descend.
 19.50 Cross a dry ravine 30 lks wide, comes from N 80 W runs on the same course 100 lks and turns to S 10° W and ascend
 22.34 Intersected line of Rancho San Jose de Buenos Ayres 70 lks. East of Sta. 12
 Set an Elder post 40 x 2 x 2 and 15 in deep and raised a mound of sand rock for cor. to Frac. Secs. 14 and 15, on the North face of hill 50 lks. North of Summit.
 Land rolling table land with good pasturage, soil 2nd rate.

From the corner to Secs. 10, 11, 14, 15, I run
 West bet. Secs. 10 and 15,
 Var. 15° 15' E.
 2.00 Foot of hill and ascend.
 4.00 Top of hill N. and S.
 6.00 Cross summit and descend.
 10.00 Cross a dry ravine 50 lks. wide, course S.E.
 12.00 Cross road N.E. and S.W.
 16.91 Intersected line of Rancho San Jose de Buenos Ayres, from which Station 13 bears S. 81½° E 16.33 chs. dist.
 Set a Black walnut post 48x3x3 and 18 in. deep and raised a mound of earth with 3 pits on the lines each 18 x 18 and 12 in. deep for cor. to Frac. Secs. 10 and 15, at foot of ridge,
 Land rolling and broken soil 2nd rate.

From the corner to Secs. 10, 11, 14, 15, I run,
 North bet. Secs. 10 and 11,
 Var. 15° 15' E.
 1.50 Foot of hill E. & W.
 4.00 Cross a narrow valley S.E. and ascend across the East slope of a high bushy ridge,
 28.00 Descend across East slope of Ridge.
 40.00 Set an Elder post 40 x 2 x 2 and 15 in deep in a mound of slate rock with a base of 20 in. and 30 in. high for ¼ sec. cor.
 43.00 Foot of ridge and enter Benedict Canon, comes from N 40° W and runs S. 20° E.
 47.50 Cross canon and ascend.
 52.00 Cross low spur of Ridge, S.W.
 54.00 Cross a dry gully 20 lks wide, S.W.
 58.50 Top of ridge N.E. and S.W.
 60.00 Set a sand rock 15 x 9 x 7 and raised a mound of sand rock with a base of 20 in. and 25 in. high for cor. to frac Secs. 10 and 11.
 Land rough and hilly, with sage and chaparral brush. Soil 2nd rate.
 November 13th, 1876.

+++++

FRAC.TP.1 S.,R.15 W.,S.B.M.

From the $\frac{1}{4}$ sec.cor.bet Secs.11 and 14, I run
North in Sec.11,
Var.15°15' E.

Ascending across West slope of ridge
3.00 Ascend South slope of ridge
18.50 Leave S.slope and run across the East slope,
House of Carlos Moreno bears S 88° E 8 chs. dist.at foot of slope
in canon,
23.00 Cross a spur,running East into Pea vine Canon,
25.00 Foot of spur
38.00 Foot of E.slope of Main Ridge and enter Pea Vine Canon.
40.00 Set an Elder post, 40 x 2 x 2 and 15 in. deep marked for $\frac{1}{4}$ sec.cor.
on its 4 sides, and raised a mound of fermigenous sand rock with
a base of 20 in. and 24 in.high for the center of Sec.11
46.00 Cross Road in canon N 25° W. and S.20° E.
53.50 Cross Pea Vine Canon S 15° E and ascend across the west slope of
Ridge,
60.00 Set a live oak pest 30 x 2 x 2 and 12 in.deep and raised a mound of
sand rock.
Land hilly and broken and covered with sage and chaparral brush.

Owing to the rough character of the country I do not continue this
line any further North but run

West descend steep west slope of ridge
7.50 Into Pea vine canon
12.60 Cross Road N.W.and S.E.
13.50 Leave canon and ascend steep East slope of Ridge
20.00 Raised a mound of sand rock
From this point it is too rough and brushy to accourately measure any far
ther West on North.

This fractional Township is principally of rough bushy and broken
hills - a small portion lying in fractional Sec.14 is rolling hills
and table land. The balance of the Township which is unsurveyed is
very bushy and broken and is totally unfit for cultivation with the
exception of some very small areas in the narrow canons.

Survey ended November 14th,1876.

LIST OF NAMES.

A list of the names of the individuals employed to assist in running,
measuring, or marking the lines and corners described in the foregoing
Field Notes of Frac.Township 1 South,Range 15 West,San Bernardino
Base and Meridian showing the respective capacities in which they
acted.

.....Compassman.
ALBERT G.RUXTON,.....Chainman.
D. C. CAGE,.....Chainman.
.....Axeman.

FINAL OATHS OF ASSISTANTS.

We hereby certify that we assisted Wm.P.Reynolds,Deputy Surveyor,
in surveying the fractional Township 1 South, Range 15 West, San
Bernardino Base and Meridian, and that said Survey has been in all
respects, to the best of our knowledge and belief,well and faith-
fully surveyed,and the boundary monuments planted according to the
instructions furnished by the Surveyor General.

D. C. CAGE
ALBERT G.RUXTON

FRAC. T. 1 S., R. 15 W., S. B. M.

SUBSCRIBED AND SWORN to before me this 14th day of November, 1876.

J.J. WARNER,
Notary Public

FINAL OATH OF DEPUTY SURVEYOR.

I, Wm. P. Reynolds, Deputy Surveyor, do solemnly swear that in pursuance of a contract with H. G. Rollins, United States Surveyor General for California, bearing date the _____ day of _____, 1876, I have well, faithfully and truly, in my own proper person, and in strict conformity with the instructions furnished by the Surveyor-General, the Surveying Manual, and the laws of the United States, surveyed all those parts or portions of Fractional Township 1 South, Range 15 West, San Bernardino Base and Meridian, as are represented in the foregoing Field Notes as having been surveyed by me and under my directions; and I do further solemnly swear that all the corners of said surveys have been established and perpetuated in strict accordance with the Surveying Manual and printed instructions, and that the foregoing are the true and original Field Notes of each Survey.

WM. P. REYNOLDS, U.S. Deputy
Surveyor.

SUBSCRIBED AND SWORN to before me, this 14th day of November, 1876.

J.J. Warner,
Notary Public.