

Copied from Photographic Copies
furnished by
U.S. General Land Office,
Washington, D. C.

Note, -

Red lines run by M^W M. F. Reilly - 1895

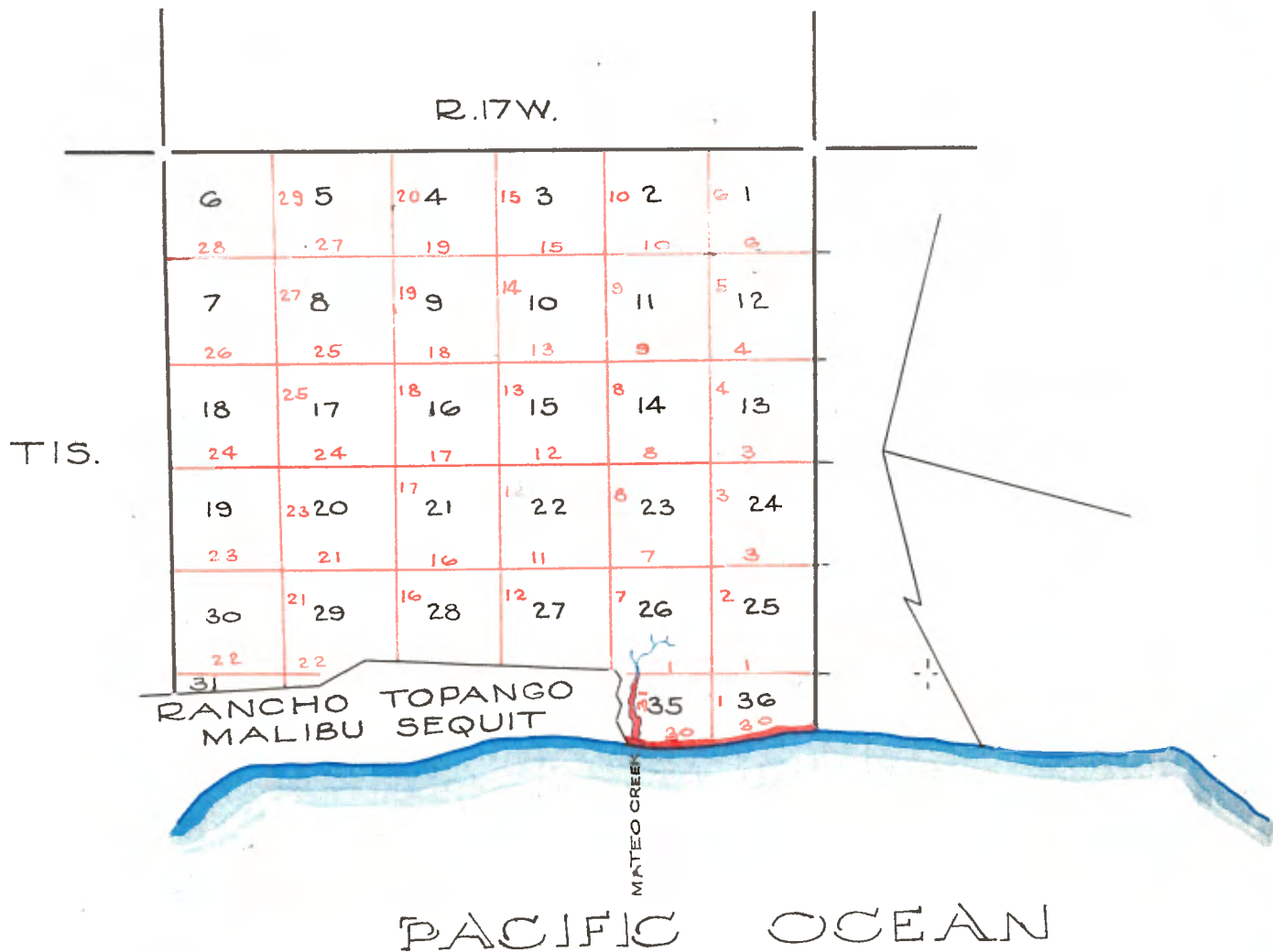

SUBDIVISIONS T.1 S.,R.17 W.,S.B.M.

From the cor.to Secs.25,30,31,and 36, on E.Boundary of Tp.previously described, I run,
West on a true line bet.Secs.25 and 36,
Var.14° 36' East.
Ascend.

6.50 Cross trail bears N.W. and S.E.
7.00 Top of spur bears N.50° W. and S.50° E and descend.
9.75 Cross gulch, 4 lks.wide,course S. and ascend.
12.00 Top of spur bears N.and S. and descend.
27.50 Cross gulch, 5 lks.wide,course S. and ascend.
29.00 To foot of perpendicular bluff impossible to chain: to avoid same, I offset N.25 lks.,thence W.100 lks.,
Thence,S.25 lks.to true line and continue W.counting distances from cor.to Secs.25,30,31,and 36,
38.24 Top of spur,bears N.and S. and descend.
40.00 Set a sandstone 26 x 15 x 9 ins.19 ins.in the ground for $\frac{1}{4}$ sec.cor., marked $\frac{1}{4}$ on N.face and raised a stone mound alongside.
Pits impracticable.
44.85 Cross gulch, 3 lks.wide,course S.10° W. and ascend.
47.00 Top of spur bears N.E. and S.W. and descend
50.22 Cross canon 12 lks.wide,course S.and ascend
55.50 Top of spur bears N.and S. and descend
63.00 Enter rolling land,bears N and S
69.42 A Cabin,bears N 5 lks.dist.
70.96 Cross gulch, 4 lks.wide,course S. and ascend.
75.50 Top of high hill, bears N.W. and S.E. and descend
78.04 Cross gulch, 3 lks wide,course S.45° E and ascend
80.00 Set a cement stone 26 x 14 x 10 ins.19 ins.in the ground for cor.to Secs.25,26,35,and 36,marked with 1 notch on S.and E.edges and raised a stone mound alongside.
Pits impracticable.
Land for E.60.00 chs.broken and mountainous.
Remainder rolling hills.
Soil 3rd rate.
Scattering oak timber and dense undergrowth of chaparral.

South on a true line bet.Secs. 35 and 36,
Var.14° 30' East.
Ascend

4.00 Top of ridge bears N 55° W and S 55° E and descend
5.60 Cross road bears N 25 W and S.25° E.
40.00 Set a sandstone 22 x 18 x 12 ins.16 ins. in the ground for $\frac{1}{4}$ sec.cor., marked $\frac{1}{4}$ on W.face and raised a stone mound alongside.
Pits impracticable.
41.10 To a point near high water mark on the shore of the Pacific Ocean and set a sandstone 28 x 12 x 12 ins.21 ins.in the ground for Meander cor.to Fractional Secs.35 and 36, marked M.C.with 1 notch on E.and 5 notches on W.edges and raised a stone mound alongside.
Pits impracticable.
Land broken and mountainous.
Soil 3rd rate.
Scattering oak timber and dense undergrowth of Chaparral.
October 26, 1895.

From the cor.to Secs.25,26,35, and 36, I run, West on a true line bet. Secs. 26 and 35,
Var.14° 30' East.
Ascend.

CHAINS

SUBDIVISIONS T.1 S., R.17 W., S.B.M.

5.00 Cross wood road bears N.25° W. and S.25° E.
 7.00 Cross wood road on top of ridge, bears N.W. and S.E. and descend.
 17.68 Cross canon, 8 lks. wide, course S. and ascend.
 20.50 Top of spur bears N. and S. and descend.
 22.57 Cross gulch, 4 lks. wide, course S.10° E. and ascend
 26.80 Top of spur, bears N. and S. and descend.
 37.04 Cross canon 6 lks. wide, course S. and ascend.
 40.00 Set a sandstone 16 x 12 x 6 ins. 11 ins. in the ground for $\frac{1}{4}$ sec. cor.,
 marked $\frac{1}{4}$ on N. face
 Dug pits 18 x 18 x 12 ins. E. and W. of stone $5\frac{1}{2}$ ft. dist. and raised an
 earth mound $1\frac{1}{2}$ ft. high, $3\frac{1}{2}$ ft. base alongside.
 45.00 Top of spur, bears N. and S. and descend.
 63.50 Cross gulch, 10 lks. wide, course S.30° W. and ascend.
 65.50 Top of spur bears N.20° E. and S.20° W. and descend.
 68.16 Intersect E. boundary of Rancho Topango Malibu Sequit at a point 4.10
 chs. S.31° E. from cor. No. 2 on Bd. which is a Sycamore 14 ins. dia.,
 marked T.M. No. 2, from which bears a Live Oak 14 ins. dia. S. 60° $\frac{3}{4}$ °
 W. 65 lks. dist., marked T.M.B.T. As this point falls in Mateo Creek
 impossible to mark, I trace line 58 lks. E. and at a distance from cor.
 to Secs. 25, 26, 35 and 36 of
 67.68 Set a sandstone 26 x 18 x 10 ins. 19 ins. in the ground for Witness
 cor. to closing cor. to Secs. 26, and 35, marked,
 W.C.C.C. with 1 notch on S. and 5 notches on N. edges dug pits
 18 x 18 x 12 ins. N.S. and E. of stone $5\frac{1}{2}$ ft. dist and raised an earth
 mound 2 ft. high $4\frac{1}{2}$ ft. base alongside.
 Land mountainous.
 Soil 3rd rate.
 Scattering Oak timber.
 Dense undergrowth of chaparral.

From the cor. to Secs. 25, 26, 35, and 36, I run,
 North, between Sections 25 and 26,
 Var. 14° 30' East.
 Descend.

.25 Cross gulch, 2 lks. wide, course S.E. and ascend.
 1.00 Top of ridge bears E. and W. and descend.
 1.75 Cross low sag, bears E. and W. and ascend.
 16.00 Top of ridge, bears E. and W. and descend
 40.00 Set a sandstone 28 x 14 x 14 ins. 21 ins. in the ground for $\frac{1}{4}$ sec. cor.
 marked $\frac{1}{4}$ on W. face and raised a stone mound alongside.
 Pits impracticable.
 41.00 Cross gulch, 4 lks. wide, course S.E. and ascend
 49.50 Cross road on top of Ridge, bears N.55° E. and S.55° W. and descend
 50.60 Cross head of gulch, course W. and ascend.
 55.50 Top of spur, bears E. and W. and descend.
 65.60 Cross gulch, 4 lks. wide, course N.45° W. and ascend.
 68.00 Top of spur bears N.W. and S.E. and descend.
 79.80 Cross ravine, 6 lks. wide, course N.W. and ascend.
 80.00 Set a sandstone 28 x 20 x 8 ins. 21 ins. in the ground for cor. to Secs.
 23, 24, 25, and 26, marked with 2 notches on S. and 1 notch on E. edges
 from which bears a
 Sycamore 16 ins. dia. N.33 $\frac{1}{2}$ ° E. 21 lks. dist. marked
 T.1 S. R.17 W., S.24, B.T.
 A Sycamore, 14 ins. dia. S. 79 $\frac{1}{4}$ ° W. 11 lks. dist., marked
 T.1 S., R.17 W., S.26 B.T.
 A live oak, 18 ins. dia. S.64 $\frac{1}{2}$ ° E. 12 lks. dist., marked,
 T.1 S., R.17 W., S.25 B.T.
 No other tree within limits.
 Raised a stone mound alongside corner stone
 Pits impracticable.

SUBDIVISIONS, T.1 S., R.17 W., S.B.M.

Land mountainous.

Soil 3rd rate.

Scattering timber of Sycamore and Oak and dense undergrowth of Chaparral.

October 28th, 1895.

East, on a random line bet. Secs. 24 and 25,
Var. $14^{\circ} 15'$ East.

40.00 Set temporary $\frac{1}{4}$ sec. cor.

80.18 Intersect E. Boundary of Tp. 21 lks. N. of cor. to Secs. 19, 24, 25, and 30,
previously described.

Thence I run N, $89^{\circ} 51'$ W. on true line bet. Secs. 24 and 25,

Var. $14^{\circ} 33'$ East.

Descend.

18.80 Cross gulch, 6 lks. wide, course N. 10° E. and ascend.

21.15 Top of spur, bears N. and S. and descend

28.15 Cross road, bears N.E. and S.W.

38.50 Cross fence, bears N.E. and S.W. and enter field

40.09 Set a sandstone 26 x 12 x 9 ins. 19 ins. in the ground for $\frac{1}{4}$ sec. cor.,
marked $\frac{1}{4}$ on N. face from which bears

A Live oak 8 ins. dia. N. $36^{\circ} 49'$ E. 62 lks. dist., marked $\frac{1}{4}$ S.B.T.

No other tree within limits.

Raised a stone mound alongside corner stone

Pits impracticable.

49.00 Top of ridge, bears N.E. and S.W. and descend

55.00 Leave field and cross fence bears N.E. and S.W.

79.85 Cross ravine, 6 lks. wide, course S.W. and ascend.

80.18 The cor. to Secs. 23, 24, 25, and 26.

Land mountainous.

Soil 3rd rate.

Scattering oak timber and dense undergrowth of chaparral.

North, between Secs. 23, and 24.

Var. $14^{\circ} 15'$ East.

Ascend.

28.00 Top of spur bears E. and W. and descend.

38.60 Cross gulch 4 lks. wide, course E. and ascend.

40.00 Set a sandstone 34 x 11 x 9 ins. 25 ins. in the ground for $\frac{1}{4}$ sec. cor.
marked $\frac{1}{4}$ on W. face.,

Dug pits 18 x 18 x 12 ins. N. and S. of stone $5\frac{1}{2}$ ft. dist. and raised
an earth mound $1\frac{1}{2}$ ft. high, $3\frac{1}{2}$ ft. base, alongside.

45.50 Top of spur bears N.W. and S.E. and descend.

51.00 Cross gulch, 3 lks. wide, course S. 60° E. and ascend

80.00 Set a sandstone 26 x 12 x 10 ins. 19 ins. in the ground for cor. to
Secs. 13, 14, 23, and 24, marked with 3 notches on S and 1 notch on
E. edges,

Dug pits in each sec. $5\frac{1}{2}$ ft. dist., and raised an earth mound 2 ft. high,
 $4\frac{1}{2}$ ft. base alongside.

Land mountainous

Soil 3rd rate.

Scattering oak timber and dense undergrowth of chaparral,

October 29th, 1895.

East on a random line bet. Secs. 13 and 24,

Var. $14^{\circ} 14'$ East.

40.00 Set temporary $\frac{1}{4}$ sec. cor.

SUBDIVISIONS T.1 S., R.17 W., S.B.M.

- 79.94 Intersect E. boundary of Tp. 19 lks. S. of cor. to Secs. 13, 18, 19, and 24, previously described
Thence, I run,
S. $89^{\circ} 52'$ W on a true line bet. Secs. 13 and 24,
Var. $14^{\circ} 42'$ East.
Ascend.
- 6.50 Cross trail bears N.E. and S.W.
- 28.00 Top of ridge, bears N.E. and S.W. and descend
- 31.00 Cross low sag, bears N.E. and S.W. and ascend
- 34.50 Top of ridge, bears N. and S. and descend.
- 39.40 Cross gulch, 4 lks. wide, course N.E. and ascend.
- 39.97 Set a sandstone 14 x 12 x 8 ins. 9 ins. in the ground for $\frac{1}{4}$ sec. cor., marked $\frac{1}{4}$ on N. face and raised a stone mound alongside.
Pits impracticable.
- 62.00 Top of ridge, bears N.W. and S.E. and descend.
- 79.94 The cor. to Secs. 13, 14, 23, and 24.
Land mountainous.
Soil 3rd rate.
Scattering oak timber and dense undergrowth of same and chaparral.

North, between Secs. 13 and 14,
Var. $14^{\circ} 14'$ East.
Ascend.

- 1.00 Top of ridge bears E. and W. and descend
- 13.00 Cross gulch 3 lks wide course N.E. and ascend
- 17.50 Top of spur bears N. 55° E. and S. 55° W. and descend
- 25.40 Cross gulch 3 lks. wide, course N.E. and ascend
- 33.00 Top of spur bears N.E. and S.W. and descend
- 37.92 Cross gulch, 3 lks. wide, course N.E. and ascend
- 40.00 Set a sandstone 20 x 16 x 10 ins. 15 ins. in the ground for $\frac{1}{4}$ sec. cor., marked $\frac{1}{4}$ on W. face.,
Dug pits 18 x 18 x 12 ins. N. and S. of stone $5\frac{1}{2}$ ft. dist. and raised an earth mound $1\frac{1}{2}$ ft. high, $3\frac{1}{2}$ ft. base alongside
- 40.20 Top of Sierra Madre de Santa Monica mountains bears N 60° E. and S. 60° W. and descend
- 46.50 Cross ravine, 6 lks. wide course E and ascend
- 54.50 Top of ridge bears E and W and descend
- 62.80 Cross gulch 5 lks wide, course E and ascend
- 69.70 Top of spur bears N.E. and S.W. and descend
- 74.54 Cross gulch 3 lks wide, course E. and ascend
- 76.50 Top of spur bears N.E. and S.W. and descend
- 80.00 Set a sandstone 20 x 14 x 12 ins. 15 ins. in the ground for cor. to Secs. 11, 12, 13, and 14, marked with 1 notch on E. and 4 notches on S. edges.
Dug pits 18 x 18 x 12 ins. in each sec. $5\frac{1}{2}$ ft. dist and raised an earth mound 2 ft. high $4\frac{1}{2}$ ft. base alongside.
Land mountainous
Soil 3rd rate.
Scattering oak timber and dense undergrowth of chaparral.
October 30th, 1895.

East, on a random line bet. Secs. 12 and 13,
Var. $14^{\circ} 30'$ East.

- 40.00 Set temporary $\frac{1}{4}$ sec. cor.
- 80.28 Intersect E. Boundary of Tp. 24 lks. S. of cor. to Secs. 7, 12, 13, and 18, previously described.
Thence, I run,
S. $89^{\circ} 50'$ W on a true line bet. Secs. 12 and 13, Var. $14^{\circ} 42'$ East.
Ascend.

SUBDIVISIONS T.L.S. R.17. W. S.B.M.

1.40 Cross road bears N.E. and S.W.
 1.45 Cross ~~wire~~ fence, bears N. and S.
 3.00 Enter cultivated land bears N and S
 12.50 Cross road and enter vineyard, bears N. and S.
 17.00 Cross road and leave vineyard, bears N. and S.
 17.10 Leave cultivated land, bears N. and S.
 28.00 Top of spur, bears N. 15° E. and S. 15° W. and descend
 30.00 Cross gulch, 6 lks. wide, course N. 10° E. and ascend.
 35.00 Top of spur, bears N. and S. and descend.
 38.75 Cross gulch, 4 lks. wide, course N. 15° E. and ascend
 40.14 Set a sandstone 30 x 14 x 10 in. 22 ins. in the ground for $\frac{1}{4}$ sec. cor.,
 marked $\frac{1}{4}$ on N. face from which bears
 A live oak 15 ins. dia. S. 25° E. 57 lks. dist.
 marked $\frac{1}{4}$ S.B.T.
 A live oak 8 ins. dia. S. 12 3/4° W. 32 lks. dist.
 marked $\frac{1}{4}$ S.B.T.
 51.50 Top of spur bears N. and S. and descend.
 56.00 Cross gulch 4 lks wide, course N 3° W. and ascend.
 63.00 Top of spur bears N. 60° E and S. 60° W. and descend
 67.00 Cross gulch 8 lks. wide, course N. and ascend.
 75.10 Top of spur, bears N.E. and S.W. and descend.
 80.28 The cor. to Secs. 11, 12, 13, and 14,
 Land mountainous.
 Soil 2nd and 3rd rate.
 Scattering oak timber and dense undergrowth of chaparral

North between Sections 11 and 12, Var. 14° 30' East.

Descend

14.50 To foot of perpendicular sandstone rocks impossible to chain. To
 avoid same I offset E 100 lks. thence N. 2.00 chs.
 thence W. 100 lks. to true line counting distance from cor. to Secs.
 11, 12, 13, and 14,
 16.70 Cross ravine, 20 lks. wide, course E. and ascend.
 22.25 Top of spur bears E. and W. and descend.
 27.30 Cross gulch, 3 lks. wide, course E. and ascend.
 28.00 Top of slope bears E. and W. and descend
 28.70 Cross ravine 6 lks. wide, course E. and ascend.
 32.10 Top of low spur bears E. and W. and descend.
 37.50 Cross gulch, 3 lks. wide, course E. and ascend.
 40.00 Set a sandstone 22 x 12 x 6 ins. 16 ins. in the ground for $\frac{1}{4}$ sec. cor.,
 marked $\frac{1}{4}$ on W. face and raised a stone mound alongside.
 Pits impracticable.
 42.00 Top of spur, bears E. and W. and descend.
 45.02 Cross gulch, 3 lks. wide, course S.E. and ascend.
 50.00 Top of spur bears N.W. and S.E. and descend.
 67.80 Cross gulch, 4 lks. wide, course S. 65° E. and ascend
 73.00 Top of high spur, bears E. and W. and descend.
 80.00 Set a sandstone 28 x 16 x 12 ins. 21 ins. in the ground for cor. to Secs.
 1, 2, 11, and 12, marked with 1 notch on E and 5 notches on S. edges
 from which bears,
 A Mancanita 5 ins. dia. S. 87° E. 50 lks. dist. marked T. 1 S., R. 17 W.
 S. 12 B.T.
 A live oak 8 ins. dia. N. 46 3/4° W. 43 lks. dist.
 marked T. 1 S., R. 17 W., S. 2 B.T.
 No other tree within limits.
 Raised a stone mound alongside, corner stone
 Pits impracticable.
 Land mountainous.
 Soil 3rd rate.

SUBDIVISIONS T.1 S., R.17 W., S.B.M.

Scattering oak timber and dense undergrowth of same and chaparral.
Oct.31st,1895.

East on a random line bet.Secs.1 and 12,
Var.14° 36' East.

- 40.00 Set temporary $\frac{1}{4}$ sec.cor.
80.21 Intersect E.boundary of Tp.32 lks.S.of cor.to Secs.1,6,7, and 12,
previously described thence I run
S.89° 46' W on a true line bet.Secs.1 and 12,
Var.14° 30' East.
Descend.
2.38 Cross gulch 4 lks wide,course S.25° E and ascend.
11.00 Top of spur,bears N.25° W and S.25° E and descend.
18.75 Cross gulch,5 lks.wide,course S.25° E.and ascend
29.00 Cross road on top of spur bears N 30° W.and S.30° E. and descend.
37.25 Cross gulch,3 lks.wide,course S 20° W and ascend
40.10 Set a sandstone 34 x 18 x 8 ins. 25 ins.in the ground for $\frac{1}{4}$ sec.cor.,
marked $\frac{1}{4}$ on N.face and raised a stone mound alongside.
Pits impracticable.
41.50 Top of spur bears N.E. and S.W. and descend.
49.84 Cross gulch,4 lks.wide,course S.and ascend.
56.00 Top of spur bears N.and S.and descend.
68.00 Cross gulch 4 lks wide,course S.W.and ascend
69.00 Top of low spur bears N.and S.and descend.
70.00 Cross Topango creek 20 lks.wide,course S.and ascend
71.00 Cross road,bears N.25° W.and S.25° E.
77.00 Top of spur bears N and S and descend
79.00 Cross gulch 3 lks.wide,course N and ascend.
80.21 The cor.to Secs.1,2,11,and 12,
Land mountainous
Soil 3rd rate.
Scattering oak timber and dense undergrowth of chaparral.

North on a random line bet.Secs.1 and 2,
Var.14° 36' East

- 40.00 Set temporary $\frac{1}{4}$ sec.cor.
80.22 Intersect the San Bernardino Base Line 27 lks.W.of cor.to Secs.1,2,35,
and 36,on N.Bdry of Tp.previously described,thence, I run,
S.12' W.on a true line bet.Secs.1 and 2,
Var.14° 30' East
Descend.
3.70 Cross gulch 5 lks wide,course S.W. and ascend
14.00 Top of spur bears N 60° E and S.60° W. and descend
17.00 Cross gulch 3 lks wide,course S.W.and ascend
21.00 Top of spur bears N.E.and S.W.and descend
25.76 Cross gulch,3 lks.wide,course S.60° W and ascend
30.00 Top of spur bears N.E. and S.W. and descend
30.75 Enter open glade bears N.E. and S.W.
33.70 Leave open glade bears N 20° W and S 20° E
39.50 Cross gulch,2lks wide,course S.20° E and ascend
40.22 Set a sandstone 32 x 20 x 14 ins. 24 ins.in the ground for $\frac{1}{4}$ sec.cor.,
marked $\frac{1}{4}$ on W.face and raised a stone mound alongside.
Pits impracticable.
Cor.set on top of low spur bears E.and W.and descend.
41.00 Cross gulch,4 lks.wide,course E.and ascend.
43.00 Top of low spur bears E and W and descend
46.20 Cross ravine,15 lks.wide,course W.and ascend.

CHAINS

SUBDIVISIONS T.1S. R.17 W., S.B.M.

59.00 Top of spur, bears E. and W. and descend
 62.50 Cross gulch, 4 lks. wide, course N.W. and ascend
 66.50 Top of spur, bears E. and W. and descend
 75.00 Cross road bears N. 60° W. and S. 60° E.
 75.40 Cross Topango creek 20 lks. wide,
 Course E. and ascend
 80.22 The cor. to Secs. 1, 2, 11, and 12,
 Land mountainous
 Soil 3rd rate.
 Scattering oak timber and dense undergrowth of chaparral.
 November 1st, 1895.

From the cor. to Sec. 23, 24, 25, and 26, I run,
 West on a true line bet. Secs. 23 and 26,
 Var. 14° 15' East.

Ascend

.20 Top of low spur bears N and S and descend
 .48 Cross ravine 6 lks. wide, course N. 50° W. and ascend.
 10.00 Top of spur bears N. and S. and descend
 17.20 Cross same ravine 8 lks. wide, course S. 60° W. and ascend.
 39.00 Top of spur bears N 20° E and S. 20° W and descend
 40.00 Set a sandstone 22 x 18 x 14 ins. in a stone mound for $\frac{1}{4}$ sec. cor.,
 marked $\frac{1}{4}$ on N face.,
 Pits impracticable; too rocky to set stone in earth
 50.86 Cross gulch, 2 lks. wide, course S. 15° W and ascend
 58.50 Top of spur bears N.E. and S.W. and descend
 72.40 Enter Mateo canon and cross creek 20 lks. wide, course S. 15° W.
 75.00 Leave Mateo canon bears N. and S. and ascend
 80.00 Set a sandstone 28 x 12 x 9 ins. 21 ins. in the ground for cor. to
 Secs. 22, 23, 26 and 27, marked with 2 notches on S. and E. edges and
 raised a stone mound alongside.
 Pits impracticable.
 Land mountainous.
 Soil 3rd rate.
 Dense undergrowth of chaparral.
 No timber.
 I carefully examined the adjustments of my solar compass today particularly the latitude and reversing apparatus and found them correct.

South on a true line bet. Secs. 26 and 27,
 Var. 14° 06' East

Ascend

2.50 Top of spur bears E. and W. and descend
 15.50 Cross low sag, bears E. and W. and ascend
 20.00 Top of spur bears N. 65° W. and S. 65° E. and descend
 25.14 Cross gulch, 5 lks. wide, course E. and ascend
 (30.00 Top of spur, bears E. and W. and descend
 (35.52 Cross gulch, 4 lks. wide, course N. 85° E. and ascend
 40.00 Set a sandstone 22 x 15 x 7 ins. 16 ins. in the ground for $\frac{1}{4}$ sec. cor.,
 marked $\frac{1}{4}$ on W. face and raised a stone mound alongside.
 Pits impracticable.
 Cor. set on top of spur, bears E. and W. and descend
 60.25 Cross gulch 4 lks. wide course E and ascend
 63.00 Top of spur bears N 40° E and S 40° W and descend
 64.75 Cross gulch, 4 lks. wide, course N. 45° E and ascend
 68.50 Top of spur bears E. and W. and descend
 70.20 Cross gulch, 4 lks. wide, course E. and ascend
 75.62 Intersect N. boundary of Rancho Topango Malibu Sequit 9.64 chs. N. 84°
 09' W. from cor. No. 2 and set a sandstone 18 x 12 x 10 ins. 12 ins. in the
 ground for closing cor. to Secs. 26 and 27, marked C.C. with 2 notches on E. and

SUBDIVISIONS T.1. S., R.17 W., S.B.M.

4 notches on W edges dug pits 18 x 18 x 12 ins. N.E. and W. of stone $5\frac{1}{2}$ ft. dist., and raised an earth mound 2 ft. high, $4\frac{1}{2}$ ft. base alongside.
Land mountainous.
Soil 3rd rate.
Scattering oak timber and dense undergrowth of chaparral.
November 2, 1895.

From the cor. to Secs. 22, 23, 26 and 27, I run,
North, between Secs. 22 and 23,
Var. $14^{\circ} 06'$ East
Descend

8.36 Cross gulch, 3 lks. wide, course E. and ascend
12.00 Top of spur, bears N. 60° W. and S. 60° E. and descend
17.82 Cross gulch, 3 lks. wide, course S. 65° E. and ascend
26.00 Top of spur, bears N.W. and S.E. and descend.
40.00 Set a sandstone 18 x 16 x 8, 12 ins. in the ground for $\frac{1}{4}$ sec. cor., marked $\frac{1}{4}$ on W. face, and raised a stone mound alongside.
Pits impracticable.

51.56 Cross gulch, 5 lks. wide, course S. 70° E. and ascend
68.50 Top of spur, bears N.W. and S.E. and descend
74.04 Cross gulch, 5 lks. wide, course S.E. and ascend.
80.00 Set a sandstone 28 x 12 x 8 ins. 21 ins. in the ground for cor. to Secs. 14, 15, 22, 23, marked with 3 notches on S. and 2 notches on E. edges and raised a stone mound alongside.
Pits impracticable.
Land mountainous
Soil 3rd rate.
Scattering oak timber and dense undergrowth of chaparral

East on a random line bet. Secs. 14 and 23,
Var. $14^{\circ} 15'$ East.

40.00 Set temporary $\frac{1}{4}$ sec cor.
79.92 Intersect N. and S. line 31 lks. S. of cor. to Secs. 13, 14, 23, and 24, thence, I run,
S. $89^{\circ} 47'$ W. on a true line bet. Secs. 14 and 23,
Var. $14^{\circ} 14'$ East.
Descend.
3.10 Cross head of gulch, course S. and ascend
6.00 Top of spur bears N. and S. and descend
20.16 Cross head of gulch, course S. 12° W. and ascend
26.50 Top of spur, bears N. and S. and descend
39.96 Set a sandstone 17 x 15 x 10 ins. 11 ins. in the ground for $\frac{1}{4}$ sec. cor., marked $\frac{1}{4}$ on N. face and raised a stone mound alongside.
Pits impracticable.
44.87 Cross gulch, 3 lks. wide, course S. 10° W. and ascend
59.00 Top of spur, bears N.W. and S.E. and descend.
71.64 Cross Mateo canon 8 lks. wide, course S. and ascend.
79.92 The cor. to Secs. 14, 15, 22, and 23.
Land mountainous
Soil 3rd rate.
Scattering oak timber and dense undergrowth of chaparral.
November 4th, 1895.

North, between Sections 14 and 15,
Var. $14^{\circ} 15'$ East.

SUBDIVISIONS T.1.S., R.17 W., S.B.M.

Ascend
14.00 Top of spur, bears N.W. and S.E. and descend.
21.76 Cross gulch, 4 lks. wide, course S. 40° E. and ascend
40.00 Set a sandstone 27 x 15 x 9 ins. 20 ins. in the ground for $\frac{1}{4}$ sec. cor.,
marked $\frac{1}{4}$ on W. face and raised a stone mound alongside,
Pits impracticable.
45.00 Top of Sierra Madre de Santa Monica mountains, bears N. 70° E. and S. 70° W.
and descend.
76.60 Cross gulch, 4 lks. wide, course W. and ascend.
80.00 Set a sandstone 22 x 14 x 10 ins. 16 ins. in the ground for cor. to Secs.
10, 11, 14, and 15, marked with 2 notches on E. and 4 notches on S. edges
and raised a stone mound alongside.
Pits impracticable.
Land mountainous.
Soil 3rd rate.
Scattering Sycamore and oak timber and dense undergrowth of chaparral.

East on a random line bet. Secs. 11 and 14, Var. 14° 15' East.
40.00 Set temporary $\frac{1}{4}$ sec. cor.
80.19 Intersect N. and S. line 18 lks. N. of cor. to Secs. 11, 12, 13, and 14, thence,
I run,
N. 89° 52' W. on a true line bet. Secs. 11 and 14,
Var. 14° 30' East.
Descend.
5.90 Cross gulch, 5 lks. wide, course N. 10° E. and ascend
9.00 Top of spur, bears N. and S. and descend.
18.77 Cross gulch, 4 lks. wide, course N. 10° W. and ascend
29.74 Top of spur, bears N. and S. and descend
35.73 Cross ravine, 20 lks. wide, course N. 44° E. and ascend
40.09 Set a sandstone 24 x 14 x 10 ins. 18 ins. in the ground for $\frac{1}{4}$ sec. cor.,
marked $\frac{1}{4}$ on N. face and raised a stone mound alongside.
Pits impracticable.
58.72 Top of divide, bears N. 10° E. and S. 10° W. and descend.
80.19 The cor. to Secs. 10, 11, 14, and 15,
Land mountainous
Soil 3rd rate,
Timber of Oak and dense undergrowth of chaparral.
November 5th, 1895.

North between Sections 10 and 11,
Var. 14° 15' East,
Ascend.
.75 Top of low spur, bears N.E. and S.W. and descend.
1.50 Cross gulch, 3 lks. wide, course S.W. and ascend
34.00 To foot of perpendicular bluff 40 ft. high impossible to chain
To avoid same I offset 1.25 chs. E. thence N. 1.25 chs. thence W. 1.25
chs. to true line counting distance from cor. to Secs. 10, 11, 14 and 15,
descend
37.75 Cross gulch 4 lks wide course W and ascend
40.00 Set a sandstone 24 x 12 x 9 ins. 18 ins in the ground for $\frac{1}{4}$ sec. cor.,
marked $\frac{1}{4}$ on W. face and raised a stone mound alongside,
Pits impracticable.
41.40 Top of ridge bears N. 70° E. and S. 70° W. and descend
58.50 Cross gulch 10 lks. wide, course N. 65° E. and ascend
65.00 Top of spur bears N.E. and S.W. and descend.

SUBDIVISIONS T.1.S., R.17 W.,S.B.M.

70.90 Cross gulch 4 lks wide course N.45° E and ascend
 73.75 Top of spur bears E and W and descend
 80.00 Set a sandstone 22 x 12 x 8 ins.16 ins.in the ground for cor.to
 Secs.2,3,10,and 11, marked with 2 notches on E.and 5 notches on S.
 edges and raised a stone mound alongside.
 Pits impracticable
 Land mountainous
 Soil 3rd rate
 Scattering oak timber and dense undergrowth of chaparral.

East on a random line bet.Secs.2 and 11,
 Var.14° 00' East.
 40.00 Set temporary $\frac{1}{4}$ sec.cor.
 79.96 Intersect N and S line 17 lks S of cor.to Secs.1,2, 11, and 12,thence,
 I run, S.89° 53' W on a true line bet.Secs.2 and 11,
 Var.14° 36' East
 Ascend
 4.50 Top of spur bears N and S and descend
 13.50 Cross ravine 6 lks.wide,course N.20° E and ascend
 13.90 Cross road,bears N.and S.
 17.50 Marcett's house bears N 33° E 2.00 chs.dist.
 20.00 To foot of perpendicular bluff on spur bears N and S impossible to
 chain
 To avoid same I offset 50 lks.,thence, S.89° 53' W.2.00 chs.thence,
 N.50 lks.dist.to true line counting distances from cor.to Secs.1,2,
 11, and 12,
 Descend.
 28.00 Cross creek,15 lks.wide,course N.E.and ascend
 29.10 Top of spur,bears N.and S.and descend
 31.48 Cross same creek,15 lks.wide,course S.E.and ascend
 36.00 Top of spur bears N and S and descend
 38.55 Cross same creek 10 lks.wide course N.E.and ascend
 39.98 Set a sandstone 30 x 10 x 8 ins.22 ins.in the ground for $\frac{1}{4}$ sec.cor.,
 marked $\frac{1}{4}$ on N.face from which bears
 A Sycamore 8 ins.dia.N.86° E.180 lks.dist.,
 marked, $\frac{1}{4}$ S.B.T.
 A Sycamore 6 ins dia S 60° E 152 lks.dist.,
 marked $\frac{1}{4}$ S.B.T.
 43.00 Top of spur bears N.W. and S.E. and descend
 45.15 Cross same gulch 5 lks.wide,course S.E. and ascend
 48.00 Top of low spur bears N and S and descend
 50.30 Cross same creek 5 lks wide,course N.E.and ascend
 56.00 Top of spur bears N and S and ascend
 63.60 Cross gulch 6 lks.wide,course N and ascend
 71.50 Top of spur bears N.25° W.and descend
 78.00 Cross gulch 6 lks wide course N and ascend
 79.96 The cor.to Secs.2,3,10,and 11,
 Landmountainous
 Soil 3rd rate,
 Scattering Oak timber and dense undergrowth of chaparral.
 November 6th,1895.

North on a random line bet secs 2 and 3
 Var.14° 00' East
 40.00 Set temporary $\frac{1}{4}$ sec cor
 80.10 Intersect San Bernardino Base Line 8 lks.E.of cor to secs.2,3,34,and 35,
 on N.boundary of Tp previously described,

SUBDIVISIONS T.1 S., R.17 W., S.B.M.

Thence, I run,
S.0° 4' E on a true line bet. Secs. 2 and 3,
Var. 14° 30' East.

Ascend

- 1.50 Top of ridge bears E and W and descend
- 15.00 Cross canon 10 lks. wide, course N 60° E and ascend
- 23.50 Top of ridge bears E and W and descend
- 28.50 Cross canon 10 lks. wide, course E and ascend
- 34.75 Top of ridge bears N 50° E and S. 50° W and descend
- 38.00 Cross gulch 10 lks. wide, course N 85° E and ascend
- 40.10 Set a sandstone 24 x 14 x 9 ins. 18 ins. in the ground for $\frac{1}{4}$ sec. cor.,
marked $\frac{1}{4}$ on W. face and raised a stone mound alongside,
Pits impracticable
- 56.50 Top of spur bears E and W and descend
- 60.50 Cross gulch, 4 lks. wide, course S. 60° W and ascend
- 62.50 Top of ridge bears N. 70° E and S. 70° W and descend
- 65.20 Cross gulch 3 lks. wide course S 60° W and ascend
- 66.25 Top of ridge bears N 60° E and S 60° W and descend
- 68.20 Cross gulch 4 lks wide, course S 30° E and ascend
- 69.00 Top of spur bears E and W and descend
- 74.50 Cross ravine 6 lks. wide, course E. and ascend
- 80.10 The cor. to secs. 2, 3, 10, and 11,
Land mountainous
Soil 3rd rate
Scattering oak timber and dense undergrowth of chaparral
November 7th, 1895.

From the cor. to Secs. 22, 23, 26, and 27, I run,
West on a true line bet. Secs. 22 and 27,
Var. 14° 06' East

Ascend.

- 6.56 Top of ridge bears N.W. and S.E. and descend
- 10.00 Cross wash 10 lks. wide, course N. 80° E. and ascend
- 25.00 Top of ridge bears N. and S. and descend
- 31.00 Cross low sag, bears N. and S. and ascend
- 34.00 Top of spur bears N.E. and S.W. and descend
- 39.00 Cross trail, bears N. and S.
- 40.00 Set a sandstone 28 x 14 x 10 ins. 21 ins. in the ground for $\frac{1}{4}$ sec. cor.,
marked $\frac{1}{4}$ on N face and raised a stone mound alongside
Pits impracticable
- 40.50 Cross gulch 8 lks wide, course NW and ascend
- 42.50 Top of spur, bears N and S and descend
- 55.25 Cross canon 25 lks. wide, course S. 10° W. and ascend
- 56.50 Top of spur bears N and S and descend
- 73.85 Cross canon 10 lks wide, course S and ascend
- 75.00 Top of spur bears N and S and descend
- 80.00 Set a sandstone 30 x 12 x 10 ins. 22 ins. in the ground for cor. to
Secs. 21, 22, 27 and 28, marked with 2 notches on S. and 3 notches on E.
edges and raised a stone mound alongside.
Pits impracticable.
Land mountainous.
Soil 3rd rate.
Scattering oak timber and dense undergrowth of chaparral.

South on a true line bet. Secs. 27 and 28,
Var. 14° 18' East.

Descend

- 7.50 Cross low sag, bears E. and W. and ascend.

SUBDIVISIONS T.1 S., R.17 W., S.B.M.

- 10.00 Top of spur bears E. and W. and descend
 12.00 Cross gulch 10 lks. wide, course W and ascend
 17.50 Top of spur bears N 60° E and S. 60° W. and descend
 25.85 Cross gulch 8 lks. wide, course W. and ascend
 27.75 Top of spur bears N. 35° E. and S. 35° W. and descend
 38.00 Cross canon, 25 lks. wide, course S. 35° E. and ascend.
 40.00 The true point for corner falling on a perpendicular slide impossible to mark, I continue S. 50 lks. and set a sandstone 22x15x9 ins. 16 ins. in the ground for Witness cor. to $\frac{1}{4}$ sec. cor., marked W.C. $\frac{1}{4}$ on W. face and raised a stone mound alongside.
 Pits impracticable.
 50.00 Top of spur, bears E. and W. and descend
 61.50 Cross canon, 6 lks. wide, course E. and ascend
 69.54 Intersect N boundary of Rancho Topango Malibu Sequit 20.92 chs. N. 89° 45' W. from cor. No. 3 on boundary which is a live oak, 12 ins. dia. marked, T.M. No. 3 on S. face and set a sandstone 26 x 18 x 4 ins. 19 ins. in the ground for closing cor. to Secs. 27 and 28, marked, C.C. with 3 notches on E and W edges and raised a stone mound alongside.
 Pits impracticable.
 Land mountainous.
 Soil 3rd rate.
 Scattering oak timber and dense undergrowth of chaparral
 November 8, 1895.

- From the cor. to Secs. 21, 22, 27 and 28, I run,
 North between Secs. 21 and 22, Va. 14° 18' East.
 Ascend.
 18.00 Top of spur bears N.W. and S.E. and descend
 40.00 Set a sandstone 16 x 14 x 14 ins. 11 ins. in the ground for $\frac{1}{4}$ sec. cor., marked $\frac{1}{4}$ on W. face and raised a stone mound alongside
 Pits impracticable
 45.00 To foot of perpendicular bluff impossible to chain
 To avoid same, I offset E. 3.00 chs. thence N. 15.00 chs.
 Thence W. 3.00 chs. to true line counting distances from cor. to Secs. 21, 22, 27 and 28,
 62.00 Cross gulch, 4 lks. wide, course S. 15° E. and ascend
 80.00 Set a granite stone 30 x 16 x 8 ins. 22 ins. in the ground for cor. to Secs. 15, 16, 21, and 22, marked with 3 notches on S. and E. edges and raised a stone mound alongside.
 Pits impracticable.
 Land mountainous.
 Soil 3rd rate.
 Scattering oak timber and dense undergrowth of chaparral.

- East on a random line bet. secs. 15 and 22,
 Va. 14° 15' East.
 40.00 Set temporary $\frac{1}{4}$ sec. cor.,
 79.81 Intersect N. and S. line 22 lks. N. of cor. to Secs. 14, 15, 22, and 23,
 Thence, I run,
 N. 89° 51' W. on a true line bet. Secs. 15 and 22,
 Var. 14° 15' East.
 Ascend.
 5.00 Top of spur bears N and S and descend
 11.00 Cross gulch 3 lks wide, course S 30° E and ascend
 15.00 Top of spur bears NW. and SE. and descend.
 39.90 Set a sandstone 36 x 20 x 8 ins. 37 ins. in the ground for $\frac{1}{4}$ sec. cor.,

SUBDIVISIONS T.1 S., R.17 W., S.B.M.

marked $\frac{1}{4}$ on N. face, and raised a stone mound alongside,
Pits impracticable.

46.00 Cross gulch, 5 lks. wide, course S. 30° E. and ascend
59.00 Top of spur, bears N. 25° W. and S. 25° E. and descend
70.00 Cross head of gulch, course S. and ascend
79.81 The cor. to Secs. 15, 16, 21, and 22,
Land mountainous
Soil 3rd rate
Scattering oak timber and dense undergrowth of chaparral,
November 9th, 1895.

North between secs. 15 and 16,
Var. 14° 15' East

Ascend

.10 To foot of perpendicular bluff impossible to chain
To avoid same, I offset W. 150 lks. thence N. 1.90 chs.,
Thence E. 150 lks. to true line, thence N. counting distance from cor. to
Secs. 15, 16, 21, and 22,
6.50 Top of Sierra Madre de Santa Monica mountains bears E. and W. and
descend.
9.92 Cross gulch, 3 lks. wide, course N. W. and ascend.
11.50 Top of spur bears N. W. and S. E. and descend
13.50 To foot of perpendicular bluff impossible to chain to avoid, which I
offset E. 2.50 chs. thence N. 3.50 chs., thence W. 2.50 chs. to line, thence
N. counting distances from cor. to Secs. 15, 16, 21 and 22.
24.00 Cross gulch, 5 lks. wide, course W. and ascend.
25.50 To foot of perpendicular bluff impossible to chain to avoid which I
offset W. 69 lks. thence N. 50 lks.,
Thence E. 69 lks. to line, thence North, counting distances
from cor. to secs. 15, 16, 21, and 22, descend.
28.50 Cross gulch, 3 lks. wide, course N. 65° W. and ascend
31.00 Top of spur bears E. and W. and descend
37.00 Cross gulch, 4 lks. wide, course N. W. and ascend
40.00 Set a sandstone 30 x 20 x 12 ins. 22 ins. in the ground for $\frac{1}{4}$ sec. cor.,
marked $\frac{1}{4}$ on W. face and raised a stone mound alongside,
Pits impracticable.
68.00 Top of spur bears N. W. and S. E. and descend..
71.50 Cross gulch, 5 lks. wide, course N. W. and ascend
72.50 Top of spur bears N. W. and S. E. and descend
78.00 Cross gulch, 3 lks. wide, course N. 25° E. and ascend.
80.00 Top of spur bears N. W. and S. E. and set a sandstone 24 x 16 x 12 ins.
18 ins. in the ground for cor. to Secs. 9, 10, 15, and 16, marked with 4
notches on S. and 3 notches on E. edges and raised a stone mound alongside.
Pits impracticable.
Land mountainous
Soil 3rd rate.
Scattering oak timber and dense undergrowth of chaparral.

East on a random line bet. Secs. 10 and 15,
Var. 14° 20' East.

40.00 Set temporary $\frac{1}{4}$ sec. cor.,
79.80 Intersect N. and S. line 24 lks. N. of cor. to secs. 10, 11, 14 and 15, thence,
I run,
N. 89° 50' W. on a true line bet. secs. 10 and 15,
Va. 14° 15' East.
Descend.
2.54 Cross gulch 2 lks. wide, course S. W. and ascend.

SUBDIVISIONS T.1S., R.17 W., S.B.M.

- 18.00 Enter heavy timber bears N. and S. on top of low spur.
bears N and S and descend.
- 22.00 Cross ravine 6 lks. wide, course N. and ascend
- 24.00 Leave timber bears N and S on top of low spur bears N and S and descend.
- 26.85 Cross gulch, 4 lks. wide, course N and ascend
- 30.50 Top of spur bears N and S and descend.
- 32.00 Cross gulch 3 lks wide, course N and ascend
- 33.75 Top of spur bears N and S and descend.
- 39.90 Set a post 3 ft. long 3 ins. square with marked stone 12 in. in the ground for $\frac{1}{4}$ sec. cor., marked $\frac{1}{4}$ S. on N. face, and raised a stone mound around post,
Pits impracticable.
- 41.50 Cross gulch, 3 lks. wide, course N.W. and ascend.
- 43.00 Top of low spur bears N. and S. and descend.
- 46.22 Cross gulch 5 lks wide, course N.E. and ascend.
- 47.35 Cross road, bears N.E. and S.W.
- 50.00 Top of spur bears N and S and descend
- 54.00 Cross ravine 5 lks wide course N.E. and ascend
- 59.00 Top of spur bears N.E. and S.W. and descend
- 60.90 Cross gulch 4 lks wide, course N.E. and ascend
- 63.50 Top of spur bears N.E. and S.W. and descend
- 66.15 Cross ravine 3 lks. wide, course N.E. and ascend
- 68.30 Top of spur bears N.E. and S.W. and descend
- 72.62 Cross gulch, 3 lks. wide, course N. and ascend
- 74.50 Top of spur bears N.E. and S.W. and descend
- 75.93 Cross gulch, 3 lks. wide, course N.E. and ascend
- 77.30 Top of spur bears N. and S. and descend
- 79.54 Cross gulch 4 lks wide, course N. and ascend
- 79.80 The cor. to Secs. 9, 10, 15, and 16,
Land mountainous
Soil 3rd rate
Heavy oak timber for 6.00 chs. the remainder scattering oak timber and dense undergrowth of chaparral.
November 11th, 1895.

North, bet. Secs. 9 and 10,
Var. $14^{\circ} 20'$ East.
Descend

- 2.00 Enter gulch, course N.
- 2.40 Leave gulch, course N. 20° E. and ascend.
- 23.00 Stunt's house bears E. about 9.00 chs. dist.,
- (30.00 Top of low spur bears E. and W. and descend
- 37.00 Cross gulch, 5 lks. wide, course NW. and ascend.
- 39.80 Top of spur bears E. and W. and descend
- 40.00 Set a post 3 ft. long 3 ins. square 12 ins. in the ground for $\frac{1}{4}$ sec. cor., marked $\frac{1}{4}$ S. on W face from which bears
A sycamore 4 ins. dia N $8\frac{3}{4}^{\circ}$ W. 252 lks. dist.
marked $\frac{1}{4}$ S.B.T.
No other tree within limits.
Dug a pit 18 x 18 x 12 ins. S of post $5\frac{1}{2}$ ft. dist. and raised an earth mound $1\frac{1}{2}$ ft. high $3\frac{1}{2}$ ft base around post Mrs. Dining's house $S. 70^{\circ} W.$
5.00 chs. dist.,
- 42.30 Cross road, bears E. and W.
- 43.00 Cross creek, 15 lks. wide, course W. and over bottom land
- 43.50 Cross dry canon 12 lks wide course S 15° W.
- 47.00 To S bank of same canon, course S.E.
- 48.50 To N bank of same canon, course W. and along W side of small orchard.
- 50.50 Mrs. M. Ellis' house bears S. 77° E. 8.00 chs. dist.,
- 61.00 Cross road bears N. 25° W and S 25° E.

SUBDIVISIONS T.1. S., R. 17 W., S.B.M.

61.85 Cross same canon 10 lks.wide, course S.E.
 62.44 Cross same canon 10 lks.wide, course S.W.
 63.00 Enter cultivated land bears N.20° W. and S.20° E.
 64.15 Cross same canon 12 lks.wide, course S.55° E.
 67.00 Leave cultivated land and bottomland bears E. and W. and ascend
 80.00 Set a sandstone 26 x 12 x 10 ins. 19 ins. in the ground for cor. to
 Secs. 3, 4, 9, and 10, marked with 5 notches on S. and 3 notches on E.
 edges and raised a stone mound alongside.
 Pits impracticable.
 Land mountainous for 40.00 chs. level bottom land for 20.00 chs. remainder
 broken.
 Soil 2nd and 3rd rate.
 Scattering oak and sycamore timber and dense undergrowth of chaparral.

 East on a random line between Sections 3 and 10,
 Var. 14° 48' East.
 40.00 Set temporary $\frac{1}{4}$ sec. cor.,
 80.32 Intersect N. and S. line 16 lks. S. of cor. to Secs. 2, 3, 10, and 11, thence
 I run S. 89° 53' W. on a true line bet. Secs. 3 and 10
 Var. 14° 00' East.
 Ascend.
 1.00 Top of low spur bears N. and S. and descend
 2.32 Cross gulch, 4 lks. wide, course N and ascend
 4.00 To foot of sandstone Bluff 60 ft. high impossible to chain to avoid
 which I offset N. 1.80 chs., thence S. 89° 53' W. 4.25 chs. thence S. 1.80
 chs. to true line, thence S. 89° 53' W. on true line counting distance
 from cor. to secs. 2, 3, 10, and 11, Descend.
 9.00 Cross gulch, 3 lks. wide, course N. 45° E. and ascend.
 11.50 Top of spur bears N. and S. and descend
 14.40 Cross gulch, 3 lks. wide, course N. 15° W. and ascend
 25.50 Top of spur bears N. and S. and descend.
 26.20 Cross gulch, 5 lks. wide, course N. 45° E. and ascend.
 40.16 Set a sandstone 24 x 12 x 10 ins. 18 ins. in the ground for $\frac{1}{4}$ sec. cor.,
 marked $\frac{1}{4}$ on N. face and raised a stone mound alongside. Pits impractica-
 ble.
 Cor. set on S. edges of a sandstone boulder 20 ft. high.
 40.50 Top of divide, bears N. and S. and descend.
 55.50 Cross gulch, 3 lks. wide, course S. W. and ascend
 58.00 Top of spur, bears N. and S. and S. and descend.
 60.15 Cross gulch, 6 lks. wide, course S. 30° W. and ascend
 62.00 Top of spur bears N and S and descend
 69.00 Cross gulch, 4 lks. wide, course S. 20° W. and ascend
 80.32 The cor. to secs. 3, 4, 9, and 10,
 Land mountainous
 Soil 3rd rate
 Scattering oak and sycamore timber and dense undergrowth of chaparral.
 November 12th, 1895.

 North, on a random line bet. Secs. 3 and 4,
 Var. 14° 48' East
 40.00 Set temporary $\frac{1}{4}$ sec. cor.
 79.93 Intersect San Bernardino Base line 39 lks. W. of cor. to Secs. 3, 4,
 33, and 34, on N. boundary of Tp. previously described,
 Thence, I run,
 S. 0° 17' W. on a true line bet. Secs. 3 and 4,
 Var. 14° 30' East.
 Ascend.
 1.10 Top of low spur bears E. and W. and descend
 3.02 Cross gulch, 6 lks. wide, course W. and ascend
 8.10 Dwyer's house bears W. about 6.00 chs. dist.
 28.50 Top of spur bears N. E. and S. W. and descend
 39.10 Cross canon 8 lks wide course S. W. and ascend.

SUBDIVISIONS T.1.S.R.17 W.S.B.M.

- 39.93 Set a sandstone 34 x 14 x 12 ins.25 ins.in the ground for $\frac{1}{4}$ sec.cor., marked $\frac{1}{4}$ on W.face from which bears
A live oak 16 ins.diam.N.34 $\frac{1}{4}$ ° E 68 lks.dist.
marked $\frac{1}{4}$ S.B.T.
No other tree within limits
Raised a stone mound alongside corner stone.
Pits impracticable.
- 43.00 Top of spur bears E.and W.and descend.
- 46.25 Cross canon 8 lks.wide,course W.and ascend.
- 55.50 Top of ridge bears E.and W. and descend
- 61.50 A Mexican's house bears S.41 $\frac{1}{2}$ ° W.
- 68.50 Cross gulch 5 lks.wide,course S.50° W and ascend
- 74.00 Top of spur bears N.E.and S.W.
A Mexican's house bears N.81° W. Descend.
- 79.93 The cor.to secs.3,4,9,and 10,
Landmountainous
Soil 3rd rate
Dense undergrowth of chaparral
No timber
I carefully examined the adjustments ofmy solar compass today particularly the latitude and reversing apparatus and found them correct.
November 13th,1895.

From the cor.to Secs.21,22,27 and 28, I run,
West on a true line bet.Secs.21 and 28,
Var.14° 18' East.
Descend

- 5.00 Cross canon 10 lks.wide,course S.10° E.and ascend
- 35.00 Top of high ridge,bears N.and S.and descend
- 38.00 Cross gulch,4 lks.wide,course S.45° W.and ascend
- 40.00 Top of low spur bears N.and S.
Set a sandstone 24 x 12 x 7 ins.18 ins.in the ground for $\frac{1}{4}$ sec.cor., marked $\frac{1}{4}$ on N.face and raised a stone mound alongside,
Pits impracticable,
Descend.
- 52.50 Cross gulch, 4 lks.wide,course S.30° W.and ascend.
- 53.50 Top of spur bears N and S and descend
- 55.25 Cross gulch 4 lks.wide,course S.15° W.and ascend
- 64.50 Top of spur bears N.and S. and descend
- 70.00 Cross trail bears N.E. and S.W.
- 71.50 Cross gulch 5 lks.wide,course S.and ascend.
- 77.50 Top of spur bears N. and S. and descend
- 8.00 Set a sandstone 24 x 18 x 15 ins.18 ins.in the ground for cor.to Secs.20,21,28 and 29, marked with 2 notches on S. and 4 notches on E.edges and raised a stone mound alongside,
Pits impracticable.
Land mountainous
Soil 3rd rate
Scattering oak timber and dense undergrowth of same andchaparral.

South on a true line between Secs.28 and 29,
Var.14° 21' East.
Descend.

- 3.80 Cross gulch 6 lks.wide,course S.30° E.and ascend
- 9.00 Top of spur bears N.E. and S.W. and descend
- 15.00 Cross same gulch, 6 lks.wide,course S.25° W.and ascend
- 21.00 Top of spur bears N.E. and S.E. and descend
- 27.48 Cross gulch 3 lks.wide,course W.and ascend
- 32.00 Top of spur, bears E. and W. and descend.
- 40.00 Set a sandstone 44 x 16 x 12 ins.33 ins.in the ground for $\frac{1}{4}$ sec.cor., marked $\frac{1}{4}$ on W.face and raised a stone mound alongside.
Pits impracticable.

SUBDIVISIONS T.1 S., R.17 W., S.B.M.

50.00 Enter gulch, course south, comes from N.10° E.
 57.28 Cross gulch 3 lks. wide, course S.30° W. and ascend
 69.28 Intersect N. boundary of Rancho Topango Malibu Sequit 21.03 chs. N.89°
 45' W. from stone set firmly in the ground, marked T.M. 2/80 on S. face
 with a stone mound in good order alongside and set a sandstone 24 x
 12 x 8 ins. 18 ins. in the ground for closing cor. to Secs. 28 and 29,
 marked C.C. with 4 notches on E. and 2 notches on W. edges and raised
 a stone mound alongside.
 Pits impracticable.
 Land mountainous
 Soil 3rd rate.
 Scattering oak timber and dense undergrowth of same, and chaparral.
 November 14th, 1895.

From the cor. to Secs. 20, 21, 28 and 29, I run,
 North between Secs. 20 and 21,
 Var. 14° 21' East.
 Ascend.

.50 Top of spur bears East and West and descend
 3.02 Cross gulch 6 lks. wide, course S.25° W. and ascend.
 4.10 Top of low spur bears E. and W. and descend
 6.92 Cross same gulch 6 lks wide, course S.E. and ascend
 18.85 Cross trail, bears N.W. and S.E.
 32.00 Top of divide bears E. and W. and descend.
 38.80 Cross gulch 3 lks. wide, course N.W. and ascend.
 40.00 Set a sandstone 30 x 16 x 9 ins. 22 ins. in the ground for $\frac{1}{4}$ sec. cor.,
 marked $\frac{1}{4}$ on W. face and raised a stone mound alongside.
 Pits impracticable.
 42.50 Top of spur bears E. and W. and descend.
 50.86 Cross gulch, 3 lks. wide, course N.65° W. and ascend
 57.00 Top of ridge, bears E. and W. and descend.
 68.00 Cross ravine 5 lks. wide, course W. and ascend
 79.50 Top of spur bears N.E. and S.W. and descend
 80.00 Set a sandstone 34 x 16 x 14 ins. 25 ins. in the ground for cor. to
 Secs. 16, 17, 20 and 21, marked with 3 notches on S. and 4 notches on E.
 edges from which bears
 A Live Oak 14 ins. dia. N.49 3/4° E. 50 lks. dist., marked
 T.1 S., R.17 W., S.16, B.T.
 No other tree within limits.
 Raised a stone mound alongside corner stone.
 Pits impracticable.
 Land mountainous.
 Soil 3rd rate.
 Scattering oak timber and dense undergrowth of chaparral.

East on a random line bet. Secs. 16 and 21,
 Var. 14° 20' East.

It being impossible to chain this line on account of perpendicular
 cliffs and bluffs in immediate advance of this point, I offset S.
 8.00 chs. thence E. 2.00 chs. thence N. 8.00 chs.,
 Thence E on a random line counting distance from cor. to secs. 16, 17,
 20 and 21,

40.00 Set temporary $\frac{1}{4}$ sec. cor.,
 79.90 Intersect N. and S. line 24 lks. S. of cor. to Secs. 15, 16, 21, and 22, thence,
 I run S.89° 50' W. on a true line bet. Secs. 16 and 21,
 Var. 14° 15' East.

Ascend.
 10.50 Summit of Sierra Madre de Santa Monica Mountains bears N.25° E. and S.
 25° W. and descend.

SUBDIVISIONS T.1 S., R. 17 W., S.B.M.

23.40 Cross gulch, 3 lks.wide, course S.65° W.and ascend.
 39.95 Top of ^{low} spur bears N.E. and S.W. and set a sandstone 18 x 16 x 6 ins.in
 a stone mound for $\frac{1}{4}$ sec.cor., marked $\frac{1}{4}$ on N.face.,
 Pits impracticable.
 Impossible to sink stone in earth on account of rocks and boulders.
 Descend
 46.74 Cross gulch 2 lks wide, course S.W. and ascend
 58.00 Top of spur bears N. E. and S.W. and descend
 59.00 Cross gulch 4 lks wide, course S.W. and ascend
 59.90 To point of offset
 79.90 True distance to corner to Secs.16,17,20, and 21
 Land mountainous
 Soil 3rd rate.
 Scattering oak timber and dense undergrowth of chaparral.

Nov.15th,1895.

North, between Sections 16 and 17,
 Var.14° 20' East.
 Descend
 5.00 Cross head of gulch, course S.W. and ascend
 10.20 Top of spur bears N.E. and S.W. and descend
 22.00 Cross ravine 6 lks.wide, course S.W. and ascend
 26.50 Leave dense brush bears E.and W.
 35.50 Top of ridge bears N.E. and S.W. and descend
 39.10 Cross gulch 6 lks wide, course N.60° W and ascend
 40.00 Set a granite stone 32 x 18 x 10 ins.marked $\frac{1}{4}$ on W.face for $\frac{1}{4}$ sec.cor.
 in a stone mound,
 Pits impracticable.
 Too rocky to set cor.stone in earth
 43.50 Top of spur bears N.E.and S.W. and descend
 48.58 Cross gulch 3 lks.wide, course S.W. and ascend.
 52.00 Top of spur bears N.E. and S.W. and descend
 70.50 Cross gulch 4 lks wide, course W.and ascend
 75.50 Top of spur bears E.and W.and descend
 80.00 Set a sandstone 26 x 14 x 6 ins.19 ins.in the ground for cor.to
 Secs.8,9,16, and 17, marked with 4 notches on S.and E.edges and
 raised a stone mound alongside.
 Pits impracticable.
 Land mountainous
 Soil 3rd rate.
 Timber of Sycamore and Oak and dense undergrowth of Chaparral for S.
 26.00 chs.

East on a random line bet.Secs. 9 and 16,
 Var.14° 02' East.
 40.00 Set temporary $\frac{1}{4}$ sec.cor.,
 80.11 Intersect N.and S.line 17 lks.N.of cor.to Secs. 9,10,15, and 16,
 Thence, I run,
 N 89° 53' W on a true line bet secs 9 and 16
 Var 14° 20' East
 Ascend
 1.00 Top of spur bears N and S and descend
 3.80 Cross gulch 6 lks wide course N and ascend
 6.00 Top of spur bears N and S and descend
 10.70 Cross ravine 6 lks wide, course N 25° E and ascend
 13.00 Top of spur bears N.E. and S.W. and descend
 16.00 Cross gulch 5 lks wide, course N and ascend
 20.00 Top of spur bears N.E. and S.W. and descend
 33.00 Cross gulch 3 lks wide, course N. and ascend.
 38.50 Top of spur bears N and S and descend.

SUBDIVISIONS T.1 S. R.17 W., S.B.M.

- 39.75 The true point for cor. falling on N slope of steep rocky spur not a suitable place to mark, I set a sandstone 26 x 16 x 9 ins. at this point 30 lks S. $89^{\circ} 53'$ E. of the point for witness cor. to $\frac{1}{4}$ sec. cor. marked W.C. $\frac{1}{4}$ on N face and raised a stone mound alongside.
Pits impracticable
- 47.35 Cross ravine 10 lks wide, course N 25° W and ascend
- 54.00 Top of spur bears N and S and descend
- 71.28 Cross gulch 3 lks wide course N and ascend
- 74.00 Top of spur bears N and S and descend
- 78.80 Cross gulch 3 lks wide, course N 25° W and ascend
- 80.11 The cor. to Secs. 8, 9, 16 and 17,
Land mountainous
Soil 3rd rate
Timber of oak and dense undergrowth of chaparral
November 16th, 1895.

North bet secs 8 and 9

Var $14^{\circ} 02'$

Descend

- 2.10 Cross gulch 4 lks wide course N 50° W and ascend
- 4.77 Top of spur bears N 70° W and S 70° E and descend
- 20.04 Cross canon 50 lks wide course S 85° W and ascend
- 30.50 Top of ridge bears N 70° W and S 70° E
Wernett's house bears S. $73^{\circ} 35'$ W about 3.00 chs. dist.
Descend
- 34.50 Smith's house bears N. $31^{\circ} 44'$ E.
- 39.70 Cross head of gulch course N. 30° W and ascend
- + 40.00 Set a post 3 ft. long 3 ins. square with marked stone 12 ins. in the ground for $\frac{1}{4}$ sec. cor., marked $\frac{1}{4}$ S on W face
Dug pits 18 x 18 x 12 ins. N and S of post $5\frac{1}{2}$ ft. dist., and raised an earth mound $1\frac{1}{2}$ ft high $3\frac{1}{2}$ ft base around post
- 41.00 Top of spur bears N 20° W and S 20° E and descend
- 41.80 Cross road bears N.W. and S.E.
- 50.26 To foot of perpendicular bluff impossible to chain
To avoid same I offset E. 100 lks. thence N. 3.24 chs. thence W. 100 lks. to line, thence N. counting distances from cor. to secs. 8, 9, 16, and 17,
- 55.00 Enter dense chaparral bears E and W
- 57.20 Cross gulch 4 lks wide, course S. 45° W and ascend
- 64.00 Top of spur bears N.E. and S.W. and descend
- 67.05 Cross head of gulch course W and ascend
- 76.50 Smith's house bears S. $25\frac{1}{4}^{\circ}$ E
- 78.25 The true point for cor. to Secs. 4, 5, 8, and 9, falling on a slide not a suitable place to mark at this point 175 lks. S. of true point
I set a post 4 ft. long 4 ins. square with marked stone 12 ins. in the ground for witness cor. to cor. to Secs. 4, 5, 8, and 9, marked,
W.C.T.1.S.S.4. on N.E.
R.17 W.S.9 on S.E.
S.8 on S.W. and
S.5 on N.W. faces with 4 notches on E and
5 notches on S edges
Dug pits 18 x 18 x 12 ins. in each sec $5\frac{1}{2}$ ft dist and raised an earth mound 2 ft. high $4\frac{1}{2}$ ft. base around post
Land mountainous
Soil 3rd rate
Timber of Oak and dense undergrowth of Chaparral for N. 25.00 chs.

From the true point for cor. to Secs. 4, 5, 8, and 9,
I run East on a random line bet. secs. 4 and 9,
Var. $14^{\circ} 06'$ East

SUBDIVISIONS T.1. S. R.17 W. S.B.M.

40.00 Set temporary $\frac{1}{4}$ sec.cor.
80.21 Intersect N and S line 13 lks S of cor to Secs.3, 4,9,10,thence,I run,
S.89° 54' W on true line bet.Secs.4 and 9
Var.14° 48' East
Ascend
5.00 Top of spur bears N.and S and descend
7.00 Cross road bears N and S
8.50 Cross canon 20 lks wide,course S.25° E and ascend
25.50 Top of ridge bears N and S and descend
30.00 Cross gulch 7 lks wide,course S and ascend
37.50 Top of ridge bears N and S and descend
40.10 Set a sandstone 20 x 12x11ins.15 in the ground for $\frac{1}{4}$ sec.cor.,marked
 $\frac{1}{4}$ on N.face and raised a stone mound alongside
Pits impracticable
51.22 Cross gulch 10 lks wide,course S 45° W and ascend
57.50 Top of spur bears N and S and descend
62.50 Cross gulch 10 lks wide,course S and ascend
80.21 The true point for cor.to Secs.4,5,8,and 9,
Land mountainous
Soil 3rd rate
Timber of Oak and dense undergrowth of chaparral

Counting distance from true point for cor to secs 4,5,8,and 9 I run
North on a random line bet.Secs.4 and 5,
Var.14° 06' East

40.00 Set temporary $\frac{1}{4}$ sec.cor.,
80.29 Intersect San Bernardino Base Line 23 lks.E.of cor. to secs.4,5,32,
and 33, on N boundary of Tp. previously described, thence, I run,
S.0° 10' E on a true line bet.Secs.4 and 5,
Var.14° 30' East.
Ascend
6.50 Top of ridge bears E and W and descend
25.96 Cross canon 10 lks.wide,course W. and ascend.
40.29 Set a sandstone 16 x 12x4 ins.11 in the ground for $\frac{1}{4}$ sec.cor.,marked,
 $\frac{1}{4}$ on W. face and raised a stone mound alongside
Pits impracticable.
42.00 Top of ridge bears N.20° W and S 20° E and descend
45.85 Cross canon 7 lks wide,course N 45° W and ascend
60.25 Top of ridge bears E and W and descend
63.25 Cross head of gulch course S 45° E and ascend
67.50 Top of spur bears N 10° W and S 10° E and descend
80.29 The true point for cor.to Secs.4,5,8 and 9
Land mountainous
Soil 3rd rate
Timber of Oak and dense undergrowth of chaparral.
November 18,1895.

From the cor.to Secs.20,21,28 and 29, I run,
West on a true line bet.secs.20 and 29,
Va.14° 21' East
Descend

2.25 Cross gulch 10 lks wide,course S and ascend
12.00 Top pf ridge bears N.E. and S.W. and descend
15.75 Cross gulch 4 lks wide,course S and ascend
23.00 Top of spur bears N and S and descend.
30.00 Cross gulch 5 lks wide,course S 10° W and ascend
35.00 Top of spur bears N and S and descend
40.00 Set a sandstone 26 x 18 x 10 ins.19 ins.in the ground for $\frac{1}{4}$ sec.cor.,

SUBDIVISIONS T.1.S., R.17 W.,S.B.M.

marked $\frac{1}{4}$ on N.face and raised a stone mound alongside.
Pits impracticable.
43.00 Cross gulch 10 lks.wide,course S.40° W and ascend
62.00 Top of spur bears N.40° E and S.40° W and descend
70.50 Enter Malibu Canon course S.
71.10 Cross Malibu Creek 30 lks.wide,course S.
71.75 Leave Malibu Canon course S and ascend
80.00 Set a sandstone 24 x 16 x 6 ins.18 ins.in the ground for cor.to Secs.
19, 20,29 and 30, marked with 2 notches on S and 5 notches on E.
edges and raised a stone mound
alongside,
Pits impracticable
Land mountainous
Soil 3rd rate
Timber of Oak and dense undergrowth of Chaparral.

South on a true line bet.Secs.29 and 30,
Var.14° 06' East.
Ascend.

1.00 Top of low spur bears E and W and descend
2.50 Cross gulch 4 lks wide,course E.and ascend
5.00 Top of spur bears E.and W.and descend
8.00 Cross gulch 3 lks wide,course E.and ascend.
12.25 Top of spur bears E and W and descend
15.00 Cross gulch 4 lks wide,course E and ascend
17.10 Top of spur bears E and W and descend
20.25 Cross gulch 5 lks wide,course E and ascend
21.25 Top of spur bears E and W and descend
23.00 Cross low sag bears E and W and ascend
25.50 Top of ridge bears E and W and descend
23.50 Cross gulch 5 lks wide,course E and ascend
34.50 A House bears W 35 lks.dist.
35.50 Cross road bears N.15° W and S.15° E.
36.90 Top of low spur bears E.and W and descend
38.25 Cross gulch 4 lks wide,course E and ascend
40.00 Set a sandstone 24 x 12 x 10 ins.18 ins.in the ground for $\frac{1}{4}$ sec.cor.,
marked $\frac{1}{4}$ on W.face and raised a stone mound alongside.
Pits impracticable.
48.00 Top of ridge bears N.E. and S.W. and descend
57.70 Cross gulch, 5 lks wide,course E.and ascend
69.50 Top of spur bears N.70° W and S 70° E and descend
77.75 Cross gulch 5 lks wide,course S 10° E and ascend
78.10 Top of low spur bears N.15° W and S.15° E and descend
79.50 Cross gulch 4 lks wide,course S 70° E and ascend
80.00 Set a sandstone 28 x 14 x 10 ins.21 ins.in the ground for cor.to
Secs.29,30,31 and 32,with 1 notch on S and 5 notches on E edges and
raised a stone mound alongside.
Pits impracticable.
Land mountainous
Soil 3rd rate
Scattering oak timber and dense undergrowth of chaparral.

South on a true line bet Secs.31 and 32,
Var.14° 01' East
Ascend

.20 Top of low spur bears N.E.and S.W. and descend.
.80 Cross gulch 4 lks wide,course N.60° E and descend.

SUBDIVISIONS T.1 S., R.17 W., S.B.M.

1.41 Intersect N boundary of Rancho Topango Malibu Sequit 33.62 chs.S.
85° 45' W.from cor.No.4, which is a
Sycamore tree 30 in.dia.,marked,
T.M. No. 4 on S.face and set a sandstone 26 x 15 x 9 ins.19 ins.in
the ground for closing cor.to Secs31 and 32, marked with 1 notch
and C.C.on W. and 5 notches on E.edges and raised a stone mound
alongside.
Pits impracticable.
Land mountainous.
Soil 3rd rate.
Scattering oak and sycamore timber and dense undergrowth of chaparral.
November 19,1895.

From the cor.to Secs.29,30,31,and 32, I run,
East on a true line bet.Secs.29 and 32,
Var.14° 01' East.
Descend.
.75 Cross gulch 4 lks wide,course N.60° E and ascend.
10.00 Top of spur bears N.E. and S.W. and descend
14.08 To foot of perpendicular bluff impossible to continue survey further
on this line.
Set a sandstone 28 x 14 x 9 ins.21 ins.in the ground for witness cor.
to closing cor.to Secs.29 and 32,marked,
W.C.C.C. with 1 notch on S.and 5 notches on N.edges and raised a
stone mound alongside.
Pits impracticable.
Land mountainous
Soil 3rd rate.
Scattering oak timber and dense undergrowth of chaparral.

From the cor.to Secs 29,30,31,and 32,I run,
West on a random line bet.Secs.30 and 31,
Var.14° 01' East.
40.00 Set temporary $\frac{1}{4}$ sec.cor.
80.14 Intersect W.boundary of Tp.29 lks.S.of cor.to Secs.25,30,31,and 36,
which is a sandstone set firmly in the ground marked with 1 notch
on S.and 5 notches on N.edges with a stone mound in good order
alongside, thence, I run
S.89° 48' E.on a true line bet.Secs.30 and 31,
Var.14° 30' East.
Descend
3.28 Cross gulch 18 lks wide,course S and ascend
20.60 Top of spur bears N and S and descend
23.85 Cross gulch 4 lks wide,course S 30° E and ascend
29.33 To top of perpendicular bank of a canon impossible to continue
further and to obtain distance across canon, I proceed ahead on
line after leaving a flag at this point and from the point ahead
on line I run a base N.of 2.00 chs.from which the flag bears S.
83° 02' W.giving by calculation a distance of 15.91 chs.across
canon and a total distance from cor.to Secs.25,30,31,and 36,of
45.24 It being impossible to set $\frac{1}{4}$ sec.cor. at true point at this point
which is 5.10 chs. S.89° 48' E.of the true point I set a sandstone
32x12x8 ins. 24 ins.in the ground for witness cor.to $\frac{1}{4}$ sec.cor.,
marked $\frac{1}{4}$ on N face and raised a stone mound alongside.
Pits impracticable.
46.40 Top of spur bears N.and S. and descend.
47.80 Cross head of gulch, course S.30° E and ascend.
51.50 Top of spur bears N.W. and S.E. and descend.
80.14 The cor.to Secs.29,30,31,and 32,
Land mountainous.

SUBDIVISIONS T.1 S., R.17 W., S.B.M.

Soil 3rd rate.
Dense undergrowth of chaparral.
No timber.

From the cor.to Secs.19,20,29 and 30, I run
West on a random line bet.Secs.19 and 30,
Var.14° 06' East.

40.00 Set temporary $\frac{1}{4}$ sec.cor.
79.86 Intersect W.boundary of Tp.22 lks.S.of cor.to secs 19,24,25,and 30,
which is a sandstone set firmly in the ground marked with 2 notches
on S and 4 notches on N edges with a stone mound in good order along-
side.
Thence, I run S.89° 51' E on a true line bet.secs 19 and 30,
Var.14° 30' East.
Descend
14.80 Cross gulch 4 lks wide,course N.E.and ascend
20.00 Top of ridge bears N.35° W and S.35° E and descend.
25.75 Cross gulch 3 lks wide,course N and ascend
38.00 Top of ridge bears N and S and descend
39.86 Set a sandstone 22 x 14 x 10 ins.16 ins.in the ground for $\frac{1}{4}$ sec.cor.,
marked $\frac{1}{4}$ on N.face dug pits 18 x 18x 12 ins. E andW of stone $5\frac{1}{2}$ ft.
dist and raised an earth mound $1\frac{1}{2}$ ft high $3\frac{1}{2}$ ft.base alongside.
55.00 Cross low sag bears N and S and ascend
58.60 Top of spur bears N and S and descend
68.75 Cross gulch 3 lks wide,course N.50° E and ascend
70.50 Top of spur bears N and S and descend
79.86 The cor.to Secs.19,20,29,and 30
Land mountainous
Soil 3rd rate.
Scattering oak timber and dense undergrowth of chaparral.
Nov.20th,1895.

From the cor.to Secs. 19,20,29,and 30, I run,
North bet.Secs.19 and 20,
Var.14° 06' East
Descend

2.00 Cross gulch 4 lks.wide,course E and ascend
5.50 Top of spur bears E and W and descend
17.00 Cross gulch 4 lks wide,course N.70° E and ascend
19.75 Top of spur bears E and W and descend
30.75 Cross Malibu Creek 30 lks.wide in Malibu Canon 150 lks.wide,course S.
20° E and ascend
36.50 Top of spur bears N.40° E and S.40° W and descend.
37.50 Cross gulch 10 lks wide,course S.45° W and ascend
40.00 Set a sandstone 26 x 14 x 8 ins.19 ins.in the ground for $\frac{1}{4}$ sec.cor.,
marked $\frac{1}{4}$ on W.face and raised a stone mound alongside.
Pits impracticable.
44.50 Top of spur bears N 45° E and S 45° W and descend
46.00 Cross head of gulch course W and ascend
50.50 Top of divide bears N.E. and S.W.and descend
60.82 Cross gulch 4 lks wide,course N.30° E and ascend.
67.50 Top of spur bears E and W and descend
72.78 Cross gulch 5 lks wide,course N 85° E and ascend
75.50 Top of spur bears E and W and descend
80.00 Set a sandstone 24 x 14 x 8 ins.18 ins in the ground for cor.to
secs 17,18,19,and 20,marked with 3 notches on S and 5 notches on E
edges and raised a stone mound alongside.

SUBDIVISIONS T.1 S.,R.17 W.,S.B.M.

Pits impracticable.
Land mountainous.
Soil 3rd rate.
Timber of Oak and dense undergrowth of chaparral.

East on a random line bet Secs.17 and 20,
Var.14° 30' East.
40.00 Set a temporary $\frac{1}{4}$ sec cor.
80.22 Intersect N and S line 12 lks.N of cor.to Secs.16,17, 20, and 21,
thence, I run,
N.89° 55' W on a true line bet.Secs.17 and 20,
Var.14° 20' East
Descend
4.00 To edge of perpendicular cliffs bears N.and S.impossible to chain.
To avoid same I offset 2.50 chs.N thence N 89° 55' W. 3.50 chs.
thence S.2.50 chs.to a line,thence N.89° 55' W. counting distances
from cor.to Secs.16,17,20 and 21,
Ascend.
8.10 Top of spur bears N.E. and S.W. and descend
23.50 Cross ravine 10 lks.wide,course N.60° W and ascend
26.50 Top of spur bears N.W. and S.E. and descend
35.50 Cross ravine 10 lks wide,course N.W. and ascend
40.11 Set a sandstone 18 x 12 x 8 ins.12 ins in the ground for $\frac{1}{4}$ sec.cor.,
marked $\frac{1}{4}$ on N face dug pits 18 x 18 x 12 ins. E. and W. of stone
5 $\frac{1}{2}$ ft.dist.,and raised an earth mound 1 $\frac{1}{2}$ ft.high 3 $\frac{1}{2}$ ft.base
alongside.
42.00 Top of low spur,bears N.and S.and descend.
45.30 Cross gulch 3 lks wide,course N and ascend
50.50 Top of spur bears N and S and descend
56.95 Cross gulch 4 lks wide,course N.20° W and ascend
60.00 Top of spur bears N.and S and descend.
63.90 Cross gulch,3 lks.wide,course N.25° W and ascend
65.30 Cross trail bears N and S on top of low spur bears N and S and descend
66.82 Cross gulch 4 lks wide,course N and ascend
72.00 Top of spur bears N and S and descend
73.45 Cross gulch 4 lks wide,course N and ascend
78.00 Top of spur bears N and S and descend
80.22 The cor to secs 17,18,19 and 20,
Land mountainous
Soil 3rd rate
Scattering oak timber and dense undergrowth of chaparral.
November 21st,1895.

West on a random line bet.Secs.18 and 19,
Var.14° 30' East
40.00 Set temporary $\frac{1}{4}$ sec cor.
48.73 To foot of W bank of Malibu Canon 100 ft high impossible to chain,
I leave a flag at this point and proceed to the cor to Secs.13,18,19,
and 24, on W boundary of Tp.due West of flag Which corner is a
sandstone set firmly in the ground,marked with 3 notches on N and S
edges with a stone mound in good order alongside and leave a flag,
Returning to first flag,I run a base S.2.00 chs. to a point from
which the flag at cor.to Secs.13, 18,19,and 24,bears N.86° 20' W.
giving by calculation a distance from flag to flag of 31.21 chs.and
a total distance from cor.to Secs.17,18,19,and 20,of
79.94 To cor.to Secs.13,18,19 and 24, on W.boundary of Tp.,thence I run
East on a true line bet.Secs.18 and 19,Var.14° 30' East.
Descend.

SUBDIVISIONS T.1.S.,R.17 W.,S.B.M.

31.21 To point of triangulation at foot of W bank of Malibu Canon
 3294 Cross Malibu Creek 10 lks.wide, S.30° W and ascend
 39.94 Set a sandstone 26 x 12 x 8 ins.19 ins.in the ground for $\frac{1}{4}$ sec.cor.
 marked $\frac{1}{4}$ on N face from which bears
 A live oak 9 ins.dia.S.80° W.19 lks.dist.,
 marked $\frac{1}{4}$ S.B.T.
 A live oak,16 ins.dia.N.62° 05' W.61 lks.dist. marked $\frac{1}{4}$ S.B.T.
 58.94 Top of spur bears N.45° W and S 45° E and descend
 65.94 Cross gulch 4 lks wide,course N 80° E and ascend
 69.94 Top of ridge bears N.and S.and descend
 76.86 Cross gulch 3 lks wide,course N.40° W and ascend
 79.94 The cor to secs.17,18,19 and 20,
 Land mountainous.
 Soil 3rd rate.
 Timber of Oak and dense undergrowth of chaparral

North between Secs.17 and 18,
 Var.14° 30' East.
 Descend
 15.85 Cross gulch,4 lks,wide,course S.85° W.and ascend.
 17.25 Cross road bears E.and W.
 20.00 Top of spur bears E.and W.and descend
 24.70 Enter flat bears E and W
 29.50 Leave flat bears E and W and ascend
 35.30 Top of spur bears N 80° W and S 80° E
 Sweeney's house bears N.54 $\frac{1}{2}$ ° E.
 Descend
 39.50 Cross gulch 4 lks wide,course W and ascend
 40.00 Set a sandstone 24 x 14 x 8 ins.18 ins.in the ground for $\frac{1}{4}$ sec.cor.,
 marked $\frac{1}{4}$ on W.face from which bears
 A Live Oak 10 ins.N.8° W 76 lks.dist.,marked $\frac{1}{4}$ S.B.T.
 No other tree within limits.
 raised a stone mound alongside,corner stone.
 Pits impracticable.
 40.50 Top of spur bears E and W and descend
 43.50 Enter field bears E and W
 44.00 Sweeney's house bears S.77° E
 46.75 Leave field bears E and W cross road bears N.W.and S.E.
 47.35 Cross Malibu Creek in Malibu Canon 30 lks wide,course N.80° W.and
 ascend.
 56.25 Top of spur bears N 40° W and S 40° E and descend
 58.85 Cross wash 10 lkswide,course S.65° E and ascend
 74.75 Top of spur bears E and W and descend
 80.00 Set a post 4 ft.long 4 ins.square with marked stone 12 ins.in the
 ground for cor.to Secs.7,8,17 and 18,marked
 T.1 S.S.8 on N.E.
 R.17 W. S.17 on S.E.
 S.18 on S.W. and
 S.7 on N.W.faces with 4 notches on S.and 5 notches on E.edges.,
 Dug pits 18 x 18 x 12 ins.in each sec 5 $\frac{1}{2}$ ft.dist. and raised an
 earth mound 2 ft.high 4 $\frac{1}{2}$ ft.base around post.
 Land mountainous
 Soil 3rd rate
 Scattering oak timber and dense undergrowth of chaparral,
 November 22,1895.

East on a random line bet.Secs.8 and 17,
 Var.14° 15' East
 40.00 Set temporary $\frac{1}{4}$ sec.cor.

SUBDIVISIONS T.1.S.,R.17 W.,S.B.M.

80.08 Intersect N and S line 22 lks N of cor to Secs 8,9,16 and 17,
Thence, I run,
N.89° 51' W on a true line bet.Secs.8 and 17,
Var.14° 02' East
Ascend
.50 Top of spur bears N and S and descend
24.50 Cross Malibu creek 10 lks wide,in Malibu canon,
Course S.and ascend
27.50 Top of ridge bears N 25° W and S.25° E and descend
33.76 Cross gulch 5 lks wide,course S.30° E and ascend
36.00 Top of spur bears N.E. and S.W. and descend
40.04 Set a sandstone 26 x 12 x 7 ins.19 ins.in the ground for $\frac{1}{4}$ sec.cor.,
marked $\frac{1}{4}$ on N.face and raised a stone mound alongside,
Pits impracticable.
41.65 Cross gulch 4 lks wide, course S.10° E and ascend
43.10 Top of spur bears N and S and descend
47.74 Cross gulch 3 lks wide,course S.E. and ascend
62.50 Top of spur bears N.20° W and S 20° E and descend
63.00 Cross gulch 4 lks wide,course S.10° E and ascend
71.00 Top of ridge bears N.W. and S.E. and descend
80.08 The cor.to Secs.7,8,17 and 18,
Land mountainous
Soil 3rd rate
Timber of oak and dense undergrowth of chaparral

West on a random line bet.Secs.7 and 18,
Va.14° 15' East
40.00 Set temporary $\frac{1}{4}$ sec.cor.,
79.90 Intersect W.boundary of Tp.8 lks.S.of cor.to Secs. 7,12,13,and 18,
which is a sandstone set firmly in the ground marked with 2 notches
on N and 4 notches on S.edges with a stone mound in good order
alongside from which bears,
A live oak 8 ins.dia.N.62 $\frac{1}{2}$ ° E 118 lks.dist.
marked T.1 S. R.17 W.S.7 B.T.
A live oak 5 ins.dia.S.22 $\frac{1}{2}$ ° E 7 lks dist.,marked T.1 S.,R.17 W.,
S.18 B.T.
A live oak 10 ins.dia.S.60° 20' W.143 lks.dist.,marked,
T.1 S. R.18 W.,S.13 B.T.
Thence, I run S.89° 57' E on a true line bet.Secs 7 and 18,
Var.14° 30' East.
Descend
3.50 Cross gulch 4 lks wide,course S.45° E and ascend
3.70 Cross trail bears N.W. and S.E.
12.50 Top of spur bears N and S and descend
18.75 Cross gulch 5 lks wide,course S and ascend
24.00 Top of spur bears N and S and descend
27.30 Cross ~~wire~~ fence bears N and S
29.90 Cross road bears N.W. and S.E.
31.50 Enter valley bears N and S
35.00 Leave valley bears N and S and ascend
36.50 Top of spur bears N and S and descend
38.55 Cross fence bears N and S and enter corral
39.10 Leave corral and cross fence bears N and S
29.90 Set a post 3 ft.long 3 ins.square 24 ins.in the ground for $\frac{1}{4}$ sec.cor.,
marked $\frac{1}{4}$ S.on N.face from which bears
A Live Oak 14 ins.dia.S.56° W 88 lks.dist.
marked $\frac{1}{4}$ S.B.T.
A Live Oak 24 ins.dia.,N.24 $\frac{1}{2}$ ° W.81 lks dist.,marked
 $\frac{1}{4}$ S.B.T.
Thompson's house bears N 24° E 129 lks.dist.

SUBDIVISIONS T.1 S. R.17 W.,S.B.M.

40.60 Cross ravine 10 lks wide, course S.25° W and ascend
 60.00 Top of spur bears N.W. and S.E. and descend.
 66.00 Cross head of gulch course N.W. and ascend
 74.50 Top of spur bears N and S and descend
 76.10 Cross gulch 3 lks wide, course S.25° E and ascend
 77.00 Top of spur bears N. and S. and descend.
 77.90 Cross gulch 3 lks wide, course S.W. and ascend
 79.90 The cor. to Secs. 7, 8, 17 and 18,
 Land mountainous
 Soil 3rd rate.
 Scattering oak timber and dense undergrowth of chaparral.
 November 23rd, 1895.

✓ North, between Sections 7 and 8,
 Var. 14° 15' East
 Descend
 5.00 Cross head of gulch, course W and ascend.
 10.10 Top of ridge bears N.E. and S.W. and descend
 11.00 Warner's house bears N. 28° W.
 20.25 Cross gulch 3 lks wide, course S.70° W and ascend.
 24.00 Top of ridge, bears N.45° W and S.25° E and descend.
 33.50 Cross gulch 10 lks wide, course W. and ascend
 40.00 Set a lava stone 24 x 12 x 10 ins. 18 ins. in the ground for $\frac{1}{4}$ sec. cor.,
 marked,
 $\frac{1}{4}$ on W face and raised a stone mound alongside.
 Pits impracticable
 47.00 Top of ridge bears N 85° W and S.85° E.
 Warner's house bears S.32° W. Descend.
 58.00 Cross gulch 4 lks wide, course W. and ascend.
 60.25 Top of spur bears E and W and descend
 66.75 Enter valley bears E and W
 71.40 Cross ravine 4 lks wide, course S.85° W.
 74.50 Leave valley bears E and W and ascend
 80.00 Set a post 4 ft. long 4 ins. square, 12 ins. in the ground for cor. to
 Secs. 5, 6, 7, and 8, marked with 5 nothces on S and E edges and marked,
 T.1 S. S. 5, on N.E.
 R.17 W., S.8 on S.E.
 S.7 on S.W. and
 S.6 on N.W. faces from which bears
 A live oak 4 ins dia. S.74 $\frac{1}{2}$ ° E 72 lks dist., marke,
 T.1 S. R.17 W. S.8 B.T.
 No other tree within limits.
 Dug pits 18 x 18 x 12 ins. in each Sec. 5, 6, and 7, 5 $\frac{1}{2}$ ft. dist.,
 and raised an earth mound 2 ft high 4 $\frac{1}{2}$ ft. base around post,
 A house bears S.46 $\frac{1}{2}$ ° E 72 lks dist.,
 Land mountainous, except about 8.00 chs.
 Rolling valley
 Soil 3rd rate,
 Timber of Oak and dense undergrowth of chaparral.

East on a random line bet. Secs. 5 and 8
 Var. 14° 15' East.
 40.00 Set temporary $\frac{1}{4}$ sec. cor.
 78.50 To edge of perpendicular slide impossible to chain to avoid which I
 offset S.175 lks. thence,
 E. on a random line and at
 80.17 Intersect N and S line 16 lks S of witness cor. to Secs. 4, 5, 8, and 9,
 Thence, I run,
 S.89° 53' W. on offset line bet. Secs. 5 and 8,
 Var. 14° 06' E.
 1.67 Offset N.175 lks. to true line and continue S.89° 53' W. with same varia-
 tion, Descend.

SUBDIVISIONS T.1.S.R.17 W.,S.B.M.

10.60 Cross gulch 5 lks wide,course S and ascend
 24.00 Top of ridge bears N.E. and S.W. and descend
 40.08 Set a sandstone 16 x 12 x 8 ins.11 ins.in the ground for $\frac{1}{4}$ sec.cor.,
 marked $\frac{1}{4}$ on N.face,
 Dug pits 18 x 18 x 12 ins. E. and W.of stone $5\frac{1}{2}$ ft.dist.,and raised
 an earth mound $1\frac{1}{2}$ ft.high, $3\frac{1}{2}$ ft.base alongside
 41.48 Cross gulch 5 lks wide,course N.45° W and ascend
 43.00 Top of low spur bears N and S and descend
 46.00 Cross gulch 3 lks wide,course N and ascend
 48.50 Top of spur bears N and S and descend
 60.38 Cross gulch 4 lks wide,course S.65° W and ascend
 (64.00 Top of spur bears N and S and descend
 (67.85 Cross gulch 4 lks wide,course S and ascend
 69.50 Top of spur bears N and S and descend
 71.52 Cross gulch 4 lks wide,course S and ascend
 79.50 Top of spur bears N and S and descend
 80.17 The cor. to Secs.5,6,7,and 8,
 Land mountainous
 Soil 3rd rate.
 Timber of Oak and dense undergrowth of chaparral.
 Nov.25th,1895.

West on a random line bet Secs.6 and 7,
 Var.14° 15' East.
 40.00 Set temporary $\frac{1}{4}$ sec.cor.,
 79.89 Intersect W boundary of Township 16 lks.N of true point for cor.to
 Secs.1,6,7, and 12, which falls in the center of a road and is marked
 by a sandstone sunk in the ground and further by a post set firmly
 in the ground 15 lks.dug.E.of true cor.,marked,
 W.C.T.1 S.S.6 on N.E.
 R.17 W.S.7 on S.E.
 R.18 W.S.12 on S.W.and
 S.1 on N.W.faces with 1 notch on N and 5 notches on S edges and
 a stone mound in good order around post from which bears,
 A willow 10 ins.dia.S.4° 52' E.144 lks.dist.,marked,
 T.1 S.R.17 W. C.C.S. 7 B.T.
 Thence, I run counting distances from true point for cor.to Secs.1
 6,7, and 12,
 N.89° 53' E on a true line bet Secs. 6 and 7,
 Var.14° 30' East.
 Descend over rolling valley
 .25 Cross fence bears N and S and enter corral
 1 .85 A house bears N about 3 chs.dist.,
 2 .12 Cross fence bears N.W.and S.E. leave corral and enter cultivated land
 bears N and S
 6 .00 Leave cultivated land bears N.and S.
 28.00 Cross road bears N.E. and S.W.
 30.40 Cross creek 30 lks wide,course S.W.
 31.00 Enter bed of creek,course S.W. and along same.
 35.00 leave bed of creek coming from the N.E. and enter grain field bears
 N. and S.
 39.89 Set a post 3 ft.long 3 ins.square,24 ins.in the ground for $\frac{1}{4}$ sec.cor.,
 marked $\frac{1}{4}$ S.on N.face from which bears
 A white oak 42 ins.dia.S.67 $\frac{1}{2}$ ° E 191 lks. dist.,marked $\frac{1}{4}$ S.B.T.
 A white oak 40 ins.dia.,N.16 $\frac{1}{2}$ ° W.366 lks.dist.,marked $\frac{1}{4}$ S.B.T.
 47.50 Leave valley and grain field bears N and S and ascend
 60.08 Cross wire fence,bears N and S.
 62.50 Top of spur bears N and S and descend
 75.70 Cross gulch 4 lks wide,course S and ascend
 79.89 The cor.to Secs.5,6,7,and 8,

SUBDIVISIONS T.1.S.R.17 W.,S.B.M.

Land for W 47.00 chs.rolling valley
Remainder mountainous and broken
Soil 2nd and 3rd rate.
Timber of Oak and dense undergrowth of chaparral.

North on a random line bet.Secs.5 and 6,
Var.14° 15' East.

40.00 Set temporary $\frac{1}{4}$ sec.cor.,
79.88 Intersect N.boundary of Tp.17 lks.W.of cor.to Secs. 5,6,31 and 32,
previously described,thence, I run,
S.7' W.on a true line bet.Secs.5 and 6,
Va.14° 30' East
Descend
8.00 Cross gulch 3 lks.wide,course S.75° W and ascend
9.50 Top of spur bears E and W and descend
11.60 Cross gulch 3 lks wide,course W and ascend
15.00 Top of spur bears E and W and descend
23.61 Cross canon 6 lks wide,course S. 55° E and ascend
30.00 Top of spur bears E and W and descend
37.50 Enter cultivated land bears E and W
39.88 Set a sandstone 26 x 14 x 8 ins.19 ins in the ground for $\frac{1}{4}$ sec.cor.,
marked $\frac{1}{4}$ on W.face from which bears
A live oak 15 ins.dia.S.66 $\frac{1}{2}$ ° E 19 lks dist.,
marked $\frac{1}{4}$ S.B.T.
A live oak, 24 ins.dia.N.77 $\frac{1}{2}$ ° W.276 lks.dist.,
marked $\frac{1}{4}$ S.B.T.
Leave cultivated land bears E.and W.
40.75 Cross gulch 5 lks wide,course N.80° W and ascend
43.00 Cross road bears E and W.
51.00 Top of ridge bears E and W and descend
54.00 Cross canon 15 lks wide,course W and ascend
66.35 A house bears N.36° 15' W 2.00 chs.dist.,
72.25 Top of ridge bears E and W and descend
79.88 The cor.to Secs.5,6,7,and 8,
Land mountainous.
Soil 3rd rate
Timber of Oak and dense undergrowth of chaparral.

November 26th,1895.

SUBDIVISIONS T.1 S. R.17 W., S.B.M.

MEANDERS OF SHORE OF
PACIFIC OCEAN.

I commence at the Meander corner to fractional Secs. 31 and 36,
on E. boundary of Tp. previously described and run with meanders
in Sec. 36,

Va. 14° 36' East.

COURSE CHS.

S. 58° W. 5.53

S. 41° W. 6.95

S. 56° W. 1.38 85, mouth of gulch, course S.

S. 76 3/4° W. 7.46

N. 74° W. 10.68

S. 86 1/2° W. 3.49

N. 86 1/2° W. 9.18

N. 82° W. 15.07

N. 87 1/2° W. 3.81

N. 80 1/2° W. 15.88

N. 85 1/2° W. 5.18 To meander cor. to fractional sections 35 and 36.

Land broken and rough.

Soil 4th rate

No timber

Dense undergrowth of chaparral

Thence in ~~Sec. 35~~,
Var. 14° 30' East.

S. 79° W. 4.81

S. 61 1/2° W. 6.53

S. 78 1/2° W. 2.36

S. 87° W. 8.94

N. 89 1/2° W. 19.30

S. 84° 10' 7.87

S. 70° 58' W. 8.32 To corner No. 1 on E. boundary of Ro. Topango

Malibu Sequit which is a post set firmly in the ground marked
T.M. No. 1 on S. face with a stone mound in good order around
post.

Land broken and rough

Soil 4th rate

No timber

Dense undergrowth of chaparral.

MEANDERS OF MATEO CREEK.

Thence up Mateo creek in Sec. 35,
Va. 14° 30' East.

SUBDIVISIONS T.1.S.R.17 W.,S.B.M.

(con) MEANDERS OF MATEO CREEK.

COURSE CHS.

N.36 $\frac{1}{4}$ ° W.	11.82	To stone set firmly in the ground marked F.H. R.1.
N.4 $\frac{1}{2}$ ° W.	7.40	To stone set firmly in the ground marked F.H.R.2.
N.25° W.	4.95	To stone set firmly in the ground marked F.H.R.3.
N.14° E.	2.94	To stone set firmly in the ground marked F.H.R.4.
N.46 3/4° E.	5.93	To stone set firmly in the ground marked F.H.R.5.
N.55 $\frac{1}{2}$ ° W.	3.48	To stone set firmly in the ground marked F.H.R.6.
		Junction of the gulch from the N.E.
N.5 $\frac{1}{4}$ ° W.	1.50	To stone set firmly in the ground marked F.H.R.7.
N.11° E.	4.43	To mound of stone No. mark.
N.18° E.	3.50	To stone set firmly in the ground marked F.H.R.9.
N.68 $\frac{1}{2}$ ° W.	7.42	To stone set firmly in the ground marked F.H.R.10.
N.6° E.	1.50	To post set firmly in the ground marked, F.H.R.11
(N.29 $\frac{1}{2}$ ° E.	4.46	To stone set firmly in the ground marked, F.H.R.12.
N.31° W.	5.95	At 1.85 to a point 58 lks.W.of Witness Cor.to closing cor.
		to Secs.26 and 35, and the end of the course is at cor No.2
		on Boundary of Topango Malibu Sequit previously described
		Land mountainous
		Soil 3rd rate
		Scattering oak and sycamore timber and dense undergrowth
		of chaparral.
		I carefully examined the adjustments of my solar compass
		today particularly the latitude and reversing apparatus
		and found them correct.

November 27,1895.

GENERAL DESCRIPTION

The land in this township is rough broken and mountainous generally the exception being a few rolling valleys in the Western portion of the Tp.
The soil is mostly 3rd rate; some 2nd rate in the valleys It is well watered by Mateo and Malibu creeks and their tributaries and by numerous other small streams generally flowing south toward the Pacific Ocean. The entire township is covered with dense undergrowth of chaparral and a scattering growth of Oak timber with sycamore timber along the creeks.
Several roads and trails traverse the Tp.in various directions.
There are houses in Secs.25,29,10,4,8,30,17,12, 13,5,6,and 7.

OFFICE OF U.S.SURVEYOR-GENERAL,

San Francisco,Cal.,June 20, 1896.

The foregoing Field Notes of the Surveys of the Subdivision lines of Township 1 South, Range 17 West, San Bernardino Meridian, in the State of California, executed by Mr.F.Reilly, U.S.Deputy Surveyor, under his Contract No.383,dated November 20th,1884, having been critically examined, and the necessary corrections and explanations made, the said Field Notes and the surveys they described are hereby approved.
(See letter of even date)

(SEAL)

W.S.GREEN
U.S.Surveyor-General for California.

SUBDIVISIONS T.1 S.,R.17 W.,S.B.M.

OFFICE OF U.S.SURVEYOR-GENERAL,

San Francisco,Cal.,June 20,1896.

I, U.S.Surveyor-General for California, do hereby certify that the foregoing Transcript has been correctly copied from the original Field Notes, as the same remain of record and on file in this Office.

ATTEST my hand and Official Seal, the day and date herein above written.

(SEAL)

W.S.GREEN.
U.S.Surveyor-General for
California.