

SECTION

31

PROPERTY CORNER  
Set 2" iron pipe, conc. plug,  
tack and brass tag marked:  
"L.A. CO. ENGR." F.B. 3888-51

PROPERTY CORNER  
Set 2" iron pipe, conc. plug,  
tack and brass tag marked:  
"L.A. CO. ENGR." F.B. 3888-53

T. 2 N.,

R. 13 W.

VERDUGO PEAKS  
MICROWAVE—SITE

Set 2" iron pipe, conc. plug,  
tack and brass tag marked:  
"L.A. CO. ENGR." F.B. 3888-51  
F.B. 4317-184

MICRO NO. 2  
Found 2" iron pipe, and brass tag  
marked: "L.A. CO. ENGR." flush with  
surface. See F.B. 3888-45  
F.B. 4317-184

Set 2" iron pipe, conc. plug,  
tack and brass tag marked:  
"L.A. CO. ENGR." F.B. 3888-52

PROPERTY CORNER  
Nothing set. Falls on steep  
hillside. F.B. 3888-51

PROPERTY CORNER  
Set 2" iron pipe, conc. plug,  
tack and brass tag marked:  
"L.A. CO. ENGR." flush with surface.  
F.B. 3888-54

Set 2" iron pipe, conc. plug,  
tack and brass tag marked:  
"L.A. CO. ENGR." F.B. 3888-54  
F.B. 4317-184

SURVEY CONTROL STATION  
LA CRESCENTA C-II AUX. I  
Found L.A. City Traverse Station  
Monument in conc. flush with surface.  
See L.A. City ENGRS. F.B. 10647-29, 30  
F.B. 3888-43  
F.B. 4317-185  
N. 4,190,542.08  
E. 4,202,676.01 (1971 adjustment)

SURVEY CONTROL STATION  
LA CRESCENTA C-II ECC. NO. I  
(VERDUGO)  
Found lead and tack in conc.  
See F.B. 3888-44  
F.B. 4317-185  
N. 4,190,723.39  
E. 4,203,086.40 (1971 adjustment)

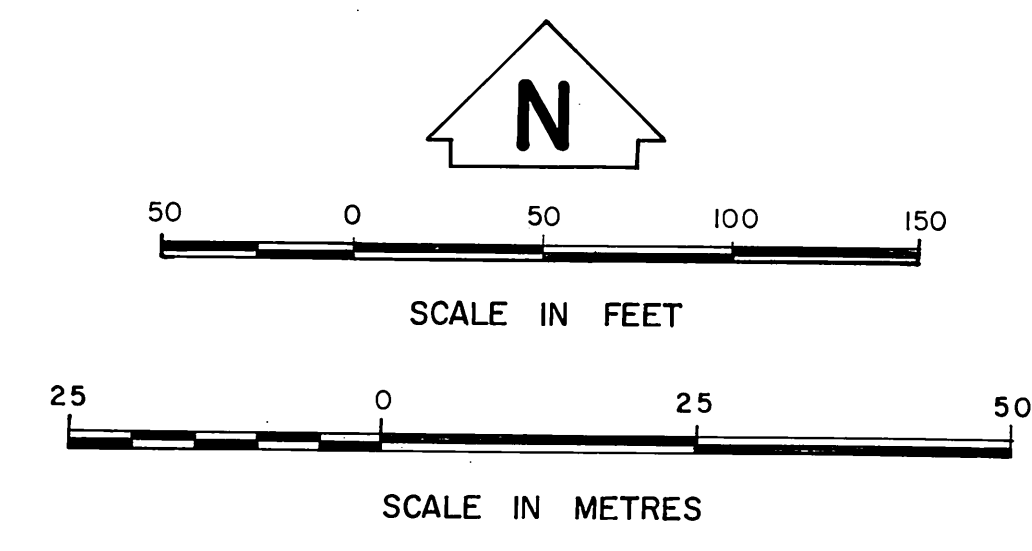
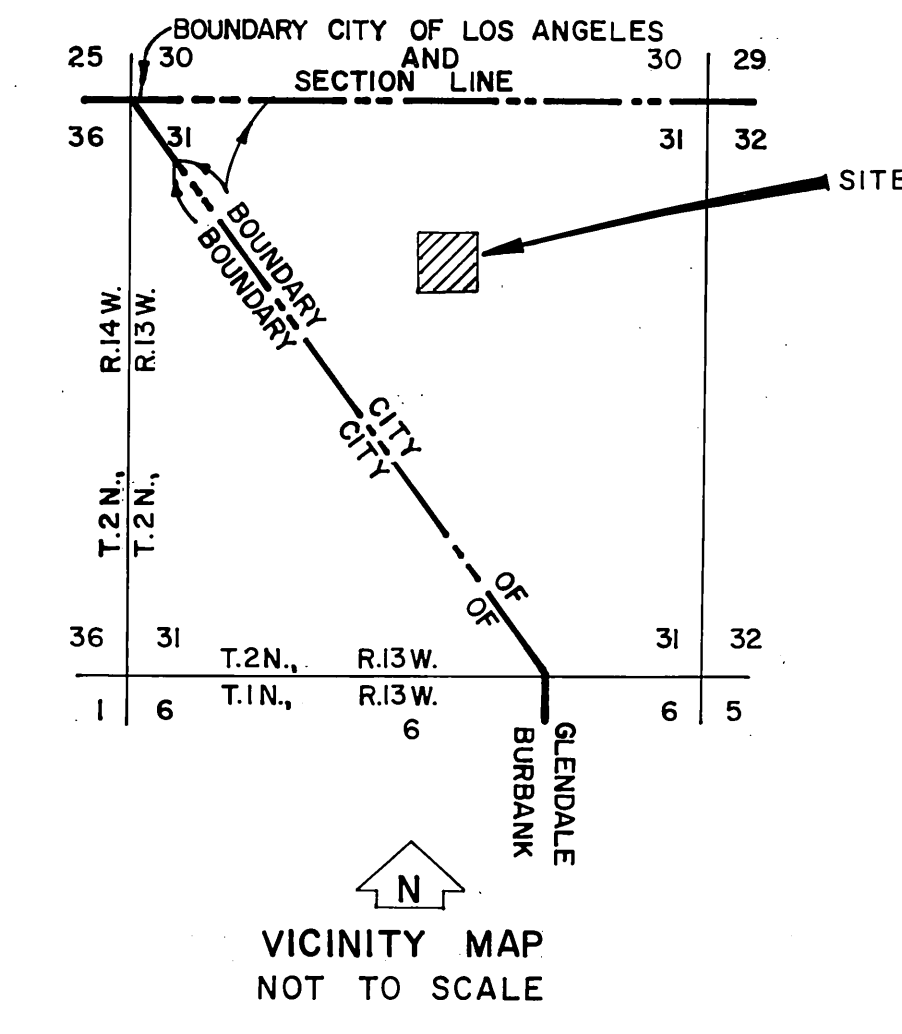

COUNTY OF LOS ANGELES DEPARTMENT OF COUNTY ENGINEER-FACILITIES PREPARED BY SURVEY—LAND DEVELOPMENT DIVISION GIBSON PHELPS JR. ASSISTANT DEPUTY COUNTY ENGINEER SURVEYED BY M.E. WACKER CHECKED BY R. HILARIO DRAWN BY R. N. TELEBRICO	BOUNDARY MAP OF <b>VERDUGO PEAKS</b> MICROWAVE—SITE (GLENDALE AREA)	COUNTY SURVEYOR'S MAP NO. <b>B-5406</b> SHEET 1 OF 1 SHEET FILED: <i>June 27, 1984</i> SURVEYED MARCH, 1984 DEPUTY REFERENCE F.B. 3888 & F.B. 4317 JOB NUMBER 0302.01 INDEX MAP NO. 52
	BASIS OF BEARINGS CALIFORNIA COORDINATE SYSTEM, ZONE 7	