

SECTION 15

T.5N., R.17W.

SECTION 22

T.5N., R.17W.

SECTION 23

T.5N., R.17W.

RANCHO TEMASCAL

STATION NO. 2
 RANCHO TEMASCAL PAT 9-28
 Found Monument marked on top of high ridge & above surface. See C.S.B-1226. F.B. 4214-12

1/4 SECTION CORNER
 Made diligent search for 4" diameter post per C.S. 9028-7. Found nothing. Topographical calls per government notes C.S. 9028-7 fit the general area. Set Monument marked on west side of Golden State Freeway by proportion between adjacent section corners per township plat T.5N., R.17W. F.B. 4214-40

1/4 SECTION CORNER
 Made diligent search for 4" diameter post per C.S. 9028-10. Found nothing. Set Monument marked on side hill by proportion between adjacent section corners per township plat T.5N., R.17W. and C.S. 9028-10. F.B. 4214-34

1/4 SECTION CORNER
 Made diligent search for 4" diameter post and stone mound per C.S. 9028-9. Nothing found. Topographical calls per C.S. 9028-9 fit the general area. Set Monument marked on top of spur of dirt road by proportion between section corners per township plat T.5N., R.17W. F.B. 4214-32

SECTION CORNER
 Made diligent search for 4" square post and pits per C.S. 9028-9. Nothing found. Topographical calls per C.S. 9028-9 fit the general area. Set Monument marked on west edge of spur by single proportion, 2 miles north, 1 mile south and record distance (3284.62) from the east per C.S. 9028-9 and township plat T.5N., R.17W. F.B. 4214-33

1/4 SECTION CORNER
 Made diligent search for 4" diameter post per C.S. 9028-9. Nothing found. Set Monument marked on top of sharp spur in rock mound by proportion between adjacent section corners per township plat T.5N., R.17W. and C.S. 9028-9. F.B. 4214-36

SECTION CORNER
 Found Monument marked in a benched area 20' east of sharp spur. See C.S.B-1226. F.B. 4214-6

SURVEY CONTROL STATION WHITAKER PEAK N-15
 Found U.S. Coast and Geodetic Survey Monument flush with surface. See Quad 341184-1074. F.B. 4214-9
 N. 4,295,177.83
 E. 4,095,671.42 (1973 adjustment)

WITNESS CORNER
 Found Monument marked in a benched area 5' north of sharp spur. See C.S.B-1226. F.B. 4214-8

1/4 SECTION CORNER
 Found Monument marked flush with surface. See C.S.B-1226. F.B. 4214-19

1/4 SECTION CORNER
 Established by proportion between adjacent section corners per township plat T.5N., R.17W. Nothing set.

SURVEY CONTROL STATION CASTAIC D-1
 Found "L.A. CO. SURVEY CONTROL TRAVERSE STATION" See F.B. 943-77 and F.B. 2459-93. F.B. 4214-12
 N. 4,293,191.50
 E. 4,085,929.87 (1976 adjustment)

SURVEY CONTROL STATION WHITAKER PEAK O-13
 Found Calif. Division of Highways brass cap Monument top of 12" cone post stamped "WHITAKER PK. O-13 1973" 4" above surface. See Quad 341184-1099. F.B. 4214-11
 N. 4,300,944.53 (1976 Adjustment)
 E. 4,096,366.74

SECTION CORNER
 Found Monument marked on side of hill flush with surface. See C.S.B-1226. F.B. 4214-5

1/4 SECTION CORNER
 Found Monument marked under barb wire fence flush with top of slope flush with surface. See C.S.B-1226. F.B. 4214-6

1/4 SECTION CORNER
 Found Monument marked 445" below surface. See C.S.B-1226. F.B. 4214-7

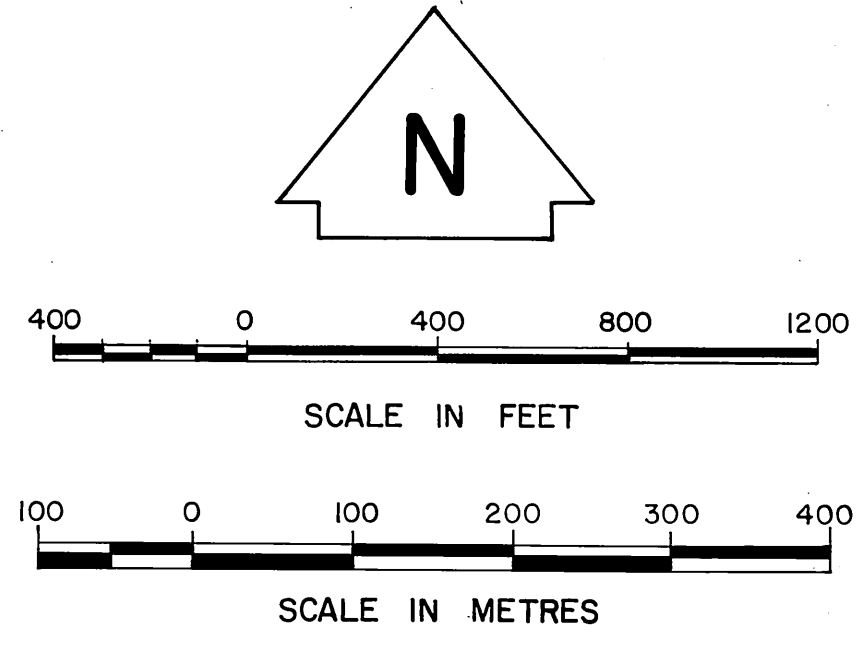
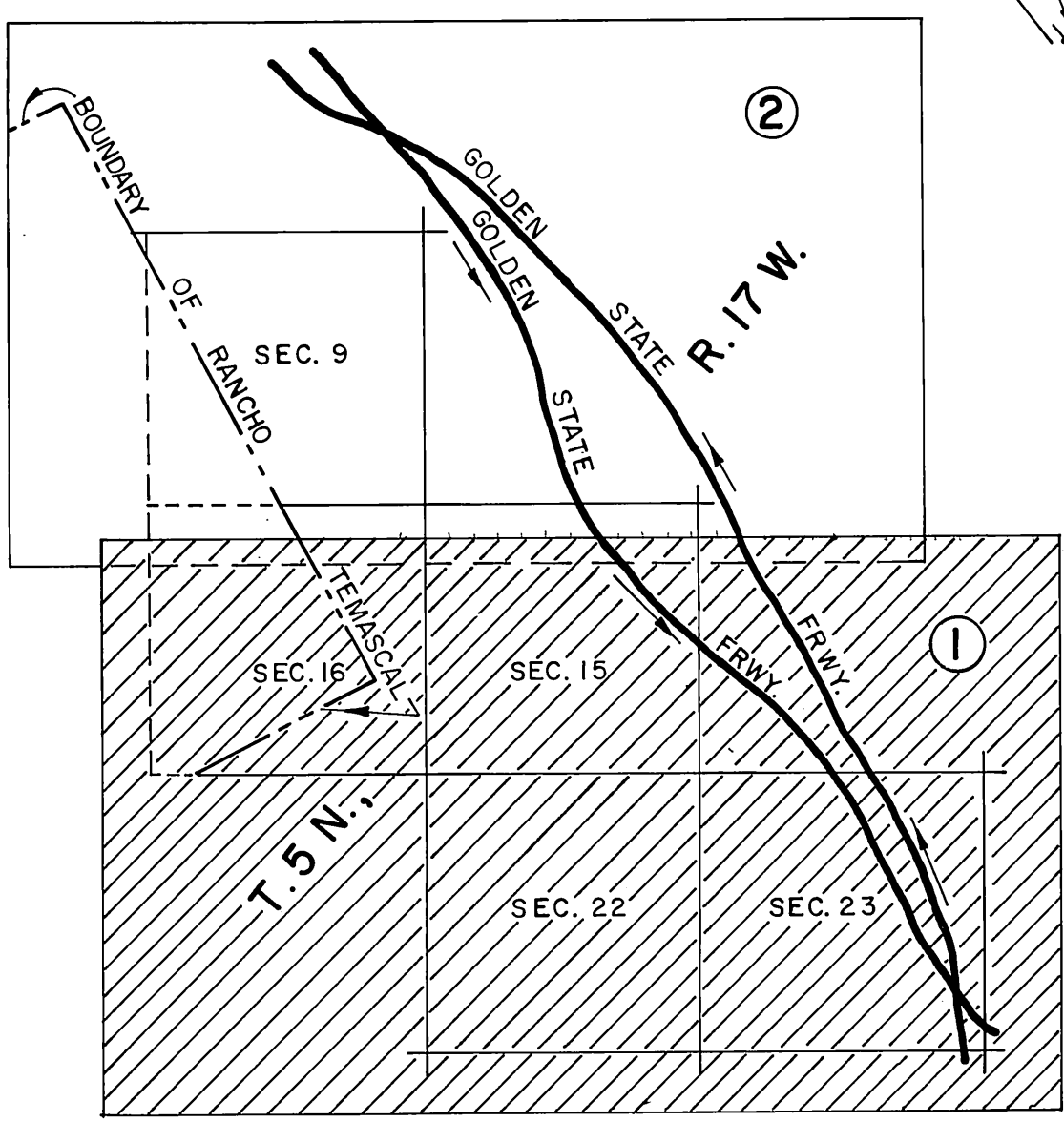

NOTE:
 THIS MAP WAS FILED FOR THE PURPOSE OF ESTABLISHING SECTION LINES. ALL OTHER CADASTRAL DATA HAS BEEN OMITTED.

COUNTY OF LOS ANGELES DEPARTMENT OF COUNTY ENGINEER-FACILITIES STEPHEN J. KOONCE-COUNTY ENGINEER PREPARED BY SURVEY-LAND DEVELOPMENT DIVISION GIBSON PHELPS JR. ASSISTANT DEPUTY COUNTY ENGINEER SURVEYED BY M.E. WACKER CHECKED BY R.G. HILARIO DRAWN BY B. GOINS-R. TELEBRICO	MAP OF SECTIONS 9, 15, 16, 22 & 23 T.5N., R.17W. BASIS OF BEARINGS CALIFORNIA COORDINATE SYSTEM, ZONE 7	COUNTY SURVEYOR'S MAP NO. B-5486 SHEET 1 OF 2 SHEETS FILED: <i>Nov. 12, 1984</i> DEPUTY SURVEYOR APRIL 19 84 REFERENCE F.B. 4214 JOB NUMBER 0208.11 INDEX MAP NO. 17
--	---	--

