

L.A. CO. SURVEY CONTROL SYSTEM MONUMENT
 S.V. B-1 (BURN)
 Triangulation Station disk cemented
 in rock outcrop projecting above
 surface. See F.B. 576-59, F.B. 3400.
 N. 171° 59' 51" (See Adjustment)
 E. 4, 177, 761.80

L.A. CO. SURVEY CONTROL SYSTEM MONUMENT
 GRANITE
 Triangulation Station disk cemented
 in rock outcrop projecting above
 surface. See F.B. 576-59, F.B. 3400.
 N. 171° 59' 51" (See Adjustment)
 E. 4, 192, 694.91

T. 6 N., R. 14 W.

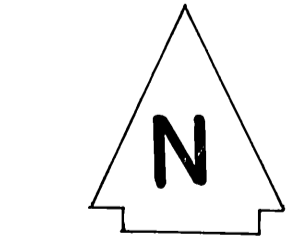

SCALE IN FEET
 0 200 400 600

SCALE IN METRES
 0 50 100 150 200

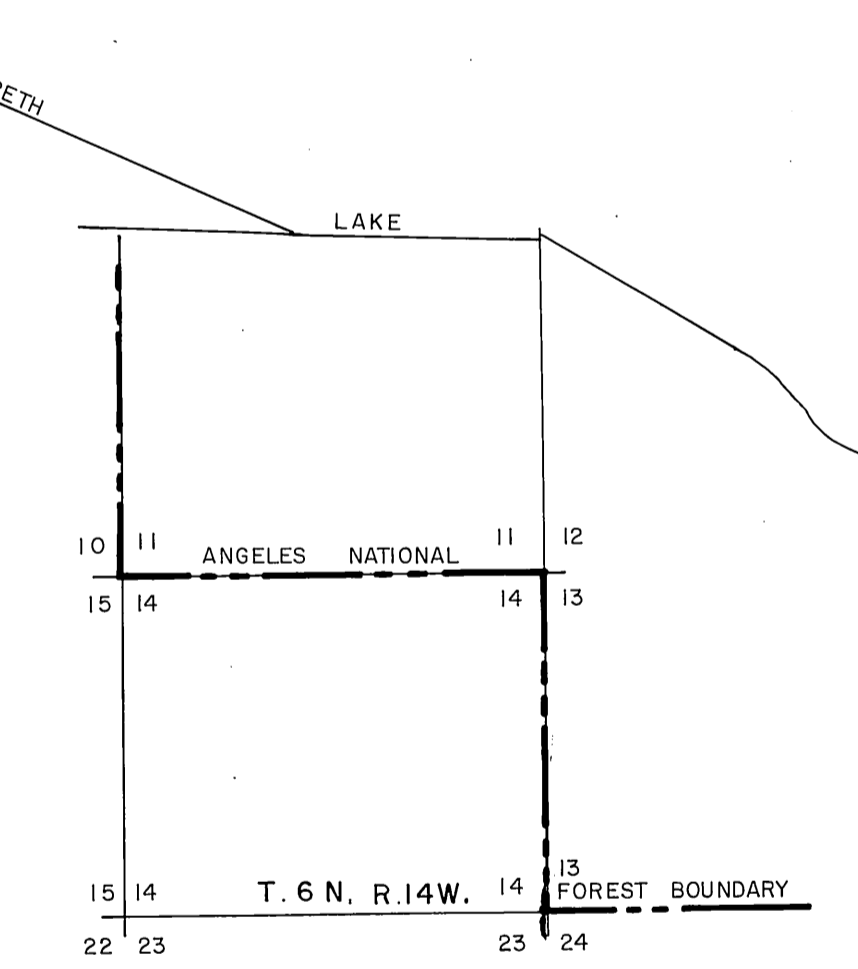

NOTE:
 THIS MAP WAS FILED FOR THE PURPOSE OF
 ESTABLISHING THE SECTION LINES. ALL
 OTHER CADASTRAL DATA HAS BEEN OMITTED

COUNTY OF LOS ANGELES DEPARTMENT OF PUBLIC WORKS T. A. TIDWELLSON - COUNTY ENGINEER PREPARED BY MAPPING DIVISION ARMANDO CID DIVISION ENGINEER SURVEYED BY J. COVEY CHECKED BY R. G. HILARIO DRAWN BY B. GOINS	MAP OF SECTION 14 T. 6 N., R. 14 W. S.B.M.	COUNTY SURVEYOR'S MAP NO. B-5495 SHEET 1 OF 1 SHEET FILED: 5-27-84 DEPT. SURVEYED: OCTOBER 1984 REFERENCE F.B. 4240
	BASIS OF BEARINGS CALIFORNIA COORDINATE SYSTEM, ZONE 7	
	JOB NUMBER 0208, 11 INDEX MAP NO. 324-177	
	COUNTY SURVEYOR'S MAP NO. B-5495	