

Field Notes Octo 2nd 1859

At request of Jno. J. Tomlinson, I have this day made survey of a certain wharfect at San Pedro, Los Angeles County California— Commencing at a point marked "a" on said Tomlinson's Wharf and from thence take the following bearings, To S.E. corner of Bachmans warehouse N. 0° 41' W. 0° 46 1/2 " N.E. " " Tomlinsons
 " " N. 26.55 W 0.32 " S.E. " " "
 " " S. 86.30 W. 0.38 Course of wharf S. 50 42' E 2.78 to end. " " N. 50 42' W 0.38 to warehouse door. Dimensions of Tomlinsons warehouse 0° 38 x 0° 61 " "
 " wharf 0.16 wide — From said point "a" N. 20° 45' W. 0.50 to Point "B" From thence N. 54° 57' W. 0.62 to S.W. corner of said Bachmans Warehouse N. 69° 06' W. 0.50 to N.W. corner of Tomlinsons Warehouse
 The water at very high tides during gales inundates the ground upon which the warehouse of said Tomlinson is situated.

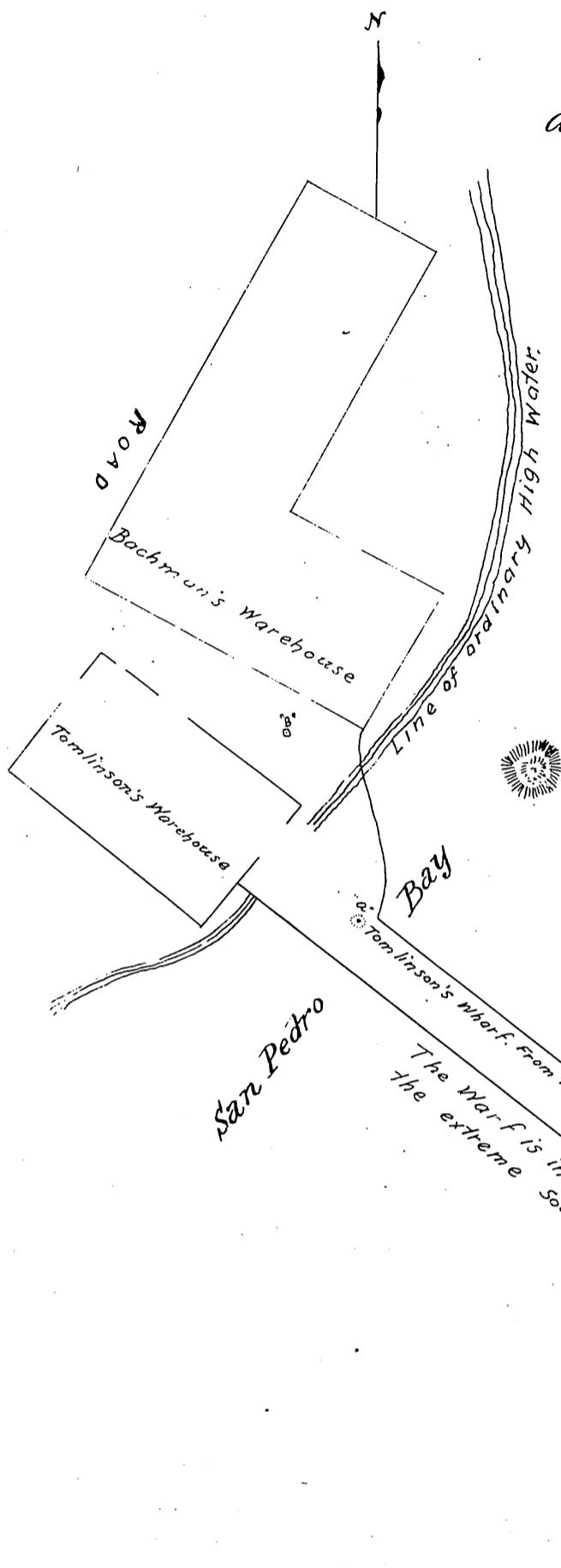

W^m Moore Co. Surveyor
 By Geo. W. Gift, Dep. Co. Surveyor.

Recorded October 4th 1859, at 11⁰⁰ A.M.
 at request of Reynolds Esq.

Copy of 1859