

Showing property contracted by Los Angeles Dock & Terminal Co. to John F. Craig  
 Los Angeles Calif. Jan. 30, 1907.  
 Said Property being located in the City of Long Beach Los Angeles County, State of California.  
 A. L. Sonderegger Chief Engr. L.A.D. & T. Co.  
 Los Angeles Calif.  
 One Inch = 200 Feet.

Note: All elevations refer to the plane of mean low water.  
 (U.S. Engineer B.M.) All Slopes not to be flatter than (3) Horizontal to (1) Vertical.  
 --- Denotes foot of Slope.  
 ~~~~~ Denotes top of Slope at elevations +120 to +140.  
 [---] Denotes area over which easement extends  
 [ ] Denotes property contracted.

Los Angeles Dock & Terminal Co.  
 to  
 John F. Craig

Exhibit "C"

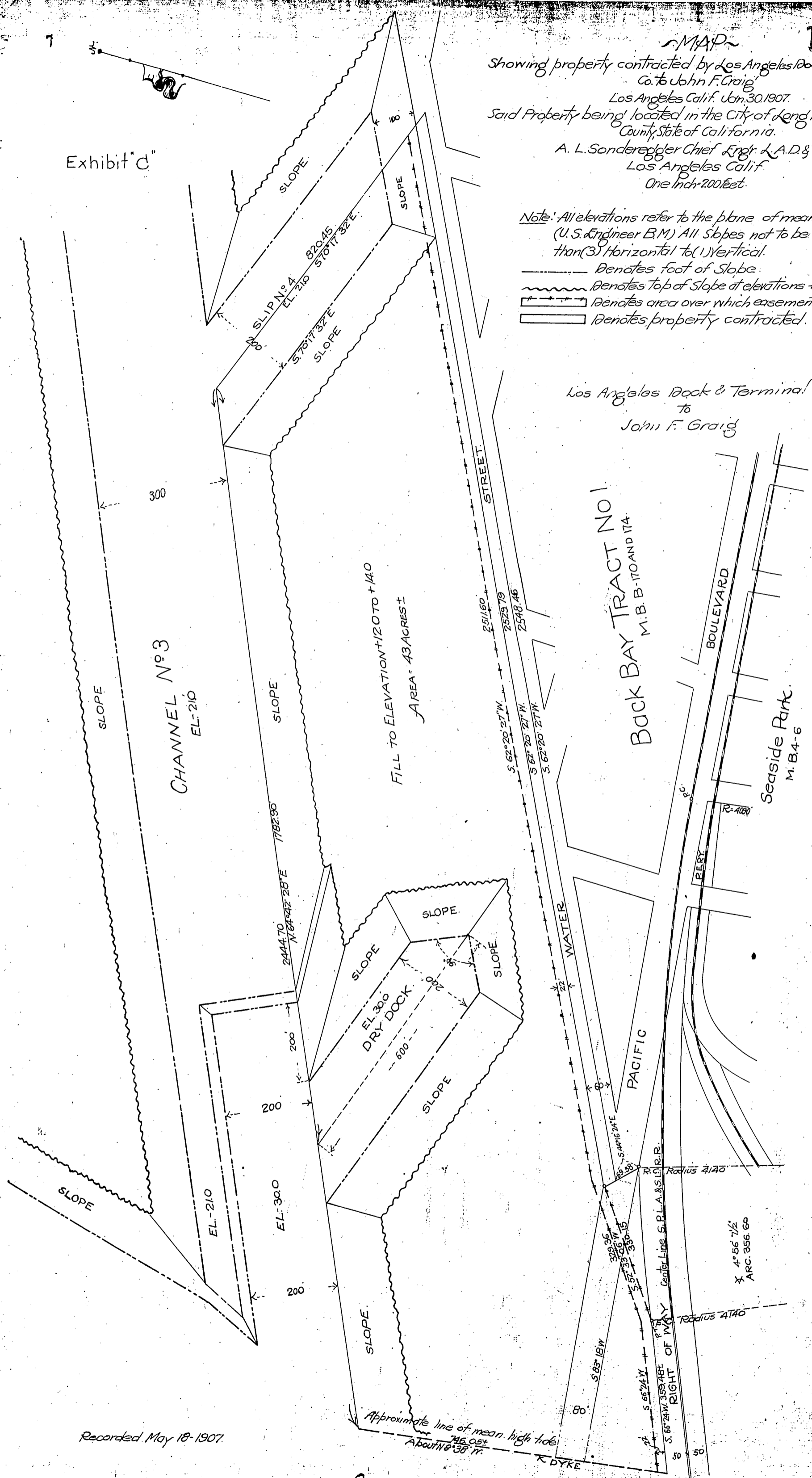

Recorded May 18-1907.

OLD SAN GABRIEL RIVER