

# MAP of the Phillips Tract Rancho La Puente, Los Angeles Co. Cal.

Surveyed December 1884

Fred Galien

Prepared for record & drawn by J. P. Culver Oct. 1885.

Covina Avenue runs due East and West and is 60 feet wide

Wideman	66
Hughson	99
Puente	66
Madilla	66
Azusa Street	66
Sierra	66
Hollenbeck	66
Arms	66
Barranca	66
First	50
Second	50
Third	50
Fourth	50
College	66
Centre	66
Dexter	66

North and South

College	66
Centre	66
Dexter	66

East West

College	66
Centre	66
Dexter	66

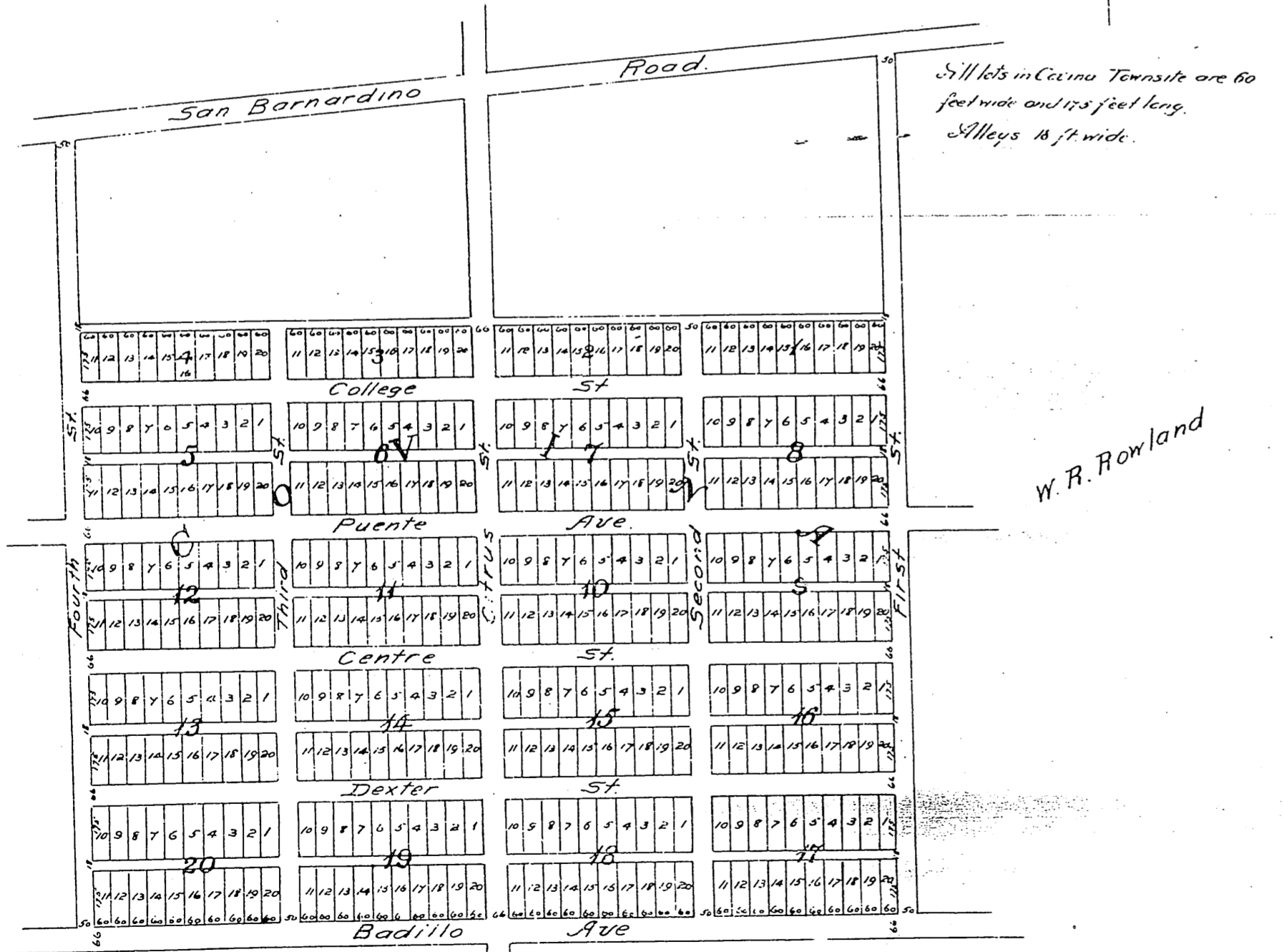
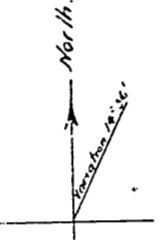

All lots in Covina Townsite are 60 feet wide and 175 feet long. Alleys 18 ft wide.

Per. Lot 3 Blk. 1 for Charter Oak Creek - K:23-49, OR: D 33-636  
 Per. " " " " " " " " " " " " K:23-9, O.R. 56435-406 & B:127-75-76, O.R. 42382-229-236; B:127-78, O.R. 42884-77  
 Lot 5 & por. Lot 4 Blk. 1 for Covina Sch. Dist. - E:139-117  
 Por. Lot 3, Blk. 16 for Ekerman Ave. - E:141-132  
 " " 3 & 6 " 16 for Arnel Drive - E:141-132  
 " " 3 & 6 " 16 " Phillips Ave. - E:141-135  
 " " 6 " 21 " Covina School District - E:139-123  
 " " 7 " 12 " " " " " - E:139-143  
 " " 8 " 12 " " " " " - E:139-144  
 " " 8 " 13 " Lark Ellen Ave. - E:141-253  
 " " 5 " 8 " " " " " - E:129-43  
 Lot 1, Blk. 16 to Covina Union High School District - E:139-204-210  
 Alley Lot 7, Blk. 30 vacated - E:123-274  
 Lots 2, 8 and por. Lot 1 Blk. 16 to Covina High School District - E:139-204 (242, 250, 251, 252, 253, 254, 255, 256, 257, 258, 259, 260, 261, 262, 263, 264, 265, 266, 267, 268, 269, 270, 271, 272, 273, 274, 275, 276, 277, 278, 279, 280, 281, 282, 283, 284, 285, 286, 287, 288, 289, 290, 291, 292, 293, 294, 295, 296, 297, 298, 299, 300, 301, 302, 303, 304, 305, 306, 307, 308, 309, 310, 311, 312, 313, 314, 315, 316, 317, 318, 319, 320, 321, 322, 323, 324, 325, 326, 327, 328, 329, 330, 331, 332, 333, 334, 335, 336, 337, 338, 339, 340, 341, 342, 343, 344, 345, 346, 347, 348, 349, 350, 351, 352, 353, 354, 355, 356, 357, 358, 359, 360, 361, 362, 363, 364, 365, 366, 367, 368, 369, 370, 371, 372, 373, 374, 375, 376, 377, 378, 379, 380, 381, 382, 383, 384, 385, 386, 387, 388, 389, 390, 391, 392, 393, 394, 395, 396, 397, 398, 399, 400, 401, 402, 403, 404, 405, 406, 407, 408, 409, 410, 411, 412, 413, 414, 415, 416, 417, 418, 419, 420, 421, 422, 423, 424, 425, 426, 427, 428, 429, 430, 431, 432, 433, 434, 435, 436, 437, 438, 439, 440, 441, 442, 443, 444, 445, 446, 447, 448, 449, 450, 451, 452, 453, 454, 455, 456, 457, 458, 459, 460, 461, 462, 463, 464, 465, 466, 467, 468, 469, 470, 471, 472, 473, 474, 475, 476, 477, 478, 479, 480, 481, 482, 483, 484, 485, 486, 487, 488, 489, 490, 491, 492, 493, 494, 495, 496, 497, 498, 499, 500, 501, 502, 503, 504, 505, 506, 507, 508, 509, 510, 511, 512, 513, 514, 515, 516, 517, 518, 519, 520, 521, 522, 523, 524, 525, 526, 527, 528, 529, 530, 531, 532, 533, 534, 535, 536, 537, 538, 539, 540, 541, 542, 543, 544, 545, 546, 547, 548, 549, 550, 551, 552, 553, 554, 555, 556, 557, 558, 559, 560, 561, 562, 563, 564, 565, 566, 567, 568, 569, 570, 571, 572, 573, 574, 575, 576, 577, 578, 579, 580, 581, 582, 583, 584, 585, 586, 587, 588, 589, 590, 591, 592, 593, 594, 595, 596, 597, 598, 599, 600, 601, 602, 603, 604, 605, 606, 607, 608, 609, 610, 611, 612, 613, 614, 615, 616, 617, 618, 619, 620, 621, 622, 623, 624, 625, 626, 627, 628, 629, 630, 631, 632, 633, 634, 635, 636, 637, 638, 639, 640, 641, 642, 643, 644, 645, 646, 647, 648, 649, 650, 651, 652, 653, 654, 655, 656, 657, 658, 659, 660, 661, 662, 663, 664, 665, 666, 667, 668, 669, 670, 671, 672, 673, 674, 675, 676, 677, 678, 679, 680, 681, 682, 683, 684, 685, 686, 687, 688, 689, 690, 691, 692, 693, 694, 695, 696, 697, 698, 699, 700, 701, 702, 703, 704, 705, 706, 707, 708, 709, 710, 711, 712, 713, 714, 715, 716, 717, 718, 719, 720, 721, 722, 723, 724, 725, 726, 727, 728, 729, 730, 731, 732, 733, 734, 735, 736, 737, 738, 739, 740, 741, 742, 743, 744, 745, 746, 747, 748, 749, 750, 751, 752, 753, 754, 755, 756, 757, 758, 759, 760, 761, 762, 763, 764, 765, 766, 767, 768, 769, 770, 771, 772, 773, 774, 775, 776, 777, 778, 779, 780, 781, 782, 783, 784, 785, 786, 787, 788, 789, 790, 791, 792, 793, 794, 795, 796, 797, 798, 799, 800, 801, 802, 803, 804, 805, 806, 807, 808, 809, 810, 811, 812, 813, 814, 815, 816, 817, 818, 819, 820, 821, 822, 823, 824, 825, 826, 827, 828, 829, 830, 831, 832, 833, 834, 835, 836, 837, 838, 839, 840, 841, 842, 843, 844, 845, 846, 847, 848, 849, 850, 851, 852, 853, 854, 855, 856, 857, 858, 859, 860, 861, 862, 863, 864, 865, 866, 867, 868, 869, 870, 871, 872, 873, 874, 875, 876, 877, 878, 879, 880, 881, 882, 883, 884, 885, 886, 887, 888, 889, 890, 891, 892, 893, 894, 895, 896, 897, 898, 899, 900, 901, 902, 903, 904, 905, 906, 907, 908, 909, 910, 911, 912, 913, 914, 915, 916, 917, 918, 919, 920, 921, 922, 923, 924, 925, 926, 927, 928, 929, 930, 931, 932, 933, 934, 935, 936, 937, 938, 939, 940, 941, 942, 943, 944, 945, 946, 947, 948, 949, 950, 951, 952, 953, 954, 955, 956, 957, 958, 959, 960, 961, 962, 963, 964, 965, 966, 967, 968, 969, 970, 971, 972, 973, 974, 975, 976, 977, 978, 979, 980, 981, 982, 983, 984, 985, 986, 987, 988, 989, 990, 991, 992, 993, 994, 995, 996, 997, 998, 999, 1000)

Por. Lot 8, Blk. 22 to City of W. Covina for Rd. & Hwy. purp. - E:150-76  
 " " 5 " 8 for St. & Hwy. purposes - E:153-179, O.R. 49833-74  
 " " 5 " 21 " Azusa Ave. - E:153-197 O.R. 49886-142  
 " " 8 " 17 " " - E:155-24, O.R. 50284-216; E:166-190, O.P. 54253-314  
 " " 1 " 27 " Citrus St. - E:155-231, O.R. 51064-336  
 " " 8 " 8 " Azusa Ave. - E:155-233, O.R. 51064-97  
 " " 2 " 1 " San Bernardino Road - E:158-41, O.R. 50901-117  
 " " 8 " 15 " Road & Public Purp. - E:159-7, O.R. 51317-114  
 " " 6 " 1 " Road Purposes - E:158-117, O.R. 51226-326  
 " " 5 " 9 " Azusa Ave. - E:160-68, O.R. 51597-37; E:166-242, O.R. 54387-306  
 " " 4 " 1 " St. & Hwy Purp. - E:159-165, O.R. 51837-184  
 " " 5 " 27 " Hollenbeck St. - E:162-61, O.R. 52442-6  
 " " 5 " 22 " " - E:161-99, O.R. 52255-388  
 " " 1 " 22 " Citrus Street - E:161-226, O.R. 53081-356; K:72-40, O.P. D 125-938  
 " " 1 " 5 " Azusa Avenue - E:166-92, O.R. 53949-174 & E:166-119, O.R. 54001-40  
 " " 8 " 20 " " - E:166-93, O.R. 53949-170; E:166-216, O.R. 54303-107 (Q.C.); 54305-120  
 " " 4 " 1 " " - E:166-226, O.R. 54331-238  
 " " 7 " 8 Q.C. by City of W. Covina - E:167-100, O.R. 51272-312; Vacated E:167-101, O.R. 51272-313  
 " " 4 " 4 for Azusa Avenue - E:166-259, O.R. 54425-218 (55171--144)  
 " " 4 " 9 for Alley Purp. - E:170-106, 107, O.R. 55131-345, 353; E:170-108 O.R. 55131-350; E:170-116, O.R. /  
 For Por. Barranca St. in Blk. 26 - SEE C.S.B. 611-5  
 Por. Lot 8 Blk. 22 for Citrus St. - E:170-259, O.R. 55490-152  
 " " 8 " 17 for Covina S.D. - K:1-17, O.R. 56109-6  
 " " 3 " 9 " " Sch. Dist. - E:168-127, O.R. 55953-114  
 " " 8 " 14 " L.A.C.F.C.D. - E:168-20, O.R. 55068-301  
 " " 4 " 9 for Alley Purp. - K:17-39, O.R. 56338-143  
 " " 2 " 4 " St. & Hwy. - K:17-18, O.R. 56316-250  
 All N. & S. roadways designated "Street" changed to Avenue)  
 All E & W. " " " " Avenue" " " Street) E:173-192, In the City of Covina  
 For Lot 2, Blk. 5 SEE C.S.B. -754-3  
 Por. Badillo St. vacated - K:42-32, O.R.D 51-419  
 Vac. Por. of Workman Ave. K:41-43, OR: D 53-302  
 Por. Lot 3 Blk 22 for Alden Ave. K:59-22, O.R. D 89-804 and K:59-23, OR: D 89-806

Por. Lot 1, Blk. 23, for Barranca St. - K:29-64, OF: D 33-368  
 NOTE: Property deeded to City - D:1939-8, D:6-123; D:1947-34, 35, D:6-123; D:1064-175, D:2-128; D:2532-394, D:6-125  
 Citrus Ave. D:4046-261, D:6-127, por. of Lot 11 Blk. 15, Lots 10 & 11 Blk. 18  
 Vac. of Street and Alleys Elks 16-17 M.R. 55-72  
 Puente Ave. changed to Badillo Ave. Ord. 14, D:25-137  
 Badillo " " " " 14, D:25-137  
 Vac. of Alley in Blk 19, Ord. 54 - D:25-137  
 Lot 15 & por. Lot 16, Blk. 14 for School Purposes - E:39-168, O.R. 17693-1  
 Lots 1 & 2, Blk. 7 deeded to U.S.A. - E:29-124, O.P. 16423-398  
 Por. Lot 2, Blk. 15, for High School purp. - D:42-198, O.R. 4193-187  
 San Bernardino R. changed to Covina Blvd. - D:56-127, Ord. 173  
 Por. Lot 2 Blk 6 for Alley Purp. - D:88-190, D:1819-259; D:1848-96  
 Covina Blvd. changed to San Bernardino Road - D:93-179, Ord. 198  
 Lots 18, 19, & 20 & por. Lot 17 Blk. 14, for School purp. - E:7-183, Cert. J.E. 82187  
 Widening 2nd St. See D.M. 1084-244  
 Por. Lots 7 & 8 to Covina Sch. Dist. - K:1-10, O.R. 56046-127  
 " " 4 & 5 Blk. 6 to City of Covina - K:62-21, OF: D 92-902  
 " " 3 & 4, " 6 " " - K:62-22, OR: D 92-915  
 " " 3 " 14 for St. Purp. - E:129-56  
 " " 7 " 9 quitclaimed by City - E:33-154, Res. 171  
 " " 1 " 15 to Covina High School Dist. - E:60-296, Doc. No. 17804-K; E:63-248, Doc. No. 10214-L  
 For Garvey - Arroyo Freeway SEE F.M. 11786-3, C.F. 2196  
 Centre St. changed to Center St. - E:80-200, Ord. 274  
 Pors. Lot 7, Blk. 8 for Pub. Hwy. E:94-31, O.R. 30773-192, 188 & 184 (3 deeds)  
 Pors. Lot 2, " 11 " Street Purposes - E:114-58, O.R. 37777-197 and E:114-85, O.P. 38014-254  
 " " 7 " 11 " - E:114-145, O.R. 38305-224  
 Lot 6 & Por. Lot 3 Blk. 16 to Covina Sch. Dist. - E:119-52, O.P. 38830-302  
 For Badillo Street SEE C.F. 2357-2 for Badillo St. & E:117-215, O.P. 4421-611  
 Lots 11, 12 & 13, Blk. 20, to Covina Union High Sch. Dist. - E:130-102, O.P. 42611-212  
 Por. Lot 8 Blk. 14 - E:127-75, 78, 85, 88  
 Vac. Por. of Workman Ave. - K:162-27, OR: D 196-505  
 For Lot 5, Blk. 6 to City of Covina - E:128-29, O.R. D 255-185  
 For Charter Oak Wash See F.M. 20098  
 Por Lot 1, Blk. 18 to City of W. Covina - E:177-3, O.R. D 351-262  
 Por Lot 7, Blk. 7 quitclaims to City of Covina - E:177-215, O.R. 4421-611  
 Por Lot 16, Blk. 2 to City of Covina - E:190-48, O.R. D 726-711  
 For Lot 2, " 15 to Covina Sch. Dist. - E:187-18, O.R. 522-178 (F.M.)  
 Por. lots 7 & 8 quitclaim by Covina Sch. Dist. to Covina Valley Unified Sch. Dist. - E:187-246, O.R. D 871-198 (G.C.)  
 Por. Lot 5, Blk. 15 for Barranca Ave. E:201-113, O.R. 5113-29 Part 1 & 2  
 Por Lot 1 & 2 Blk 25 for Fairway Ln. - E:201-27, O.R. D 150-888  
 Por Lot 1 Blk 15 to City of Covina - O.R. D 1849-957

MR 9-3  
 PHILLIPS TRACT - RANCHO LA PUENTE

RETURN TO  
 COUNTY ENGINEER  
 MAPPING DIVISION  
 FILE ROOM

COUNTY ENGINEERS COPY

