

Plot
of the
Mappa Tract
in the
City of Los Angeles
subdivided
at the request of Chas Charnock
and T.H. Ward in Aug 1886 by Geo C Knox
Scale 100 feet to one inch

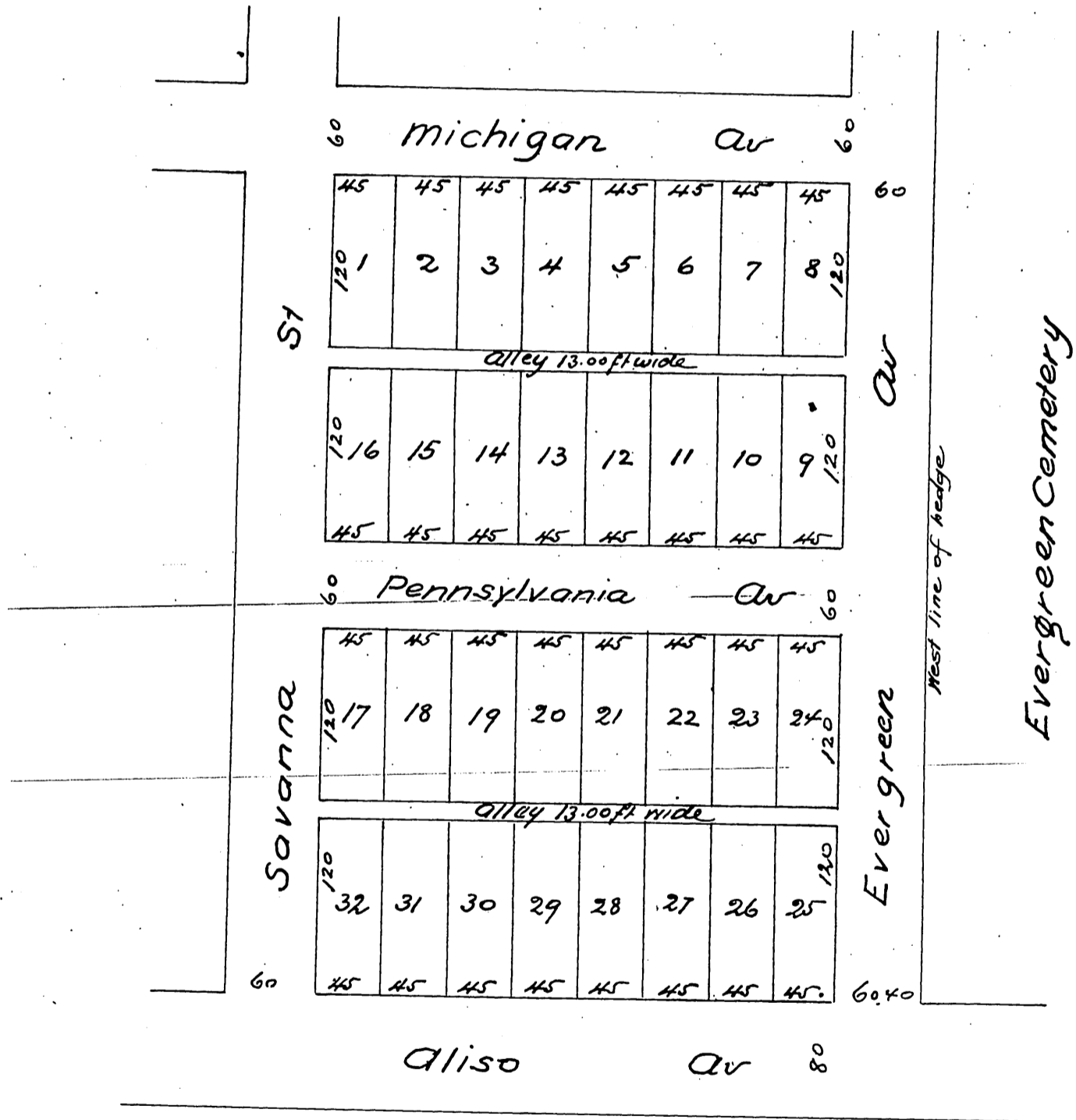

Note
The Mappa Tract is Block 12 of the
Mathews and Fickett subdivision of lots
3 and 4 in Block 73 Hancock's Survey of
35 acre Donation lots in the City of
Los Angeles.

a full, true and correct copy of the original
recorded Oct 8th 1886 at 3 P.M. at request of.
Chas Charnock
Frank A. Gibson County Recorder
By Arthur Bray Deputy