

1177

# Map of

## Mrs M. M. Smith's Subdivision

OF

the Northwest part of Block "U" of the subdivided lands belonging to J. H. Painter  
and B. F. Ball Pasadena Cal

Surveyed Sept 1886 by J. M. Willard C.E

Scale 50ft-1 inch

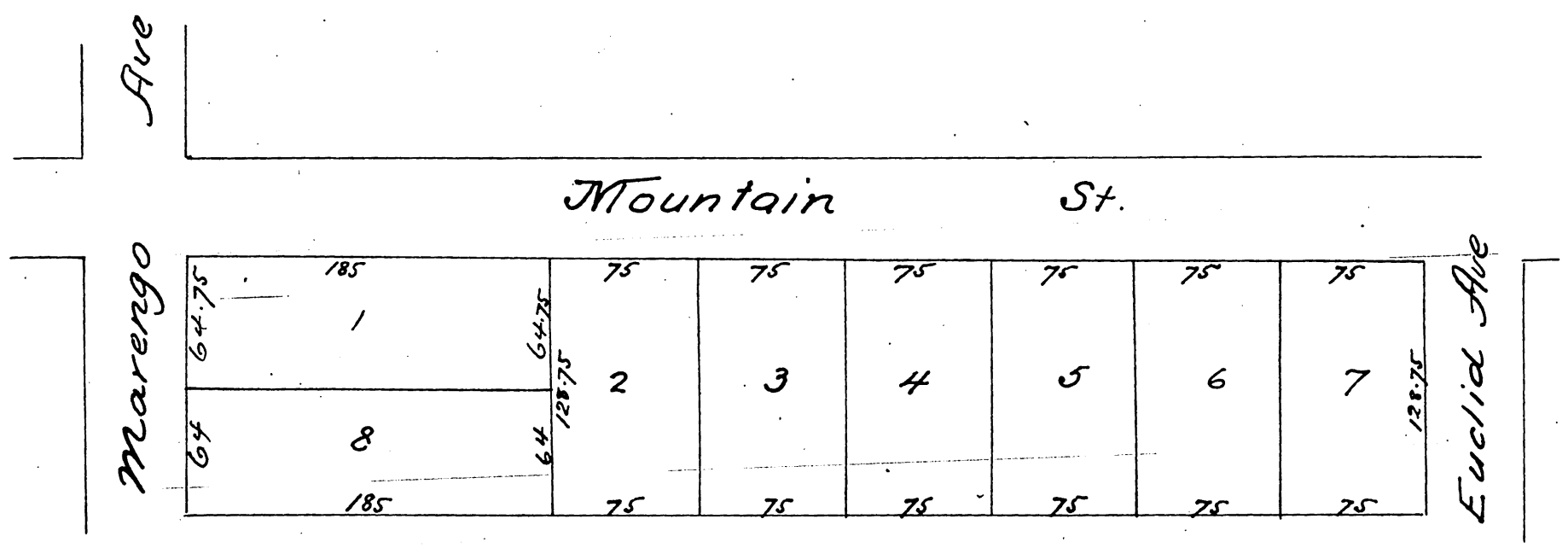

A full true and correct copy of the original (reduced to  
 the scale of 80 feet to one inch) recorded November 1st 1886  
 at 11:20 am at request of Mrs M. M. Smith.  
 Frank A. Gibson County Recorder  
 By Arthur Bray Deputy