

Map
of
L. H. Michener's Subdivision
of the
North East 4.09 acres of Block U of the Painter 2nd Ball Tract
Pasadena Cal.
Surveyed Sept 1886 by J. M. Willard C.E.
Scale 50ft = 1 inch

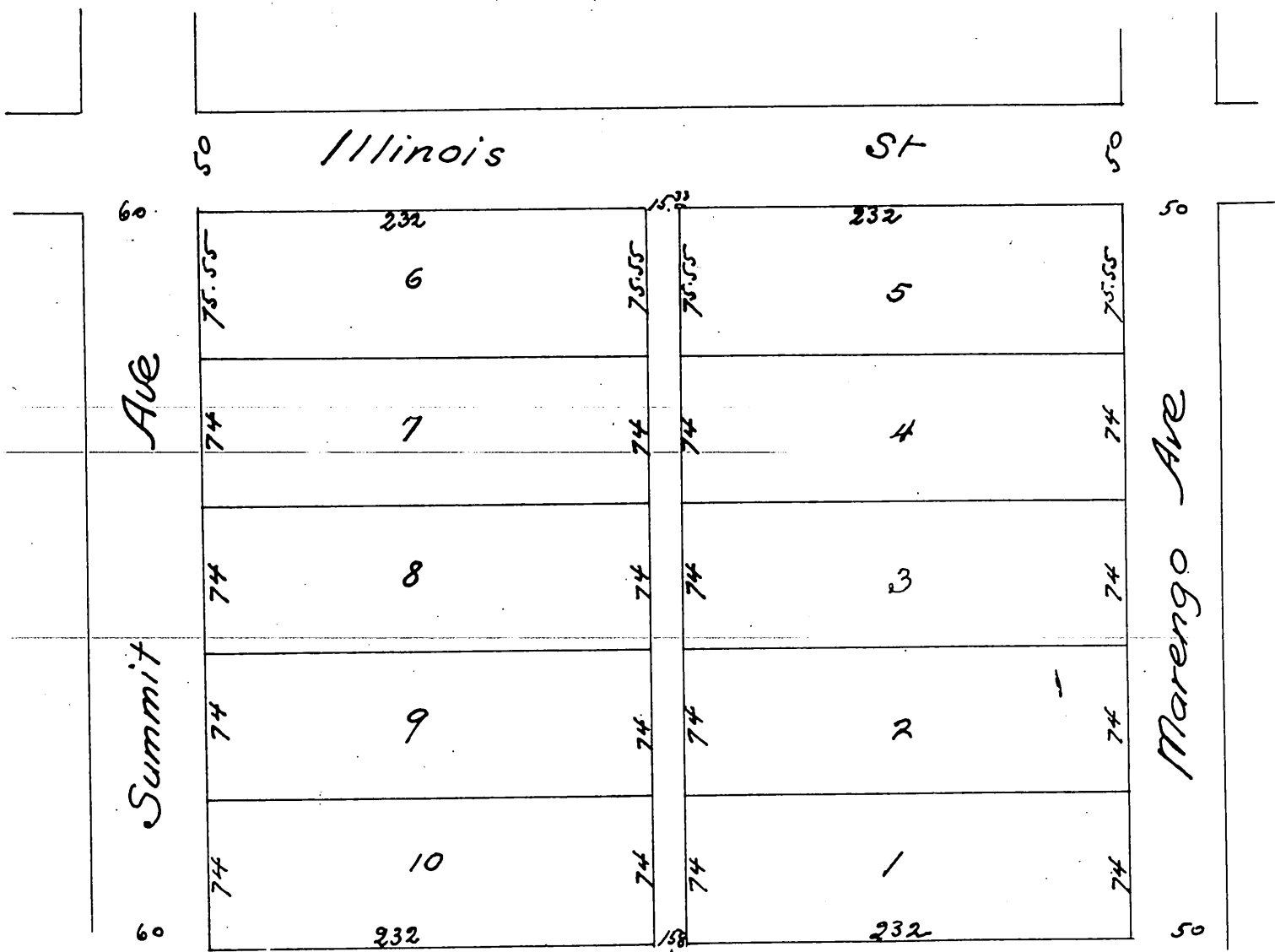

A full true and correct copy of the original (reduced to the
scale of 80 feet to one inch) recorded November 3rd 1886 at 12⁵⁶ M.
at request of L. H. Michener
Frank A. Gibson County Recorder
By Arthur Bray Deputy