

Map
 of the
Burton Tract
 Being Lots 1 & 2 BIK 3 Garey Tract
 Los Angeles City

Surveyed Oct 1886 by E.T. Wright
 Scale 40 feet to one inch

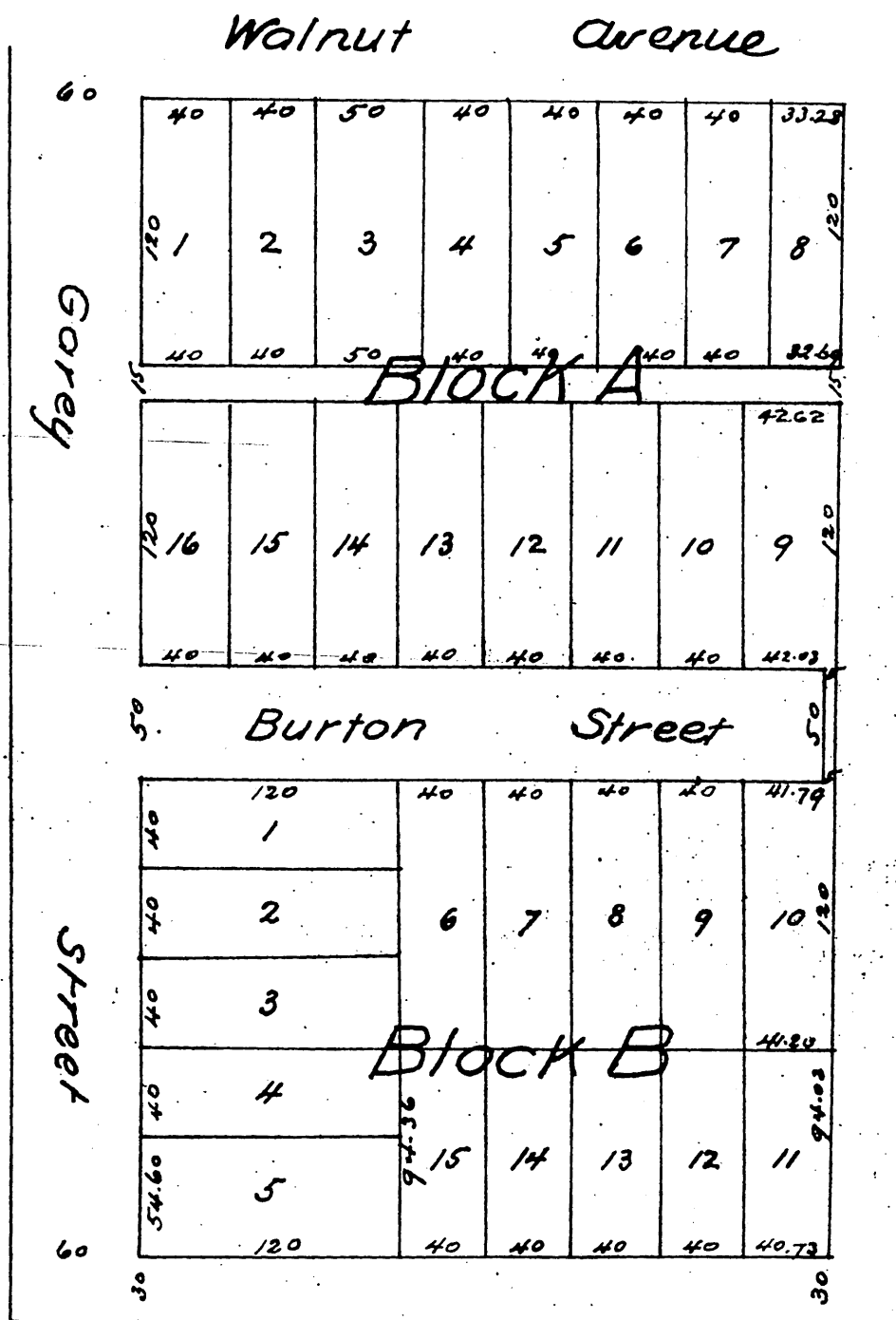

A full, true and correct copy of the original
 (reduced to the scale of 80 feet to one inch)
 recorded Nov 6, 1886 at 10²⁹ am. at request
 of C. B. Woodhead
 Frank A. Gibson, County Recorder
 By Arthur Bray, Deputy