

MAP OF THE KENNEBEC TRACT

Being the property described Book 34 page 389 also Book 153 page 12 of Los Angeles County Records of Deeds

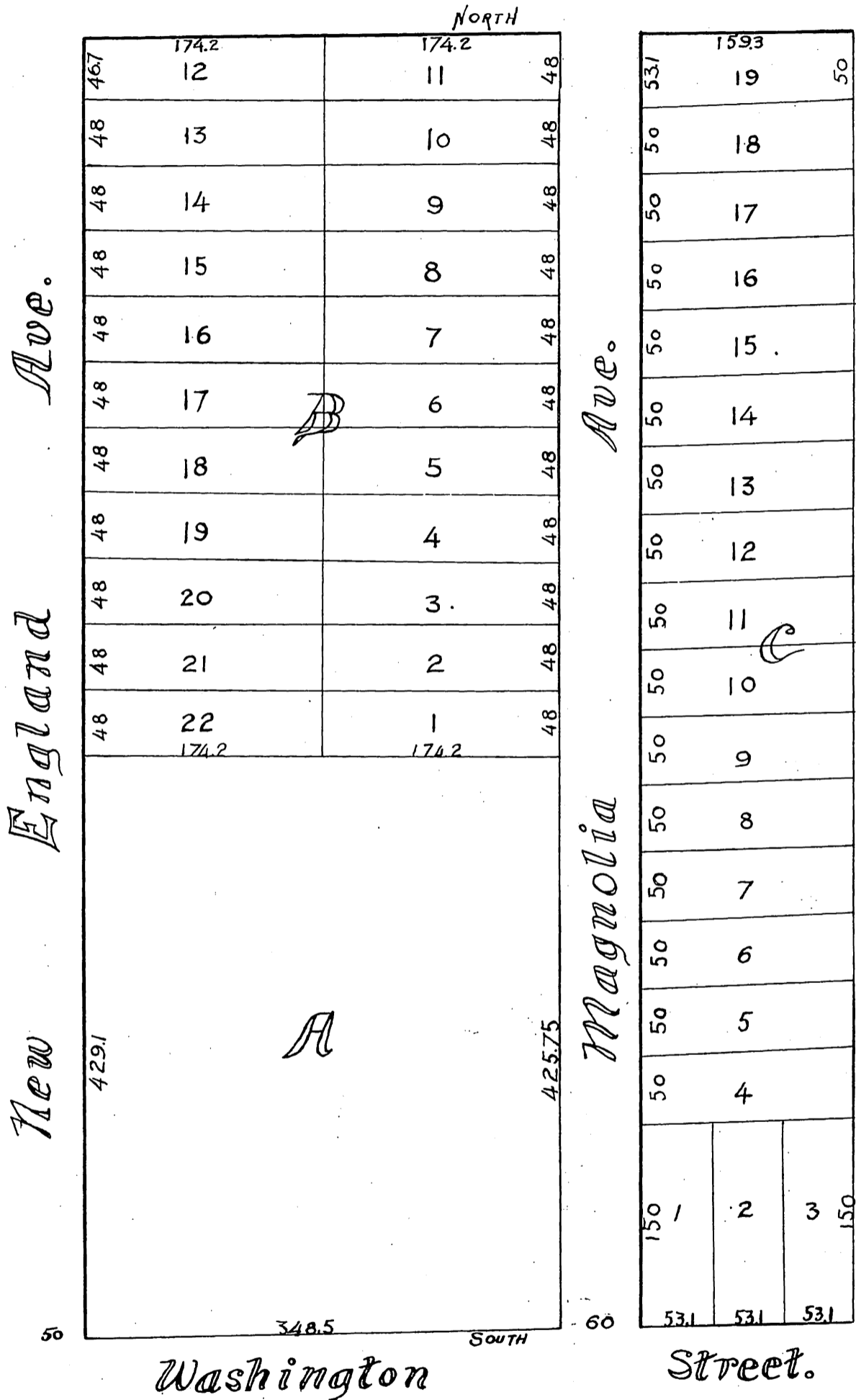

This is to certify that the Map of the Kennebec Tract recorded in Book 28 page 1 of Miscellaneous records of Official records of Los Angeles County, California, being a Map of a survey made by me in January 1887 for A. S. Bixby, is a map of the Subdivision of the real property described in Deeds given by L. D. Grant to A. S. Bixby and J. H. Bixby recorded in Book 34 page 389 of Deeds of said Official records, and under by L. B. Palmer to A. S. Bixby recorded in Book 153 page 12 of said records. Subscribed and sworn to before me this 27 day of February 1888.
 F. D. Lanterman, Notary Public.
 A full true and correct copy of the original, recorded at request of A. S. Bixby Feb. 2, 1888 at 10 minutes to 10 A. M. by J. H. Bixby, County Recorder by J. C. Johnston, Deputy.

Surveyed and Subdivided under instruction from
 A. S. Bixby by F. D. Lanterman, Sur.
 Jan. 1887.

*(reduced to the scale of 100 feet to one inch)
 recorded August 18, 1887 at 10 past 10 A.M.
 at request of A. S. Bixby*