

*Map of Briggs Addition to Pasadena  
 Being a Subdivision of of the Western  
 part of the 33 1/2 Acres, conveyed by Alex.  
 T. Grogan to A.F. Sproul. Situated in the  
 Grogan Tract, Pasadena, Los Angeles Co, Calif.  
 Scale 80 ft. to 1 inch.*

*Sur. July '87 by F. H. Post, C.E.*

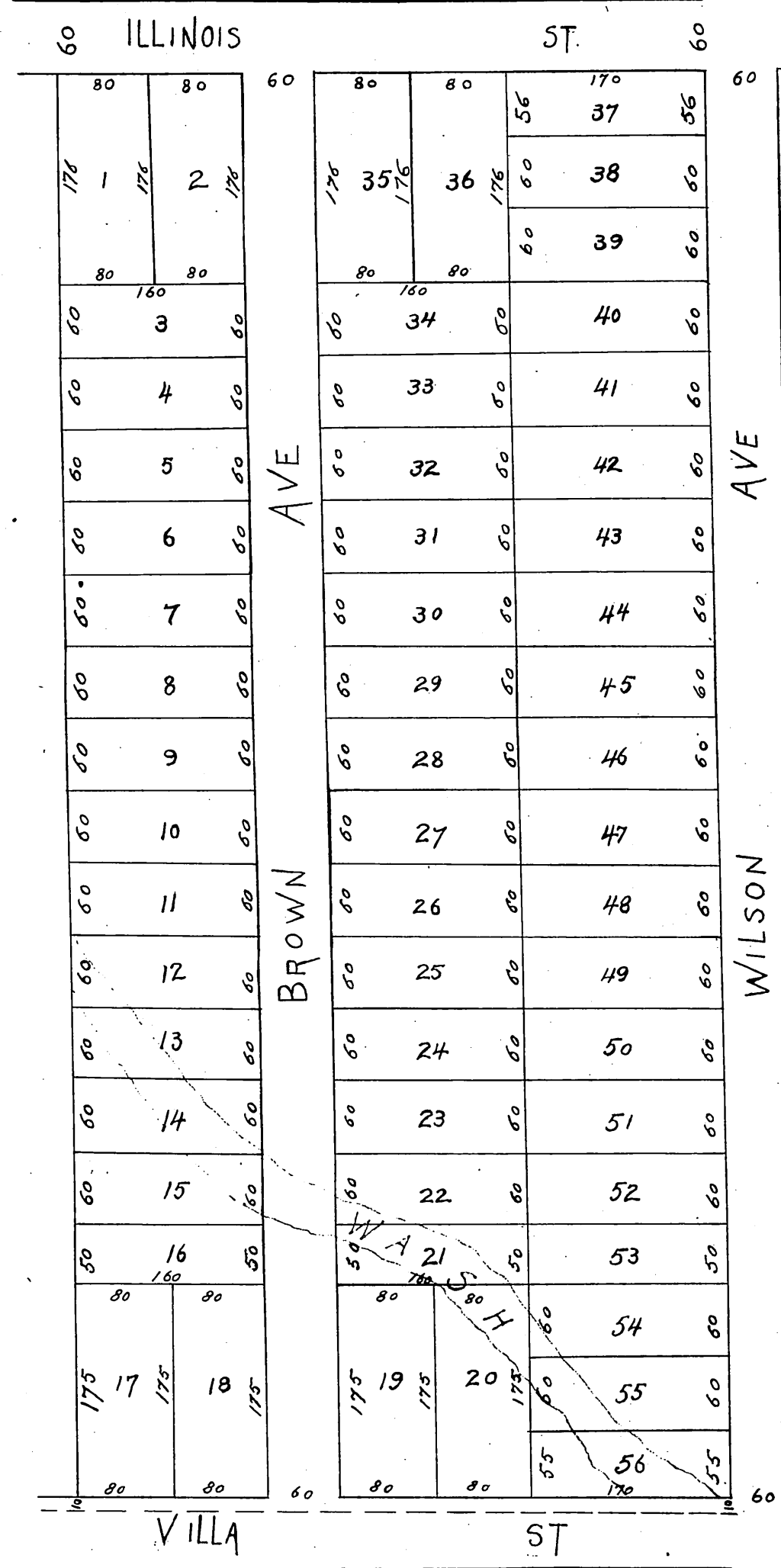

*REDUCED TO A SCALE OF 120 FEET TO THE INCH.  
 RECORDED AUG. 20, 1887 AT REQUEST OF G. S. MAYHOU.  
 Surveyed July, 1887 by F. H. Post, C. E.*

*Vacation of Brown Ave. 42-3.*

*Completed  
 6/1/1887*