

Handwritten mark at top left corner.

Map of
HERMITAGE
SANTA ANITA RANCHO
LOS ANGELES CO. CALIF.
SCALE 200 FT TO 1 INCH

Cambell and Marsh
Draughtsmen.

(Reduced to a scale of 250 ft. to the inch)
Recorded Sept. 2, 1887. At the request of
H. H. Marham.

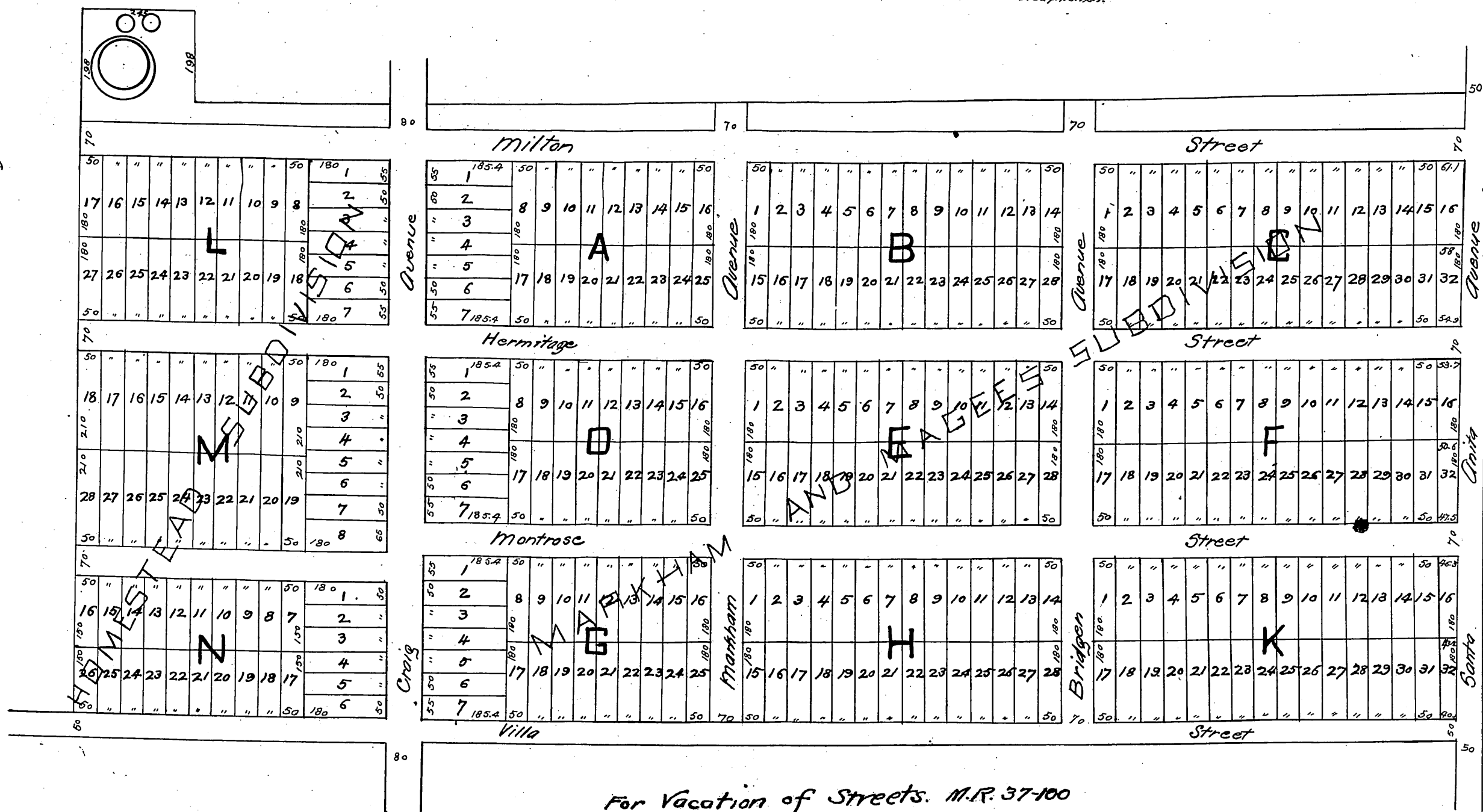

For Vacation of Streets. M.R. 37-100

