

Hilbish Subdivision

South 21st & 29th Providencia

W.S. Hall C.E.

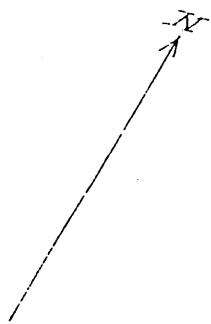
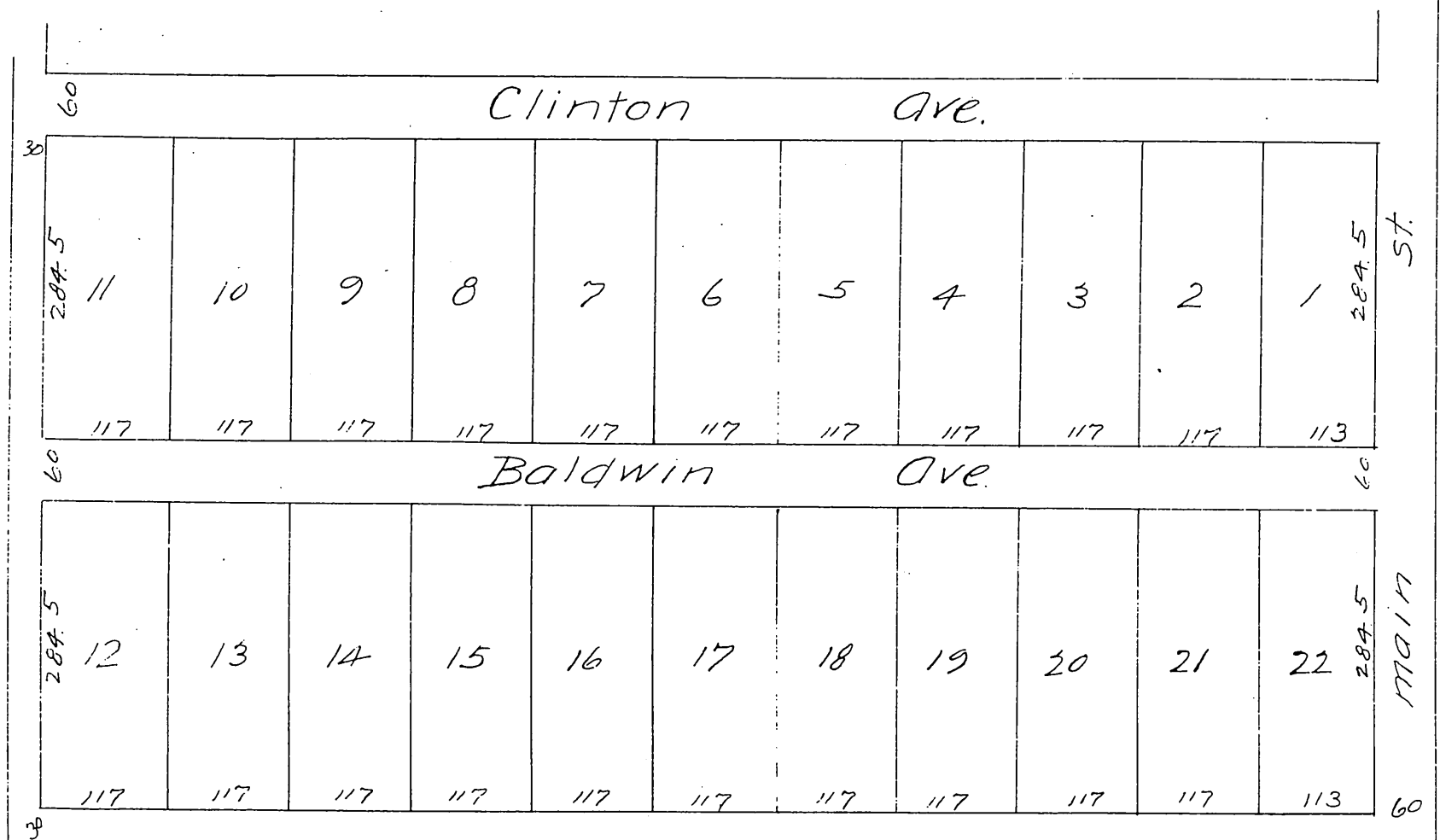

A full, true and correct copy of the original.
 (reduced to the scale of 150 feet to one inch)
 recorded Sept 13, 1887 at 21 min past 11 A.M.
 at request of J.M. Hilbish

Frank A. Gibson County Recorder.

By George Bugbee Deputy