

# MAP OF C.B. Warren's Subdivision. Pasadena Cal.

Kinnear and Warren Surveyors Los Angeles Cal.

Scale 50 ft. = 1 in.

Being the W 1/2 of Lot 1 Block 2 of the San Pasqual Tract. the same is shown on a map of said tract is recorded in Book 3 Page 315 of Miscellaneous Records in the office of the County Recorder of Los Angeles County State of California containing 5 acres.

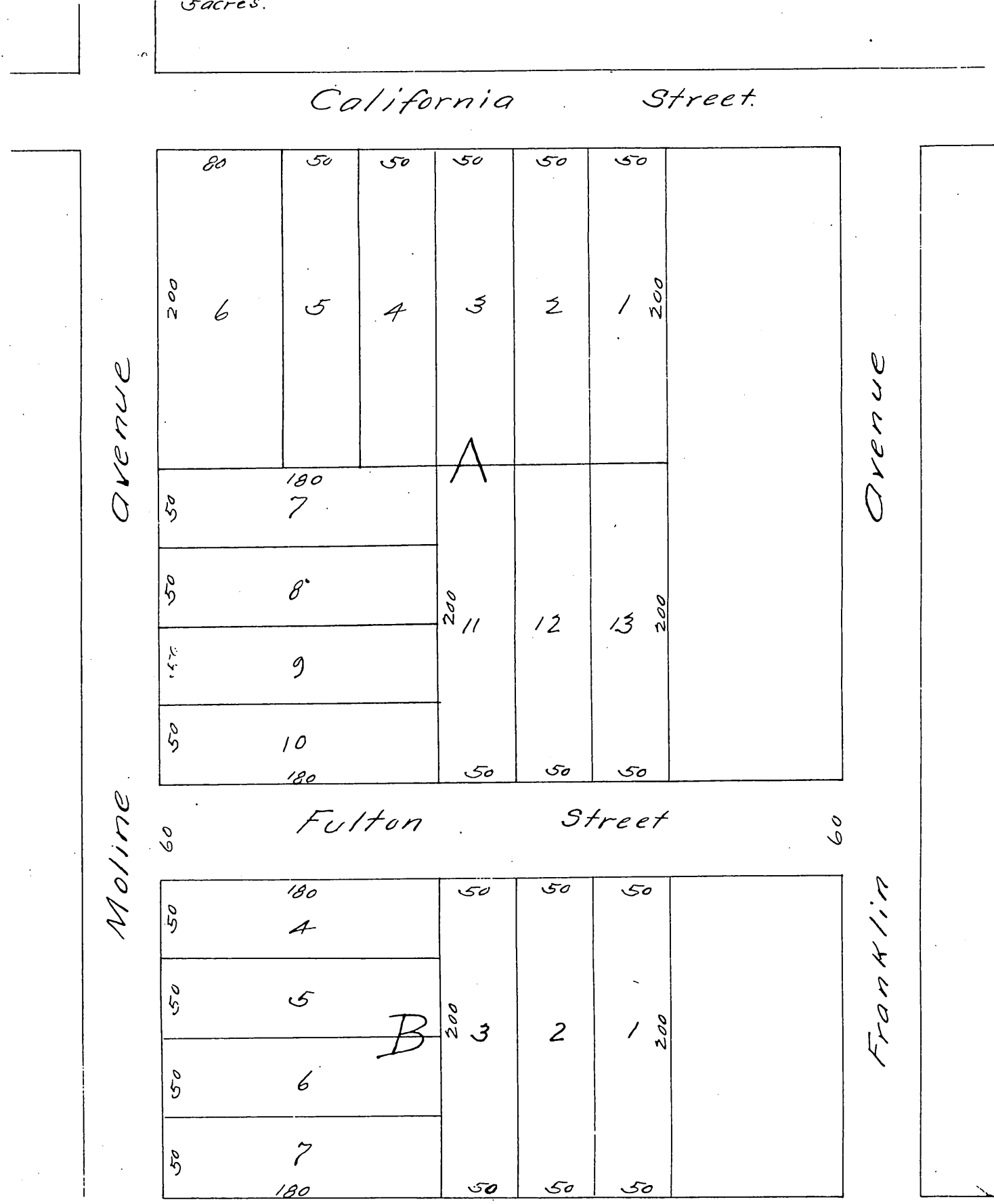

A full true and correct copy of the original (reduced to the scale of 80 feet to one inch) recorded Sept 19<sup>th</sup> 1887 at 10.2 a.m. at request of Mrs G.R. Warren.

Frank A Gibson County Recorder  
B George Wugbee Deputy.