



# MAP of Southern Part of HUNTINGTON.

laid off by J. F. Towell being part of the  
Sierra Madre Villa Tract.  
Santo Anita Rancho, Los Angeles Co., Cal.

H. J. Stevenson, Surveyor 1887.  
Scale 200ft to 1 inch.

Being the Southern fifty acres conveyed by S. D. Hovey to J. F. Towell by deed dated 6<sup>th</sup> February 1886, and recorded in the office of the Recorder of said County of Los Angeles, in Book 150 of Deeds at page 637, and more particularly bounded and described as follows - Commencing at the SW corner of the 102<sup>65</sup>/<sub>100</sub> acre tract of a point in the County Road which bounds said tract on the South, thence through said road North 89° 18' E 24<sup>58</sup>/<sub>100</sub> chains to the SE corner of said 102<sup>65</sup>/<sub>100</sub> acre tract; thence N 64° 5' East 21<sup>54</sup>/<sub>100</sub> chains, thence West 23<sup>33</sup>/<sub>100</sub> chains to West line of said tract, thence along said West line, South 13° 10' W 7<sup>13</sup>/<sub>100</sub> chains, S 8° 45' W 14<sup>22</sup>/<sub>100</sub> chains; S 2° E 0<sup>68</sup>/<sub>100</sub> chains to place of beginning, Subject to a reservation of 68 links in width off South line of said tract for County road and a strip 15 feet wide off East side for Private road to the Sierra Madre Villa, said tract containing 50 acres clear of said reservations.

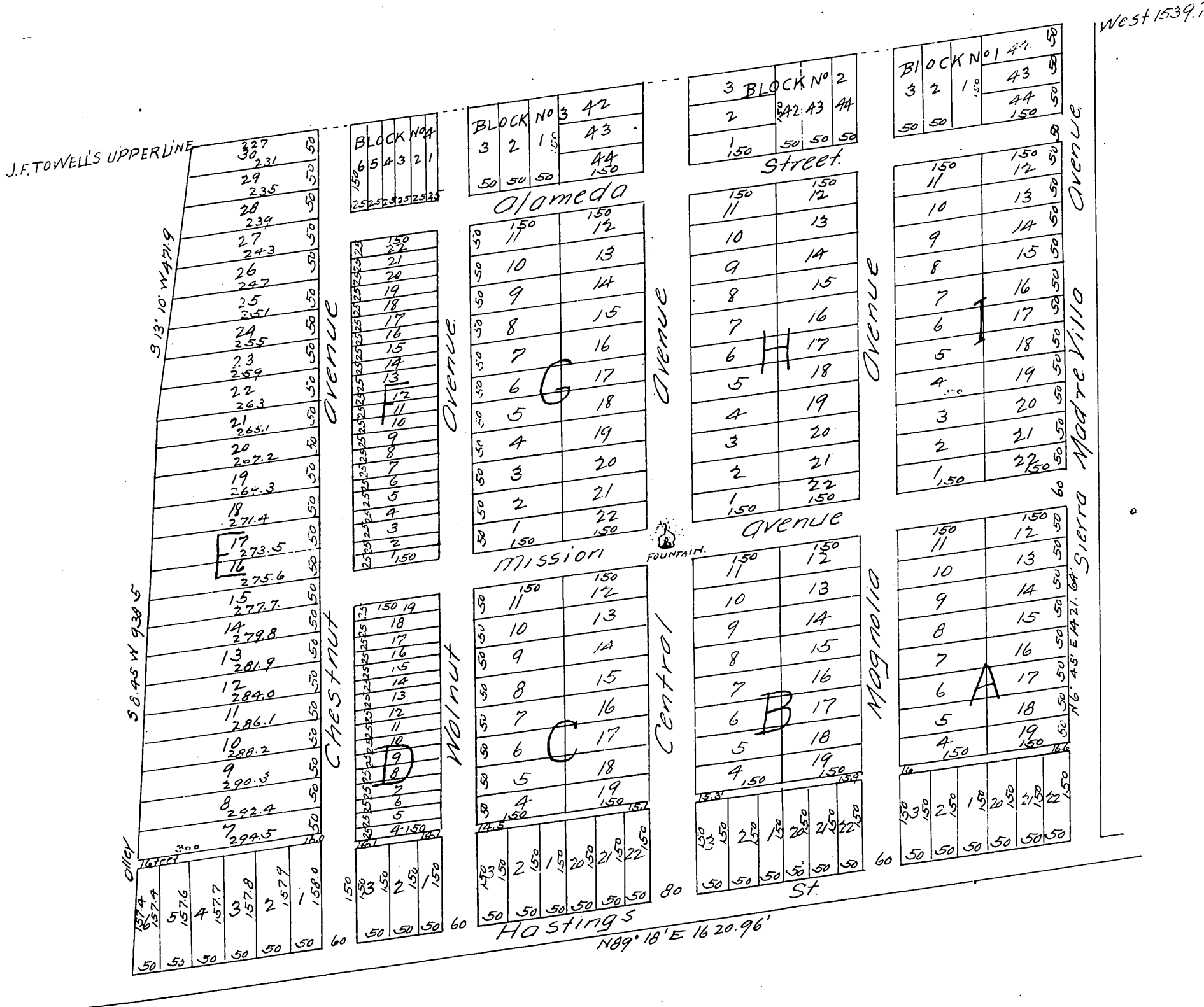

A full, true and correct copy of the original, recorded Sept 21, 1887  
at 1:44 PM at request of J. F. Towell.  
Frank A. Gibson County Recorder.  
By George Bugbee Deputy.