

MAP
of the
Subdivision of Lot 5 of the N¹/₂ of Lot 7,
Block 73, Hancocks Survey,
Las A. City Cal.
Surveyed Sept 1887 by E.G. Jones
Scale 50' = 1"

Aliso Ave Extension.

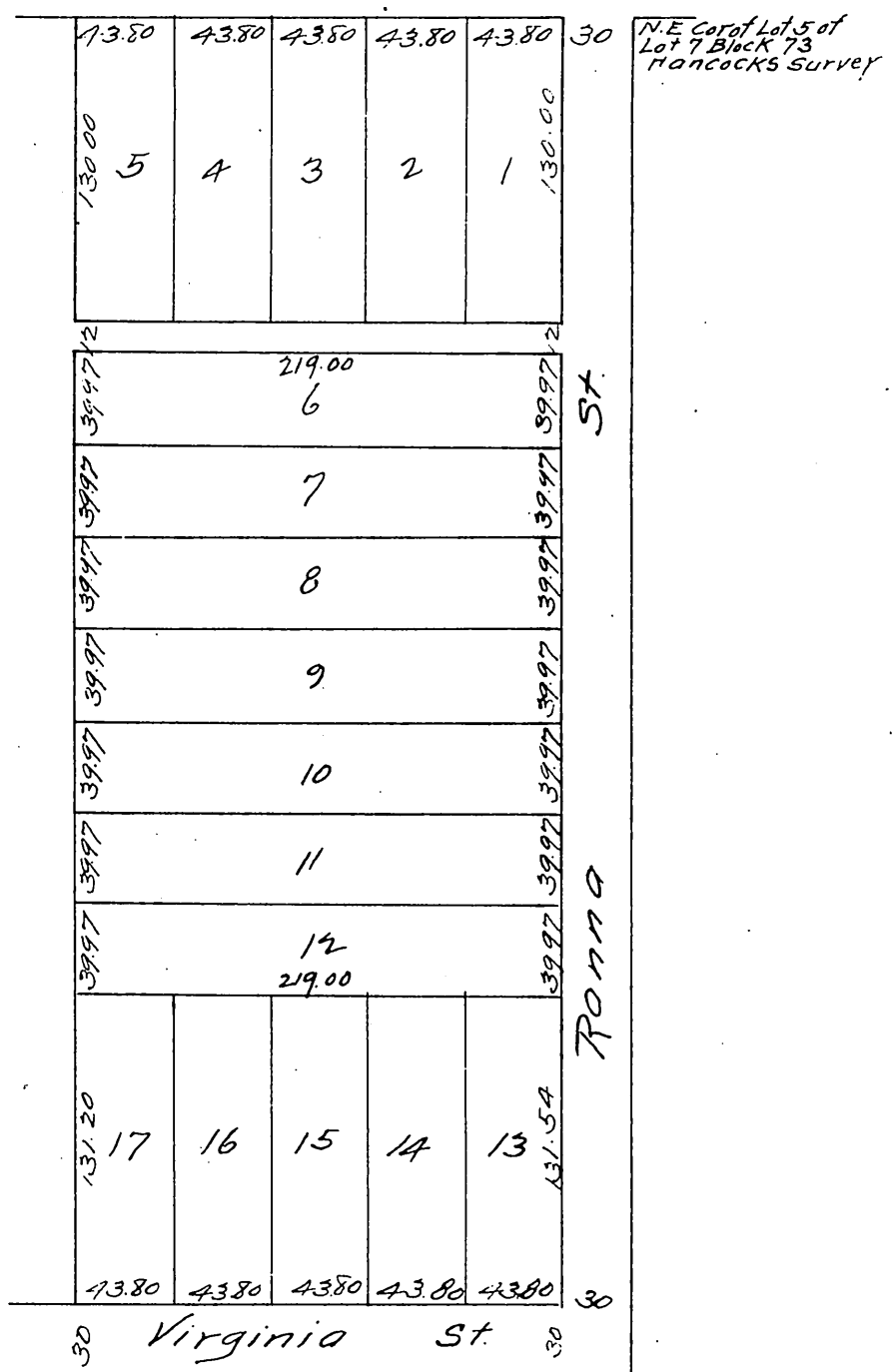

A full, true and correct copy of the original, (reduced to the scale of 80 feet to one inch) recorded Sept 24 1887 at 2 P.M. at request of O. O. Rolfe.
Frank A Gibson County Recorder.
By George Bugbe Deputy.