

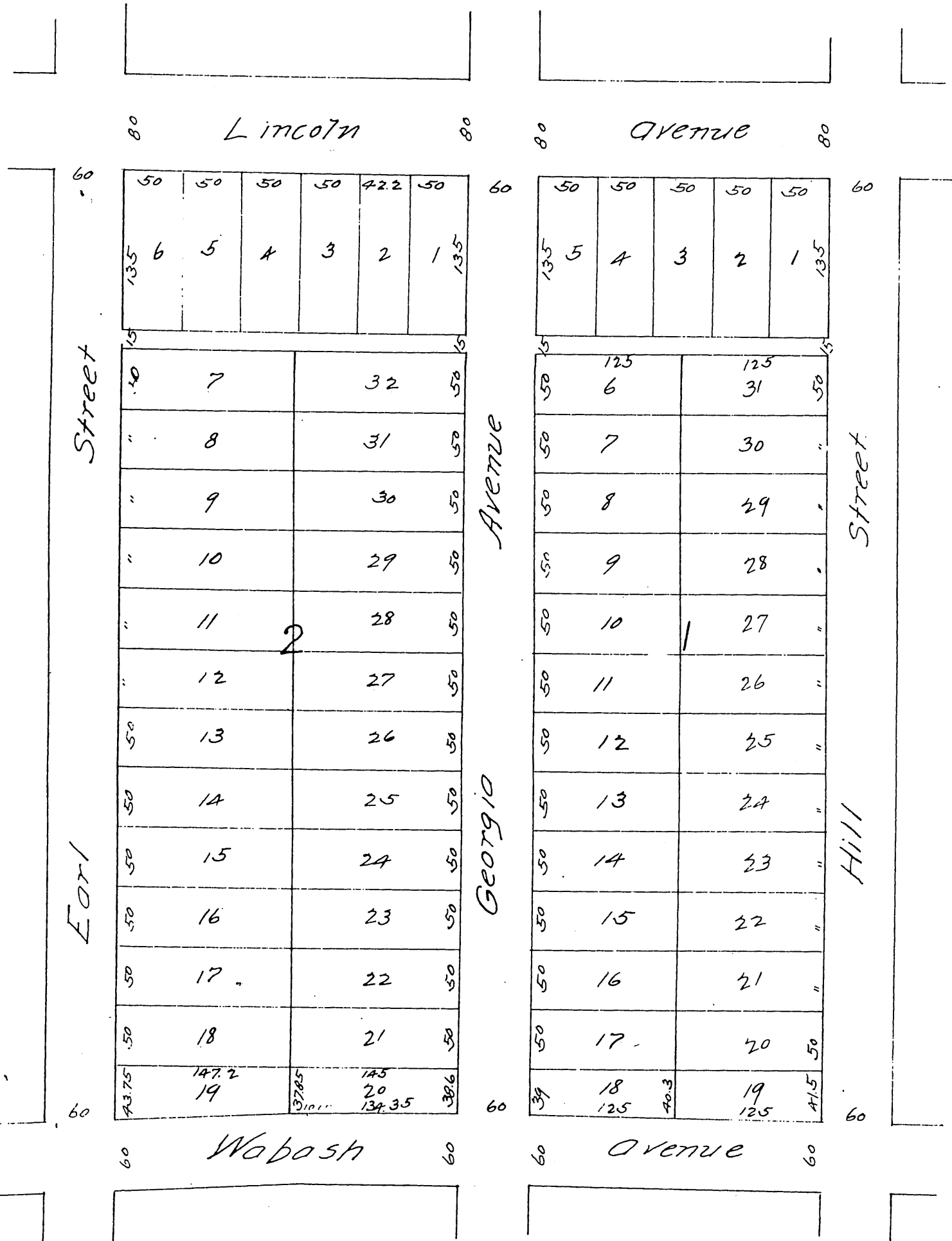

# MAP of THE DODD TRACT Los Angeles, Cal.

Subdivision of Block 35 Lick Tract.  
Surveyed by Kinnear & Warren, Los Angeles Cal.

Scale 50ft = 1 in.



A full true and correct copy of the original, reduced to the scale of 100 feet to one inch, recorded September 24<sup>th</sup> 1887 at 19 min past 4 P.M. at request of W. A. Johnson.

Frank A. Gibson County Recorder.  
By George B. Ingber Deputy.