

MAP
of
L.D. Conner's Subdivision

Block 153

TOWN OF POMONA CAL
Jas. T. Taylor & Co. Surveyors
Scale 60ft = 1 inch
September 1887.

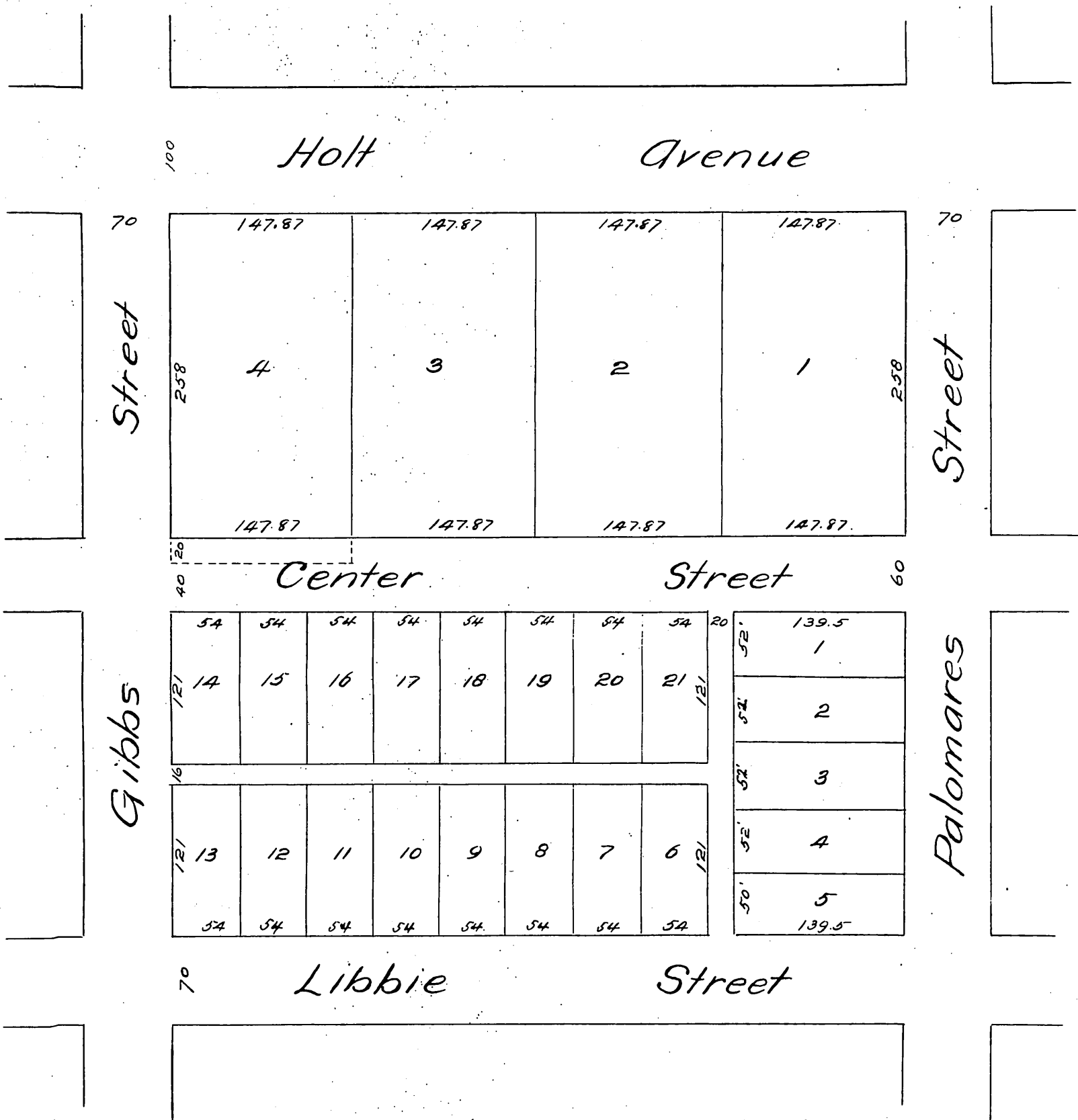

A full, true and correct copy of the original
reduced to a scale of 100 feet to the inch re-
corded Oct. 4, 1887, at 10.31 A.M. at request
of Jas. T. Taylor.
Frank O. Gibson County Recorder.
By George Bugbee, Deputy.