

PLAT  
 OF  
 GARNSEY & MCFARLAND  
 Subdivision of the west half of Lot 1, Block B of the  
 MARENGO TRACT  
 SOUTH PASADENA  
 CAL

S. D. Kendall, Surveyor.  
 Sept. 1887.

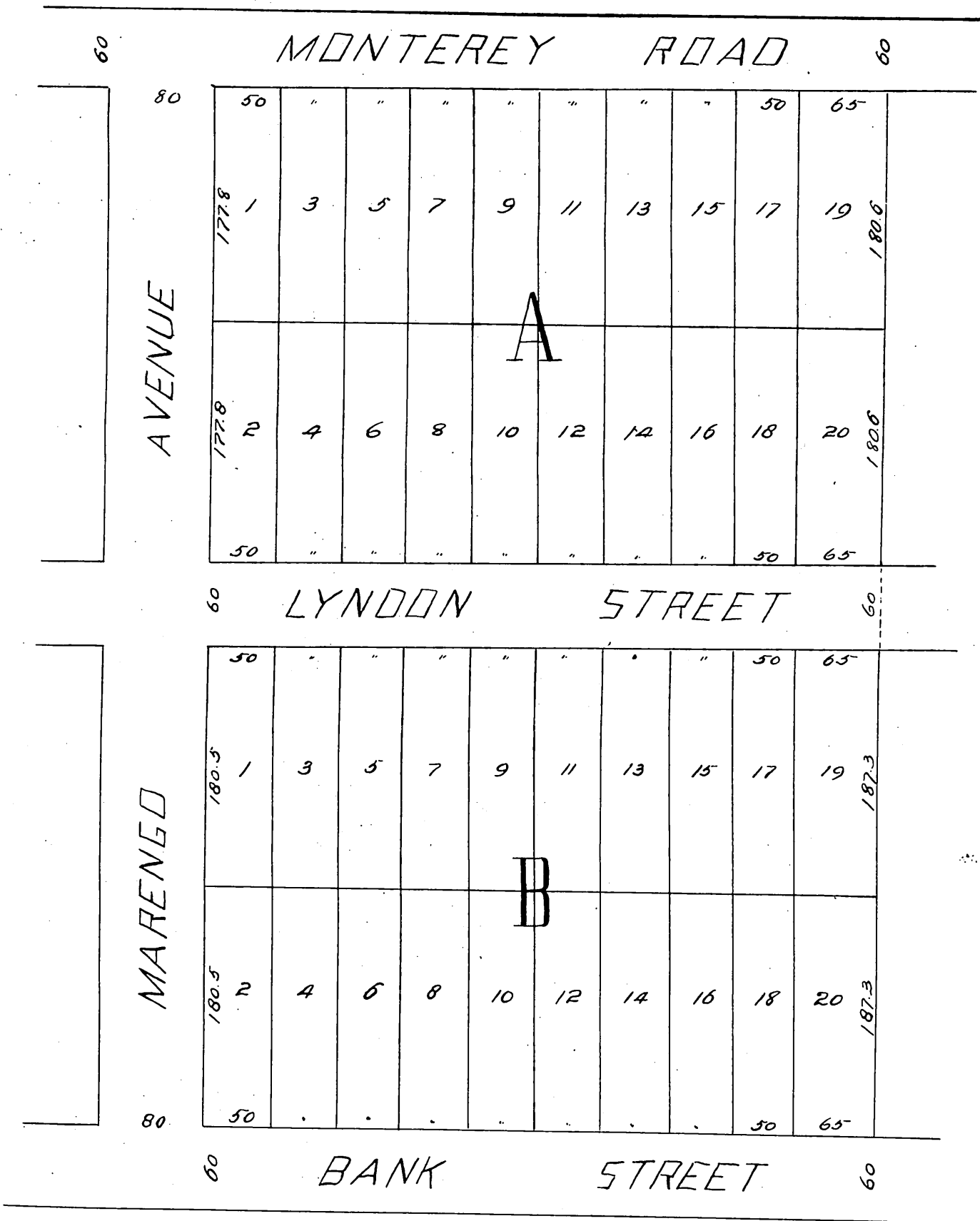

A full true and correct copy of the original  
 recorded Oct 4 1887 at 12.45 M at request of  
 M<sup>c</sup>Farland & Garnsey  
 Frank A. Gibson, County Recorder.  
 By George Bugbee Deputy.