

"VERNON"

MAP OF H.M. AMES

First Subdivision of "Vernon"

Being a portion of the N.E. 1/4 of N.E. 1/4 of Sec. 17, T2, S.R. 13, W. S.B.M.

This Subdivision is all of the land obtained and conveyed to H.M. Ames by deed to him from Edwards & Snell filed July 23 1887, Tyler to Ames filed Aug 2 1887 and from Bluett, filed Aug. 19. 1887.

LOS ANGELES CO. CAL.

Surveyed June 1887

by
W.H. PINKER

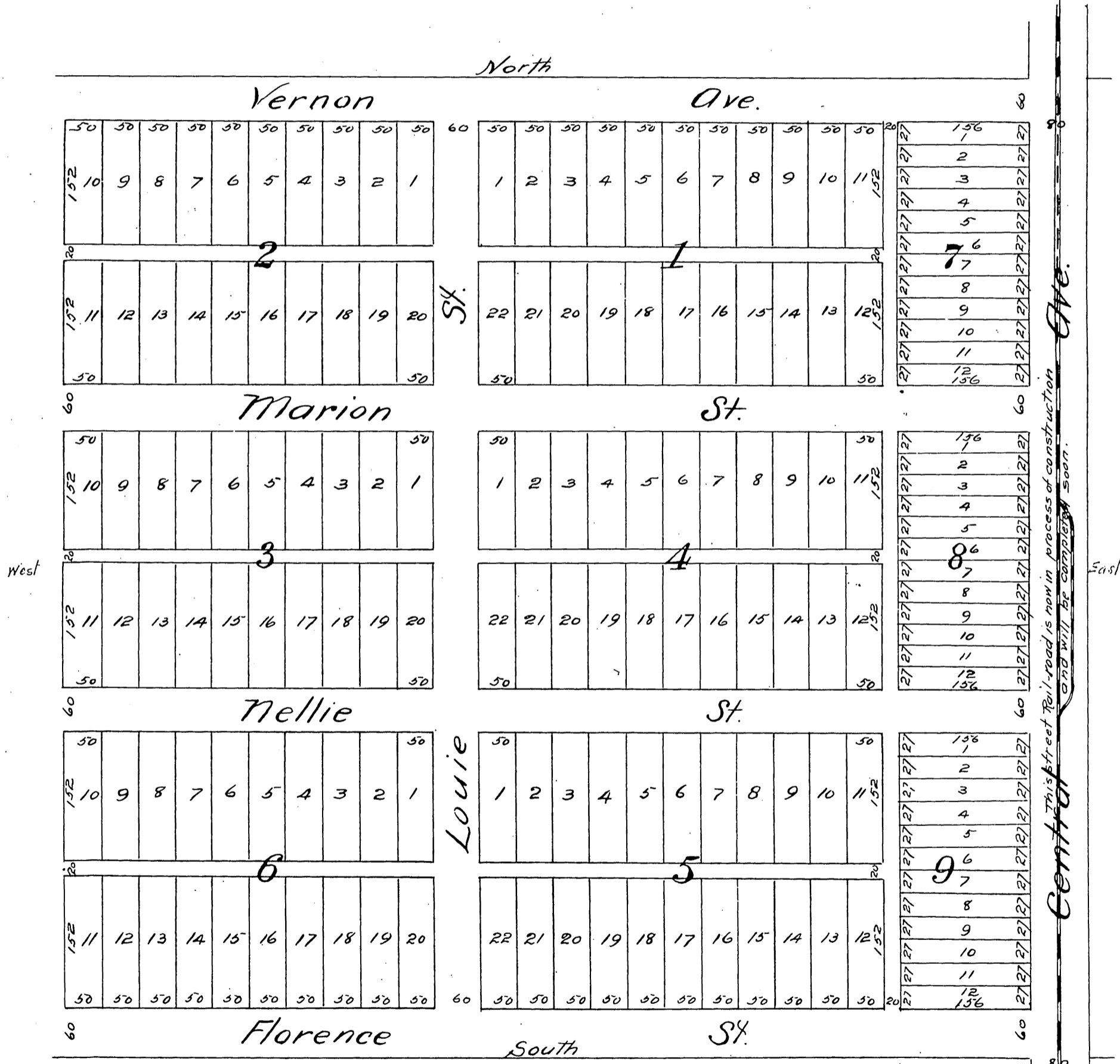

A full, true and correct copy of the original, reduced to 1/2 size, recorded, Oct 6 1887 at 9.25 A.M. at request of H.M. Ames.
 Frank A. Gibson, County Recorder.
 By George Bugbee, Deputy.