

Mountain View Tract

Being a Subdivision of the West half of Lot 1,
of Block 72
Hameock's Survey

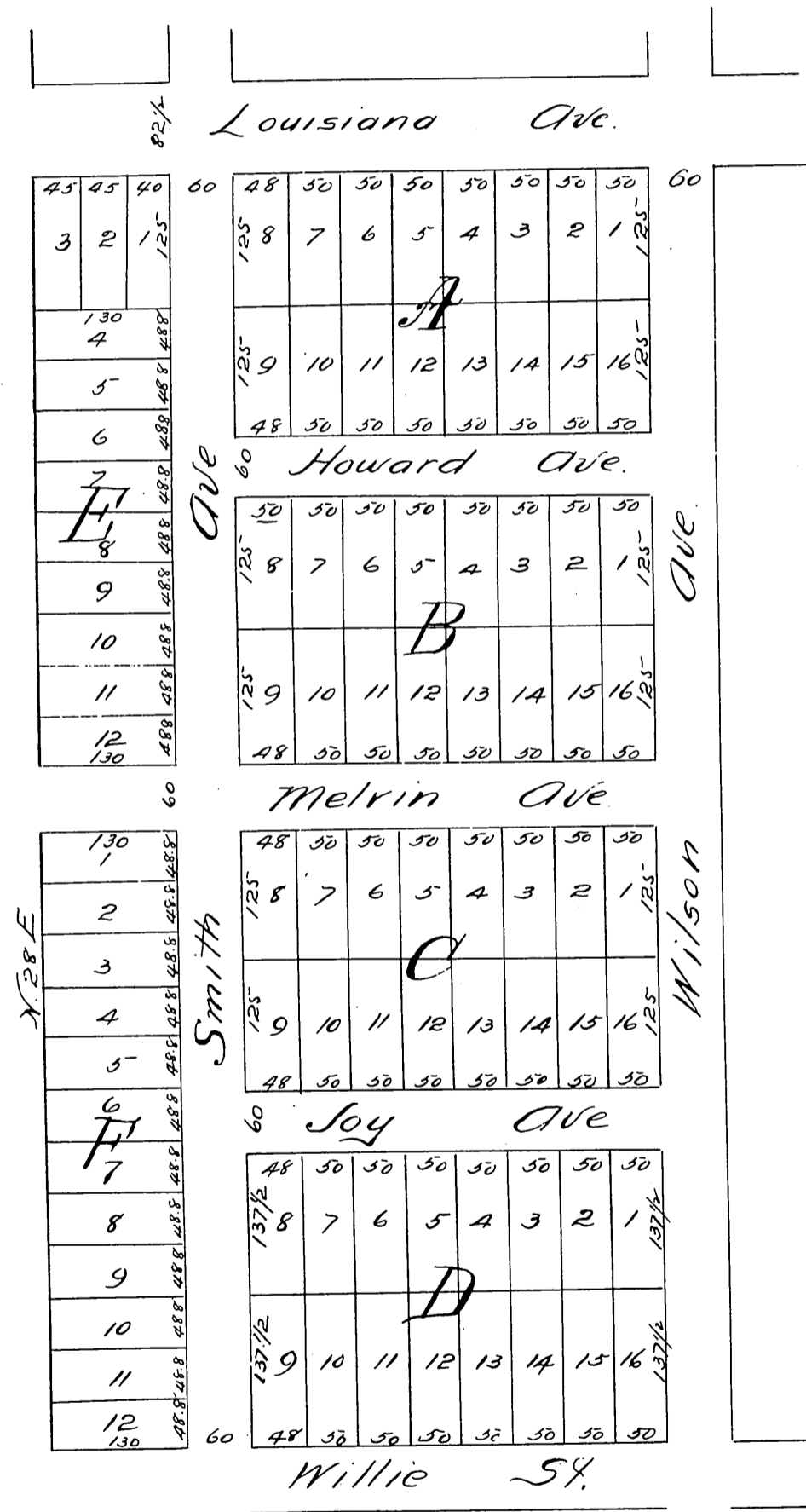

A full, true and correct copy of the original (reduced to the scale of 150 feet to one inch) recorded October 18th 1887 at 10 Min past 3 P.M. at request of W. J. Smith.
Frank A. Gibson Co. Recorder
by George Young, Deputy.