



# Map

of

## Barlow & Worthington's

Sub'd of

Lot 8 of Wilkinson's Sub'd

of

Lot 1 Blk 61 H.S

Recorded B5 pp. 513 M.S.

Los Angeles Cal.

Dec 13, 1887 L.H. Carver C.E.

Scale 50 ft = 1 in

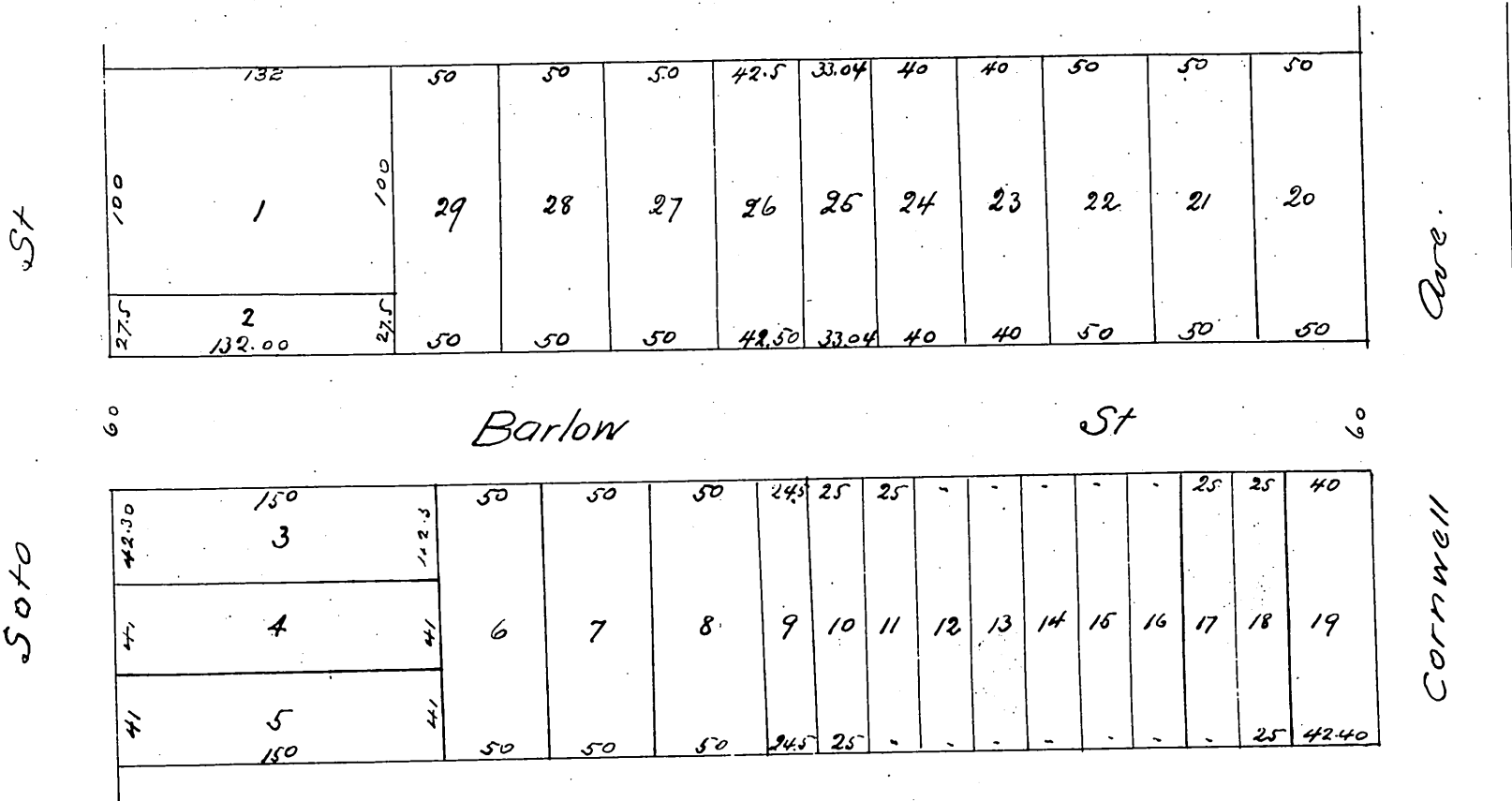

A full true and correct copy of the original (reduced to the scale of 80 feet to 1 inch) recorded December 14<sup>th</sup> 1887 at 12:29 M. at request of Barlow and Worthington  
 Frank A. Gibson County Recorder  
 by Wm. E. Johnston Deputy.