

Subdivision of the Durant Tract

Pasadena Cal
Surveyed by Mount and Drummond Nov 1887
Scale 75 feet to 1 inch

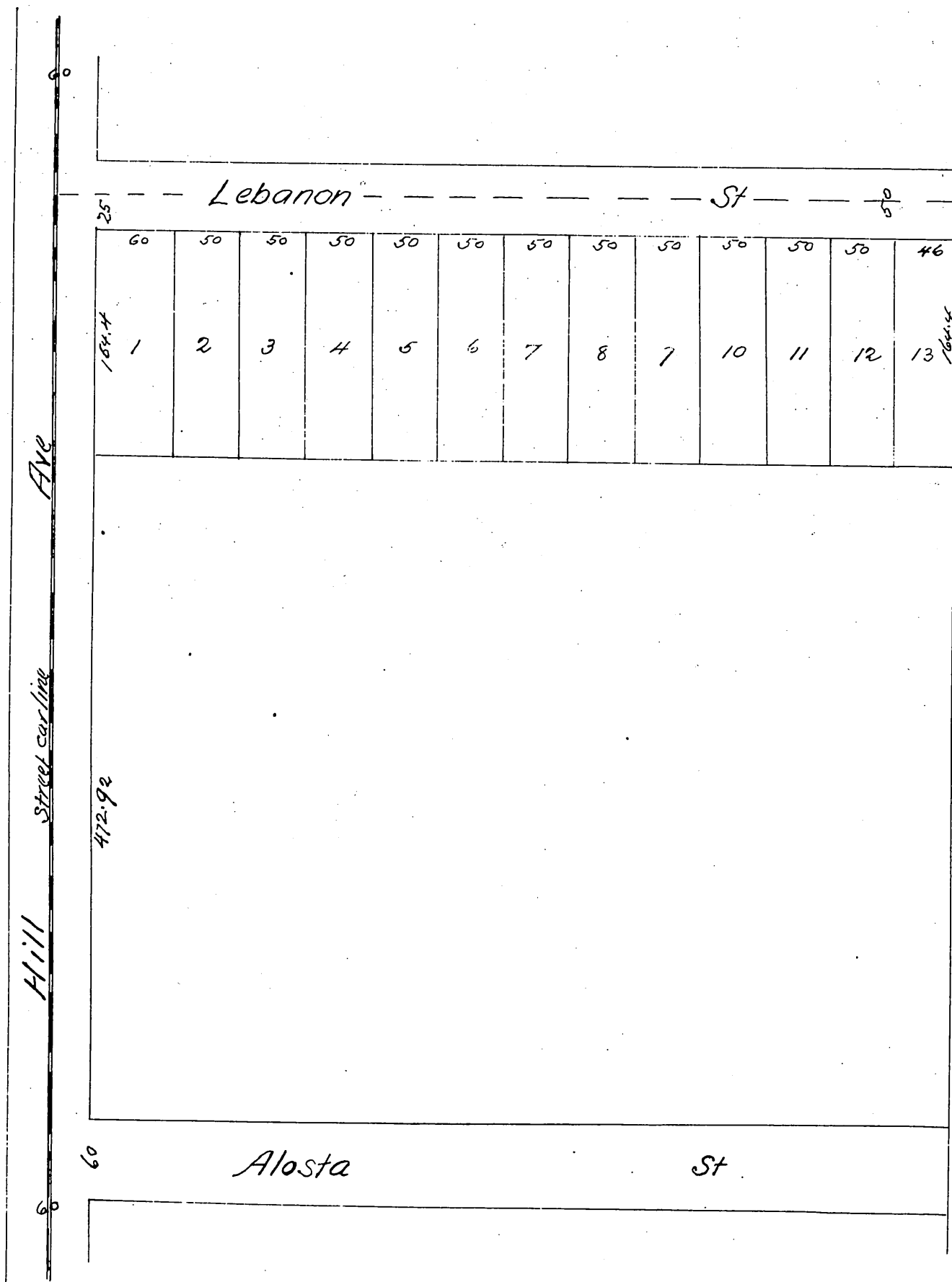

A full, true and correct copy of the original reduced
to the scale of 100 feet to 1 in. (1 inch) recorded Dec. 19th 1887
at 3:25 P.M. at request of C.C. Baynton
Frank A. Gibson Co. Recorder
by Wm. E. Johnston Deputy