

MAP  
OF  
R. Zellner's Subdivision  
of a part of Block 8, Los Angeles Homestead Tract.  
Los Angeles County Cala

Surveyed and plotted June 1888 by Clarence A Miller.  
Scale 75 feet = 1 inch.

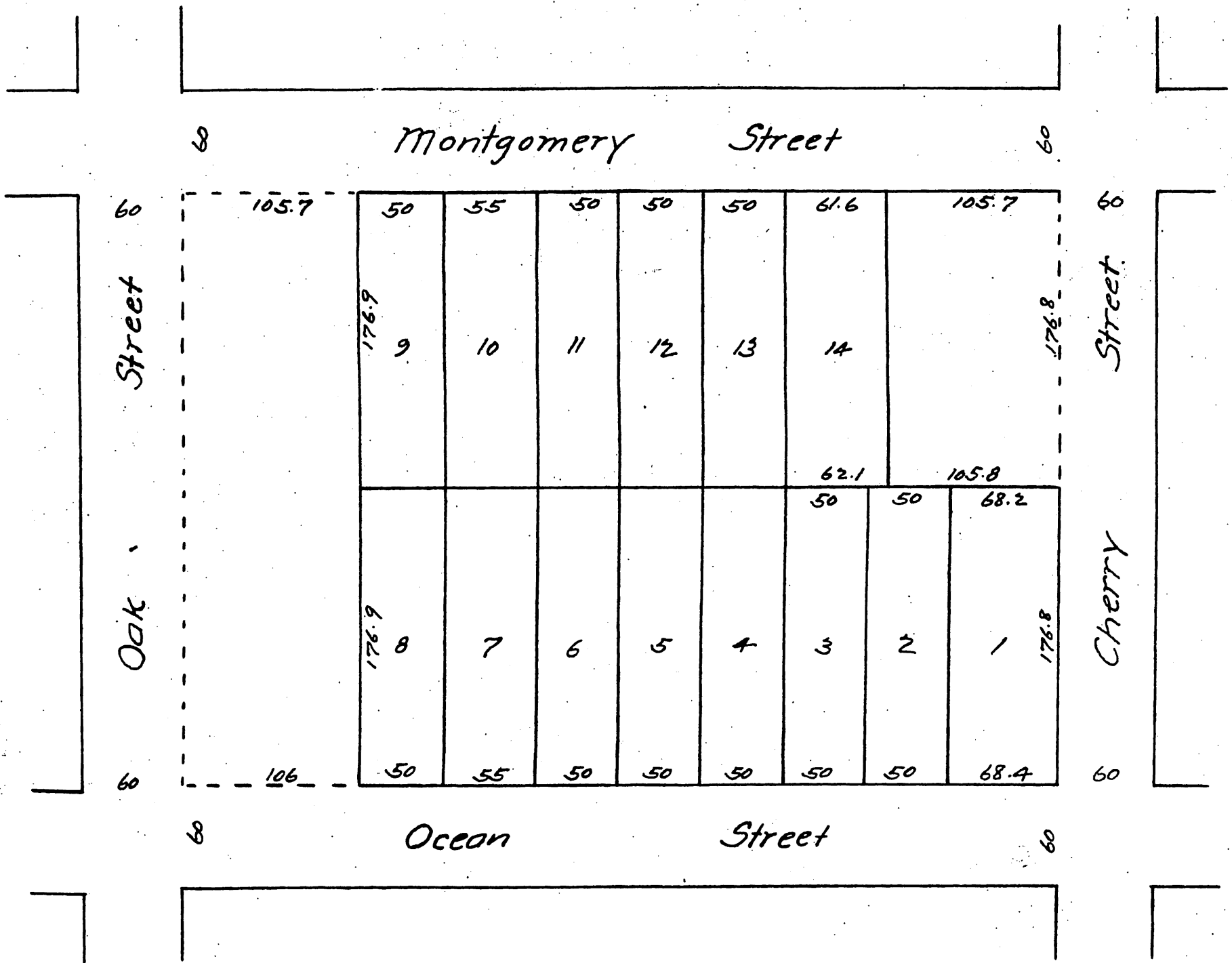

A full, true and correct copy of the original  
recorded Aug 18, 1888 at 49 min past 4 P M at  
request of R Zellner

Frank A Gibson, County Recorder.  
By George Bugbee Deputy