

MAP  
 OF  
 Lewis and Hammond's  
 Subdivision of Lots 23 and 24 in Blk 22  
 Town of Whittier  
 Los Angeles County California

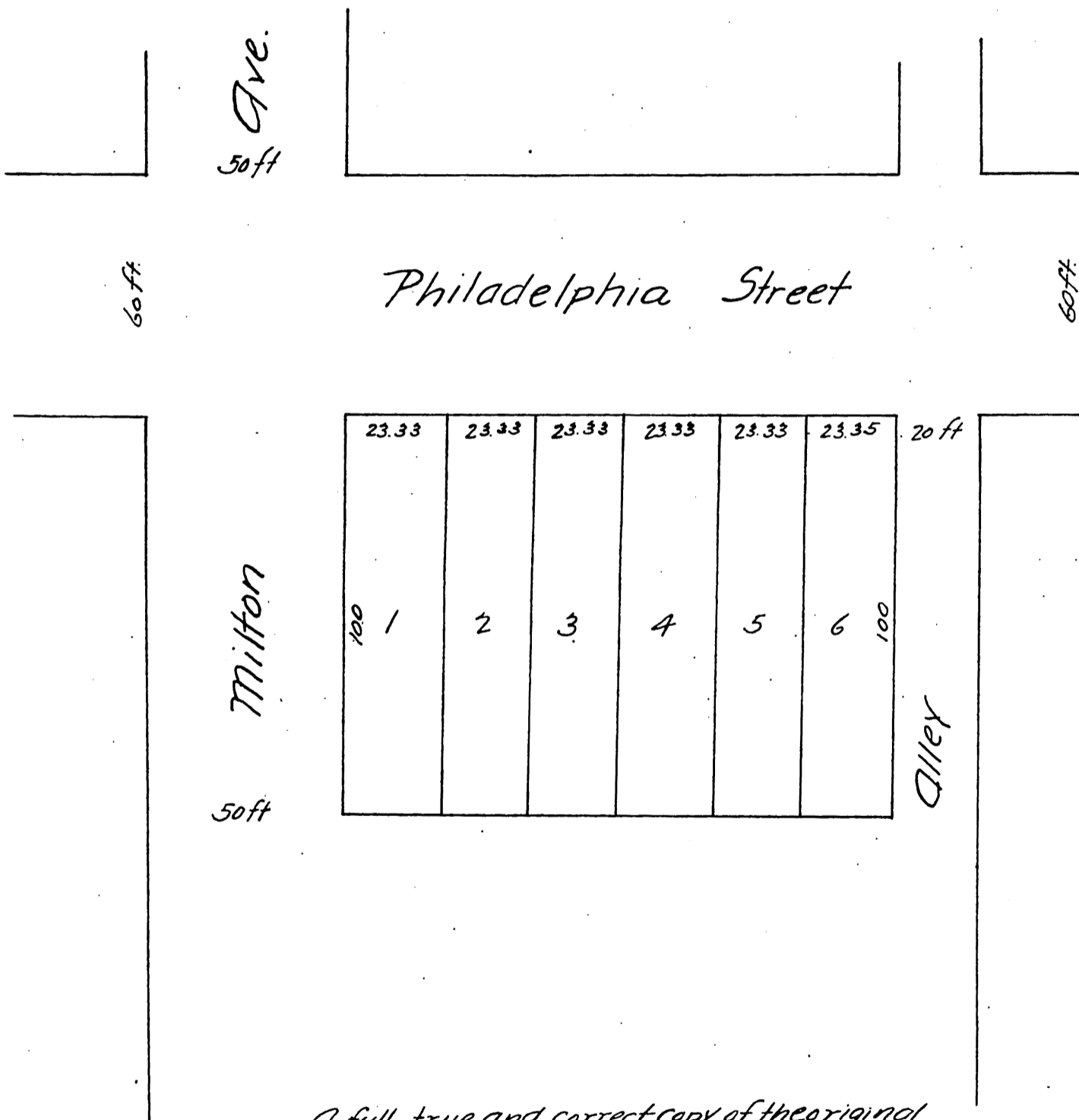

A full, true and correct copy of the original  
 recorded August 30, 1888 at 18 min past 3 PM  
 at request of M. C. Lewis.  
 Frank A. Gibson, County Recorder.  
 By George Bugbee Deputy