

MAP
 OF THE
 Logan Tract
 Being the subdivision of Lots 13, 14, 15, 16 & 17
 of Strohm's subdivision of Lot 5 Freeman
 Tract and 1/2 of Tr marked J.P. Crashtwaite
 Surveyed May 1888 by E.G. Jones
 Scale 50 feet = 1 inch

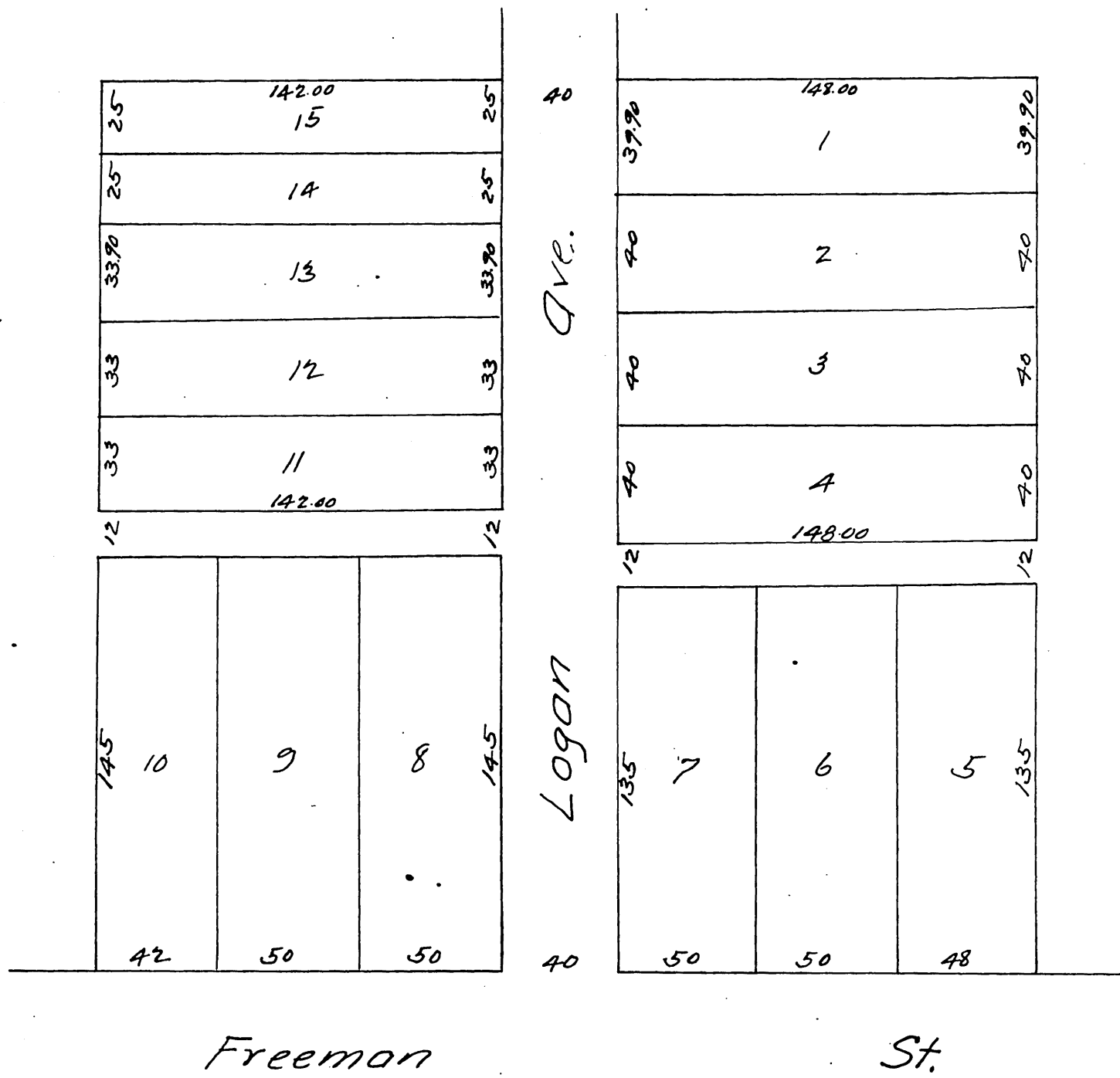

A full, true and correct copy of the original
 recorded October 6, 1888 at 59 min Past 2 P.M.
 at request of J. A. Griffes
 Frank G. Gibson, County Recorder.
 By George Bugbee Deputy.