

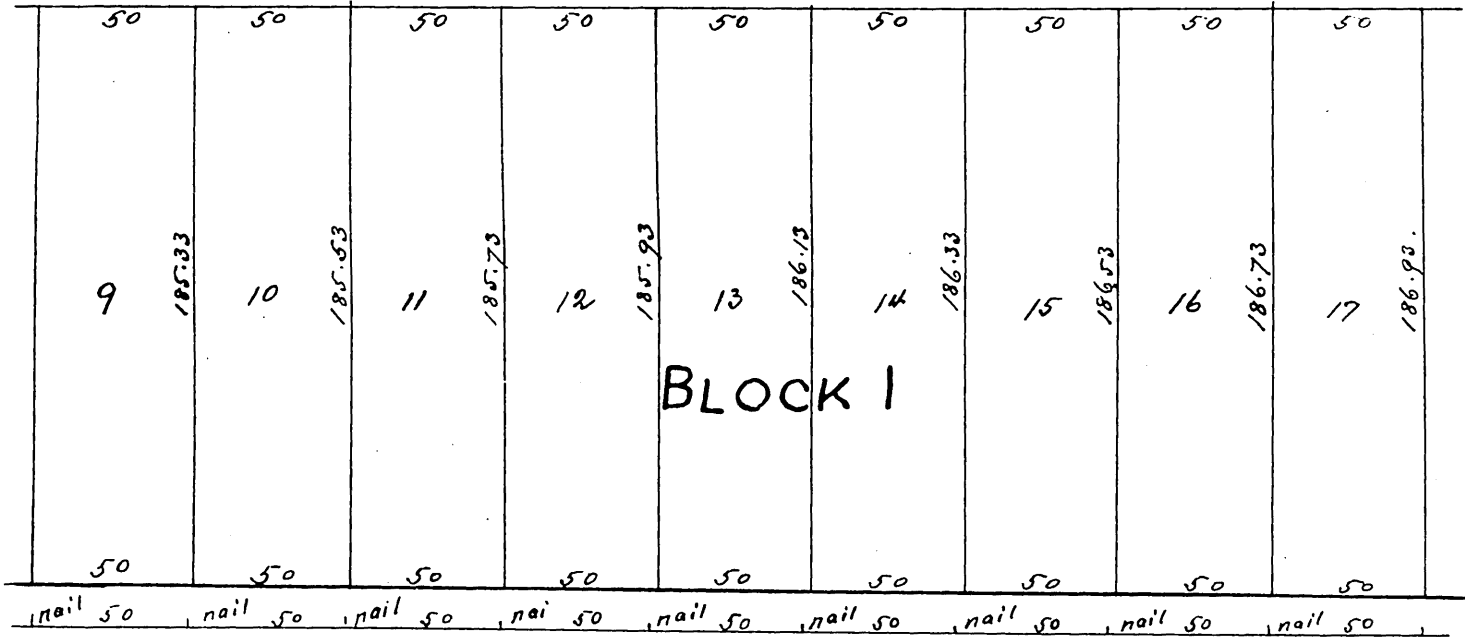

NOTE The Mason Tract is a subdivision of the southerly one half of Lot 5 Block 2 Hancock's Survey, City of Los Angeles California, and also a certain parcel of land conveyed by H.C. Austin to Guadalupe Mason located in lot 5 Block 2, Hancock's Survey, and adjacent to the northerly line of the southerly one half of Lot 5 Block 2 Hancock's Survey

Fences shown thus are on the lands of Guadalupe Mason
Curb lines thus



THIRTY THIRD STREET

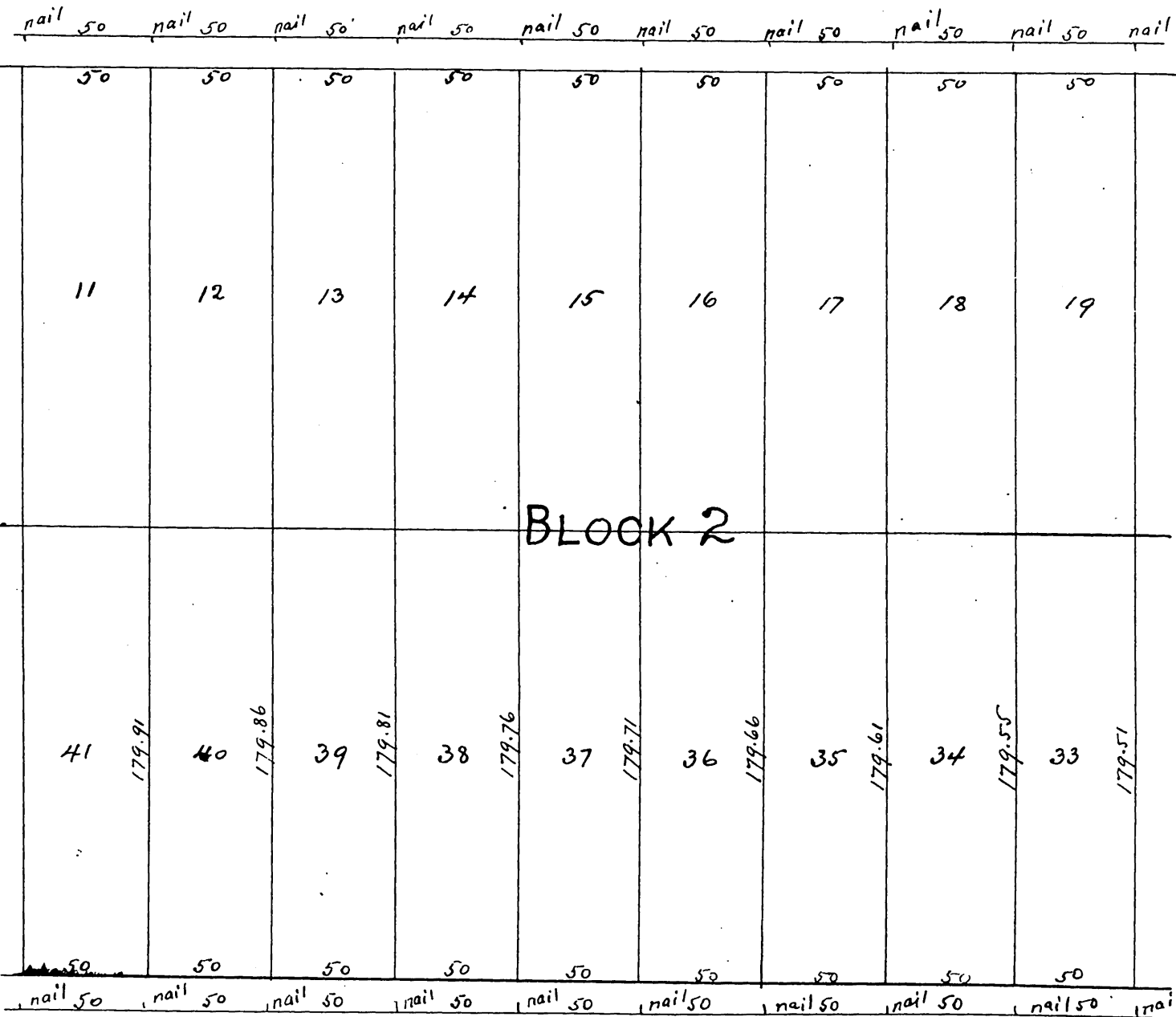

JEFFERSON STREET