

Portion of Railroad Avenue
between Blocks 102 & H

as per B12 P61 & B10 P90 Miscellaneous Records of
Los Angeles Co. Vacated April 7, 1888, by order of
Honorable Board of Supervisors of Los Angeles
County

85

Scale 150 FT. = 1 IN.

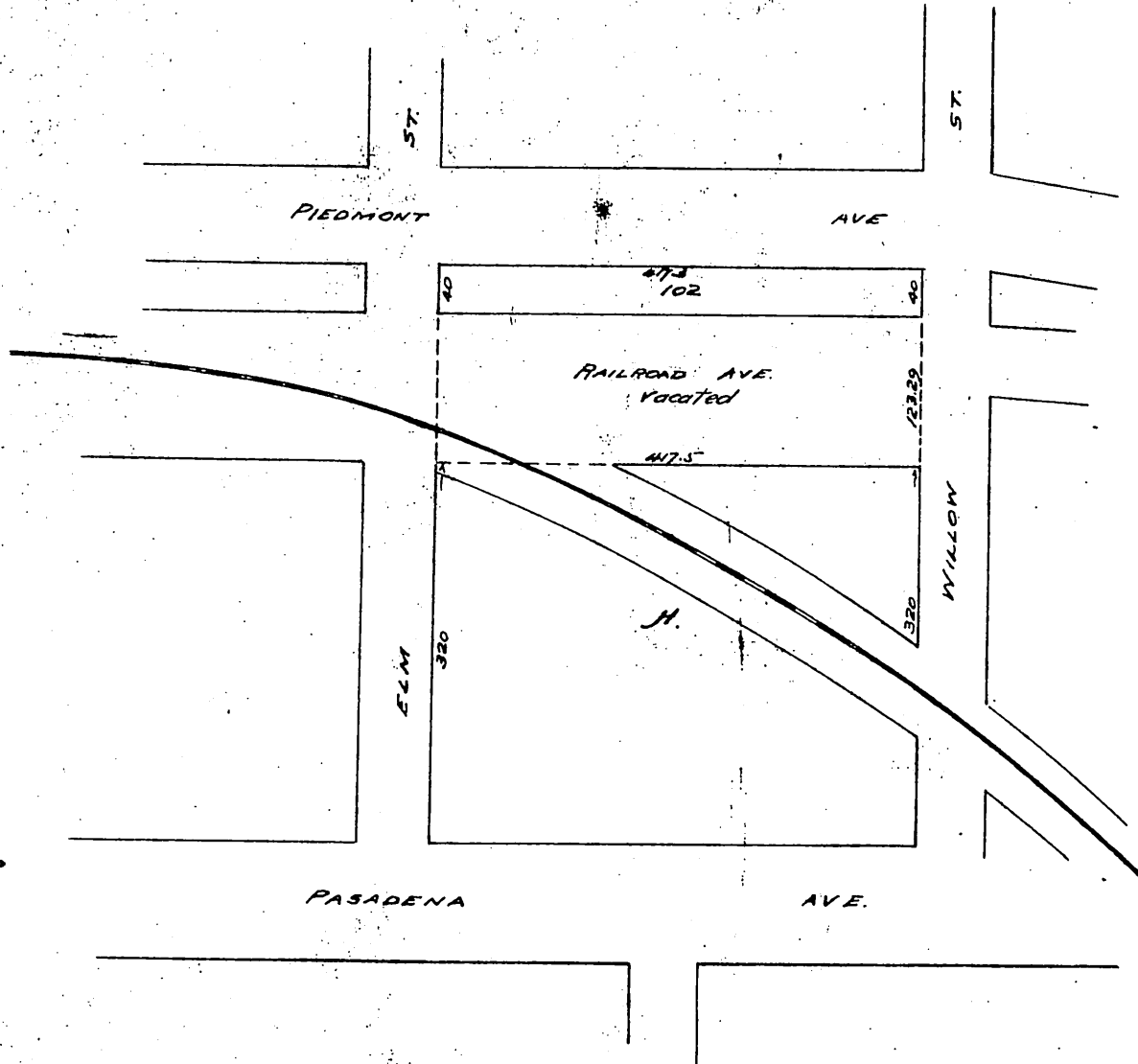

Saturday, April 7, 1888

In re Railroad Avenue

of Garvanza.

The following Petition read and filed. Los Angeles, Cal. April 7, 1888.

To the Honorable Board of Supervisors of Los Angeles County:

Your petitioners respectfully represent that on a map recorded by Ralph Rogers, one of the undersigned and now on record in Book 12, Page 61 Miscellaneous Records of Los Angeles County, being a map of the town of Garvanza, there is represented a street called Railroad Avenue, four blocks long and aligning the California Central Railway, that said street has never been formally accepted by the County and has only been dedicated to the extent of filling said map for record, but has never been opened nor used by the public.

That for Railroad purposes and for Depot Grounds it is found necessary to use that portion of said Street situated between Block 102 and Block H, as shown upon said map. That your petitioners are owners of said Two Blocks, and they now respectfully ask your Honorable Board to pass an order vacating so much of said Railroad Avenue as lies between the two blocks aforesaid and your petitioners will ever pray

CALIFORNIA CENTRAL RY. Co.

By D. McCool, General Manager.

RALPH ROGERS.

WHEREUPON Supervisor Martin moved that the prayer of petitioners be granted, and the land therein described be abandoned and vacated as a public highway. MOTION CARRIED.

A full, true and correct copy of the original
Recorded June 11, 1896, at 11 Min. past 3 P.M.
at request of S. Cal. Ry Co.

E. C. Hodgman - County Recorder.

By E. T. Wright

Co. Sur. and ex officio Dep. Co. Rec.