

Peck's Subdivision of Block 12 Carolina Tract.

According to a Map filed in the office of the
County Recorder of Los Angeles Co. Jan. 7. 1898
Scale 100'-1"

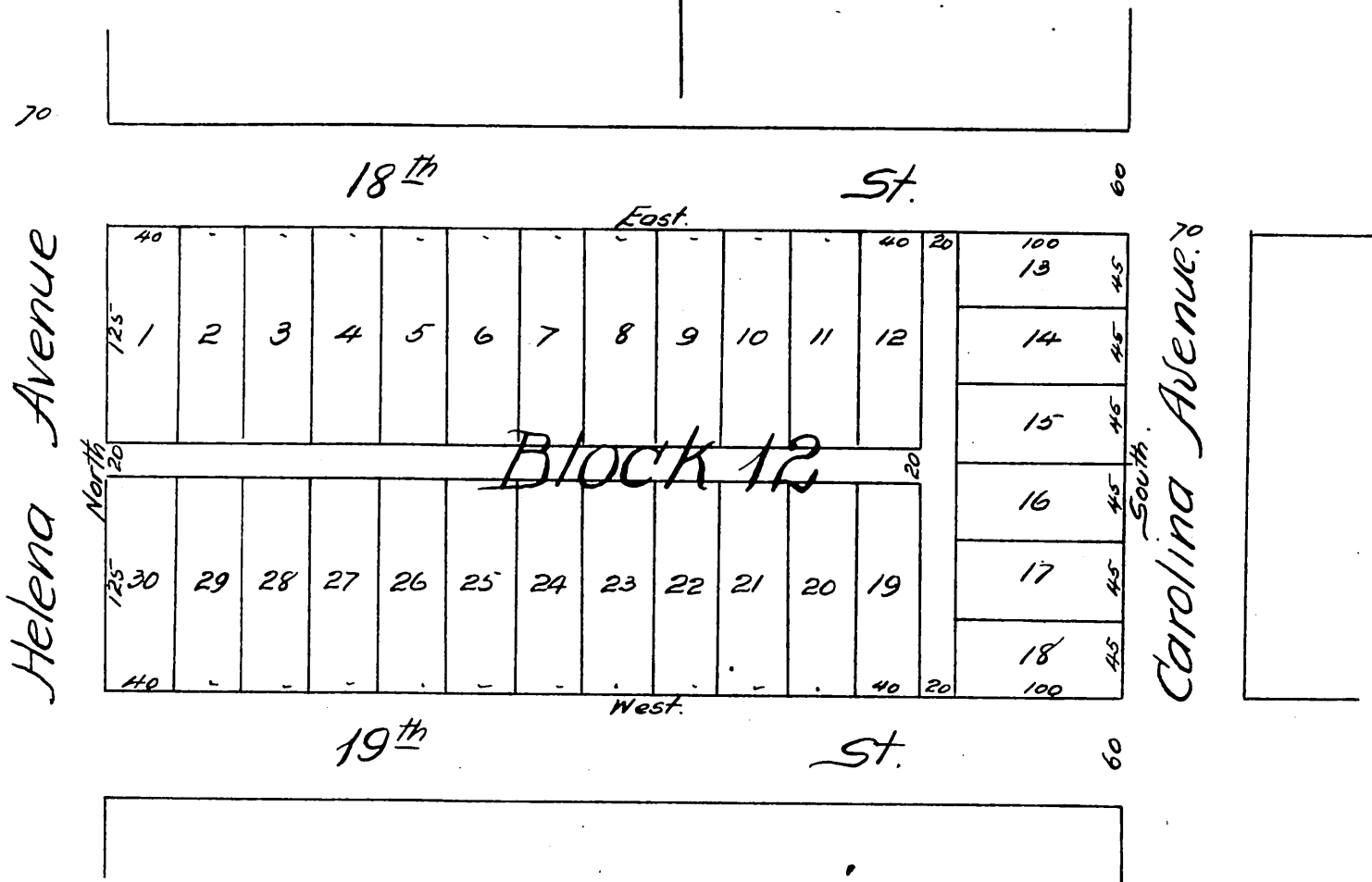

We hereby certify that we are the proprietors of the property subdivided as shown by this map, and, further that we caused such subdivision and map to be made and dedicate for public use the streets and alleys as shown on this map.

Geo. H. Peck Jr.
Roman D. Sepulveda.

A full, true and correct copy of the original
Recorded Feb. 8. 1899 at 35 Min. past 9 A. M.
at request of N. W. Tilton.

R. D. Wade County Recorder.

By Jos. H. Smith.

Co. Sur. and ex-officio Dep. Co. Rec.