

105

ORM 2310-349

349

City Railway Company
To
County of Los Angeles.

105

Sht. 35
A-82

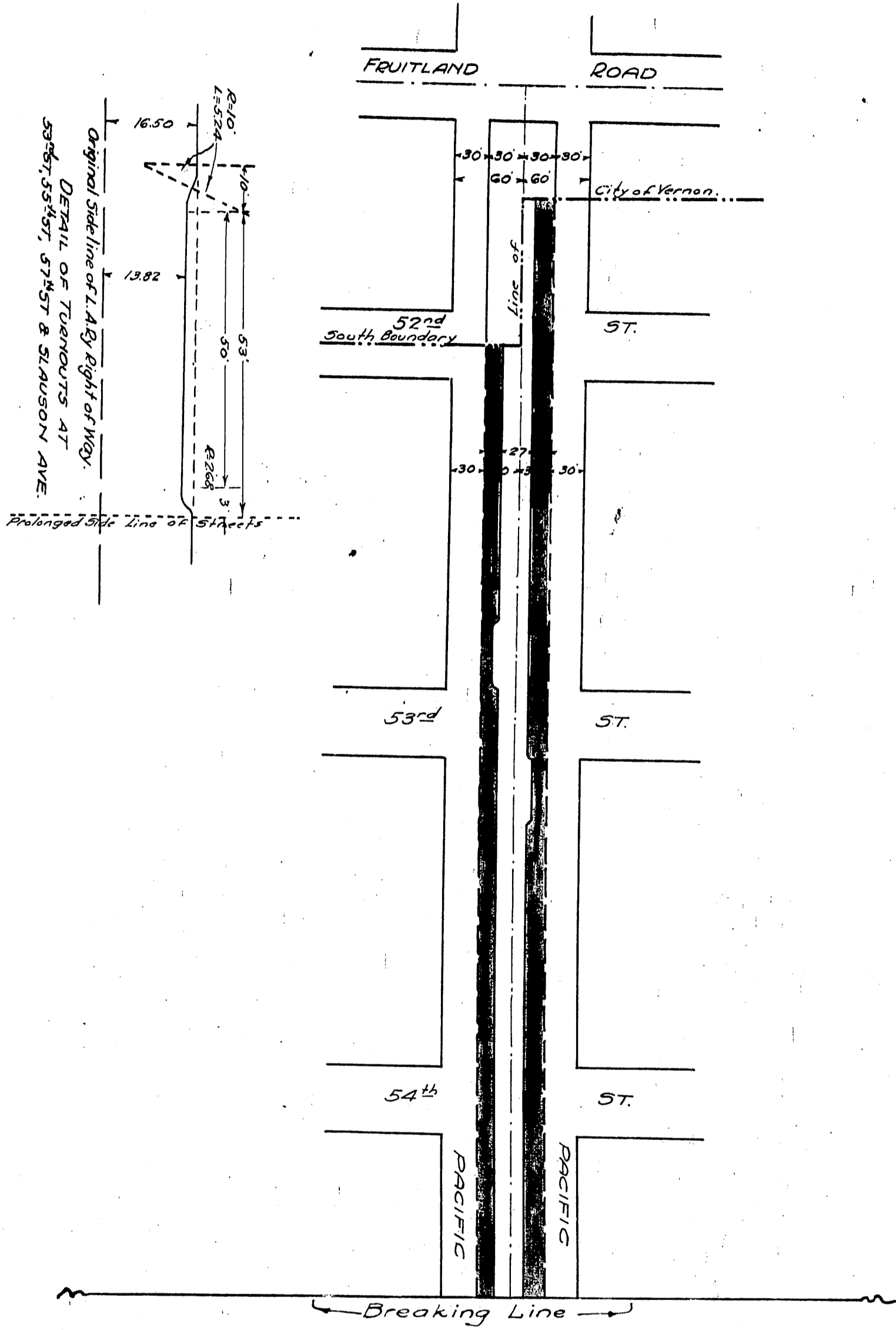

Recorded Sept. 6, 1923.
D:37-211
A-82
Sht. 7

OR. 2310

106

City Railway Company
To
County of Los Angeles.

ORM 2310-349 349

106

f Breaking Line

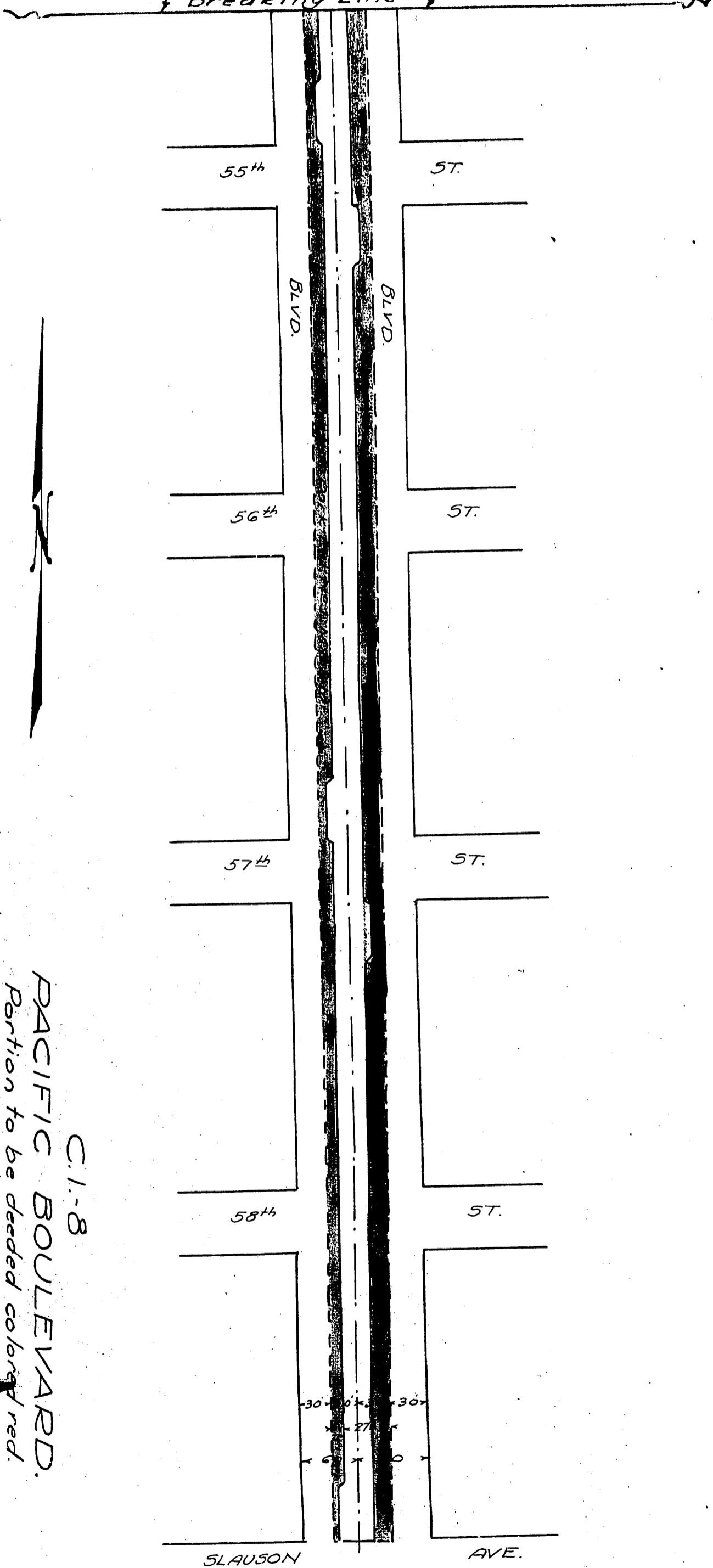

C.I.-8
PACIFIC BOULEVARD.
Portion to be deeded colored red.

SLAUSON

AVE.

D:37-211

A-82

Recorded Sept. 6, 1923.

O.R. 2310.