

See Sheet 2

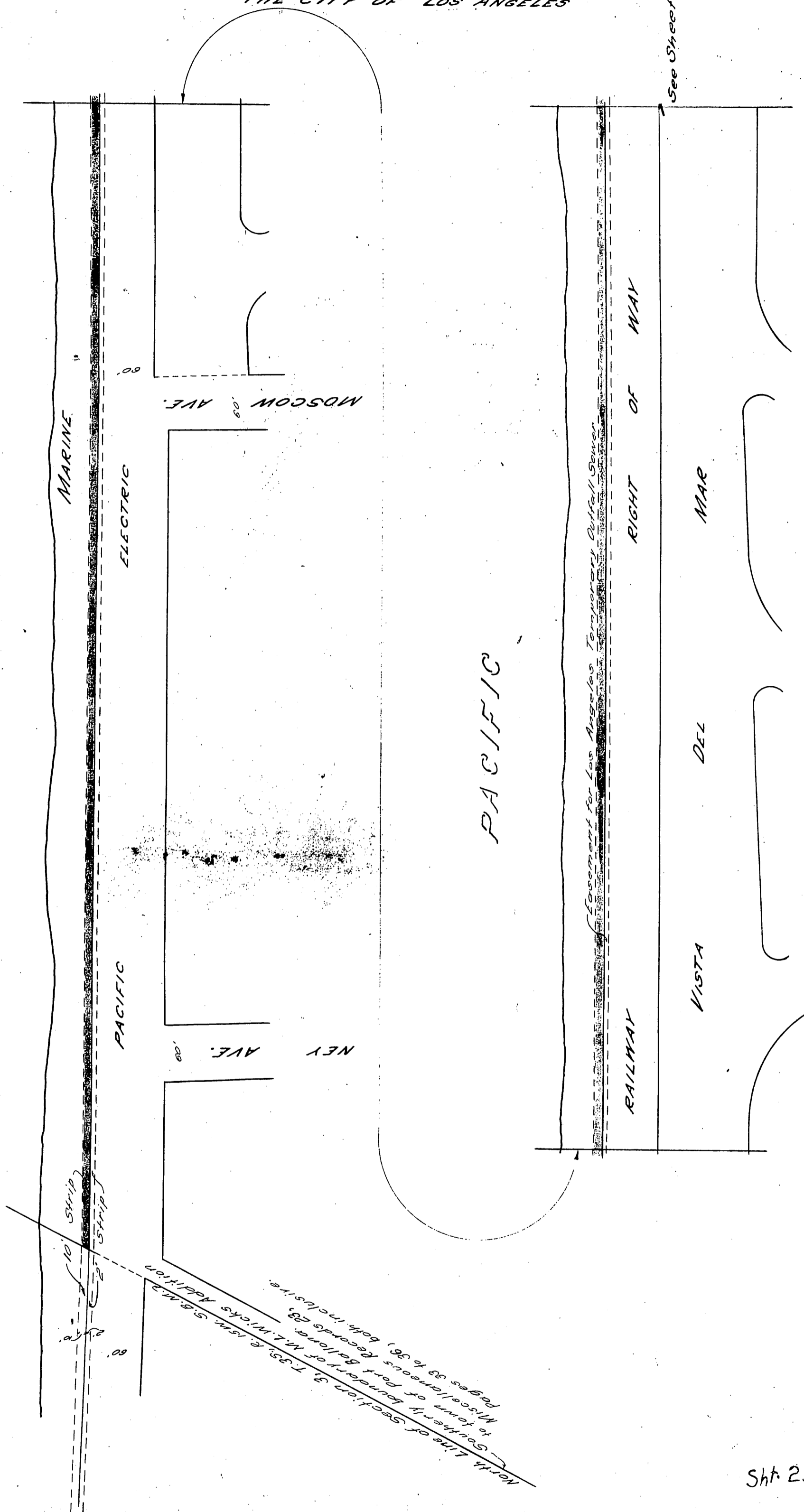

Sht. 23

O.R. 2882.

CITY OF VENICE  
TO

39

THE CITY OF LOS ANGELES

OCEAN AVENUE

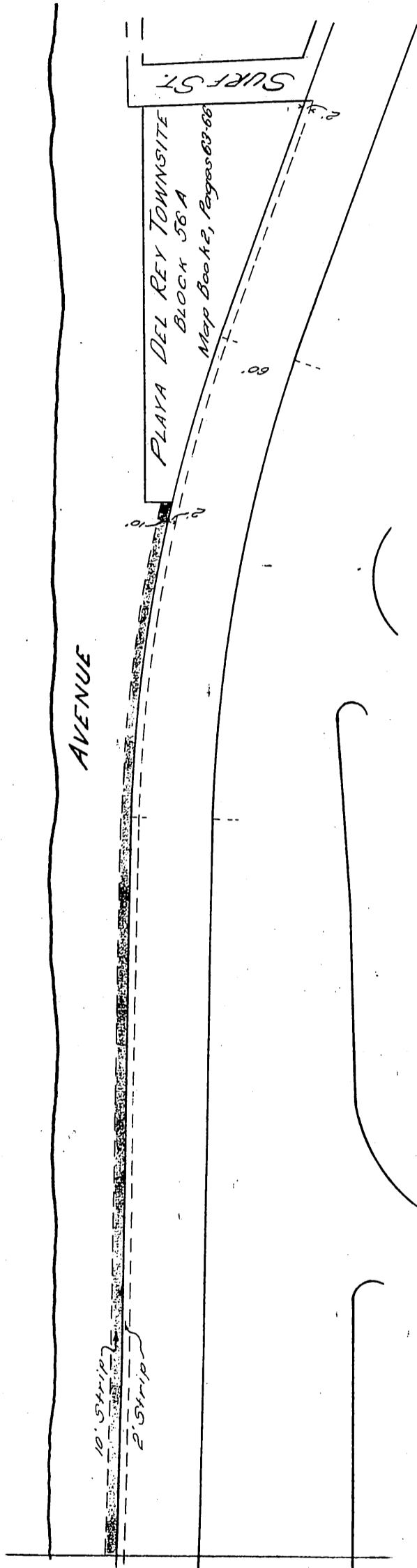

See Sheet 1

Parcel No 10

SKETCH SHOWING  
EASEMENT GRANTED TO CITY OF LOS ANGELES  
FOR

TEMPORARY OUTFALL SEWER

Scale 1"=100' January 1923

Comp. M.M.  
R.T.

File in map sec. D-475.

Recorded Dec. 26, 1923.

Sht. 23

O.R. 2882.