

TO STATE OF CALIFORNIA

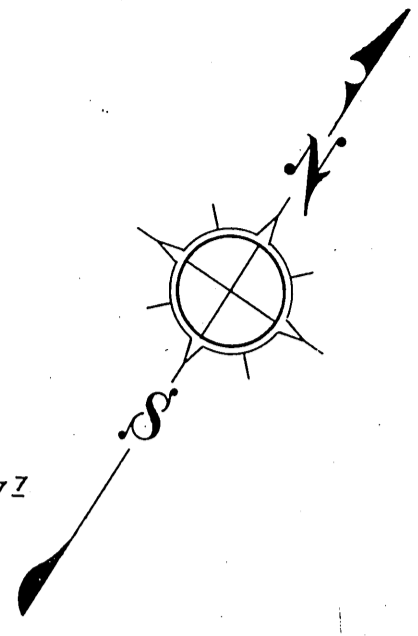
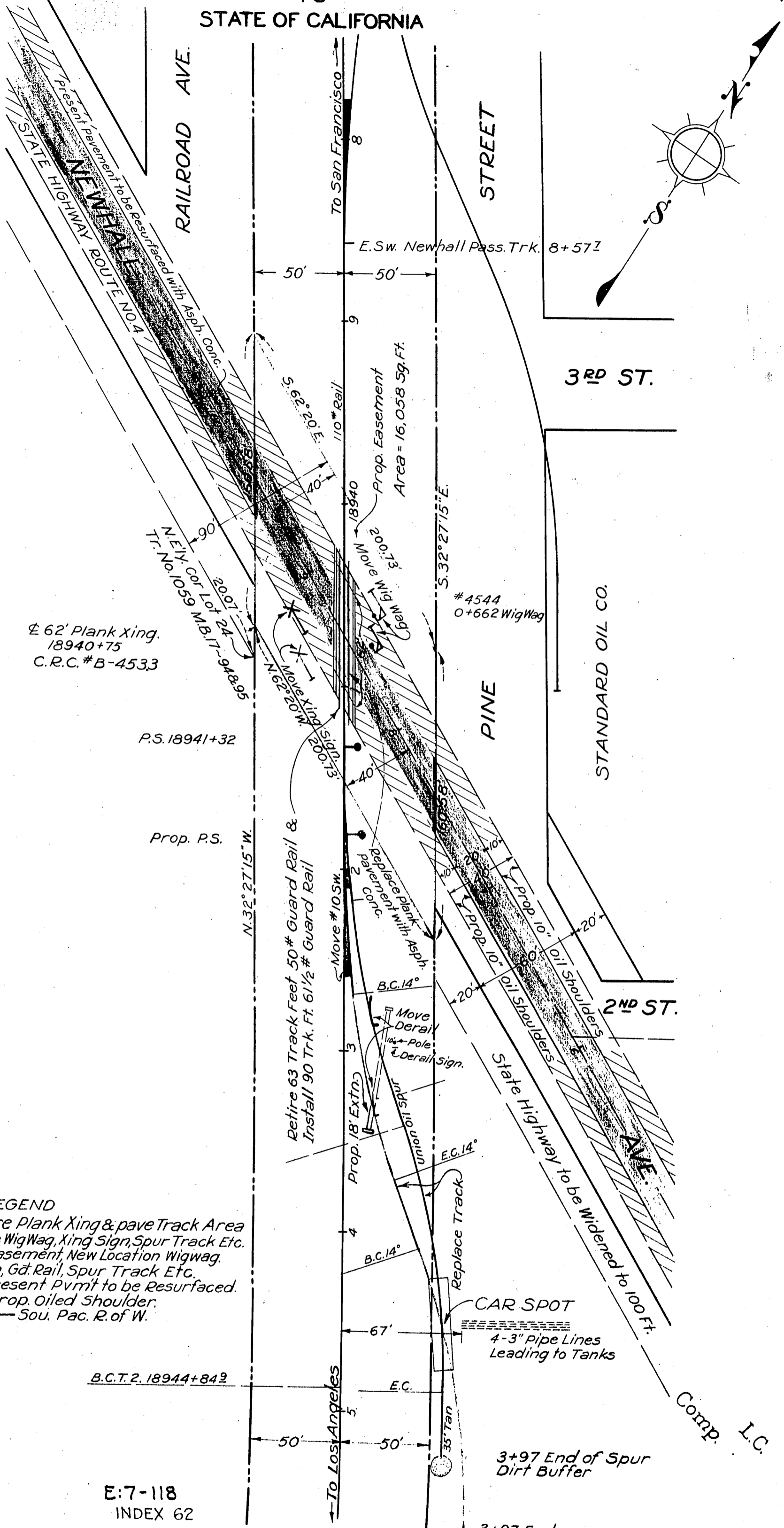

ϕ 62' Plank Xing.  
18940+75  
C.R.C. #B-4533

P.S. 18941+32

Prop. P.S.

N. 32° 27' 15" W.

Retire 63 Track Feet 50# Guard Rail &  
Install 90 Trk. Ft. 6 1/2 # Guard Rail

Move #10 SW

Replace Plank Xing with Asph.

Prop. 18' Extn.

Union Oil Spur

Replace Track

Prop. 10"

Oil Shoulders

Prop. 10"

Oil Shoulders

Prop. 10"

Oil Shoulders

State Highway to be Widened to 100 Ft.

Comp. I.C.

3+97 End of Spur  
Dirt Buffer

3+97 End

35' Tan

- LEGEND**
- Tint - Replace Plank Xing & pave Track Area
  - Yellow - Move WigWag, Xing Sign, Spur Track Etc.
  - Red - Prop. Easement, New Location WigWag, Xing Sign, Gd. Rail, Spur Track Etc.
  - Shaded - Present Pvm't to be Resurfaced.
  - Hatched - Prop. Oiled Shoulder.
  - Sou. Pac. R. of W.

B.C.T. 2. 18944+849

E.C.

E:7-118  
INDEX 62

RECORDED - AUG. 24, 1935.

O.R. 13594