

FIELD COPY

**COUNTY OF LOS ANGELES**

**ROAD DEPARTMENT**

**BENCH MARKS**



**OTTERBEIN QUAD**

**1955**

PREFACE

The Road Department level net is composed of some 1,000 miles of levels supporting more than 10,000 bench marks. In 1955, a major re-adjustment of the net was undertaken resulting in revised bench mark elevations of which the accompanying list is a part.

To facilitate the adjustment, indexing, and distribution of adjusted values of the net, the county territory was divided into 30 quads or areas. For identification purposes each quad was given a name, viz., "Rosemead", "La Mirada", "Santa Fe", etc. When bench marks and elevations in the Road Dept. net are used, the name of the quad in which the bench mark is located and the date of the adjustment of the elevation must be included in the bench mark description, e.g.,

SG 908 - L & T in E. cb. Mascatel Ave. on G/L prod.  
Scott St. (Rosemead - 1955) Elev. 333.517

It is expected that this general adjustment will, for the most part, remain sound for the next 15 or 20 years. As new circuits are completed, however, re-adjustment of individual quads may become advisable. It is expected that these subsequent adjustments will be in the nature of a few hundredths of a foot. When a quad is re-adjusted, new elevation lists will be published and the date of the re-adjustment will replace the "1955" at the end of the bench mark description. Two bench marks in the same quad with different adjustment dates will not normally join each other. Since all adjustments taper out to nothing at the periphery of the quad, any bench mark in one quad will join any bench mark in another quad regardless of their respective adjustment dates.

The basic accuracy of the net is reflected by an indicated field probable error of  $\pm 0.12$  foot per mile of leveling as determined from 298 conditions of closure. However, many years experience in vertical control in the greater Los Angeles basin & Antelope Valley indicate that because of varying degrees of subsidence and heaving, the true datum is recovered only by obtaining substantial agreement of a number of bench marks.

The users of this net are invited to assist in its maintenance by notifying this Department of cases of obliteration, apparent mistakes in descriptions or elevations, and proven disturbance of bench marks.

---

Datum: U.S. Coast and Geodetic Survey Sea Level Datum of  
1929, through the medium of the Los Angeles County  
Engineer Precise Level Net, 1952 Adjustment.

11--Iron Pipe

1212--Los Angeles City Engineer

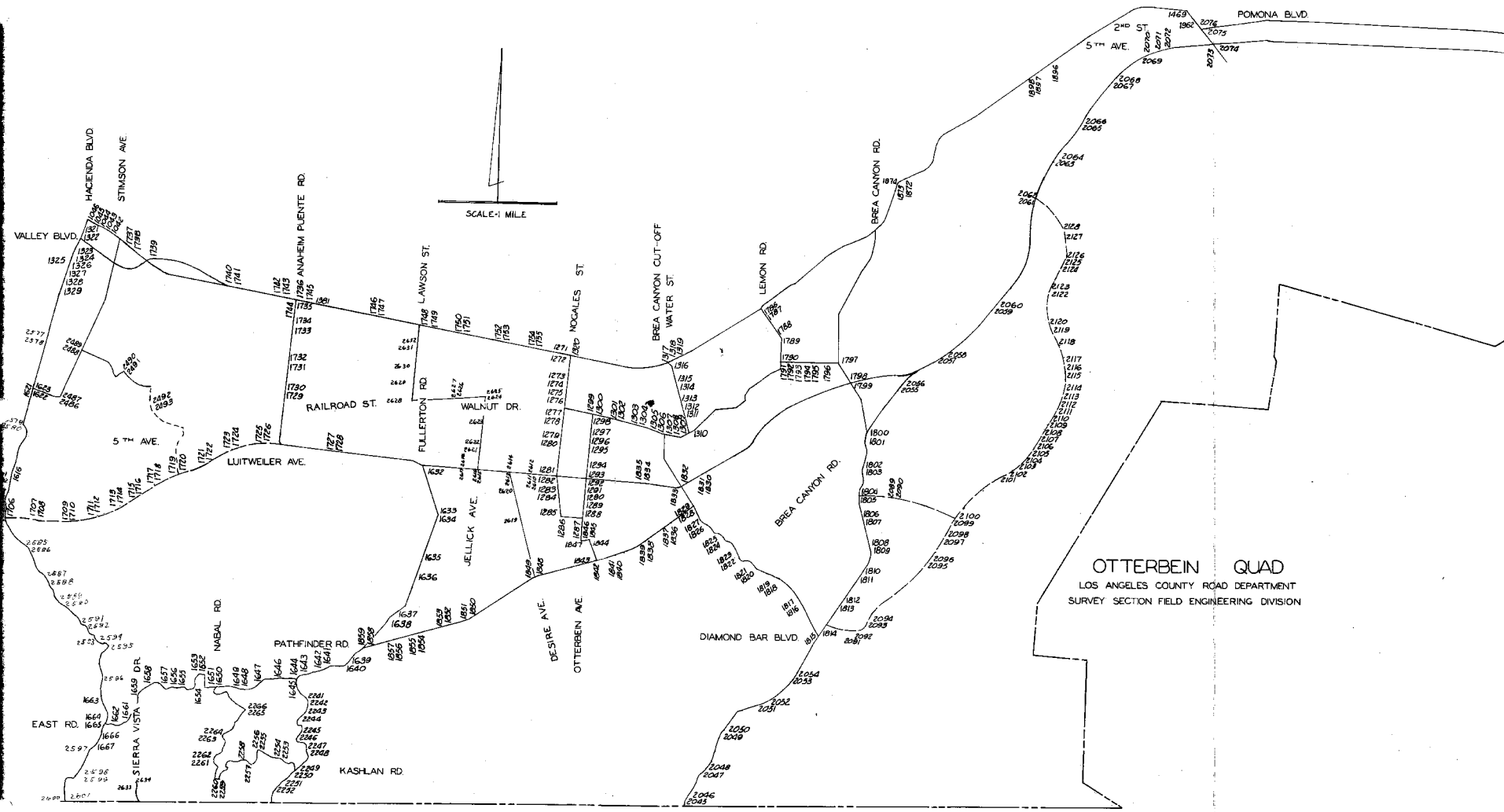

**OTTERBEIN QUAD**  
 LOS ANGELES COUNTY ROAD DEPARTMENT  
 SURVEY SECTION FIELD ENGINEERING DIVISION

JUL 1964

LOS ANGELES COUNTY ROAD DEPARTMENT  
SURVEY SECTION FIELD ENGINEERING DIVISION

PAGE 1

QUAD-YEAR	ELEV	DESCRIPTION (INCLUDE QUAD AND YEAR IN DESCRIPTION)	BM NUMBER
BASELINE (1955)	328.649	L+SPK @ CTR CB RET @ NW COR OLD VALLEY BLVD + GLENDDORA AVE MKD (PS 6	SG 1042A
BASELINE (1955)	328.714	3IN IP + USGS CAP 8IN UP @ PUENTE STA OF SPRR 35FT S C/L OLD VALLEY BLVD + 160FT W C/L GLENDDORA	SG 1043A
BASELINE (1955)	324.434	L+T CONC WK 4FT S OF SW COR OF BLDG NO 15703 30F E C/L RIDGEWAY ST + 30FT N C/L OLD VALLEY BLVD	SG 1044A
BASELINE (1955)	322.356	RD MON IN WELL 8IN DN @ C/L INT OLD VALLEY BLVD + HACIENDA BLVD	SG 1045B
BASELINE (1955)	323.914	CS MON FLUSH 1FT E OF E CB 41FT E C/L HACIENDA BLVD + 10FT S OF S RAIL SPRR MKD (BM 11-114A)	SG 1046B
BASELINE (1955)	456.328	R D MON IN WELL 10 IN DN @ C/L INT VALLEY BLVD + NOGALES ST	SG 1271A
BASELINE (1955)	457.095	L+BN NE COR CONC BASE OF RR X SIGNAL 6FT S OF SPRR 15FT E C/L NOGALES ST	SG 1272
OTTRBEIN (1955)	440.315	L+BN NR N EDGE CONC DR TO HSE NO 854 20FT E C/L NOGALES ST @ NE COR SAN JOSE AVE	SG 1273
OTTRBEIN (1955)	440.739	L+BN SE COR CONC BASE OF WATER PUMP 65FT W C/L NOGALES ST + 75FT N C/L SAN JOSE AVE	SG 1274
OTTRBEIN (1955)	450.153	L+BN N SIDE OF CONC BASE OF RR X SIGNAL 13FT N OF UPRR 18FT W C/L NOGALES ST	SG 1275
OTTRBEIN (1955)	446.826	L+BN CTR OF CONC HDWL OF DRAIN 15FT S OF UPRR + 32FT E C/L NOGALES ST	SG 1276
OTTRBEIN (1955)	456.786	L+BN N EDGE OF OIL TANK 25FT E C/L NOGALES ST 325FT N OF HSE NO 1310 + OPP PP NO 268081E	SG 1277
OTTRBEIN (1955)	463.601	L+BN NW EDGE OIL TANK 22FT E C/L NOGALES ST + 170FT S OF HSE NO 1310	SG 1278
OTTRBEIN (1955)	466.836	L+T S EDGE OF 12 IN STANDPIPE 25FT E C/L NOGALES ST N OF DR TO HSE NO 1434 ONE MI S VALLEY BLVD	SG 1279
OTTRBEIN (1955)	472.424	L+BN CONC RET WALL 40FT E C/L NOGALES ST + 330FT S OF DR TO HSE NO 1434	SG 1280
OTTRBEIN (1955)	488.383	L+BN N WING OF HDWL 50FT S C/L 5TH AVE + 22FT E C/L NOGALES ST	SG 1281
OTTRBEIN (1955)	501.436	L+BN N EDGE CONC DR TO HSE NO 1860 40FT E C/L NOGALES ST	SG 1284
OTTRBEIN (1955)	511.020	L+BN N END OF HDWL W SIDE OF DR TO HSE NO 19007 @ NE COR KILLIAN AVE 25FT N C/L NOGALES ST	SG 1285
OTTRBEIN (1955)	517.215	L+BN CTR W HDWL OF DR TO HSE NO 19039 20FT N C/L KILLIAN AVE	SG 1286
OTTRBEIN (1955)	527.094	L+BN TOP 24IN STANDPIPE @ NW COR KILLIAN AVE + OTTRBEIN AVE	SG 1287
OTTRBEIN (1955)	526.211	L+BN TOP 24IN STANDPIPE 25FT W C/L OTTRBEIN AVE + 100FT S OF DR TO HSE NO 1847	SG 1288
OTTRBEIN (1955)	514.868	L+T E EDGE 12IN STANDPIPE 30FT W C/L OTTRBEIN AVE 80FT N C/L PROD VALENCIA ST + 10FT N OF DR TO HSE NO 1755	SG 1291
OTTRBEIN (1955)	510.798	L+BN IN N WING OF HDWL 50FT S + 20FT E C/L INT 5TH AVE + OTTRBEIN AVE	SG 1292

QUAD-YEAR	ELEV	DESCRIPTION (INCLUDE QUAD AND YEAR IN DESCRIPTION)	BM NUMBER
OTTRBEIN (1955)	512.970	L+BN W END OF 1ST STEP TO PORCH OF HSE NO 19208 5TH AVE 55FT S C/L + 116 <b>OUT</b> /L OTTERBEIN AVE	SG 1293
OTTRBEIN (1955)	499.459	L+T SE COR CONC PORCH FRONT OF HSE NO 1523 OTTERBEIN AVE 45FT W C/L	SG 1294
OTTRBEIN (1955)	485.806	L+BN W CB OTTERBEIN AVE 10FT W C/L + 10FT N C/L PROD TRANBARGER ST	SG 1295
OTTRBEIN (1955)	488.004	L+BN CONC RET WALL 2FT N OF END 20FT E + 20FT N C/L INT OTTERBEIN AVE + TRANBARGER ST	SG 1296
OTTRBEIN (1955)	472.923	L+BN E EDGE OF OIL TANK 7FT S OF DR TO HSE NO 1301 + 50FT W C/L OTTERBEIN AVE	SG 1297
OTTRBEIN (1955)	462.524	L+T CTR OF 2ND STEP NE COR OF CHURCH BLDG @ SW COR WALNUT DR + OTTERBEIN AVE	SG 1298
OTTRBEIN (1955)	462.622	L+T S END OF 1ST CONC STEP TO PORCH OF STORE @ NE COR WALNUT DR + OTTERBEIN ST	SG 1299
OTTRBEIN (1955)	467.317	L+BN CTR OF HDWL OF DRAIN W SIDE OF DR TO HSE NO 15254 WALNUT DR 20FT S C/L	SG 1300
OTTRBEIN (1955)	470.630	L+BN NR E END HDWL OF CONC BRIDGE NO 361 10FT W OF DR TO HSE NO 19335 WALNUT DR 20FT N C/L	SG 1301
OTTRBEIN (1955)	471.257	L+BN E END HDWL OF CONC BRIDGE NO 361 20FT S C/L WALNUT DR OPP DR TO HSE NO 19335	SG 1302
OTTRBEIN (1955)	481.632	L+BN CTR OF HDWL OF DRAIN W SIDE OF DR TO HSE NO 19448 WALNUT DR 15FT S C/L	SG 1303
OTTRBEIN (1955)	487.636	L+BN E EDGE OF CONC WK TO HOSPITAL CASA ALEGRE NO 19506 WALNUT DR 21FT S C/L	SG 1304
OTTRBEIN (1955)	491.710	L+T S EDGE OF CONC WK TO HSE NO 19565 WALNUT DR 3FT S OF STEP + 60FT N C/L	SG 1305
OTTRBEIN (1955)	498.444	L+BN E END OF CONC WINGWALL 25FT S C/L WALNUT DR + 35FT E C/L BREA CANYON CUTOFF RD	SG 1306
OTTRBEIN (1955)	502.453	L+T 6FT E OF W END CONC RET WALL 70FT W PP NO 47129E + 23FT N C/L WALNUT DR	SG 1307
OTTRBEIN (1955)	503.678	L+T CONC RET WALL 10FT W OF END 50FT W OF ENT TO HSE NO 19734 WALNUT DR 23FT N C/L + 10FT W PP NO 507758E	SG 1308
OTTRBEIN (1955)	508.571	L+T W END CONC HDWL 18FT S C/L WALNUT DR + 25FT E C/L PROD WATER ST	SG 1309
OTTRBEIN (1955)	492.772	L+BN W END CONC HDWL OF DRAIN 15FT E C/L WATER ST + 450FT N C/L WALNUT DR	SG 1310
OTTRBEIN (1955)	484.842	L+T E EDGE CONC WK 15FT N OF STEPS TO HSE NO 1111 WATER ST 45FT W C/L	SG 1311
OTTRBEIN (1955)	486.435	L+BN CTR N END OF CONC CULV 55FT N OF WK TO HSE NO 1111 WATER ST 20FT E C/L	SG 1312
OTTRBEIN (1955)	488.717	L+BN NW SIDE OF CONC BASE OF RR X SIGNAL 12FT S OF S RAIL UPRR + 15FT E C/L WATER ST MKD (NO 3-23,4)	SG 1313
OTTRBEIN (1955)	487.238	L+BN SE COR OF CONC BASE OF METAL SIGNAL BOX NO 318 12FT S OF S RAIL UPRR + 40FT W C/L WATER ST	SG 1314

QUAD-YEAR	ELEV	DESCRIPTION (INCLUDE QUAD AND YEAR IN DESCRIPTION)	BM NUMBER
OTTRBEIN (1955)	482.931	L+T WK TO HSE NO 817 25FT W C/L WATER ST + 200FT S C/L HOWELL RD	SG 1315
BASELINE (1955)	487.594	L+BN S SIDE OF CONC BASE OF RR X SIGNAL 12FT S OF S RAIL SPRR + 25FT E C/L WATER ST	SG 1316
BASELINE (1955)	487.223	L+BN IN CONC BASE OF RR X SIGNAL 15FT N OF N RAIL SPRR + 20FT W C/L WATER ST + 60FT S C/L VALLEY BLVD MKD (50-57A)	SG 1317
BASELINE (1955)	453.829	CS MON OF C/L VALLEY BLVD + 40FT W C/L NOGALES ST FROM THE N	SG 1320
BASELINE (1955)	319.768	L+SPK CTR CONC HDWL 20FT E C/L HACIENDA BLVD + 200FT S C/L VALLEY BLVD	SG 1323
BASELINE (1955)	319.753	L+T CTR CONC HDWL 20FT W C/L HACIENDA BLVD + 200FT S C/L VALLEY BLVD	SG 1324A
BASELINE (1955)	318.946	L+BN SE COR CONC BASE COR POST 25FT W C/L HACIENDA BLVD + 1300FT S OLD VALLEY BLVD	SG 1325
BASELINE (1955)	324.017	L+T CONC CATCH BASIN 30FT W C/L HACIENDA BLVD + 105FT S OF S RAIL UPRR MKD (BM)	SG 1326A
BASELINE (1955)	325.324	L+T S END OF BRIDGE ABUT UPRR 24FT E C/L HACIENDA BLVD + 15FT S OF S RAIL	SG 1327A
BASELINE (1955)	332.727	L+T NR CTR CB RET @ SW COR GALE AVE + HACIENDA BLVD 47FT S + 47FT W C/L INT MKD (BM P)	SG 1328A
BASELINE (1955)	332.111	RDBM TAG N CB 9FT E BCR @ NW COR HACIENDA BLVD + GALE AVE 36FT N + 70FT W C/L INT	SG 1329A
BASELINE (1955)	785.630	BRONZE DISK IN CTR OF CONC ABUT OF SPRR CULV 8FT N OF TRACKS 250FT W INT VERNON AVE + BELLEVUE AVE	SG 1469
BASELINE (1955)	497.840	CS BRASS MON FLUSH IN CB ON SE COR HACIENDA BLVD + LOS ALTOS DR 53FT S + 80FT E C/L INT MKD (BM 38-9A 1963)	SG 1616A
BASELINE (1955)	406.127	RDBM TAG S CB + 1FT W BCR @ SE COR HACIENDA BLVD + HALLIBURTON RD + 40FT S C/L + 84FT E C/L INT	SG 1622A
BASELINE (1955)	405.237	RDBM TAG N CB 1FT E BCR @ NE COR HACIENDA BLVD + HALLIBURTON RD 40FT N + 72FT E C/L INT	SG 1623A
OTTRBEIN (1955)	483.600	CS MON IN WELL 10IN DN 13FT E + 1FT S C/L INT 5TH AVE + FULLERTON RD MKD (BM 44-12)	SG 1632
OTTRBEIN (1955)	499.342	RDBM TAG S END CONC HDWL 40FT N OF DR TO ROWLAND SCHOOL 20FT E C/L FULLERTON RD + 0.5 MI S 5TH AVE	SG 1633
OTTRBEIN (1955)	502.452	CS MON IN WELL 12IN DN @ PI OF CURVE @ S ENT TO ROWLAND SCHOOL 12FT E C/L FULLERTON RD + 0.5 MI S 5TH AVE	SG 1634
OTTRBEIN (1955)	534.905	RDBM TAG NR W EDGE OF CIRC CONC STORAGE TANK 2FT UP ON NE COR FULLERTON RD + MESCAL ST 50FT N + 30FT E C/L INT	SG 1635
OTTRBEIN (1955)	550.794	RDBM TAG 2FT E BCR @ SE COR FULLERTON RD + SENTENO ST 18FT S + 35FT E C/L INT	SG 1636
OTTRBEIN (1955)	588.767	CS TAG + BRAD IN SW END CONC HDWL 50FT S OF DR TO HSE NO 2804 FULLERTON RD 28FT N C/L + 1.5 MI S 5TH AVE	SG 1637

**DISTURBED**

JUL 1964

LOS ANGELES COUNTY ROAD DEPARTMENT  
SURVEY SECTION FIELD ENGINEERING DIVISION

PAGE 4

QUAD-YEAR	ELEV	DESCRIPTION (INCLUDE QUAD AND YEAR IN DESCRIPTION)	BM NUMBER
OTTRBEIN (1955)	589.456	CS MON IN WELL 8IN DN @ PI OF CURVE 65FT FROM CONC HDWL 105FT S OF DR TO HSE NO 2804 FULLERTON RD 9FT N C/L + 1.5 MI S 5TH AVE	SG 1638
OTTRBEIN (1955)	653.369	RDBM TAG IN S END CONC HDWL 30FT SE C/L 18FT S PP NO 875077E + 2.0 MI S 5TH AVE	SG 1640
OTTRBEIN (1955)	870.497	RD MON IN WELL 8IN DN 60FT N C/L PROD EAST RD 35FT NW C/L FULLERTON RD + 15FT E C/L SKYLINE DR	SG 1643
OTTRBEIN (1955)	871.190	CHIS X ON W END POST OF STEEL GUARD RAIL 22FT S C/L EAST RD + 35FT W C/L FULLERTON RD	SG 1644A
OTTRBEIN (1955)	829.932	L+T CONC DR TO HSE NO 1505 EAST RD 27FT N C/L + 0.2 MI W FULLERTON RD	SG 1645
OTTRBEIN (1955)	817.844	CHIS X ON FIRE HYD 4FT UP 25FT N C/L EAST RD 9FT W OF DR TO HSE NO 1485 + 0.25 MI W FULLERTON RD	SG 1646
OTTRBEIN (1955)	779.074	L+T CONC FOUNDATION OF W BRICK GATE POST @ HSE NO 1409 EAST RD 20FT N C/L 70FT E C/L COBAN RD + 0.4 MI W FULLERTON RD	SG 1647
OTTRBEIN (1955)	746.766	RDBM TAG N WINGWALL CONC HDWL 13FT E OF ENT TO HSE NO 1276 EAST RD 15FT S C/L + 0.6 MI W FULLERTON RD	SG 1648
OTTRBEIN (1955)	478.255	L+T E SIDE BOT STEP TO HSE NO 1276 EAST RD 30FT S C/L + 0.6 MI W FULLERTON RD	SG 1649
OTTRBEIN (1955)	720.235	RDBM TAG CTR CONC HDWL @ NE COR EAST RD + VALLE DR 21FT N + 12FT E C/L INT	SG 1650
OTTRBEIN (1955)	720.077	L+T CONC DR TO HSE NO 1141 EAST RD @ NW COR VALLE DR 70FT N + 15FT W C/L INT	SG 1651
OTTRBEIN (1955)	731.889	L+T S CB OF DR TO HSE NO 1001 PAPAYA DR 20FT E C/L + 27FT N C/L PROD EAST RD	SG 1652
OTTRBEIN (1955)	716.798	RDBM TAG CTR CONC HDWL OF DROP INLET 21FT N C/L EAST RD + 300FT W C/L PAPAYA DR	SG 1653
OTTRBEIN (1955)	708.140	RDBM TAG IN CTR CONC HDWL 15FT N C/L EAST RD E PP NO 1124854E + 1.2 MI W FULLERTON RD	SG 1654
OTTRBEIN (1955)	714.645	RDBM TAG IN NE COR CONC FOOTING FOR GAS METER W SIDE HACIENDA COUNTRY CLUB 80FT S C/L EAST RD + 1.4 MI W FULLERTON RD	SG 1655
OTTRBEIN (1955)	728.072	CHIS X IN W POST STEEL GUARD RAIL 17FT S C/L EAST RD 100FT E OF DR TO HSE NO 640 + 1.5 MI W FULLERTON RD	SG 1656
OTTRBEIN (1955)	727.037	L+T ON E SIDE CONC DR TO HSE NO 640 EAST RD 15FT S C/L + 1.5MI W FULLERTON RD	SG 1657
OTTRBEIN (1955)	734.330	CHIS X ON TOP FIRE HYD BET HSE NO 500 + NO 502 EAST RD 25FT S C/L + 30FT E C/L CHURCHILL RD MKD (BM)	SG 1658
OTTRBEIN (1955)	650.138	CHIS X S POST OF STEEL GUARD RAIL 15FT W C/L EAST RD + 1.9 MI W FULLERTON RD	SG 1659
OTTRBEIN (1955)	606.023	L+T NW CB EAST RD 15FT NW C/L 45FT N TP NO W1678Y + 2.0 MI W FULLERTON RD	SG 1660
OTTRBEIN (1955)	547.541	RDBM TAG CTR CONC HDWL 16FT N C/L EAST RD 50FT NW TP NO W1671Y + 1000FT W HACIENDA BLVD	SG 1661

QUAD-YEAR	ELEV	DESCRIPTION (INCLUDE QUAD AND YEAR IN DESCRIPTION)	BM NUMBER
BASELINE (1955)	605.220	CS MON IN WELL 8IN DN ON C/L ENCANADA DR 47FT W C/L HACIENDA BLVD MKD (BM 38-4 1954)	SG 1662
BASELINE (1955)	605.440	CS MON FLUSH @ SW COR HACIENDA BLVD + ENCANADA DR 23FT W + 20FT S C/L INT	SG 1663A
BASELINE (1955)	551.826	RDBM TAG INCTR OF S SIDE CONC VALVE BOX 12FT N + 24FT W C/L INT HACIENDA BLVD + EAST RD	SG 1664
BASELINE (1955)	555.283	L+T IN W END CONC STEP TO OFFICE @ SE COR HACIENDA BLVD + EAST RD 50FT E + 40FT S C/L INT MKD (BM)	SG 1665A
BASELINE (1955)	512.792	L+BRAD 2FT S OF N END CONC HDWL OPP HSE NO 1703 HACIENDA BLVD 21FT E C/L MKD (BM)	SG 1666
BASELINE (1955)	494.182	CS MON IN WELL 12IN DN @ C/L PI 63FT NE C/L INT HACIENDA BLVD + WEST RD	SG 1667
BASELINE (1955)	553.580	L+T 0.9FT N OF N CB FACE 11FT E BCR @ NE COR HACIENDA BLVD + COLIMA RD 42FT N + 84FT E C/L INT	SG 1705A
BASELINE (1955)	552.145	L+T S CB 22FT W BCR @ SW COR HACIENDA BLVD + COLIMA RD 42FT S + 97FT W C/L INT	SG 1706A
OTTRBEIN (1955)	635.512	3/4IN IP 12IN DN 100FT S C/L GRAZIDE RD + 5700FT E HACIENDA BLVD	SG 1717
OTTRBEIN (1955)	595.809	RDBM TAG IN NW CONC FOOTING TO EDISON TOWER NO 1/3 182FT S C/L GRAZIDE RD + 4985FT W ANAHEIM- PUENTE RD	SG 1719
OTTRBEIN (1955)	562.589	RD MON IN WELL 6 IN DN 152FT NE C/L GRAZIDE RD + 4985FT W ANAHEIM-PUENTE RD 2FT S OF 2IN X 3FT GUARD PIPE	SG 1720
OTTRBEIN (1955)	502.299	RD MON IN WELL 6IN DN 152FT NE C/L GRAZIDE RD + 3492FT W ANAHEIM-PUENTE RD 2FT N OF 2IN X 3FT GUARD PIPE	SG 1721
OTTRBEIN (1955)	496.950	2IN IP WITH CS TAG 16IN DN ON C/L GRAZIDE RD @ PI + 3492FT W ANAHEIM-PUENTE RD	SG 1722
OTTRBEIN (1955)	464.143	RD MON IN WELL 150FT SW C/L GRAZIDE RD + 1765FT W ANAHEIM-PUENTE RD 2FT N OF 2IN X 3FT GUARD PIPE	SG 1723
OTTRBEIN (1955)	457.147	RD MON IN WELL 6IN DN 110FT NE C/L GRAZIDE RD + 1765FT W ANAHEIM-PUENTE RD 2FT S OF 2IN X 3FT GUARD PIPE	SG 1724
OTTRBEIN (1955)	462.019	2IN IP IN CONC SLAB FLUSH 24FT S OF FIFTH AVE + 390FT E C/L ANAHEIM-PUENTE RD 35FT E OF 916551E MKD (CSBM 44-14 1955 RE 63)	SG 1725
OTTRBEIN (1955)	460.937	RDBM TAG SW COR CONC PUMP BASE 12IN UP 65FT N C/L FIFTH AVE + 415FT E C/L ANAHEIM-PUENTE RD	SG 1726
OTTRBEIN (1955)	453.486	RDBM TAG CTR HDWL 50FT S C/L FIFTH AVE @ MI POST 0.51 0.5 MI E ANAHEIM-PUENTE RD	SG 1727
OTTRBEIN (1955)	453.326	CS MON 3FT W CULV HDWL 50FT S C/L FIFTH AVE @ MI POST 0.51 0.5 MI E ANAHEIM-PUENTE RD MKD (BM 49-13 1955 RD 63)	SG 1728
OTTRBEIN (1955)	421.056	RDBM TAG N SIDE CONC DR TO HSE NO 1356 ANAHEIM- PUENTE RD 50FT E C/L + 115FT N C/L BONITA VISTA	SG 1729



JUL 1964

LOS ANGELES COUNTY ROAD DEPARTMENT  
SURVEY SECTION FIELD ENGINEERING DIVISION

PAGE 6

QUAD-YEAR	ELEV	DESCRIPTION (INCLUDE QUAD AND YEAR IN DESCRIPTION)	BM NUMBER
OTTRBEIN (1955)	418.485	L+T ON N SIDE OF CONC WK TO HSE NO 1344 ANAHEIM-PUENTE RD 50FT E C/L + 240FT N C/L BONITA VISTA LANE MKD (BM)	SG 1730
OTTRBEIN (1955)	390.792	CS MON IN WELL 10IN DN ON C/L ANAHEIM-PUENTE RD 295FT S UPRR TRACK MKD (PUENTE I-12)	SG 1731
OTTRBEIN (1955)	389.669	RDBM TAG IN S HDWL 18FT E C/L ANAHEIM-PUENTE RD + 10FT S C/L UPRR TRACK	SG 1732
OTTRBEIN (1955)	378.492	RDBM TAG 1FT N OF <b>OUT</b> EDGE DR TO FREEMAN READY MIX PLANT 60FT C/L ANAHEIM-PUENTE RD + 950FT N OF UPRR TRACKS	SG 1733
OTTRBEIN (1955)	376.313	L+T CONC RIM WATER VALVE BOX 45FT W C/L ANAHEIM-PUENTE RD + 1250FT N UPRR TRACKS 200FT S OFFICE DAY + NIGHT MFG CO MKD (BM)	SG 1734
BASELINE (1955)	374.516	CHIS SQUARE CTR OF N CULV 70FT S C/L VALLEY BLVD + 30FT W C/L ANAHEIM-PUENTE RD	SG 1735A
BASELINE (1955)	374.528	CT SPK W END CULV HDWL N SIDE SPRR 70FT S C/L VALLEY BLVD + 30FT W C/L ANAHEIM-PUENTE RD MKD (15)	SG 1736A
BASELINE (1955)	335.675	L+T CONC FOUNDATION OF GAS STA 33FT E C/L ALBERT ST + 50FT S C/L OLD VALLEY BLVD MKD (BM)	SG 1738B
BASELINE (1955)	343.504	RDBM TAG N CB 4FT E BCR 20FT N C/L OLD VALLEY BLVD + 28FT E C/L BAJA AVE	SG 1739A
BASELINE (1955)	355.602	RDBM TAG CTR HDWL 45FT N C/L VALLEY BLVD + 350FT W C/L FERRERO LANE	SG 1740A
BASELINE (1955)	357.412	L+BN E END CONC HDWL 80FT S C/L VALLEY BLVD + 350FT W C/L FERRERO LANE	SG 1741A
BASELINE (1955)	370.330	L+BN N CONC HDWL 75FT S C/L VALLEY BLVD + 150FT W C/L WICKFORD AVE	SG 1742A
BASELINE (1955)	373.090	L+T IN END OF ISL 4FT N C/L VALLEY BLVD + 60FT W C/L WICKFORD AVE	SG 1743A
BASELINE (1955)	374.891	CT SPK CTR HDWL 27FT E C/L ANAHEIM-PUENTE RD + 65FT S C/L VALLEY BLVD MKD (BM 16)	SG 1744A
BASELINE (1955)	379.335	RD MON IN WELL 7IN DN @ C/L INT VALLEY BLVD + PASS + COVINA RD	SG 1745A
BASELINE (1955)	390.083	RD MON IN WELL 8IN DN ON C/L INT VALLEY BLVD + HAMBLEDON AVE	SG 1746
BASELINE (1955)	398.358	L+T CTR CONC HDWL 40FT S C/L VALLEY BLVD + 20FT E C/L GIANO AVE	SG 1748
BASELINE (1955)	398.416	L+T N CB 6FT E BCR 40FT N C/L VALLEY BLVD + 46FT E C/L GIANO AVE	SG 1749
BASELINE (1955)	412.390	L+BN IN RR SIGNAL BASE 75FT S C/L VALLEY BLVD + 35FT W C/L YORBITA RD	SG 1750
BASELINE (1955)	410.069	RDBM TAG CTR CONC HDWL 43FT N C/L VALLEY BLVD + 25FT E C/L YORBITA RD	SG 1751
BASELINE (1955)	419.923	RDBM TAG W CB 11FT N BCR 81FT N C/L VALLEY BLVD + 20FT W C/L LA SEDA RD	SG 1752
BASELINE (1955)	419.895	L+T E CB 12FT N BCR 82FT N C/L VALLEY BLVD + 20FT E C/L LA SEDA RD	SG 1753

JUL 1964

LOS ANGELES COUNTY ROAD DEPARTMENT  
SURVEY SECTION FIELD ENGINEERING DIVISION

PAGE 7

QUAD-YEAR	ELEV	DESCRIPTION (INCLUDE QUAD AND YEAR IN DESCRIPTION)	BM NUMBER
BASELINE (1955)	429.656	L+BN E END CONC HDWL 70FT S C/L VALLEY BLVD + 0.2MI E LA SEDA RD MKD (BM 12)	SG 1754
BASELINE (1955)	432.940	RDBM TAG N CB 1FT W CATCH BASIN 40FT N VALLEY BLVD + 0.2 MI E LA SEDA RD	SG 1755
OTTRBEIN (1955)	520.800	RDBM TAG IN E CB LEMON AVE 30FT E C/L + 0.2 MI N CURRIER RD NR DRAINAGE BOX FROM WALNUT SCHOOL	SG 1786
OTTRBEIN (1955)	521.197	RDBM TAG IN S END CONC WALL OF BUS LOADING YARD @ WALNUT SCHOOL 40FT E C/L LEMON AVE + 0.2 MI N CURRIER RD	SG 1787
OTTRBEIN (1955)	525.377	EDISON CO BR MON FLUSH 26FT N C/L CURRIER RD + 34FT E C/L LEMON AVE (USE NW EDGE)	SG 1788
OTTRBEIN (1955)	527.373	RDBM TAG W END CONC HDWL 17FT S C/L CURRIER RD + 46FT E C/L LEMON RD	SG 1789
OTTRBEIN (1955)	529.111	L+T NR CTR OF CURVED CONC HDWL 24FT N C/L LYCOMING ST + 26FT E C/L LEMON RD	SG 1790
OTTRBEIN (1955)	528.901	L+T NR CTR OF CURVED CONC HDWL 28FT S C/L LYCOMING ST + 26FT E C/L LEMON RD	SG 1791
OTTRBEIN (1955)	535.502	L+BN S END CONC HDWL 23FT N C/L LYCOMING ST + 42FT W C/L BANNING WAY MKD (BM)	SG 1792
OTTRBEIN (1955)	538.730	L+BN W END OF CONC HDWL 18FT E C/L BANNING WAY + 18FT S C/L LYCOMING ST	SG 1793
OTTRBEIN (1955)	548.727	L+BN NR CTR OF W CONC HDWL 18FT S C/L LYCOMING ST 0.2 MI W OLD BREA CANYON RD MKD (BM)	SG 1794
OTTRBEIN (1955)	549.033	L+BN NR CTR OF E CONC HDWL 18FT S C/L LYCOMING ST + 0.2 MI W OLD BREA CANYON RD MKD (BM)	SG 1795
OTTRBEIN (1955)	558.329	L+B IN NE COR CONC BRIDGE NO B7 12FT E C/L OLD BREA CANYON RD + 232FT N LYCOMING ST	SG 1796
OTTRBEIN (1955)	558.623	CS MON IN WELL 8IN DN @ NW COR OLD BREA CANYON RD + LYCOMING ST 12FT W + 10FT N C/L INT MKD (BM44-3)	SG 1797
OTTRBEIN (1955)	579.903	RDBM TAG IN CONC HDWL @ NE COR FIFTH AVE + OLD BREA CANYON RD 26FT N + 26FT E C/L INT	SG 1798
OTTRBEIN (1955)	578.650	CS MON IN WELL @ NW COR OLD BREA CANYON RD + FIFTH AVE 11FT N + 11FT W C/L INT	SG 1799
OTTRBEIN (1955)	641.953	USC+GS TRI STA MON FLUSH 27FT W C/L OLD BREA CANYON RD @ INT BREA CANYON RD MKD (STOP 1938)	SG 1800
OTTRBEIN (1955)	717.377	USC+GS MON 6IN UP 50FT E C/L BREA CANYON RD + 0.3 MI S OLD BREA CANYON RD MKD (M 346)	SG 1802
OTTRBEIN (1955)	741.766	USC+GS BR MON FLUSH 50FT E C/L BREA CANYON RD + 0.4 MI S OLD BREA CANYON RD NR HDWL NO B 191 + 25 MKD (N 346)	SG 1803
OTTRBEIN (1955)	801.688	USC+GS MON FLUSH 48FT E C/L BREA CANYON RD + 0.7 MI S OLD BREA CANYON RD 65FT N HDWL NO B 173+89 MKD (S 346)	SG 1804
OTTRBEIN (1955)	793.864	RDBM TAG NR N END HDWL NO B 173+89 20FT E C/L BREA CANYON RD + 0.7 MI S OLD BREA CANYON RD	SG 1805
OTTRBEIN (1955)	772.602	RDBM TAG IN CONC CATTLE UNDER PASS NO B 158+59 32FT W C/L BREA CANYON RD + 1.0 MI N BREA CANYON CUTOFF RD	SG 1806

JUL 1964

LOS ANGELES COUNTY ROAD DEPARTMENT  
SURVEY SECTION FIELD ENGINEERING DIVISION

PAGE 8

QUAD-YEAR	ELEV	DESCRIPTION (INCLUDE QUAD AND YEAR IN DESCRIPTION)	BM NUMBER
OTTRBEIN (1955)	771.437	RDBM TAG IN S END CONC CATTLE UNDERPASS NO B 158+50 24FT E C/L BREA CANYON RD + 1.0 MI N BREA CANYON CUTOFF RD	SG 1807
OTTRBEIN (1955)	731.026	USC+GS BR MON FLUSH 50FT E C/L BREA CANYON RD + 0.7 MI N BREA CANYON CUTOFF RD MKD (X 346)	SG 1808
OTTRBEIN (1955)	727.345	RDBM TAG NR S END CONC HDWL NO 140+93 20FT W C/L BREA CANYON RD + 0.65 MI N BREA CANYON CUTOFF RD	SG 1809
OTTRBEIN (1955)	708.913	RDBM TAG NR S END CONC HDWL NO 127+79 20FT W C/L BREA CANYON RD + 0.4 MI N BREA CANYON CUTOFF RD	SG 1810
OTTRBEIN (1955)	708.143	USC+GS BR MON FLUSH NR HDWL NO 127+79 20FT W C/L BREA CANYON RD + 0.4 MI N BREA CANYON CUTOFF RD MKD (C 347)	SG 1811
OTTRBEIN (1955)	692.623	USC+GS BR MON FLUSH 26FT E C/L BREA CANYON RD + 0.2 MI N BREA CANYON CUTOFF RD MKD (F 347)	SG 1812
OTTRBEIN (1955)	692.859	RDBM TAG IN CONC HDWL NO B 118+54 20FT W C/L BREA CANYON RD + 0.2 MI N BREA CUTOFF RD	SG 1813
OTTRBEIN (1955)	678.372	USC+GS BR MON FLUSH 25FT E C/L BREA CANYON RD + 210FT S C/L BREA CANYON CUTOFF RD MKD (H 347)	SG 1814
OTTRBEIN (1955)	681.867	USC+GS BR WITNESS COR FLUSH 4FT S + 25FT W C/L INT BREA CANYON CUTOFF RD + BREA CANYON RD MKD (SPADRA NO 1)	SG 1815
OTTRBEIN (1955)	762.513	RDBM TAG NR CTR CONC HDWL 18FT N C/L BREA CANYON CUTOFF RD + 0.3 MI N BREA CANYON RD	SG 1816
OTTRBEIN (1955)	765.953	CS BR MON 2IN UP NR 2IN WHITE WITNESS PIPE 110FT N C/L BREA CANYON CUTOFF RD + 0.3 MI N BREA CANYON RD MKD (BM 12)	SG 1817
OTTRBEIN (1955)	809.222	CS BR MON 2IN UP NR 2IN WHITE WITNESS PIPE 50FT E OF E END OF BRIDGE NO B 761 75FT N C/L BREA CANYON CUTOFF RD + 0.5 MI N BREA CANYON RD MKD (BM 11)	SG 1818
OTTRBEIN (1955)	821.605	RDBM TAG IN CONC HDWL 15FT N C/L BREA CANYON CUTOFF RD + 0.55 MI N BREA CANYON RD	SG 1819
OTTRBEIN (1955)	872.247	BT SPK IN CONC HDWL 15FT N C/L BREA CANYON CUTOFF RD + 0.75 MI N BREA CANYON RD 550FT FROM SUMMIT MKD (BM 9)	SG 1820
OTTRBEIN (1955)	874.153	2IN IP 2IN UP 50FT S C/L BREA CANYON CUTOFF RD + 0.75 MI N BREA CANYON RD 500FT FROM SUMMIT MKD (LS 2311)	SG 1821
OTTRBEIN (1955)	894.530	BT HD SPK IN CONC HDWL 21FT W C/L BREA CANYON CUTOFF RD + 0.9 N BREA CANYON RD MKD (BM 7)	SG 1822
OTTRBEIN (1955)	872.072	BT SPK IN CONC DROP INLET 15FT W C/L BREA CANYON CUTOFF RD + 1.0 MI N BREA CANYON RD MKD (BM6)	SG 1823
OTTRBEIN (1955)	772.369	BT SPK IN CONC HDWL OF CATTLE UNDERPASS 16FT SW C/L BREA CANYON CUTOFF RD + 0.75 MI S FIFTH AVE MKD (BM 3)	SG 1824
OTTRBEIN (1955)	770.139	RDBM TAG IN CONC HDWL TO CATTLE UNDERPASS 10FT NE C/L BREA CANYON CUTOFF RD + 0.75 MI S FIFTH AVE	SG 1825
OTTRBEIN (1955)	725.117	L+BN IN CONC HDWL OF DIRT RD TO WATER TANK 10FT N C/L 66FT W C/L BREA CANYON CUTOFF RD + 0.6 MI S FIFTH AVE MKD (BM)	SG 1826

QUAD=YEAR	ELEV	DESCRIPTION (INCLUDE QUAD AND YEAR IN DESCRIPTION)	BM NUMBER
OTTRBEIN (1955)	716.003	L+BN IN CONC HDWL OF DIRT RD TO WATER TANK 36FT S C/L 25FT W C/L BREA CANYON CUTOFF RD + 0.6 MI S FIFTH AVE MKD (BM)	SG 1827
OTTRBEIN (1955)	673.450	RDBM TAG NW COR CONC HDWL 20FT W C/L BREA CANYON CUTOFF RD 50FT S OF BC + 0.4MI S FIFTH AVE	SG 1828
OTTRBEIN (1955)	652.278	CS MON IN WELL 8IN DN @ C/L INT PATHFINDER RD + BREA CANYON CUTOFF RD 3.35 MI S FIFTH AVE	SG 1829
OTTRBEIN (1955)	583.121	CS MON IN WELL 6IN DN 11FT N C/L FIFTH AVE + 0.25 MI E BREA CANYON CUTOFF RD NR MI POST 3.75 MKD (BM 44-7)	SG 1830
OTTRBEIN (1955)	590.158	RDBM TAG NR CTR CONC HDWL 150FT S C/L FIFTH AVE + 0.25 MI E BREA CANYON CUTOFF RD NR MI POST 3.75	SG 1831
OTTRBEIN (1955)	567.961	3/4IN IP 6IN DN @ C/L INT BREA CANYON CUTOFF RD + FIFTH AVE	SG 1832
OTTRBEIN (1955)	567.049	RDBM TAG IN CONC FOOTING OF BREATHER @ SW COR BREA CANYON CUTOFF RD + FIFTH AVE 50FT S + 66FT W C/L INT	SG 1833
OTTRBEIN (1955)	518.992	RDBM TAG NR MI POST 315 45FT S C/L FIFTH AVE + 0.33MI W BREA CANYON CUTOFF RD	SG 1834
OTTRBEIN (1955)	522.064	CS MON IN WELL 6IN DN 10FT N C/L FIFTH AVE + 0.32MI W BREA CANYON CUTOFF RD @ MI POST 3.15 MKD (BM 44-8)	SG 1835
OTTRBEIN (1955)	656.475	CS MON IN WELL 24IN DN 66FT N OF PI PATHFINDER RD 1000FT W C/L BREA CANYON CUTOFF RD	SG 1836
OTTRBEIN (1955)	647.880	CS MON IN WELL 18IN DN 34FT S OF PI PATHFINDER 1000FT W C/L BREA CANYON CUTOFF RD	SG 1837
OTTRBEIN (1955)	632.105	L+T BOTTOM CONC STEP TO GARAGE 80FT S C/L PATHFINDER RD 476FT S C/L REEDVIEW DR + 0.4MI W BREA CANYON CUTOFF RD	SG 1838
OTTRBEIN (1955)	639.230	CS MON 24IN DN 50FT S C/L PATHFINDER RD 388FT S C/L REEDVIEW DR + 0.45MI W BREA CANYON CUTOFF RD	SG 1839
OTTRBEIN (1955)	646.155	CS MON 24IN DN 50FT S RP TO POT C/L PATHFINDER RD + 1027FT E HOWELL RD (USE E EDGE)	SG 1840
OTTRBEIN (1955)	635.450	CS MON 18IN DN 50FT N RP TO POT C/L PATHFINDER RD + 1027FT E HOWELL RD (USE N EDGE)	SG 1841
OTTRBEIN (1955)	613.956	RDBM TAG E CB 25FT N OF ENT TO SOUTHWEST INDUSTRIAL ELECTRONICS CO 18FT E C/L ALEXDALE LANE + 0.2MI S VALENCIA ST MKD (BM)	SG 1842
OTTRBEIN (1955)	613.909	L+BN W CB 25FT N OF ENT TO SOUTHWEST INDUSTRIAL ELECTRONICS CO 18FT W C/L ALEXDALE LANE + 0.2MI S VALENCIA ST MKD (BM)	SG 1843
OTTRBEIN (1955)	551.979	RDBM TAG E CB 1FT S BCR 18FT E C/L ALEXDALE LANE + 50FT S C/L VALENCIA ST	SG 1844
OTTRBEIN (1955)	551.249	L+T W CB 3FT S BCR 18FT W C/L ALEXDALE LANE + 40FT S C/L VALENCIA ST	SG 1845
OTTRBEIN (1955)	546.836	RDBM TAG @ SW COR CONC RET WALL @ NE COR VALENCIA ST + OTTRBEIN AVE 28FT N + 28FT E C/L INT	SG 1846

JUL 1964

LOS ANGELES COUNTY ROAD DEPARTMENT  
SURVEY SECTION FIELD ENGINEERING DIVISION

PAGE 10

QUAD-YEAR	ELEV	DESCRIPTION (INCLUDE QUAD AND YEAR IN DESCRIPTION)	BM NUMBER
OTTRBEIN (1955)	548.442	L+T IN CONC STEP OF WK TO HSE NO 2149 OTTERBEIN AVE 18FT W C/L + 50FT S C/L VALENCIA ST MKD(BM)	SG 1847
OTTRBEIN (1955)	574.030	1/2IN IP 3IN UP IN CONC FTG OF 5FT CHAIN LINK FEN ON NE COR PATHFINDER + DESIRE AVE NLY + 20FT ELY APPROX C/L INT	SG 1848A
OTTRBEIN (1955)	573.895	3/4IN IP + RE 248 TAG 8IN UP ALONG FENCE LINE 128FT W C/L DESIRE AVE + 0.95 MI S FIFTH AVE	SG 1849
OTTRBEIN (1955)	634.836	3/4IN IP 2IN DN 50FT N C/L PATHFINDER RD 295FT W C/L GALLIO AVE + 0.2 MI S AGUIRO ST	SG 1850
OTTRBEIN (1955)	640.156	3/4IN IP 2IN DN 50FT S C/L PATHFINDER RD 295FT W C/L GALLIO AVE + 0.2MI S AGUIRO ST	SG 1851
OTTRBEIN (1955)	647.492	CHIS X IN OIL LINE VALVE BOX CASTING 95FT S C/L PATHFINDER RD 130FT W C/L BATSON AVE + 0.25MI S AGUIRO ST	SG 1852
OTTRBEIN (1955)	629.721	L+LS 2606 TAG IN ROCK @ FENCE COR 50FT N C/L PATHFINDER RD 420FT W C/L BATSON AVE + 0.25 MI S AGUIRO ST	SG 1853
OTTRBEIN (1955)	629.234	3/4IN IP 2IN DN 50FT N C/L PATHFINDER RD + 1835 FT E C/L FULLERTON RD (USE N EDGE)	SG 1854
OTTRBEIN (1955)	636.616	3/4IN IP 2IN DN 50FT S C/L PATHFINDER RD + 1835 FT E C/L FULLERTON RD (USE S EDGE)	SG 1855
OTTRBEIN (1955)	632.471	3/4IN IP 3IN DN 50FT S C/L PATHFINDER RD + 780FT E C/L FULLERTON RD (USE SE EDGE)	SG 1856
OTTRBEIN (1955)	615.015	3/4IN IP 2IN DN 50FT N C/L PATHFINDER RD + 780FT E C/L FULLERTON RD (USE W EDGE)	SG 1857
OTTRBEIN (1955)	629.513	CS MON IN WELL 4FT W C/L FULLERTON RD 35FT E PI + 115FT NE PP NO 1073667E 1.75MI S FIFTH AVE	SG 1858
OTTRBEIN (1955)	629.064	L+BRAD E END OF HDWL 30FT W OF PI FULLERTON RD + 80FT E PP NO 1073667E 1.75MI S FIFTH AVE	SG 1859
BASELINE (1955)	612.651	CS MON IN WELL 15IN DN NR N EDGE OF PVMT VALLEY BLVD 0.25MI E SAN JOSE HILLS RD MKD (COVINA 19 AUX 2)	SG 1872
BASELINE (1955)	604.228	CS MON IN WELL 30IN DN NR CTR TRAFFIC ISE @ INT VALLEY BLVD LA PUENTE RD + SAN JOSE HILLS RD MKD (BM 11-95)	SG 1873
BASELINE (1955)	684.191	CS MON IN WELL 12IN DN 8FT W OF W EDGE PVMT POMONA BLVD + 8FT E OF E EDGE PVMT VALLEY BLVD MKD (BM 11-91)	SG 1898
BASELINE (1955)	771.274	RD BR CAP S HDWL 8FT S OF S RAIL + 11FT NE C/L PROD POMONA + COVINA RD NR INT POMONA BLVD + POMONA + COVINA RD + SECOND ST	SG 1962
OTTRBEIN (1955)	512.090	USC+GS MON IN CONC 2IN UP 20FT E C/L BREA CANYON RD @ L A CO LINE MKD (K422-1935)	SG 2045
OTTRBEIN (1955)	516.709	USC+GS MON IN CONC 6IN UP 34FT E BREA CANYON RD + 100FT N L A CO LINE MKD (E349-1949)	SG 2046
OTTRBEIN (1955)	564.760	USC+GS MON IN CONC 4IN UP 24FT E C/L BREA CANYON RD + 1.7MI S BREA CANYON CUTOFF RD + 0.4MI N L A CO LINE MKD (Y-421-1935)	SG 2047
OTTRBEIN (1955)	566.194	USC+GS MON IN CONC 6IN UP 64FT E C/L BREA CANYON RD + 1.6MI S BREA CANYON CUTOFF RD + 0.45MI NLY OF L A CO LINE MKD (P348-1945)	SG 2048

JUL 1964

LOS ANGELES COUNTY ROAD DEPARTMENT  
SURVEY SECTION FIELD ENGINEERING DIVISION

PAGE 11

QUAD-YEAR	ELEV	DESCRIPTION (INCLUDE QUAD AND YEAR IN DESCRIPTION)	BM NUMBER
OTTRBEIN (1955)	610.720	USC+GS MON IN CONC 3IN UP 100FT SE C/L BREA CANYON RD + 1.25MI S BREA CANYON CUTOFF RD MKD (D 348-1949)	SG 2049
OTTRBEIN (1955)	615.840	USC+GS MON IN CONC 4IN UP 82FT SE C/L BREA CANYON RD + 1.2MI S BREA CANYON CUTOFF RD MKD (C 348-1949)	SG 2050
OTTRBEIN (1955)	632.259	USC+GS MON IN CONC 2IN UP 133FT E C/L BREA CANYON RD + 0.75MI S BREA CANYON CUTOFF RD MKD (T347-1949)	SG 2051
OTTRBEIN (1955)	634.851	USC+GS MON IN CONC 2IN UP 50FT E C/L BREA CANYON RD + 0.7MI S BREA CANYON CUTOFF RD MKD (S 347-1949)	SG 2052
OTTRBEIN (1955)	658.846	RDBM TAG IN SE COR OF HDWL OF CONC CULV 22FT W C/L BREA CANYON RD + 0.45MI S BREA CANYON CUTOFF RD NEAR HWY MARKER NO B87+07	SG 2053
OTTRBEIN (1955)	660.235	USC+GS MON IN CONC FLUSH 30FT W C/L BREA CANYON RD + 0.40MI S BREA CANYON CUTOFF RD MKD (N347-1949)	SG 2054
OTTRBEIN (1955)	620.329	USC+GS MON FLUSH 50FT W C/L BREA CANYON RD 0.3MI N FROM FIFTH AVE MKD (ROW TRI POINT 1938-1958)	SG 2057
OTTRBEIN (1955)	627.069	RDBM TAG 1FT S N END CONC HDWL NR HWY MARKER B263+00 50FT E C/L BREA CANYON RD + 0.4MI N FIFTH AVE	SG 2058
OTTRBEIN (1955)	684.371	MET WATER DIST BR CAP MKD 1FT S N END OF CONC HDWL 38FT E C/L BREA CANYON RD + 0.8MI S DIAMOND BAR BLVD NR HWY MARKER B307+25 MKD (BM 62H 1933)	SG 2059
OTTRBEIN (1955)	687.345	RDBM TAG CONC BASE FENCE POST 1FT E TP NOG19063Y 80FT W C/L BREA CANYON RD 50FT N ENT TO DUMP 0.8MI S DIAMOND BAR BLVD NR HWY MARKER B307+25	SG 2060
OTTRBEIN (1955)	719.998	RDBM TAG IN CONC WK AROUND FOUNTAIN 6IN E OF W EDGE 76FT E + 161FT S C/L INT BREA CANYON RD + DIAMOND BAR BLVD	SG 2061
OTTRBEIN (1955)	719.992	RDBM TAG @ W END OF CATCH BASIN IN S CB OF N DRIVE DIAMOND BAR BLVD 135FT E C/L BREA CANYON RD	SG 2062
OTTRBEIN (1955)	687.518	RDBM TAG 1FT S OF N END CONC HDWL NR HWY MARKER B374+50 35FT E C/L BREA CANYON RD + 0.4MI N DIAMOND BAR BLVD	SG 2063
OTTRBEIN (1955)	685.240	2IN IP FLUSH LS TAG NO 2825 @ 4INX4IN POST NR HWY MARKER B374+50 50FT W C/L BREA CANYON RD + 0.4MI N DAIMOND BAR BLVD MKD (STATE PL)	SG 2064
OTTRBEIN (1955)	765.795	RDBM TAG IN CONC BASE OF FENCE POST 15FT S OF GATE 51FT W C/L BREA CANYON RD + 1.0MI N DIAMOND BAR BLVD	SG 2065
OTTRBEIN (1955)	766.554	RDBM TAG IN CONC BASE OF FENCE POST 92FT N OF GATE + 51FT W C/L BREA CANYON RD + 1.0MI N DIAMOND BAR BLVD	SG 2066
OTTRBEIN (1955)	786.131	CS MON IN WELL 18IN DN WITH 2IN IP MARKER UP 3FT 10FT N 34FT E BREA CANYON RD + 1.5MI N DIAMOND BAR BLVD + 250FT N HWY MARKER B424+90	SG 2067
OTTRBEIN (1955)	781.363	RD MON IN WELL 8IN DN NR 2IN IP MARKER 3FT UP 87FT N C/L BREA CANYON RD NR E FENCE OF STATE HOSPITAL 1.5MI N DIAMOND BAR BLVD NR HWY MARKER B424+90	SG 2068

JUL 1964

LOS ANGELES COUNTY ROAD DEPARTMENT  
SURVEY SECTION FIELD ENGINEERING DIVISION

PAGE 12

QUAD=YEAR	ELEV	DESCRIPTION (INCLUDE QUAD AND YEAR IN DESCRIPTION)	BM NUMBER
OTTRBEIN (1955)	869.057	RDBM TAG CONC BASE OF FENCE POST NR N EDGE OF OLD RD 80FT E C/L BREA CANYON RD 2.0MI N DIAMOND BAR BLVD NR HWY MARKER B457+17	SG 2069
OTTRBEIN (1955)	868.564	RDBM TAG 1FT N OF S END CONC HDWL 31FT W C/L BREA CANYON RD 2.0MI N DIAMOND BAR BLVD NR HWY MARKER B458-53	SG 2070
OTTRBEIN (1955)	778.980	RDBM TAG IN CTR OF CONC PKWY 5FT N + 34FT W C/L INT BREA CANYON RD + ROSELAWN AVE	SG 2071
OTTRBEIN (1955)	778.447	L+PK 6IN S OF N END OF CONC HDWL 75FT N + 19FT E C/L INT BREA CANYON RD + ROSELAWN AVE	SG 2072
OTTRBEIN (1955)	794.329	RDBM TAG 1FT N OF S END CONC HDWL @ NW COR 162FT W + 71FT N C/L INT BELLEVUE AVE + BREA CANYON RD	SG 2073
OTTRBEIN (1955)	796.708	L+PK IN CTR OF ISL RET 51FT E + 8FT S INT BREA CANYON RD + BELLEVUE AVE	SG 2074
BASELINE (1955)	798.871	L+N S CB 1FT E CATCH BASIN 28FT S + 314FT E C/L INT BELLEVUE AVE + 2ND ST	SG 2075
BASELINE (1955)	798.379	CS MON IN WELL 13IN DN IN CTR PKWY RET @ C/L 2ND ST 96FT E C/L BELLEVUE AVE	SG 2076
OTTRBEIN (1955)	868.446	BEG @ BREA CANYON RD + PATHFINDER RD THENCE ELY ALONG PATHFINDER RD 0.2MI RD MON IN WELL 8IN DN NR INT OF TWO CONC DRAINS 75FT NLY C/L 2IN IP MARKER 2FT NLY 3FT UP	SG 2089
OTTRBEIN (1955)	855.284	BEG @ BREA CANYON RD + PATHFINDER RD THENCE ELY ALONG PATHFINDER RD 1300FT RDBM IN WELL 8IN DN AT ELY END OF NLY CUT 55FT NLY C/L	SG 2090
OTTRBEIN (1955)	675.570	BEG @ BREA CANYON RD + DIAMOND BAR BLVD THENCE NELY ALONG DIAMOND BAR BLVD 0.1MI TO CONC BOX CULV IN ISLAND RDBM TAG 2FT RT C/L	SG 2091
OTTRBEIN (1955)	677.001	BEG @ BREA CANYON RD + DIAMOND BAR BLVD THENCE NELY ALONG DIAMOND BAR BLVD 0.1MI TO CONC BOX CULV RDBM TAG 45FT SLY C/L	SG 2092
OTTRBEIN (1955)	732.750	BEG @ BREA CANYON RD + DIAMOND BAR BLVD THENCE NELY ALONG DIAMOND BAR BLVD 0.3MI TO CONC BOX CULV IN ISL RDBM TAG 2FT SELY C/L	SG 2093
OTTRBEIN (1955)	735.019	BEG @ BREA CANYON RD + DIAMOND BAR BLVD THENCE NELY ALONG DIAMOND BAR BLVD 0.3MI TO CONC HDWL 55FT SELY C/L RDBM TAG	SG 2094
OTTRBEIN (1955)	732.172	BEG @ BREA CANYON RD + DIAMOND BAR BLVD THENCE NELY ALONG DIAMOND BAR BLVD 0.9MI TO CONC HDWL 65FT SELY C/L RDBM TAG 2FT SLY AT NLY END	SG 2095
OTTRBEIN (1955)	730.726	BEG @ BREA CANYON RD + DIAMOND BAR BLVD THENCE NELY ALONG DIAMOND BAR BLVD 0.9MI TO CONC HDWL 65FT NWLY C/L RDBM TAG NR CTR HDWL	SG 2096
OTTRBEIN (1955)	756.480	BEG @ BREA CANYON RD + DIAMOND BAR BLVD THENCE NELY ALONG DIAMOND BAR BLVD 1.2MI TO CONC BOX CULV IN ISL RDBM TAG NR C/L	SG 2097
OTTRBEIN (1955)	753.782	BEG @ BREA CANYON RD + DIAMOND BAR BLVD THENCE NELY ALONG DIAMOND BAR BLVD 1.2MI TO CONC HDWL 65FT ELY C/L RDBM TAG NR NLY END	SG 2098
OTTRBEIN (1955)	766.638	RDBM TAG NR CTR OF CONC HDWL @ NWLY COR DIAMOND BAR BLVD + PATHFINDER RD 60FT NLY + 102FT WLY C/L INT	SG 2099

JUL 1964

LOS ANGELES COUNTY ROAD DEPARTMENT  
SURVEY SECTION FIELD ENGINEERING DIVISION

PAGE 13

QUAD-YEAR	ELEV	DESCRIPTION (INCLUDE QUAD AND YEAR IN DESCRIPTION)	BM NUMBER
OTTRBEIN (1955)	772.294	RDBM TAG IN CONC HDWL NR INT DIAMOND BAR BLVD + PATHFINDER RD 224FT NLY + 60FT ELY C/L INT	SG 2100
OTTRBEIN (1955)	798.699	BEG @ PATHFINDER RD + DIAMOND BAR BLVD THENCE 0.4MI NLY ALONG DIAMOND BAR BLVD TO CONC HDWL RDBM TAG NR CTR 70FT ELY C/L	SG 2101
OTTRBEIN (1955)	799.988	BEG @ PATHFINDER RD + DIAMOND BAR BLVD THENCE 0.4MI NLY ALONG DIAMOND BAR BLVD TO CONC HDWL RDBM TAG NR CTR 70FT WLY C/L	SG 2102
OTTRBEIN (1955)	809.847	BEG @ PATHFINDER RD + DIAMOND BAR BLVD THENCE 0.55MI NLY ALONG DIAMOND BAR BLVD TO CONC HDWL RDBM TAG NR CTR 65FT ELY C/L	SG 2103
OTTRBEIN (1955)	811.155	BEG @ PATHFINDER RD + DIAMOND BAR BLVD THENCE 0.55MI NLY ALONG DIAMOND BAR BLVD TO CONC HDWL RDBM TAG NR CTR 65FT WLY C/L	SG 2104
OTTRBEIN (1955)	820.557	BEG @ PATHFINDER RD + DIAMOND BAR BLVD THENCE 0.7MI NLY ALONG DIAMOND BAR BLVD TO CONC HDWL RDBM TAG 65FT ELY C/L	SG 2105
OTTRBEIN (1955)	821.834	BEG @ PATHFINDER RD + DIAMOND BAR BLVD THENCE 0.7MI NLY ALONG DIAMOND BAR BLVD TO CONC HDWL RDBM TAG NR CTR 65FT WLY C/L	SG 2106
OTTRBEIN (1955)	833.916	BEG @ PATHFINDER RD + DIAMOND BAR BLVD THENCE 0.9MI NLY ALONG DIAMOND BAR BLVD TO CONC HDWL RDBM TAG NR CTR 65FT ELY C/L	SG 2107
OTTRBEIN (1955)	835.159	BEG @ PATHFINDER RD + DIAMOND BAR BLVD THENCE 0.9MI NLY ALONG DIAMOND BAR BLVD TO CONC HDWL RDBM TAG NR CTR 65FT WLY C/L	SG 2108
OTTRBEIN (1955)	843.511	BEG @ PATHFINDER RD + DIAMOND BAR BLVD THENCE 1MI NLY ALONG DIAMOND BAR BLVD TO CONC HDWL RDBM TAG NR CTR 65FT ELY C/L	SG 2109
OTTRBEIN (1955)	844.695	BEG @ PATHFINDER RD + DIAMOND BAR BLVD THENCE 1MI NLY ALONG DIAMOND BAR BLVD TO CONC HDWL RDBM TAG NR CTR 65FT WLY C/L	SG 2110
OTTRBEIN (1955)	861.563	BEG @ PATHFINDER RD + DIAMOND BAR BLVD THENCE 1.2MI NLY ALONG DIAMOND BAR BLVD TO CONC HDWL RDBM TAG NR CTR 65FT ELY C/L	SG 2111
OTTRBEIN (1955)	862.894	BEG @ PATHFINDER RD + DIAMOND BAR BLVD THENCE 1.2MI NLY ALONG DIAMOND BAR BLVD TO CONC HDWL RDBM TAG NR CTR 65FT WLY C/L	SG 2112
OTTRBEIN (1955)	879.104	BEG @ PATHFINDER RD + DIAMOND BAR BLVD THENCE 1.4MI NLY ALONG DIAMOND BAR BLVD TO CONC SLAB FLOOR SLY END OF BARN RDBM TAG 113FT WLY C/L	SG 2113
OTTRBEIN (1955)	879.214	BEG @ PATHFINDER RD + DIAMOND BAR BLVD THENCE 1.5MI NLY ALONG DIAMOND BAR BLVD RDBM TAG IN CONC FOOTING OF SLY GATE POST OF 5 STRAND BARBED WIRE FENCE WLY OF PROPOSED C/L	SG 2114
OTTRBEIN (1955)	898.424	BEG @ PATHFINDER RD + DIAMOND BAR BLVD THENCE 1.9MI NLY ALONG DIAMOND BAR BLVD TO SQ CONC FOUNDATION OF WATER VALVE RDBM TAG	SG 2115
OTTRBEIN (1955)	898.714	BEG @ PATHFINDER RD + DIAMOND BAR BLVD THENCE 1.9MI NLY ALONG DIAMOND BAR BLVD TO CONC FOOTING OF 8IN WATER LINE AT POINT OF COMING OUT OF DITCH L+BN MKD (BM)	SG 2116



JUL 1964

LOS ANGELES COUNTY ROAD DEPARTMENT  
SURVEY SECTION FIELD ENGINEERING DIVISION

PAGE 14

QUAD-YEAR	ELEV	DESCRIPTION (INCLUDE QUAD AND YEAR IN DESCRIPTION)	BM NUMBER
OTTRBEIN (1955)	877.717	BEG @ PATHFINDER RD + DIAMOND BAR BLVD THENCE 2.0MI NLY ALONG DIAMOND BAR BLVD L+BN IN 8IN WATER LINE NR POINT OF CROSSING SMALL RAVINE	SG 2117
OTTRBEIN (1955)	890.389	BEG @ PATHFINDER RD + DIAMOND BAR BLVD THENCE 2.3MI NLY ALONG DIAMOND BAR BLVD L+BN CONC FOOTING OF 8IN WATER LINE AT VALVE BOX ON TOP OF SMALL HILL MKD (BM)	SG 2118
OTTRBEIN (1955)	773.914	BEG @ PATHFINDER RD + DIAMOND BAR BLVD THENCE NLY 2.5MI ALONG DIAMOND BAR BLVD L+BN IN WLY CONC COLLAR OF 8IN WATER LINE IN BOTTOM OF SMALL RAVINE MKD (BM)	SG 2119
OTTRBEIN (1955)	773.698	BEG @ PATHFINDER RD + DIAMOND BAR BLVD THENCE NLY 2.5MI ALONG DIAMOND BAR BLVD L+BN IN ELY CONC COLLAR OF 8IN WATER LINE IN BOTTOM OF SMALL RAVINE MKD (BM)	SG 2120
OTTRBEIN (1955)	912.257	BEG @ PATHFINDER RD + DIAMOND BAR BLVD THENCE NLY 3.0MI ALONG DIAMOND BAR BLVD RD MON IN WELL 8IN DN 85FT SE JUNCTION OF FENCES 2IN IP MARKER 3FT UP 2FT S	SG 2121
OTTRBEIN (1955)	924.503	BEG @ PATHFINDER RD + DIAMOND BAR BLVD THENCE NLY 3.0MI ALONG DIAMOND BAR BLVD RD MON IN WELL 8IN DN NR INT OF FENCES 2IN IP MARKER 3FT UP 2FT S	SG 2122
OTTRBEIN (1955)	841.660	BEG @ DIAMOND BAR BLVD + GOLDEN SPRING DR THENCE SLY ALONG DIAMOND BAR BLVD 0.4MI TO SMALL HDWL 25FT ELY C/L RDBM TAG NR CTR	SG 2123
OTTRBEIN (1955)	822.255	BEG @ DIAMOND BAR BLVD + GOLDEN SPRING DR THENCE SLY ALONG DIAMOND BAR BLVD 0.4MI TO SMALL HDWL 95FT WLY C/L RDBM TAG NR CTR	SG 2124
OTTRBEIN (1955)	811.415	BEG DIAMOND BAR BLVD + GOLDEN SPRING DR THENCE SLY ALONG DIAMOND BAR BLVD 0.3MI TO CONC HDWL 100FT WLY C/L RDBM TAG NR CTR	SG 2125
OTTRBEIN (1955)	820.740	BEG @ DIAMOND BAR BLVD + GOLDEN SPRING DR THENCE SLY ALONG DIAMOND BAR BLVD 0.3MI TO CONC HDWL 100FT ELY C/L RDBM TAG NR CTR	SG 2126
OTTRBEIN (1955)	768.275	RDBM TAG W CB 2FT S BCR @ SW COR DIAMOND BAR BLVD + GOLDEN SPRING DR 69FT S + 40FT W C/L INT	SG 2127
OTTRBEIN (1955)	762.798	RDBM TAG W CB 2FT N BCR @ NW COR DIAMOND BAR BLVD + GOLDEN SPRING DR 40FT W + 69FT N C/L INT	SG 2128
OTTRBEIN (1955)	872.423	BEG @ FULLERTON RD + EAST RD THENCE SLY ALONG FULLERTON RD 0.15MI TO PI OF CURVE 3/4IN IP 12IN DN IN WELL	SG 2241
OTTRBEIN (1955)	873.716	BEG @ FULLERTON RD + EAST RD THENCE SLY ALONG FULLERTON RD 0.17MI TO POT RD MON IN WELL 8IN DN NR C/L OF ROCK DRWY TO HSE NO 1968 MKD (RD DEPT 1950)	SG 2242
OTTRBEIN (1955)	857.133	RD MON IN WELL 6IN DN NR PI OF CURVE NR INT FULLERTON RD + DOROTHEA RD 10FT WLY ALONG SEMITAN MKD (RD DEPT 1950)	SG 2243
OTTRBEIN (1955)	840.614	RD MON IN WELL 8IN DN @ EC ON FULLERTON RD OF CURVE 168FT WLY INT DOROTHEA RD MKD (RD DEPT 1950)	SG 2244
OTTRBEIN (1955)	723. <sup>343</sup> <del>743</del>	RD MON IN WELL 9IN CN @ EC ON FULLERTON RD OF CURVE 160FT NELY INT CHOTA RD MKD (RD DEPT 1950)	SG 2245

JUL 1964

LOS ANGELES COUNTY ROAD DEPARTMENT  
SURVEY SECTION FIELD ENGINEERING DIVISION

PAGE 15

QUAD-YEAR	ELEV	DESCRIPTION (INCLUDE QUAD AND YEAR IN DESCRIPTION)	BM NUMBER
OTTRBEIN (1955)	703.980	3/4IN IP IN WELL 6IN DN @ BC ON FULLERTON RD OF CURVE 160FT SELY INT CHOTA RD MKD (RD DEPT 1950)	SG 2246
OTTRBEIN (1955)	657.393	BEG @ FULLERTON RD + CHOTA RD THENCE SWLY ALONG FULLERTON RD 0.2MI TO SLY POST OF CURVE RD MON IN WELL 6IN DN 132FT NWLY C/L DRWY TO HSE NO 1517 MKD (RD DEPT 1950)	SG 2247
OTTRBEIN (1955)	646.137	BEG @ FULLERTON RD + CHOTA RD THENCE SLY ALONG FULLERTON RD 0.2MI TO PI OF CURVE A BROKEN-OFF RD MON IN WELL 7IN DN 15FT NWLY C/L DR TO HSE NO 1517	SG 2248
OTTRBEIN (1955)	565.155	RD MON IN WELL 7IN DN @ PI OF CURVE @ INT FULLERTON RD + KASHLAN RD MKD (RD DEPT 1950)	SG 2249
OTTRBEIN (1955)	556.828	3/4IN IP IN WELL 12IN DN @ PI OF CURVE ALONG FULLERTON RD 102FT S KASHLAN RD	SG 2250
OTTRBEIN (1955)	541.524	L+T CTR CHIS SQ IN CONC HDWL OF 18IN PIPE @ NW COR FULLERTON RD + VISTA RD 75FT N + 18FT W C/L INT MKD (SEP 24-24)	SG 2251
OTTRBEIN (1955)	533.374	3/4IN IP IN WELL 11IN DN @ PI OF CURVE ON FULLERTON RD 105FT S VISTA RD	SG 2252
OTTRBEIN (1955)	579.443	BEG @ FULLERTON RD + KASHLAN RD THENCE 0.17MI WLY ALONG KASHLAN RD L+BN IN CONC APRON OF DRWY TO HSE NO 1840 15FT S C/L MKD (BM)	SG 2253
OTTRBEIN (1955)	575.164	BEG @ FULLERTON RD + KASHLAN RD THENCE 0.2MI WLY ALONG KASHLAN RD L+BN E WALL OF 14IN DRAIN PIPE 25FT N C/L + 18FT E C/L DRWY TO HSE NO 1803 MKD (BM)	SG 2254
OTTRBEIN (1955)	584.483	L+BN NR CTR CB RET OF PRIV DR @ SW COR KASHLAN RD + CHOTA RD 18FT S + 70FT W C/L INT	SG 2255
OTTRBEIN (1955)	581.489	L+BN CTR OF CONC HDWL OF 20IN DRAIN PIPE @ NW COR KASHLAN RD + CHOTA RD 27FT N + 70FT W C/L INT	SG 2256
OTTRBEIN (1955)	643.940	1-1/2IN IP 2IN UP @ SW COR KASHLAN RD + COBAN RD 15FT S + 20FT W C/L INT 4FT SE FIR HYDRANT	SG 2257
OTTRBEIN (1955)	641.031	L+BN COR OF CONC DR TO HSE @ NW COR KASHLAN RD + COBAN RD 16FT N + 75FT W C/L INT	SG 2258
OTTRBEIN (1955)	492.320	L+BN CTR CONC HDWL NE COR KASHLAN RD + POPENOE RD 50FT N + 16FT E C/L INT MKD (BM)	SG 2259
OTTRBEIN (1955)	490.127	L+BN CTR CONC HDWL @ SW COR KASHLAN RD + POPENOE RD 16FT S + 40FT W C/L INT MKD (BM)	SG 2260
OTTRBEIN (1955)	531.566	L+BN CONC CB OF DR @ SW COR CYPRESS ST + NABAL RD 65FT S + 45FT W C/L INT MKD (BM)	SG 2261
OTTRBEIN (1955)	534.247	L+BN CONC FOOTING OF LARGE CHAIN LINK GATE @ NW COR CYPRESS ST + NABAL RD 5FT N + 60FT W C/L INT MKD (BM)	SG 2262
OTTRBEIN (1955)	637.251	BEG @ NABAL RD + BENIK RD THENCE NLY ALONG NABAL RD 0.15MI L+BN @ SW COR OF 4FT CHAIN LINK FENCE 20FT E C/L PVMT MKD (BM)	SG 2263
OTTRBEIN (1955)	640.590	BEG @ NABAL RD + BENIK RD THENCE NLY ALONG NABAL RD 0.16MI L+BN CONC SLAB OF GARAGE WK @ HSE NO 1649 50FT W C/L PVMT MKD (BM)	SG 2264

QUAD-YEAR	ELEV	DESCRIPTION (INCLUDE QUAD AND YEAR IN DESCRIPTION)	BM NUMBER
OTTRBEIN (1955)	832.048	L+BN CONC STEP OF HSE @ NW COR NABAL RD + DOROTHEA RD 30FT W + 11FT N C/L INT MKD (BM)	SG 2265
OTTRBEIN (1955)	819.241	L+BN IN CONC WALL @ SW COR TUMIN RD + DOROTHEA RD 24FT S + 27FT W C/L INT MKD (BM)	SG 2266
OTTRBEIN (1955)	422.294	CS MON 8IN DN NR C/L INT HALLIBURTON RD + STIMSON AVE MKD (CO SUR RE 63)	SG 2486
OTTRBEIN (1955)	420.834	CS TAG W CB 1FT N BCR @ NW COR HALLIBURTON RD + STIMSON AVE 65FT N + 25FT W C/L INT	SG 2487
OTTRBEIN (1955)	371.046	RAM SET S CB 1FT E BCR @ SE COR STIMSON AVE + SIGMAN ST 18FT S + 56FT E C/L INT MKD (SD 122)	SG 2488
OTTRBEIN (1955)	370.465	RAM SET N CB 1FT E BCR @ NE COR STIMSON AVE + SIGMAN ST 18FT N + 56FT E C/L INT	SG 2489
OTTRBEIN (1955)	428.885	R E TAG NO 10103 1FT N BCR @ SW COR WEDGEWORTH DR + FIELDGATE AVE 40FT S + 18FT W C/L INT	SG 2490
OTTRBEIN (1955)	426.374	R E TAG NO 10303 E CB @ BCR @ NE COR WEDGEWORTH DR + FIELDGATE AVE 48FT N + 20FT E C/L INT	SG 2491
OTTRBEIN (1955)	472.961	RDBM TAG CONC FTG OF EDISON TOWER NO 1-1 SECOND TOWER S WEDGEWORTH DR 200FT E FIELDGATE AVE	SG 2492
OTTRBEIN (1955)	472.993	RDBM TAG SW CONC FTG OF EDISON TOWER NO 1-1 SECOND TOWER S WEDGEWORTH DR 200FT E FIELDGATE AVE	SG 2493
BASELINE (1955)	360.961	L+T W CB HACIENDA BLVD 42FT W C/L @ C/L PROD SIGMAN ST	SG 2577
BASELINE (1955)	361.523	L+T S CB 17FT E BCR @ SE COR HACIENDA BLVD + SIGMA ST 18FT S + 97FT E C/L INT CB PAINTED (BM)	SG 2578
BASELINE (1955)	438.708	RD MON IN WELL 8IN DN @ C/L INT HACIENDA BLVD + TETLEY ST MKD (RD DEPT 1962)	SG 2579
BASELINE (1955)	439.979	L+T E CB HACIENDA BLVD 40FT E C/L ON C/L PROD TETLEY ST	SG 2580
BASELINE (1955)	497.169	L+T N CB 3FT E BCR @ NE COR HACIENDA BLVD + LOS ALTOS DR 17FT N + 80FT E C/L INT	SG 2581
BASELINE (1955)	498.781	L+T E CB (W CB SERVICE ISLAND) HACIENDA BLVD 30FT S BCR @ SE COR LOS ALTOS DR 60FT S + 42 FT E C/L INT	SG 2582
BASELINE (1955)	519.777	L+BN E CB (W CB SERVICE ISLAND) HACIENDA BLVD 2FT N BCR @ NE COR DEL PRADO DR 30FT N + 45FT E C/L INT	SG 2583
BASELINE (1955)	521.868	L+BN E CB (W CB SERVICE ISLAND) HACIENDA BLVD 2FT S BCR @ SE COR DEL PRADO DR 35FT S + 45FT E C/L INT	SG 2584
BASELINE (1955)	602.867	RDBM TAG N CB 5FT E FUTURE BCR @ NE COR HACIENDA BLVD + RICHVIEW DR 20FT N + 72FT E C/L INT	SG 2585
BASELINE (1955)	604.609	L+BN 4FT NLY BCR 35FT ELY C/L HACIENDA BLVD 40FT SLY C/L RICHVIEW DR	SG 2586
BASELINE (1955)	683.156	L+BN 15FT WLY FROM C/L HACIENDA BLVD + 0.3MI SLY FROM C/L INT HACIENDA BLVD + RICHVIEW DR	SG 2587

JUL 1964

LOS ANGELES COUNTY ROAD DEPARTMENT  
SURVEY SECTION FIELD ENGINEERING DIVISION

PAGE 17

QUAD-YEAR	ELEV	DESCRIPTION (INCLUDE QUAD AND YEAR IN DESCRIPTION)	BM NUMBER
BASELINE (1955)	709.404	CSBM MON FLUSH 17FT W C/L HACIENDA BLVD 0.35MI SLY INT HACIENDA BLVD + RICHVIEW DR MKD (BM 38-7)	SG 2588
BASELINE (1955)	844.706	L+T IN CONC WALL OF DRAIN 15FT W APPROX C/L HACIENDA BLVD 0.7MI SLY INT HACIENDA BLVD + RICHVIEW DR MKD (BM)	SG 2589
BASELINE (1955)	866.507	RDBM TAG CONC HDWL BY PRIVATE DRWY 66FT E APPROX C/L HACIENDA BLVD 0.8MI SLY INT HACIENDA BLVD + RICHVIEW DR	SG 2590
BASELINE (1955)	897.425	CS BM MON IN WELL 9IN AT INT HACIENDA BLVD + SKYLINE DR 25FT W + 14FT N C/L INT MKD (BM- 38-6 1954)	SG 2591
BASELINE (1955)	896.096	CO SUR MON IN WELL 18IN DN @ OR NR C/L INT HACIENDA BLVD + SKYLINE DR MKD (CO SUR RE 2177)	SG 2592
BASELINE (1955)	791.838	RDBM TAG CONC HDWL OF DRAIN 36FT E APPROX C/L HACIENDA BLVD 0.3MI SLY INT HACIENDA BLVD + SKYLINE DR	SG 2593
BASELINE (1955)	786.115	CS MON 2IN UP @ PE OF OLD RD ON SEMI-TAN GOING SELY 12FT N TP W7302Y 0.35MI SLY INT HACIENDA BLVD + SKYLINE DR MKD (CO SUR RE 2177)	SG 2594
BASELINE (1955)	747.617	CS MON IN WELL 12IN DN 25FT E C/L HACIENDA BLVD + 4.6FT N C/L CANADA SOMBRA RD MKD (BM 38-5 1954)	SG 2595
BASELINE (1955)	698.425	CS MON IN WELL 18IN DN 15FT WLY APPROX C/L HACIENDA BLVD + ON OR NR C/L GREENVIEW RD MKD (CS RE 2177)	SG 2596
BASELINE (1955)	496.466	L+T CONC RET WALL OF HSE ON NW COR HACIENDA BLVD + WEST RD 60FT NLY + 18FT WLY APPROX C/L INT OPP SG 1667	SG 2597
BASELINE (1955)	491.594	L+T CONC WK ON NE COR HACIENDA BLVD + AVOCADO CREST RD 18FT N + 33FT E C/L INT (MKD BM)	SG 2598
BASELINE (1955)	490.228	RD BM TAG CONC HDWL ON SE COR HACIENDA BLVD + AVOCADO CREST RD 15FT S + 18FT E C/L INT	SG 2599
BASELINE (1955)	429.612	L+T S CB 1FT E BCR @ SE COR HACIENDA BLVD + JANINE RD 15FT S + 75FT E C/L INT	SG 2600
BASELINE (1955)	425.009	CS MON IN WELL 15IN DN ON C/L HACIENDA BLVD @ INT OF ORANGE COUNTY LINE	SG 2601
OTTRBEIN (1955)	482.627	BT SPK W END CONC CULV HDWL S SIDE FIFTH AVE @ MI POST 2.28	SG 2610
OTTRBEIN (1955)	477.037	RDBM TAG E CB 3FT S BCR @ SE COR FIFTH AVE + PASO REAL AVE 80FT S + 18FT E C/L INT	SG 2611
OTTRBEIN (1955)	477.017	RDBM TAG W CB 3FT S BCR @ SW COR FIFTH AVE + PASO REAL AVE 80FT S + 18FT W C/L INT	SG 2612
OTTRBEIN (1955)	470.794	L+T W END GAS ISL ON SE COR FIFTH AVE + DESIRE AVE 655FT + 80FT E C/L INT MKD (BM)	SG 2613
OTTRBEIN (1955)	468.306	CS MON IN WELL 10IN DN 11FT S CTR PVMT FIFTH AVE + ON NLY PROD PROLONGATION OF WLY EDGE PVMT DESIRE AVE MKD (BM 44-10 1955)	SG 2614

JUL 1964

LOS ANGELES COUNTY ROAD DEPARTMENT  
SURVEY SECTION FIELD ENGINEERING DIVISION

PAGE 18

QUAD-YEAR	ELEV	DESCRIPTION (INCLUDE QUAD AND YEAR IN DESCRIPTION)	BM NUMBER
OTTRBEIN (1955)	462.893	CITY OF INDUSTRY BR MON IN CB @ SE COR FIFTH AVE + JELLYCK AVE 45FT S + 53FT E C/L INT MKD (BENCH MARK 5-9)	SG 2615
OTTRBEIN (1955)	462.184	RDBM TAG S CB 4FT SW BCR @ SW COR FIFTH AVE + JELLYCK AVE 45FT S + 94FT W C/L INT	SG 2616
OTTRBEIN (1955)	462.712	RDBM TAG N CB SERV ISL ON NE COR FIFTH AVE + BATSON AVE 55FT N + 35FT E C/L INT	SG 2617
OTTRBEIN (1955)	463.780	CE BR MON IN CONC WK AROUND MH ON NW COR FIFTH AVE + BATSON AVE 56FT N + 41FT W C/L INT MKD (BM 44-11A 1963)	SG 2618
OTTRBEIN (1955)	504.774	RDBM TAG N CB W BCR @ NW COR DESIRE AVE + HONORE ST 20FT N + 66FT W C/L INT	SG 2619
OTTRBEIN (1955)	480.453	RDBM TAG W CB DESIRE AVE 20FT W C/L + 500FT S FIFTH AVE NR N FENCE LINE OF SCHOOL	SG 2620
OTTRBEIN (1955)	445.410	CITY OF INDUSTRY BR MON IN CONC FTG OF N GATE POST @ ENT TO HSE NO 1337 JELLYCK AVE 1500FT N FIFTH AVE + 25FT W C/L MKD (BENCH MARK 5-8)	SG 2621
OTTRBEIN (1955)	441.745	L+T CONC FTG OF N GATE POST TO HSE NO 1307 JELLYCK AVE 18FT W C/L + 0.4MI N FIFTH AVE MKD (BM)	SG 2622
OTTRBEIN (1955)	437.475	L+T N CB OF DR TO HSE NO 1231 JELLYCK AVE 25FT W C/L + 0.45MI N FIFTH AVE MKD (BM)	SG 2623
OTTRBEIN (1955)	434.807	CHIS X ON BOLT OF RR CROSSING SIGNAL ON SW COR JELLYCK AVE + RAILROAD ST 66FT S + 15FT W C/L INT	SG 2624
OTTRBEIN (1955)	433.567	CITY OF INDUSTRY BR MON IN NW COR CONC FRAME AROUND GAS VALVES ON SE COR JELLYCK AVE + RAILROAD ST 30FT S + 21FT E INT MKD (BENCH MARK 5-7)	SG 2625
OTTRBEIN (1955)	425.646	L+T CONC WK TO BLDG N SIDE RAILROAD ST 24FT N + 70FT E SPUR TRACK TO PLANT MKD (BM)	SG 2626
OTTRBEIN (1955)	425.156	CITY OF INDUSTRY BR MON IN CONC FTG AT W GATE POST OF RR SPUR TRACK 25FT N C/L RAILROAD ST + 0.3MI W JELLYCK AVE MKD (BENCH MARK 5-6)	SG 2627
OTTRBEIN (1955)	420.892	RDBM TAG W CB 1FT N BCR @ NW COR RAILROAD ST + LAWSON ST 45FT N + 18FT W INT	SG 2628
OTTRBEIN (1955)	418.546	CITY OF INDUSTRY BR MON W CB LAWSON ST 18FT W C/L + 500FT N RAILROAD ST MKD (BENCH MARK 5-13)	SG 2629
OTTRBEIN (1955)	420.021	L+BN CONC FTG OF SIGN ON NW COR LAWSON ST + ROWLAND ST 18FT N + 20FT W C/L INT MKD (BM)	SG 2630
OTTRBEIN (1955)	392.674	L+BN CONC RIM OF SMH 15FT E C/L LAWSON ST + 0.2MI N ROWLAND ST MKD (BM)	SG 2631
OTTRBEIN (1955)	389.717	L+BN CONC RIM OF SMH 15FT E C/L LAWSON ST + 0.2MI N ROWLAND ST MKD (BM)	SG 2632
OTTRBEIN (1955)	594.645	RDBM TAG W CB SIERRA VISTA DR 16FT W C/L + 130FT S CUL-DE-SAC ON N END ST NR PP NO 1154440E	SG 2633
OTTRBEIN (1955)	596.895	L+BRAD IN N CUL-DE-SAC OF SIERRA VISTA DR NR DR TO HSE NO 1678 MKD (BM)	SG 2634