

**LOS ANGELES COUNTY  
DEPARTMENT OF PUBLIC WORKS**

**BENCH MARK LIST**



**OTTERBEIN QUAD**

**1995 ADJUSTMENT**

**NAVD 88 DATUM  
METRIC**

PREFACE

The Department of Public Works level net is composed of more than 1,700 miles or 2720 kilometers of levels supporting in excess of 9,000 bench marks. Previously when a major readjustment of the net was undertaken, to emphasize the complete break with previous elevations, the CY, CG, & CL, series bench marks were re-labeled DY, DG, & DL, respectively. Beginning in 1993 the baseline readjustment year will be indicated on baseline BM,s only indicated below (\*). Henceforth all BM numbers will be labeled as a Y, G, or L, series that will no longer indicate the major adjustment year.

To facilitate the adjustment, indexing and distribution of adjusted values of the net, the county territory was divided into 33 quads or areas. For the identification purposes each quad was given a name, viz., "Rosemead," "La Mirada," "Santa Fe," etc. When bench marks and elevations in these quads are used, the name must be included in the bench mark description, e.g.,

\* BASELINE    90.057 L&BR IN CTR OF CB RET @ NE COR                    Y 9191  
  (1990)    295.461 LA HABRA BLVD & VALLEY HOME AVE  
              10.7M N & 10.7M E/O C/L INT

It is expected that this general adjustment will for the most part remain sound for 8 to 12 years. Updating constrained adjustments will continue in the future. When a quad is readjusted, new elevations will be published and the date of readjustment will be noted in the bench mark description. Two bench marks with different adjustment dates will not normally agree with each other.

The basic accuracy of the net is reflected by an indicated field probable error of plus or minus 0.004mm per kilometer of leveling as determined from the conditions of closure. However, many years of experience in vertical control in the greater Los Angeles basin and Antelope Valley indicate that because of varying degrees of subsidence and heaving, the true datum is recovered only by obtaining substantial agreement of a number of bench marks.

The users of this net are invited to assist in its maintenance by notifying this department of cases of obliteration, apparent mistakes in description or elevations, and proven disturbance of bench marks.

=====  
DATUM: North American Vertical Datum of 1988 (NAVD88)

Note: NAVD 1988 minus approximately 700mm (2.3ft) equals  
Previous NGVD 1929 Datums. For more accurate equations  
At individual bench marks refer to previous publications

ABBREVIATIONS USED IN BENCH MARK LISTINGS

ABUT -----	Abutment	ECR -----	End of Curb Return
ALG -----	Along	EC -----	End of Curve
ANG PT -----	Angle Point	ENT -----	Entrance
B/W -----	Back of Walk	FL -----	Floor
BCR -----	Beginning of Curb Return	FTG -----	Footing
BC -----	Beginning of Curve	FRWY -----	Freeway
BLDG -----	Building	F/W -----	Front of Walk
BM -----	Bench Mark	GAR -----	Garage
BT SPK -----	Boat or Bolt Spike	HDWL -----	Headwall
BR CAP -----	Brass or Bronze Cap	HSE -----	House
C B -----	Catch Basin	HWY -----	Highway
CTR -----	Center	INT -----	Intersection
C/L -----	Center Line	IP -----	Iron Pipe
C/L INT -----	Center Line Intersection	LT -----	Left
C/L PROD -----	Center Line Produced	LACE -----	L.A. City Engineer
CONC -----	Concrete	LACS -----	L.A. Co. Engineer
COR -----	Corner	LAFC -----	L.A. Co. Flood Control
COE -----	Corps of Engineers	L&BN -----	Lead and Bench Nail
CULV -----	Culvert	L&BR -----	Lead and Brad
CYN -----	Canyon	L&N -----	Lead and Nail
CB -----	Curb	L&SPK -----	Lead and Spike
CS MON -----	Co. Eng. Monument	L&T -----	Lead and Tack
CT SPK -----	Cut Spike	MCR -----	Middle of Curb Return
DPW -----	Dept. of Public Works	MKD -----	Marked
DR -----	Drive or Driveway	MC -----	Middle of Curve
E/O -----	East of	MON -----	Monument

ABBREVIATIONS USED IN BENCH MARKS (CON'T)

N/O ----- North of  
NR ----- Near  
OPP ----- Opposite  
PI ----- Point of Intersection  
PK&W ----- PK Nail and Washer  
P/L ----- Property Line  
POST ----- Point of Semi-Tangent  
PP ----- Power Pole  
PVMT ----- Pavement  
PROD ----- Produced  
RD ----- Road  
RDBM ----- Road Dept. Bench Mark  
RDBM TAG ----- Road Dept. Bench Mark Tag  
RR ----- Railroad  
RT ----- Right  
R/W ----- Right of Way  
SDMH ----- Storm Drain Manhole  
SMH ----- Sewer Manhole  
SPK ----- Spike  
ST&W ----- Spike Tin and Washer  
S/O ----- South of  
TP ----- Telephone Pole  
USC&GS ----- U.S. Coast and Geodetic Survey  
USGS ----- U.S. Geological Survey  
WK ----- Walk  
W/O ----- West of  
D90/L-3

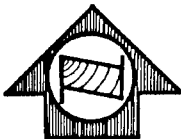
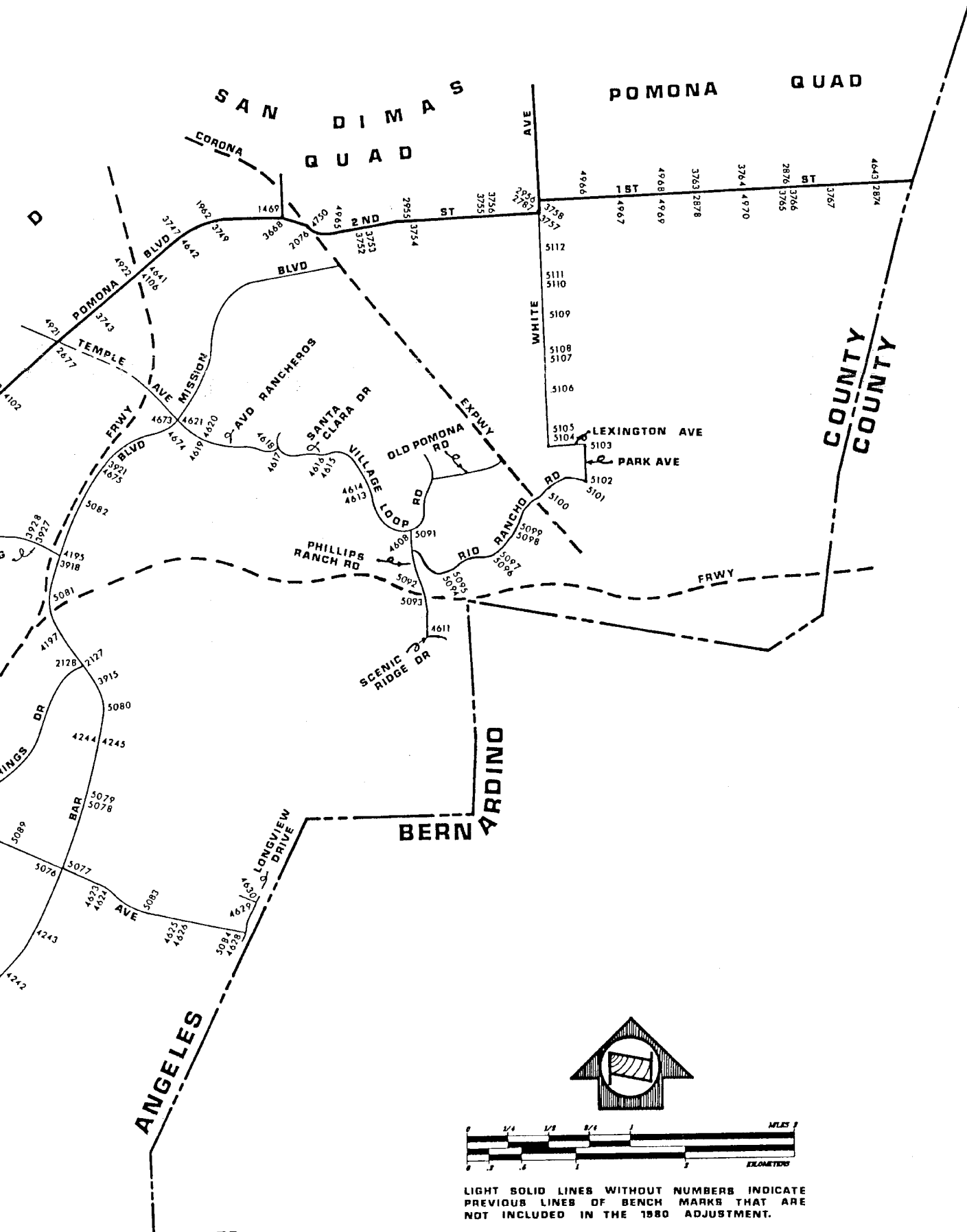

LIGHT SOLID LINES WITHOUT NUMBERS INDICATE PREVIOUS LINES OF BENCH MARKS THAT ARE NOT INCLUDED IN THE 1980 ADJUSTMENT.

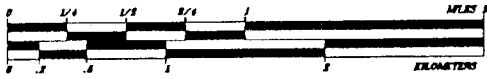
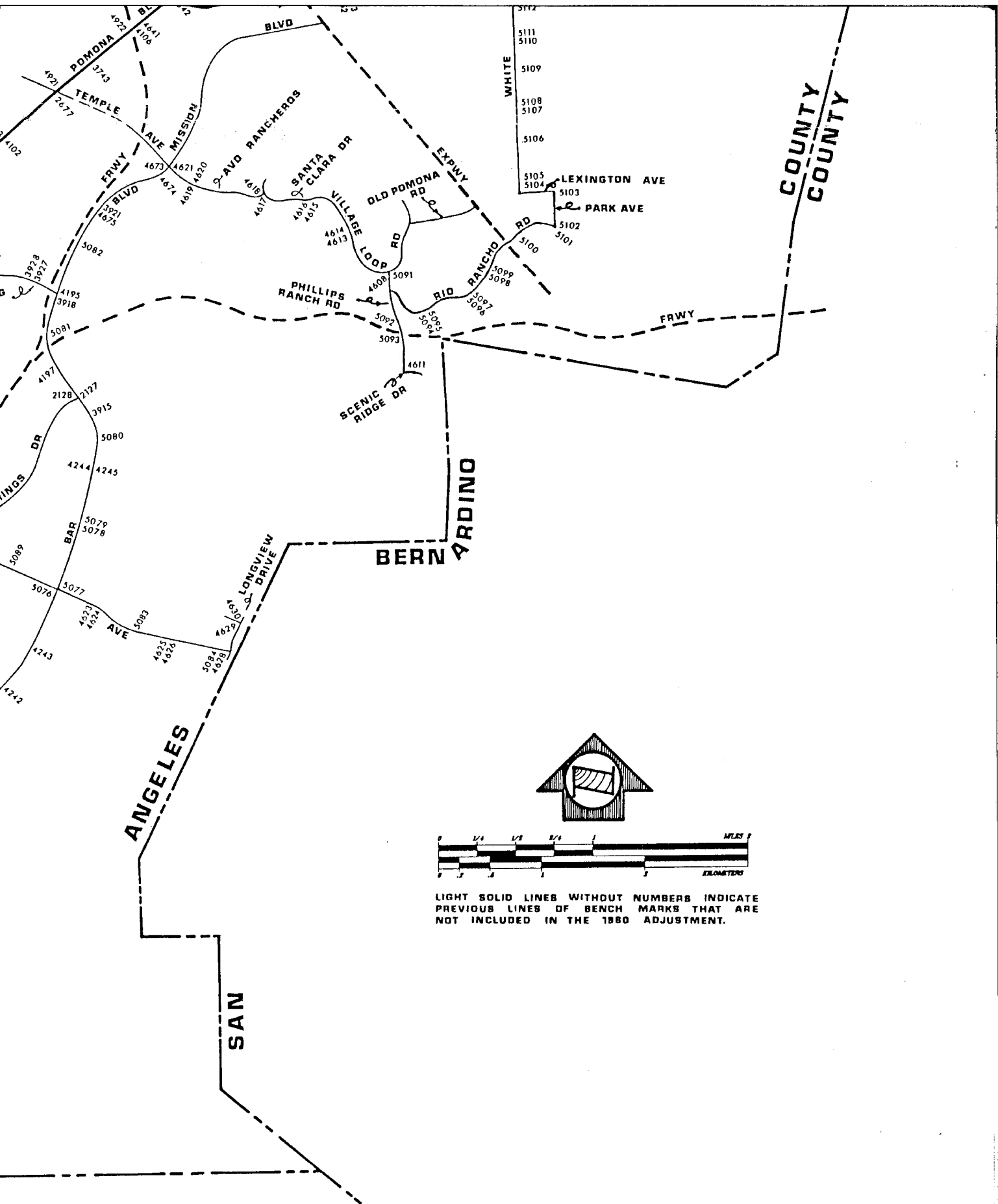

LIGHT SOLID LINES WITHOUT NUMBERS INDICATE PREVIOUS LINES OF BENCH MARKS THAT ARE NOT INCLUDED IN THE 1980 ADJUSTMENT.

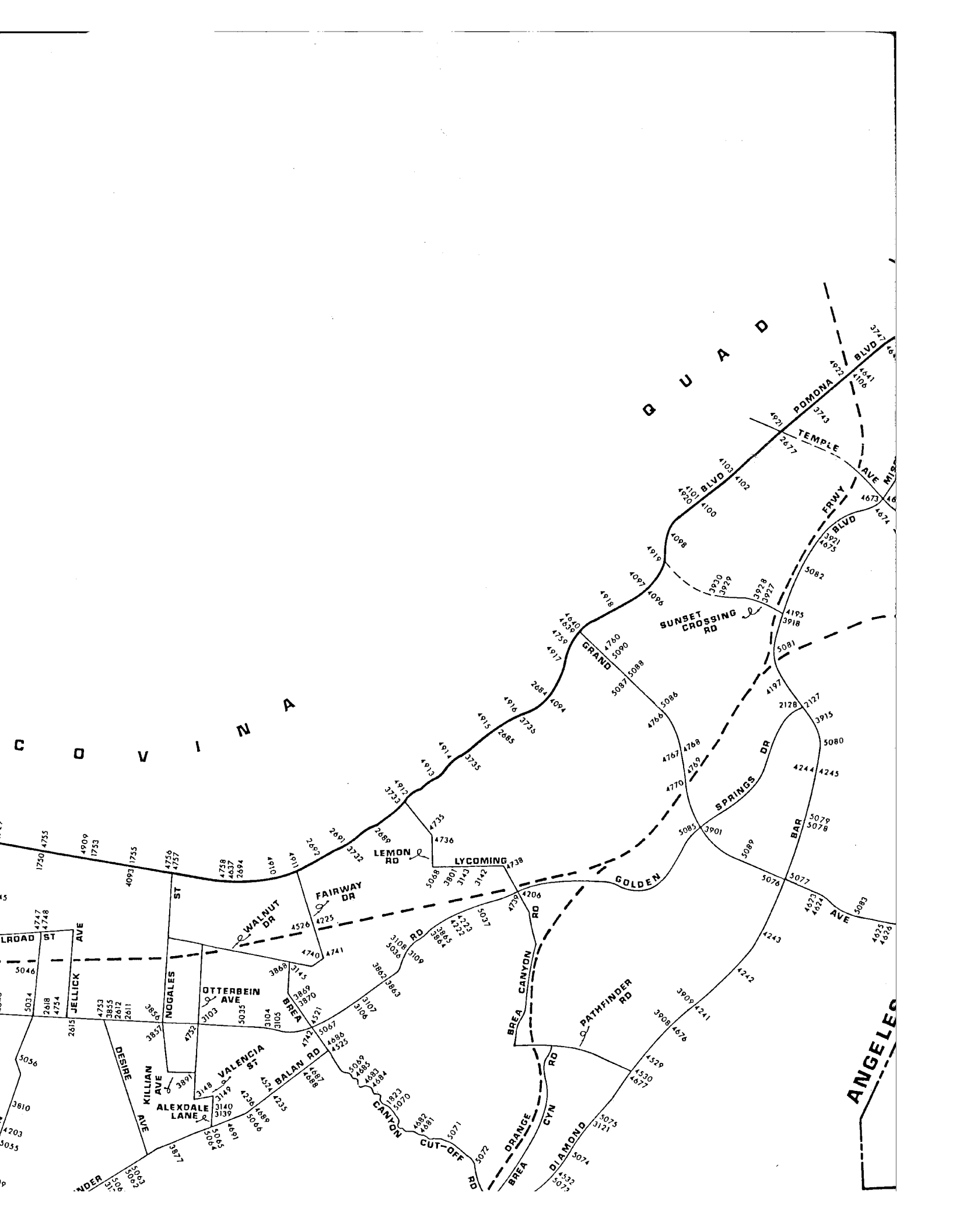

COVINA

GUADALUPE

ANGELES

ROAD ST  
5046  
5034  
2818  
4754  
2615  
3810  
4203  
3055  
5056  
3877  
5065  
5066  
5067  
5068  
5069  
5070  
5071  
5072

JELLYCK AVE  
4753  
3855  
2612  
2611  
3856  
3857  
3858  
3859  
3860  
3861  
3862  
3863  
3864  
3865  
3866  
3867  
3868  
3869  
3870  
3871  
3872  
3873  
3874  
3875  
3876  
3877  
3878  
3879  
3880  
3881  
3882  
3883  
3884  
3885  
3886  
3887  
3888  
3889  
3890  
3891  
3892  
3893  
3894  
3895  
3896  
3897  
3898  
3899  
3900  
3901  
3902  
3903  
3904  
3905  
3906  
3907  
3908  
3909  
3910  
3911  
3912  
3913  
3914  
3915  
3916  
3917  
3918  
3919  
3920  
3921  
3922  
3923  
3924  
3925  
3926  
3927  
3928  
3929  
3930  
3931  
3932  
3933  
3934  
3935  
3936  
3937  
3938  
3939  
3940  
3941  
3942  
3943  
3944  
3945  
3946  
3947  
3948  
3949  
3950  
3951  
3952  
3953  
3954  
3955  
3956  
3957  
3958  
3959  
3960  
3961  
3962  
3963  
3964  
3965  
3966  
3967  
3968  
3969  
3970  
3971  
3972  
3973  
3974  
3975  
3976  
3977  
3978  
3979  
3980  
3981  
3982  
3983  
3984  
3985  
3986  
3987  
3988  
3989  
3990  
3991  
3992  
3993  
3994  
3995  
3996  
3997  
3998  
3999  
4000

WALNUT DR  
4759  
4758  
4637  
2894  
4093  
1755  
4756  
4757  
4758  
4759  
4760  
4761  
4762  
4763  
4764  
4765  
4766  
4767  
4768  
4769  
4770  
4771  
4772  
4773  
4774  
4775  
4776  
4777  
4778  
4779  
4780  
4781  
4782  
4783  
4784  
4785  
4786  
4787  
4788  
4789  
4790  
4791  
4792  
4793  
4794  
4795  
4796  
4797  
4798  
4799  
4800

FAIRWAY DR  
4526  
4225  
4740  
4741  
3108  
3109  
3110  
3111  
3112  
3113  
3114  
3115  
3116  
3117  
3118  
3119  
3120  
3121  
3122  
3123  
3124  
3125  
3126  
3127  
3128  
3129  
3130  
3131  
3132  
3133  
3134  
3135  
3136  
3137  
3138  
3139  
3140  
3141  
3142  
3143  
3144  
3145  
3146  
3147  
3148  
3149  
3150  
3151  
3152  
3153  
3154  
3155  
3156  
3157  
3158  
3159  
3160  
3161  
3162  
3163  
3164  
3165  
3166  
3167  
3168  
3169  
3170  
3171  
3172  
3173  
3174  
3175  
3176  
3177  
3178  
3179  
3180  
3181  
3182  
3183  
3184  
3185  
3186  
3187  
3188  
3189  
3190  
3191  
3192  
3193  
3194  
3195  
3196  
3197  
3198  
3199  
3200

LEMON RD  
2689  
3732  
2691  
3732  
2692  
4911  
0169  
4912  
3733  
4913  
3734  
4914  
3735  
4915  
2685  
4916  
3736  
4917  
2684  
4918  
3737  
4919  
2683  
4920  
3738  
4921  
2682  
4922  
3739  
4923  
2681  
4924  
3740  
4925  
2680  
4926  
3741  
4927  
2679  
4928  
3742  
4929  
2678  
4930  
3743  
4931  
2677  
4932  
3744  
4933  
2676  
4934  
3745  
4935  
2675  
4936  
3746  
4937  
2674  
4938  
3747  
4939  
2673  
4940  
3748  
4941  
2672  
4942  
3749  
4943  
2671  
4944  
3750  
4945  
2670  
4946  
3751  
4947  
2669  
4948  
3752  
4949  
2668  
4950  
3753  
4951  
2667  
4952  
3754  
4953  
2666  
4954  
3755  
4955  
2665  
4956  
3756  
4957  
2664  
4958  
3757  
4959  
2663  
4960  
3758  
4961  
2662  
4962  
3759  
4963  
2661  
4964  
3760  
4965  
2660  
4966  
3761  
4967  
2659  
4968  
3762  
4969  
2658  
4970  
3763  
4971  
2657  
4972  
3764  
4973  
2656  
4974  
3765  
4975  
2655  
4976  
3766  
4977  
2654  
4978  
3767  
4979  
2653  
4980  
3768  
4981  
2652  
4982  
3769  
4983  
2651  
4984  
3770  
4985  
2650  
4986  
3771  
4987  
2649  
4988  
3772  
4989  
2648  
4990  
3773  
4991  
2647  
4992  
3774  
4993  
2646  
4994  
3775  
4995  
2645  
4996  
3776  
4997  
2644  
4998  
3777  
4999  
2643  
5000

LYCOMING  
3088  
3801  
3143  
3142  
4738  
4739  
4740  
4741  
4742  
4743  
4744  
4745  
4746  
4747  
4748  
4749  
4750  
4751  
4752  
4753  
4754  
4755  
4756  
4757  
4758  
4759  
4760  
4761  
4762  
4763  
4764  
4765  
4766  
4767  
4768  
4769  
4770  
4771  
4772  
4773  
4774  
4775  
4776  
4777  
4778  
4779  
4780  
4781  
4782  
4783  
4784  
4785  
4786  
4787  
4788  
4789  
4790  
4791  
4792  
4793  
4794  
4795  
4796  
4797  
4798  
4799  
4800

SUNSET CROSSING RD  
4550  
4551  
4739  
4917  
4552  
4740  
4918  
4553  
4741  
4919  
4554  
4742  
4920  
4555  
4743  
4921  
4556  
4744  
4922  
4557  
4745  
4923  
4558  
4746  
4924  
4559  
4747  
4925  
4560  
4748  
4926  
4561  
4749  
4927  
4562  
4750  
4928  
4563  
4751  
4929  
4564  
4752  
4930  
4565  
4753  
4931  
4566  
4754  
4932  
4567  
4755  
4933  
4568  
4756  
4934  
4569  
4757  
4935  
4570  
4758  
4936  
4571  
4759  
4937  
4572  
4760  
4938  
4573  
4761  
4939  
4574  
4762  
4940  
4575  
4763  
4941  
4576  
4764  
4942  
4577  
4765  
4943  
4578  
4766  
4944  
4579  
4767  
4945  
4580  
4768  
4946  
4581  
4769  
4947  
4582  
4770  
4948  
4583  
4771  
4949  
4584  
4772  
4950  
4585  
4773  
4951  
4586  
4774  
4952  
4587  
4775  
4953  
4588  
4776  
4954  
4589  
4777  
4955  
4590  
4778  
4956  
4591  
4779  
4957  
4592  
4780  
4958  
4593  
4781  
4959  
4594  
4782  
4960  
4595  
4783  
4961  
4596  
4784  
4962  
4597  
4785  
4963  
4598  
4786  
4964  
4599  
4787  
4965  
4600  
4788  
4966  
4601  
4789  
4967  
4602  
4790  
4968  
4603  
4791  
4969  
4604  
4792  
4970  
4605  
4793  
4971  
4606  
4794  
4972  
4607  
4795  
4973  
4608  
4796  
4974  
4609  
4797  
4975  
4610  
4798  
4976  
4611  
4799  
4977  
4612  
4800  
4700  
4978  
4613  
4801  
4701  
4979  
4614  
4802  
4702  
4980  
4615  
4803  
4703  
4981  
4616  
4804  
4704  
4982  
4617  
4805  
4705  
4983  
4618  
4806  
4706  
4984  
4619  
4807  
4707  
4985  
4620  
4808  
4708  
4986  
4621  
4809  
4709  
4987  
4622  
4810  
4710  
4988  
4623  
4811  
4711  
4989  
4624  
4812  
4712  
4990  
4625  
4813  
4713  
4991  
4626  
4814  
4714  
4992  
4627  
4815  
4715  
4993  
4628  
4816  
4716  
4994  
4629  
4817  
4717  
4995  
4630  
4818  
4718  
4996  
4631  
4819  
4719  
4997  
4632  
4820  
4720  
4998  
4633  
4821  
4721  
4999  
4634  
4822  
4722  
5000

SPRINGS DR  
5085  
3901  
5086  
3902  
5087  
3903  
5088  
3904  
5089  
3905  
5090  
3906  
5091  
3907  
5092  
3908  
5093  
3909  
5094  
3910  
5095  
3911  
5096  
3912  
5097  
3913  
5098  
3914  
5099  
3915  
5100  
3916  
5101  
3917  
5102  
3918  
5103  
3919  
5104  
3920  
5105  
3921  
5106  
3922  
5107  
3923  
5108  
3924  
5109  
3925  
5110  
3926  
5111  
3927  
5112  
3928  
5113  
3929  
5114  
3930  
5115  
3931  
5116  
3932  
5117  
3933  
5118  
3934  
5119  
3935  
5120  
3936  
5121  
3937  
5122  
3938  
5123  
3939  
5124  
3940  
5125  
3941  
5126  
3942  
5127  
3943  
5128  
3944  
5129  
3945  
5130  
3946  
5131  
3947  
5132  
3948  
5133  
3949  
5134  
3950  
5135  
3951  
5136  
3952  
5137  
3953  
5138  
3954  
5139  
3955  
5140  
3956  
5141  
3957  
5142  
3958  
5143  
3959  
5144  
3960  
5145  
3961  
5146  
3962  
5147  
3963  
5148  
3964  
5149  
3965  
5150  
3966  
5151  
3967  
5152  
3968  
5153  
3969  
5154  
3970  
5155  
3971  
5156  
3972  
5157  
3973  
5158  
3974  
5159  
3975  
5160  
3976  
5161  
3977  
5162  
3978  
5163  
3979  
5164  
3980  
5165  
3981  
5166  
3982  
3983  
5167  
3984  
5168  
3985  
5169  
3986  
5170  
3987  
5171  
3988  
5172  
3989  
5173  
3990  
5174  
3991  
5175  
3992  
5176  
3993  
5177  
3994  
5178  
3995  
5179  
3996  
5180  
3997  
5181  
3998  
5182  
3999  
5183  
4000

BAR AVE  
5079  
3078  
5080  
3079  
5081  
3080  
5082  
3081  
5083  
3082  
5084  
3083  
5085  
3084  
5086  
3085  
5087  
3086  
5088  
3087  
5089  
3088  
5090  
3089  
5091  
3090  
5092  
3091  
5093  
3092  
5094  
3093  
5095  
3094  
5096  
3095  
5097  
3096  
5098  
3097  
5099  
3098  
5100  
3099  
5101  
3100  
5102  
3101  
5103  
3102  
5104  
3103  
5105  
3104  
5106  
3105  
5107  
3106  
5108  
3107  
5109  
3108  
5110  
3109  
5111  
3110  
5112  
3111  
5113  
3112  
5114  
3113  
5115  
3114  
5116  
3115  
5117  
3116  
5118  
3117  
5119  
3118  
5120  
3119  
5121  
3120  
5122  
3121  
5123  
3122  
5124  
3123  
5125  
3124  
5126  
3125  
5127  
3126  
5128  
3127  
5129  
3128  
5130  
3129  
5131  
3130  
5132  
3131  
5133  
3132  
5134  
3133  
5135  
3134  
5136  
3135  
5137  
3136  
5138  
3137  
5139  
3138  
5140  
3139  
5141  
3140  
5142  
3141  
5143  
3142  
5144  
3143  
5145  
3144  
5146  
3145  
5147  
3146  
5148  
3147  
5149  
3148  
5150  
3149  
5151  
3150  
5152  
3151  
5153  
3152  
5154  
3153  
5155  
3154  
5156  
3155  
5157  
3156  
5158  
3157  
5159  
3158  
5160  
3159  
5161  
3160  
5162  
3161  
5163  
3162  
5164  
3163  
5165  
3164  
5166  
3165  
5167  
3166  
5168  
3167  
5169  
3168  
5170  
3169  
5171  
3170  
5172  
3171  
5173  
3172  
5174  
3173  
5175  
3174  
5176  
3175  
5177  
3176  
5178  
3177  
5179  
3178  
5180  
3179  
5181  
3180  
5182  
3181  
5183  
3182  
5184  
3183  
5185  
3184  
5186  
3185  
5187  
3186  
5188  
3187  
5189  
3188  
5190  
3189  
5191  
3190  
5192  
3191  
5193  
3192  
5194  
3193  
5195  
3194  
5196  
3195  
5197  
3196  
5198  
3197  
5199  
3198  
5200  
3199  
5201  
3200

WALNUT DR  
4759  
4758  
4637  
2894  
4093  
1755  
4756  
4757  
4758  
4759  
4760  
4761  
4762  
4763  
4764  
4765  
4766  
4767  
4768  
4769  
4770  
4771  
4772  
4773  
4774  
4775  
4776  
4777  
4778  
4779  
4780  
4781  
4782  
4783  
4784  
4785  
4786  
4787  
4788  
4789  
4790  
4791  
4792  
4793  
4794  
4795  
4796  
4797  
4798  
4799  
4800

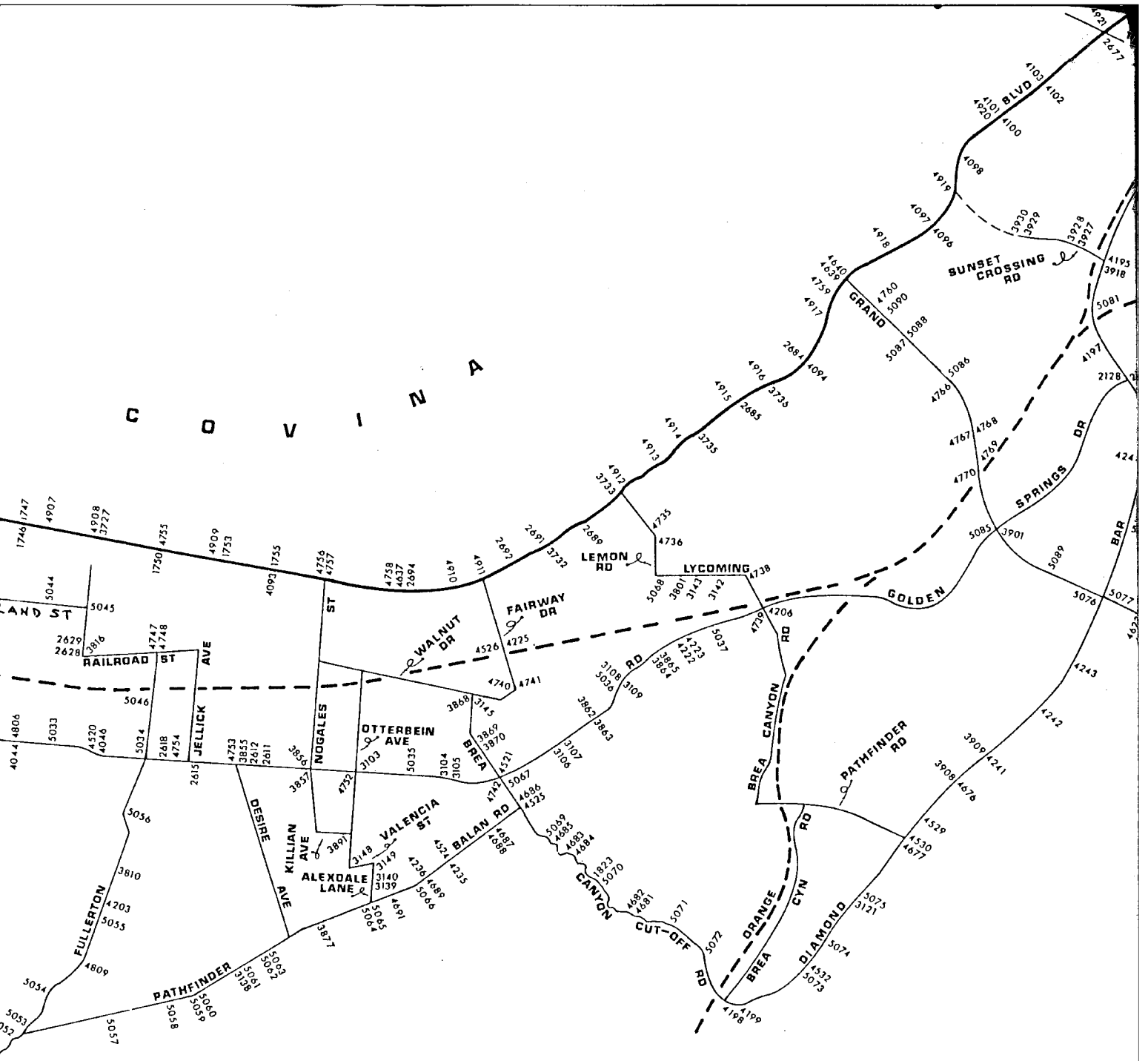

**OTTERBEIN**

**QUAD**

**LOS**

**ORANGE**

**COUNTY**



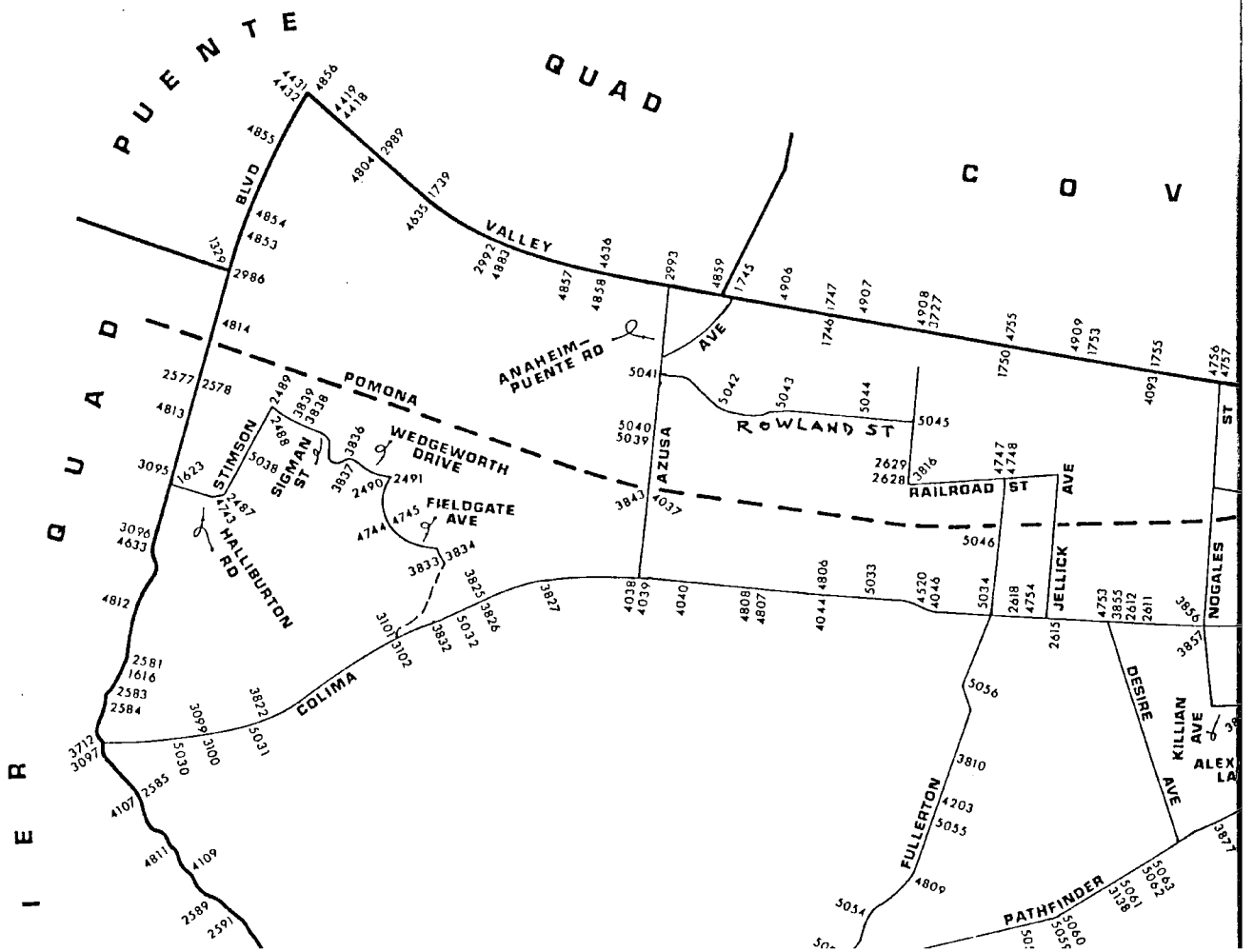

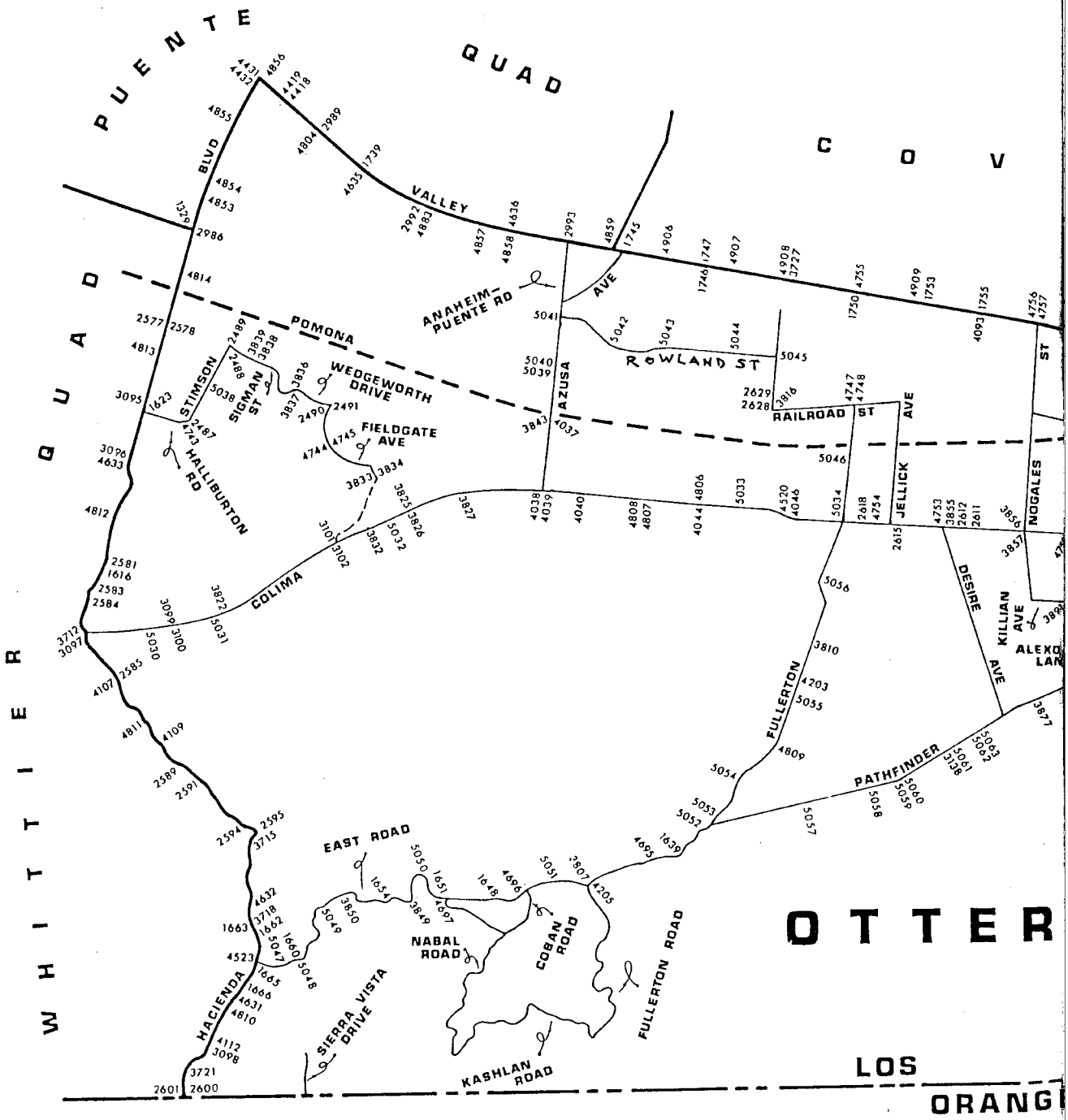

# OTTER

# LOS ORANGE

JAD-YEAR	ELEV METER/FOOT	DESCRIPTION (INCLUDE QUAD AND YEAR IN DESCRIPTION)	BM NUMBER
BASELINE (1995)	0101.945 0334.465	RDBM TAG IN N CB 2.9M E/O BCR @ NW COR HACIENDA BLVD & GALE AVE 21.3M W & 11M N/O C/L INT	G 1329
BASELINE (1995)	0240.063 0787.607	MWD BR MON IN HDWL 2.4M N/O N RAIL SPRR 23M S/O C/L MT VERNON AVE & 105M ELY/O C/L ROSELAWN ST MKD (62D 1933)	G 1469
BASELINE (1995)	0152.468 0500.222	CSBM MON IN S END C B 2.4M S/O BCR @ SE COR LOS ALTOS DR & HACIENDA BLVD (SERV RD) 24.4M E & 16.2M S/O C/L INT MKD (BM 38-9A 1963 RE 5869)	G 1616
BASELINE (1995)	0124.246 0407.630	RDBM TAG IN N CB 300MM E BCR @ NE COR HACIENDA BLVD & HALLIBURTON RD 22M E & 12.2M N/O C/L INT	G 1623A
OTTERBEIN (1995)	0201.557 0661.275	RD MON IN WELL 200MM DN ON PI OF CURVE TO SW 3.7M W C/L PVMT FULLERTON RD 9M N/O PP #875077E 6M SLY/O GUY P #1684228E (390.M SLY/O HARBOR BL)	G 1639
OTTERBEIN (1995)	0228.305 0749.031	RDBM TAG IN N WINGWALL CONC HDWL 5M S C/L EAST RD 9M W/O & OPP DRWY TO HSE #1301 FULLERTON RD	G 1648
OTTERBEIN (1995)	0220.184 0722.387	L&T IN CONC DRWY TO HSE #1141 EAST RD 23M N/O C/L & 4.6M W/O C/L VALLE DR	G 1651
OTTERBEIN (1995)	0216.545 0710.448	RDBM TAG IN CTR OF CONC HDWL 4.6M N/O C/L EAST RD & 73M S/O C/L DEEP CYN RD E/O PP #1124854E	G 1654
OTTERBEIN (1995)	0185.378 0608.194	L&T IN NWLY CB EAST RD 4.6M NLY/O C/L & 78M SLY/O DRWY TO HSE #365 14M N/O PP #212079E	G 1660
OTTERBEIN (1995)	0185.098 0607.276	CSBM MON IN WELL ON C/L ENCANADA DR 14.6M W/O C/L HACIENDA BLVD MKD (BM 38-4 1964 RE 63)	G 1662
BASELINE (1995)	0185.147 0607.436	CS MON FL @ SW COR HACIENDA BLVD & ENCANADA DR 7M W & 6.1M S/O C/L INT MKD (COR 11 RE 329)	G 1663
BASELINE (1995)	0169.830 0557.184	L&T W END CONC STEP TO OFFICE @ SE COR EAST RD & HACIENDA BL 15.2M E & 12.2M S C/L INT MKD BM	G 1665
BASELINE (1995)	0156.903 0514.773	L&T IN CONC HDWL 600MM S/O N END 6.4M E/O C/L HACIENDA BLVD OPP HSE #1705 & 6.4M N/O C/L DRWY FOR HSES #1703 & #1705	G 1666
BASELINE (1995)	0105.426 0345.885	RDBM TAG IN N CB OLD VALLEY BLVD 6.1M N/O C/L @ PP# 215724E & 41.5M E/O C/L DRWY TO BLDG #16253 (128M E/O C/L VALLEY BLVD OVERPASS)	G 1739
BASELINE (1995)	0116.358 0381.751	RD MON IN WELL 200MM DN @ C/L INT VALLEY BLVD & AZUSA WAY MKD (LA CO 1959)	G 1745

JAD-YEAR	ELEV METER/FOOT	D E S C R I P T I O N (INCLUDE QUAD AND YEAR IN DESCRIPTION)	BM NUMBER
BASELINE (1995)	0119.634 0392.499	RD MON IN WELL 200MM DN ON C/L INT VALLEY BLVD & HAMBLEDON AVE MKD (1959)	G 1746
BASELINE (1995)	0119.859 0393.237	L&T IN N CB 1.5M E/O BCR @ NE COR VALLEY BLVD & HAMBLEDON AVE 15M E & 12.8M N/O C/L INT	G 1747
BASELINE (1995)	0126.416 0414.750	L&BN IN CONC BASE 3M W/O CF 1.5M S/O BCR @ SW COR VALLET BLVD & FULLERTON RD 24.7M S & 12.8M W/O C/L INT	G 1750
BASELINE (1995)	0128.745 0422.391	L&BR IN E CB 3.7M N/O BCR @ NE COR VALLEY BLVD & LA SEDA RD 27.4M N & 5.5M E/O C/L INT	G 1753
BASELINE (1995)	0132.677 0435.291	RDBM TAG IN N CB VALLEY BLVD W END C B 12.8M N C/L & 21M E/O C/L ELY MOST DRWY TO BLDG #18711	G 1755
OTTERBEIN (1995)	0266.575 0874.588	SPK&L IN E CONC HDWL 39M W/O C/L BREA CYN CUT-OFF RD & 29M N/O C/L CUT-OFF CT	G 1823
BASELINE (1995)	0235.724 0773.371	RD BR CAP IN HDWL 24M NLY C/L POMONA BLVD 2.4M S/O S RAIL SPRR 4M ELY/O C/L RIDGEWAY ST PROD 27.4M S/O C/L VERNON AVE	G 1962
BASELINE (1995)	0244.025 0800.605	CS MON IN WELL 300MM DN ON C/L 2ND ST IN MEDIAN 750MM W/O END & 95M E C/L HWY 71 MKD (BM 11-85)	G 2076
OTTERBEIN (1995)	0234.893 0770.645	RDBM TAG IN W CB DIAMOND BAR BLVD 600MM S/O BCR 12.2M W/O C/L & 21M S/O C/L GOLDEN SPRINGS DR	G 2127
OTTERBEIN (1995)	0233.224 0765.169	RDBM TAG IN W CB DIAMOND BAR BL 600MM N/O BCR 12.2M W/O C/L & 21M N/O C/L GOLDEN SPRINGS DR	G 2128
OTTERBEIN (1995)	0128.986 0423.182	CS TAG IN W CB 300MM N/O BCR @ NW COR STIMSON AVE & HALLIBURTON RD 26.5M N & 9.1M W/O C/L INT	G 2487
OTTERBEIN (1995)	0113.811 0373.395	RAM SET S CB 1M E/O BCR @ SE COR STIMSON AVE & SIGMAN ST 5.5M S & 21M E/O C/L INT	G 2488
OTTERBEIN (1995)	0113.644 0372.847	RAM SET IN N CB 1.2M E/O BCR @ NE COR STIMSON AVE & SIGMAN ST 5.5M N & 21M E/O C/L INT	G 2489
OTTERBEIN (1995)	0131.462 0431.305	RE TAG #10103 300MM N/O BCR @ SW COR WEDGEWORTH DR & FIELDGATE AVE 14M S & 5.5M W/O C/L INT	G 2490
OTTERBEIN (1995)	0130.691 0428.775	RE TAG #10103 E/O CB @ BCR & NE COR WEDGEWORTH DR & FIELDGATE AVE 14M N & 6.1M E/O C/L INT	G 2491
BASELINE (1995)	0110.734 0363.300	L&T IN W CB HACIENDA BLVD 12.8M W/O C/L @ C/L PROD SIGMAN ST	G 2577

JAD-YEAR	ELEV METER/FOOT	D E S C R I P T I O N (INCLUDE QUAD AND YEAR IN DESCRIPTION)	BM NUMBER
BASELINE (1995)	0110.888 0363.805	RDBM TAG IN S CB 5.2M E/O BCR @ SE COR HACIENDA BLVD & SIGMAN ST 30M E & 5.5M S/O C/L INT	G 2578
BASELINE (1995)	0152.261 0499.543	L&T IN N CB 900MM E/O BCR @ NE COR HACIENDA BL & LOS ALTOS DR 24.4M E & 5.2M N/O C/L INT	G 2581
BASELINE (1995)	0159.150 0522.145	L&BN IN E CB 600MM N/O BCR @ NE COR HACIENDA BLVD & DEL PRADO DR 13.7M E & 9.1M N/O C/L INT	G 2583
BASELINE (1995)	0159.782 0524.218	L&BN IN E CB 600MM S/O BCR @ SE COR HACIENDA BLVD & DEL PRADO DR 13.7M E & 10.7M S/O C/L INT	G 2584
BASELINE (1995)	0184.462 0605.189	RD BM TAG IN NLY CB RICHVIEW DR 6M N/O C/L 9.8M ELY/O BCR & 22M ELY/O C/L HACIENDA BLVD	G 2585
BASELINE (1995)	0258.132 0846.888	L&T IN CONC WALL OF DRAIN 4.6M W/O C/L HACIENDA BLVD & 322M N/O C/L SKYLINE DR	G 2589
OTTERBEIN (1995)	0274.181 0899.542	CS BM MON IN WELL @ HACIENDA BLVD & SKYLINE DR 7.6M W & 4.3M N C/L INT MKD (BM 38-6 1954 RE 63)	G 2591
BASELINE (1995)	0240.258 0788.246	CS MON FL IN CONC BASE 136M NLY/O C/L CANADA SOMBRE RD & 9.1M W/O C/L HACIENDA BLVD 3M WLY OF EDGE PVMT (4M NLY/O PP WITH GUY POLE NO#)	G 2594
BASELINE (1995)	0228.484 0749.618	CS MON IN WELL 7.6M E/O C/L HACIENDA BL & 1.4M N/O C/L CANADA SOMBRA RD MKD (BM 38-5 1954)	G 2595
BASELINE (1995)	0131.579 0431.689	L&T IN S CB 300MM E/O BCR @ SE COR HACIENDA BLVD & JANINE DR 23M E & 4.6M S/O C/L INT	G 2600
BASELINE (1995)	0130.195 0427.148	CS MON IN WELL 450MM DN ON C/L HACIENDA BLVD 7.3M W/O ELY CF 26.5M S/O BCR @ SE COR & 41.8M S/O C/L JANINE DR MKD (LA CO + OR CO RE 2177)	G 2601
OTTERBEIN (1995)	0146.133 0479.438	RDBM TAG IN E CB 1M S/O BCR @ SE COR COLIMA RD & PASO REAL AVE 24.4M S & 5.5M E/O C/L INT	G 2611
OTTERBEIN (1995)	0146.127 0479.418	RDBM TAG IN W CB 1M S/O BCR @ SW COR COLIMA RD & PASO REAL AVE 24.4M S & 5.5M W/O C/L INT	G 2612
OTTERBEIN (1995)	0141.826 0465.307	CITY OF INDUSTRY BR DISC IN S CB 300MM W/O BCR @ SE COR COLIMA RD & JELICK AVE 16M E & 12.8M S/O C/L INT MKD (BENCH MARK 5-9)	G 2615
OTTERBEIN (1995)	0142.111 0466.243	CSBM MON IN WALK 3M E/O BCR 2.7M N/O CF @ NW COR COLIMA RD & BATSON AVE 17M N & 12.5M W/O C/L INT MKD (BM 44-11A 1963 RE 5869)	G 2618

JAD-YEAR	ELEV METER/FOOT	D E S C R I P T I O N (INCLUDE QUAD AND YEAR IN DESCRIPTION)	BM NUMBER
OTTERBEIN (1995)	0129.026 0423.313	RDBM TAG IN W CB 300MM N/O BCR @ NW COR LAWSON ST & RAILROAD ST 14M N & 5.5M W/O C/L INT	G 2628
OTTERBEIN (1995)	0128.309 0420.960	CITY OF INDUSTRY BR MON IN W CB LAWSON ST 5.5M W C/L & 144M N/O C/L RAILROAD ST MKD (BM 5-13)	G 2629
BASELINE (1995)	0214.982 0705.320	RD MON IN WELL 325MM DN @ C/L INT POMONA BLVD & TEMPLE AVE MKD (LA CO RD DEPT 1962)	G 2677
BASELINE (1995)	0176.523 0579.143	RDBM TAG IN CONC FTG OF 125MM IP GUARD POST FOR 600MM WATER LINE 49M E/O C/L BREA CYN RD & 36M S/O C/L VALLEY BLVD	G 2684
BASELINE (1995)	0167.778 0550.452	FC BR DISC IN HDWL 2M S/O SLY SPRR TRACK 27M S/O C/L VALLEY BLVD & 156M E/O C/L PROD PIERRA RD MKD (BM 102-18 1956) 20.4M S/O S EDGE AC	G 2685
BASELINE (1995)	0157.813 0517.758	FC BR DISC IN E END HDWL 21.3M S/O C/L VALLEY BLVD & 61.3M W/O C/L PROD LEMON CREEK DR MKD (BM 102-14 1956)	G 2689
BASELINE (1995)	0156.182 0512.407	RDBM TAG IN NLY CB VALLEY BLVD 300MM E/O BCR 12.5M C/L & 23M ELY/O C/L CASTLEHILL RD	G 2691
BASELINE (1995)	0149.780 0491.403	CSBM MON IN W END C B 12.5M SLY C/L VALLEY BLVD & 82M ELY/O C/L FAIRWAY DR MKD (BM 11-100A 1962)	G 2692
BASELINE (1995)	0147.699 0484.576	RDBM TAG IN NW COR OF 900MMX900MM CONC PAD FOR VENT PIPE 17.7M SLY C/L VALLEY BLVD & 213M E/O C/L SENTOUS AVE	G 2694
BASELINE (1995)	0258.557 0848.282	L&BN IN E CB 300MM N/O BCR @ NE COR WHITE AVE & 2ND ST 18.6M N & 12.8M E/O C/L INT	G 2787
BASELINE (1995)	0274.508 0900.615	CS BR MON FL 300MM S CF & 2.4M W/O BCR @ SW COR 1ST ST & EAST END AVE 25.6M W & 6.4M S/O C/L INT MKD (BM 11-78A 1962 RE 5869)	G 2874
BASELINE (1995)	0270.341 0886.944	CS BR MON IN E CB N END C B @ NE COR RESERVOIR ST & 1ST ST 46M N & 9.1M E/O C/L INT MKD (BM 11-78A 1962 RE 5869)	G 2876
BASELINE (1995)	0267.487 0877.580	CS BM MON FL @ SW ABUT OF BRIDGE OVER TOWNE AVE 15.5M W/O C/L & 8.2M S/O C/L 1ST ST MKD (BM 11-79A 1962 RE 5869)	G 2878
BASELINE (1995)	0251.764 0825.996	CS MON IN WELL 200MM DN SW COR 2ND ST & OAK AVE 15.2M W & 9.4M S/O C/L INT MKD (BM 11-84A 1962)	G 2955

JAD-YEAR	ELEV METER/FOOT	D E S C R I P T I O N (INCLUDE QUAD AND YEAR IN DESCRIPTION)	BM NUMBER
BASELINE (1995)	0259.943 0852.830	CSBM MON IN HDWL 2.1M S/O S CF @ W END OF BRIDGE OVER WHITE AVE 25.6M W/O C/L & 8.2M S/O C/L 1ST ST MKD (BM 11-83A 1962 RE 5869)	G 2956
BASELINE (1995)	0102.176 0335.222	CS MON IN C B 400MM S/O S CF 7.3M E/O BCR @ SE COR HACIENDA BLVD & GALE AVE 32M E & 12.8M S/O C/L INT MKD (BM 38-13A 1963 RE 5869)	G 2986
BASELINE (1995)	0097.704 0320.551	RDBM TAG IN N CB VALLEY BL 14M N C/L 17.4M E/O BCR & 42M E/O C/L HACIENDA BL (NR E END C B)	G 2988
BASELINE (1995)	0102.725 0337.024	RDBM TAG IN W CB 300MM N/O BCR @ NW COR ALBERT ST & OLD VALLEY BLVD 14M N & 5.5M W/O C/L INT (NR S END C B)	G 2989
BASELINE (1995)	0108.587 0356.256	RDBM TAG IN N CB VALLEY BLVD NR W END C B 17.4M N/O C/L & 16.5M W/O APPROX C/L INT WITH OLD VALLEY BLVD (322M W/O C/L FERRERO LN)	G 2992
BASELINE (1995)	0115.419 0378.671	RDBM TAG IN N CB VALLEY BLVD @ E END OF 2 C B 12.8M N/O C/L & 157M W/O C/L LAURA AVE	G 2993
BASELINE (1995)	0123.413 0404.897	CSBM MON IN WELL 300MM E/O ELY CF 4M N/O BCR @ NE COR HACIENDA BLVD & HALLIBURTON RD 27.4M N & 13M E/O C/L INT MKD (BM 38-11A 1963 RE 5869)	G 3095
BASELINE (1995)	0133.651 0438.487	CSBM MON IN WELL 300MM W/O WLY CF @ BCR NW COR HACIENDA BLVD & TETLY ST 22.3M N & 12.8M W/O C/L INT MKD (BM 38-10A 1963 RE 5869)	G 3096
BASELINE (1995)	0169.540 0556.232	CSBM MON 300MM S/O SLY CF COLIMA RD 2M E/O BCR 12.8M S/O C/L & 18.3M E/O C/L HACIENDA BLVD MKD MKD (38-8A 1963 RE 5869) @ E END C B	G 3097
BASELINE (1995)	0150.398 0493.431	RDBM TAG IN S CB 300MM E BCR @ SE COR HACIENDA BLVD & AVOCADO CREST 14.3M E & 5M S/O C/L INT	G 3098
OTTERBEIN (1995)	0197.504 0647.978	RDBM TAG IN N CB COLIMA RD 12.8M N/O C/L & 147M E/O ALLENTON ST (NR CREST OF HILL)	G 3099
OTTERBEIN (1995)	0198.456 0651.101	RDBM TAG IN S CB COLIMA RD 12.8M S/O C/L & 163M E/O ALLENTON ST (NR CREST OF HILL)	G 3100
OTTERBEIN (1995)	0191.802 0629.270	RDBM TAG IN W CB 900MM N/O BCR @ NW COR COLIMA RD & PUNTA DEL ESTE DR 23M N & 6.1M W/O C/L INT	G 3101
OTTERBEIN (1995)	0191.861 0629.464	L&T IN N CB RET 3.7M W/O BCR @ NE COR COLIMA RD & PUNTA DEL ESTE DR 12.8M N & 11.6M E/O C/L INT	G 3102

JAD-YEAR	ELEV METER/FOOT	DESCRIPTION (INCLUDE QUAD AND YEAR IN DESCRIPTION)	BM NUMBER
OTTERBEIN (1995)	0156.053 0511.984	RDBM TAG IN N CB 2M W/O BCR @ NE COR COLIMA RD & OTTERBEIN AVE 12.8M N & 15M E/O C/L INT	G 3103
OTTERBEIN (1995)	0161.856 0531.023	RDBM TAG IN W CB 1M N/O BCR @ NW COR COLIMA RD & YBARRA DR 24.4M N & 5.5M W/O C/L INT	G 3104
OTTERBEIN (1995)	0162.024 0531.574	RDBM TAG IN E CB 300MM S/O BCR @ NE COR COLIMA RD & YBARRA DR 24.4M N & 5.5M E/O C/L INT	G 3105
OTTERBEIN (1995)	0181.102 0594.165	RDBM TAG IN W CB 300MM S/O BCR @ SW COR COLIMA RD & LAKE CYN RD 23.5M S & 9.1M W/O C/L INT	G 3106
OTTERBEIN (1995)	0181.061 0594.031	L&N IN S CB NR BCR @ SE COR COLIMA RD & LAKE CYN RD 30M E & 12.2M S/O C/L INT	G 3107
OTTERBEIN (1995)	0178.453 0585.475	RDBM TAG W CB 300MM N/O BCR @ NW COR CALBOURNE DR & GOLDEN SPRINGS RD 24M N & 5.5M W/O C/L INT	G 3108
OTTERBEIN (1995)	0178.399 0585.297	RDBM TAG E CB 300MM N/O BCR @ NE COR CALBOURNE DR & GOLDEN SPRINGS RD 24M N & 5.5M E/O C/L INT	G 3109
OTTERBEIN (1995)	0224.213 0735.605	L&T IN N CB FOUNTAIN SPRINGS RD 300MM W/O BCR 6.1M N/O C/L & 23M W/O C/L DIAMOND BAR BLVD	G 3121
OTTERBEIN (1995)	0188.502 0618.444	CE TAG IN E CB 5M S/O BCR @ SELY COR PATHFINDER RD & BLANDFORD DR 25M SLY & 6.1M ELY C/L INT	G 3138
OTTERBEIN (1995)	0187.826 0616.226	L&BN IN E CB ALEXDALE LANE OPP HSE #2277 5.5M W/O C/L & 54M N/O C/L PATHFINDER RD	G 3139
OTTERBEIN (1995)	0183.689 0602.653	RDBM TAG IN W CB ALEXDALE LN 27M S/O BCR 5.5M W/O C/L & 42M S/O C/L AGUIRO ST	G 3140
OTTERBEIN (1995)	0168.965 0554.346	RCE TAG #8244 IN S CB 300MM E/O BCR @ SE COR LYCOMING ST & PENARTH AVE 14M E & 6.1M S C/L INT	G 3142
OTTERBEIN (1995)	0168.612 0553.188	RCE TAG #8244 IN W CB 300MM S/O BCR @ SW COR LYCOMING ST & PENARTH AVE 15M S & 5.5M W C/L INT	G 3143
OTTERBEIN (1995)	0152.645 0500.803	RDBM TAG IN S CB NR BCR @ SE COR BREA CYN CUT OFF RD & WALNUT DR S 6.1M S & 18M E/O C/L INT	G 3145
OTTERBEIN (1995)	0167.182 0548.496	LS TAG #2760 IN W CB OTTERBEIN AVE 5.5M W/O C/L & 9M S/O C/L PROD VALENCIA AVE	G 3148
OTTERBEIN (1995)	0168.606 0553.168	CE TAG IN N CB VALENCIA AVE 6.1M N/O C/L ON C/L PROD ALEXDALE LN	G 3149
BASELINE (1995)	0239.517 0785.815	RDBM TAG IN SLY CB POMONA BLVD 6.4M E/O END CB 5M S/O C/L & 165M ELY/O C/L ROSELAWN ST	G 3668



JAD-YEAR	ELEV METER/FOOT	D E S C R I P T I O N (INCLUDE QUAD AND YEAR IN DESCRIPTION)	BM NUMBER
BASELINE (1995)	0169.541 0556.236	RDBM TAG IN N CB 11M E/O BCR @ NE COR HACIENDA BLVD & COLIMA RD 34.7M E & 12.2M N/O C/L INT	G 3712
BASELINE (1995)	0218.483 0716.806	L&BN IN CONC FTG 300MM N/O S END BRICK WALL @ NW COR PVT RD @ #2231 HACIENDA BLVD 10.7M W & 8M N/O C/L INT (142M S/O C/L CANADA SOMBRE RD)	G 3715
BASELINE (1995)	0185.151 0607.450	CS MON IN WELL 300MM DN @ C/L INT HACIENDA BLVD & ENCANADA DR MKD (RE 2177)	G 3718
BASELINE (1995)	0136.727 0448.578	RAMSET IN CB @ BCR 25.3M ELY & 15.2M NLY/O C/L INT ESEVERRI LN & HACIENDA BLVD (SERV RD)	G 3721
BASELINE (1995)	0121.961 0400.134	RDBM TAG IN N CB 1.5M W/O BCR @ NW COR VALLEY BLVD & GIANO AVE 14.6M W & 12.2M N/O C/L INT	G 3727
BASELINE (1995)	0155.527 0510.258	CITY INDUSTRY MON IN NLY CB VALLEY BLVD 600MM W/O BCR 12.8M N/O C/L & 22M WLY/O C/L CASTLEHILL DR MKD (V 40)	G 3732
BASELINE (1995)	0158.992 0521.626	RDBM TAG IN WLY CB LEMON AVE 1.5M S/O BCR 12.8M W/O C/L & 23.8M N/O C/L VALLEY BLVD	G 3733
BASELINE (1995)	0166.201 0545.278	RDBM TAG NR CTR OF NWLY CB RET 19.8M NLY C/L VALLEY BLVD & 13.4M WLY/O C/L PIERRE RD	G 3735
BASELINE (1995)	0172.726 0566.685	RDBM TAG IN NWLY COR CONC BASE RR SIGNAL 27M S C/L VALLEY BLVD & 7.6M E/O C/L PROD MORNINGSIDE DR (2.1M S/O S RAIL SPRR TRACKS)	G 3736
BASELINE (1995)	0217.027 0712.029	RDBM TAG IN WLY CB POMONA BLVD 9./M W/O C/L & 24M N/O C/L ENTERPRISE PL (@ S END DRWY)	G 3743
BASELINE (1995)	0230.297 0755.566	RDBM TAG IN SLY CB POMONA BLVD 9.8M S/O C/L & 53.3M WLY/O C/L PIONEER BLVD @ BLDG #2660	G 3747
BASELINE (1995)	0235.639 0773.092	RDBM TAG IN NW COR CONC GAS VAULT 18M N/O N RAIL SPRR TRACK 35M N/O N CB VALLEY BLVD 9M W/O C/L RIDGEWAY ST @ APPROX E C OF CURVE TO THE E	G 3749
BASELINE (1995)	0248.851 0816.439	RDBM TAG IN N CB 2ND ST 7M N/O C/L 2.1M W/O BOX CULV & 34M W/O SPRR TRACKS 402M W/O C/L OAK AVE	G 3752
BASELINE (1995)	0248.858 0816.462	RDBM TAG IN S CB 2ND ST 7M S/O C/L 1.8M W/O BOX CULV & 34M W/O RR TRACKS 402M W/O C/L OAK AVE	G 3753
BASELINE (1995)	0252.156 0827.282	RDBM TAG IN S CB 300MM E/O BCR @ SE COR OAK AVE & 2ND ST 16.8M E & 8.5M S/O C/L INT	G 3754

JAD-YEAR	ELEV METER/FOOT	D E S C R I P T I O N (INCLUDE QUAD AND YEAR IN DESCRIPTION)	BM NUMBER
BASELINE (1995)	0255.667 0838.801	RDBM TAG IN S CB 2.4M W/O BCR @ SW COR OAK AVE & HAMILTON BLVD 15.2M W & 7M S/O C/L INT	G 3755
BASELINE (1995)	0255.999 0839.890	RDBM TAG IN E CB 4.9M N/O BCR @ NE COR 2ND ST & HAMILTON BLVD 13.7M N & 10.7M E/O C/L INT	G 3756
BASELINE (1995)	0258.482 0848.036	RDBM TAG IN W CB 600MM S/O BCR @ SW COR 2ND ST & WHITE AVE 19.8M S & 9.8M W/O C/L INT	G 3757
BASELINE (1995)	0260.135 0853.460	RDBM TAG IN S CB @ SE COR OF BRIDGE OVER WHITE AVE 23.5M E/O C/L & 6.1M S/O C/L FIRST ST	G 3758
BASELINE (1995)	0267.345 0877.114	L&PK IN SE ABUT OF BRIDGE OVER TOWNE AVE 24.1M E/O C/L & 8.2M S/O C/L FIRST ST	G 3763
BASELINE (1995)	0268.150 0879.755	RDBM TAG IN N CB 1.8M W/O END 22M W & 6.1M N/O C/L INT FIRST ST & SAN ANTONIO AVE	G 3764
BASELINE (1995)	0269.918 0885.556	RDBM TAG IN N CB 750MM W/O END @ NW COR FIRST ST & RESERVOIR ST 28M W & 6.1M N/O C/L INT	G 3765
BASELINE (1995)	0269.700 0884.841	RDBM TAG IN S CB 600MM E/O BCR @ SE COR 1ST ST & RESERVOIR ST 18M E & 6.1M S/O C/L INT	G 3766
BASELINE (1995)	0271.500 0890.746	RDBM TAG IN S CB 1ST ST 6.1M S/O C/L @ E P/L WATER RESERVOIR 87M E/O C/L ELECTRA ST	G 3767
OTTERBEIN (1995)	0164.589 0539.989	RDBM TAG IN S CB 1.5M E/O BCR @ SE COR LYCOMING ST & GLENWICK AVE 15M E & 6.1M S/O C/L INT	G 3801
OTTERBEIN (1995)	0267.140 0876.442	RDBM MON IN WELL 200MM DN 26M N/O C/L EAST RD & 9M W/O C/L SKYLINE DR MKD (1969) 50MM IP 1M UP & 300MM W/O MON	G 3807
OTTERBEIN (1995)	0158.027 0518.460	CE TAG #10915 IN W CB 300MM N/O BCR 17M N & 9.8M W/O C/L INT FULLERTON RD & GALATINA ST	G 3810
OTTERBEIN (1995)	0144.856 0475.248	L&T IN N CB 1M W/O BCR @ NE COR COLIMA RD & FULLERTON RD 18M E & 12.8M N/O C/L INT MKD (BM)	G 3813
OTTERBEIN (1995)	0129.103 0423.565	RDBM TAG IN N CB 3M E/O BCR @ NE COR LAWSON ST & RAILROAD ST 24M E & 6.1M N/O C/L INT	G 3816
OTTERBEIN (1995)	0184.044 0603.818	RDBM TAG IN NE COR C B @ NW COR COLIMA RD & STIMSON AVE 21M W & 14M N/O C/L INT	G 3822
OTTERBEIN (1995)	0178.101 0584.320	RDBM TAG IN N CB COLIMA RD 12.8M N/O C/L & 122M W/O COUNTRY CYN RD 402M E/O PUNTA DEL ESTE DR	G 3824

JAD-YEAR	ELEV METER/FOOT	D E S C R I P T I O N (INCLUDE QUAD AND YEAR IN DESCRIPTION)	BM NUMBER
OTTERBEIN (1995)	0149.947 0491.951	RDBM TAG IN S CB 5.5M E/O BCR @ SE COR COLIMA RD & COUNTRYWOOD RD 20M E & 12.8M S/O C/L INT	G 3825
OTTERBEIN (1995)	0150.377 0493.362	RDBM TAG IN N CB 2.4M E/O BCR @ NE COR COLIMA RD & COUNTRYWOOD RD 23M E & 12.8M N/O C/L INT	G 3826
OTTERBEIN (1995)	0142.543 0467.660	RDBM TAG IN W CB 1.2M N/O BCR @ NW COR COLIMA RD & PARKLAWN RD 23M N & 6.1M W/O C/L INT	G 3827
OTTERBEIN (1995)	0179.740 0589.697	RDBM TAG IN E END C B 12.8M S/O C/L COLIMA RD & 145M W/O C/L COUNTRY CYN RD 402M E/O PUNTA DEL ESTE DR	G 3832
OTTERBEIN (1995)	0162.293 0532.456	RDBM TAG IN C B @ BCR 5.5M E/O C/L PASO VERDE DR & 15.5M S/O C/L CLEMINTINA DR	G 3833
OTTERBEIN (1995)	0161.126 0528.628	RDBM TAG IN N CB 1M E/O BCR @ NE COR PASO VERDE DR & CLEMINTINA DR 15M E & 5.5M N/O C/L INT	G 3834
OTTERBEIN (1995)	0124.698 0409.113	RE TAG #5406 IN CTR OF CONC WK @ MC 9.1M E/O C/L GLENELDER AVE & 9.4M N/O C/L WEDGEWORTH DR	G 3836
OTTERBEIN (1995)	0124.398 0408.129	RE TAG #5406 IN CTR CONC WALK @ MC HSE #16242 9.1M SLY & 9.1M WLY/O C/L INT WEDGEWORTH DR & FLAMSTEAD DR	G 3837
OTTERBEIN (1995)	0117.114 0384.232	RDBM TAG IN E CB 1.2M N/O BCR @ SE COR SIGMAN ST & EASTLEIGH AVE 12.2M S & 4.6M E/O C/L INT	G 3838
OTTERBEIN (1995)	0116.655 0382.726	RDBM TAG IN N CB SIGMAN ST E END C B 5.5M N/O C/L & 20M W/O C/L EASTLEIGH AVE	G 3839
OTTERBEIN (1995)	0133.789 0438.939	RDBM TAG W CB 7M S/O BCR 27M S & 15.8M W/O C/L INT AZUSA AVE & POMONA FRWY (E BOUND OFF-RAMP)	G 3843
OTTERBEIN (1995)	0220.703 0724.090	RDBM TAG IN W EDGE CONC DRWY TO FIRE STA 7.3M N/O C/L DEEP CYN RD & 44M W/O C/L EAST RD	G 3849
OTTERBEIN (1995)	0223.218 0732.341	RDBM TAG IN S CB OF EXIT DRWY TO HACIENDA GOLF CLUB 483M E/O WLY INT CHURCHILL RD 6M S/O C/L EAST RD (600MM S/O CB END @ ROCK PILLAR)	G 3850
OTTERBEIN (1995)	0143.838 0471.909	RCE TAG #10915 IN N CB 300MM E/O BCR @ NE COR COLIMA RD & DESIRE AVE 18M E & 12.8M N/O C/L INT	G 3855
OTTERBEIN (1995)	0148.903 0488.526	RDBM TAG IN E CB 12M N/O BCR @ NE COR COLIMA RD & NOGALES ST 34M N & 12.8M E/O C/L INT	G 3856
OTTERBEIN (1995)	0149.471 0490.389	RDBM TAG IN S CB 600MM W/O BCR @ SE COR COLIMA RD & NOGALES ST 24M E & 14M S/O C/L INT	G 3857

QUAD-YEAR	ELEV METER/FOOT	D E S C R I P T I O N (INCLUDE QUAD AND YEAR IN DESCRIPTION)	BM NUMBER
OTTERBEIN (1995)	0182.761 0599.608	L&T IN CB RET 4.6M N/O BCR @ SW COR COLIMA RD & WALNUT LEAF DR 20M S 7 6.7M W/O C/L INT	G 3862
OTTERBEIN (1995)	0182.405 0598.440	RDBM TAG IN S CB 2M E/O BCR @ SE COR COLIMA RD & WALNUT LEAF DR 19M E & 12.8M S/O C/L INT	G 3863
OTTERBEIN (1995)	0173.453 0569.070	LS TAG #3054 W CB 300MM N/O BCR @ NW COR ARKLEY DR & GOLDEN SPRING RD 24.4M N & 5.5M W/O C/L INT	G 3864
OTTERBEIN (1995)	0174.064 0571.075	LS TAG #3054 N CB 300MM W/O BCR @ NE COR ARKLEY DR & GOLDEN SPRING RD 16.5M E & 12.8M N C/L INT	G 3865
OTTERBEIN (1995)	0152.686 0500.937	RDBM TAG IN W CB 1M S/O BCR @ SW COR WALNUT DR & BREA CYN CUT OFF RD 15M S & 6.1M W/O C/L INT	G 3868
OTTERBEIN (1995)	0158.851 0521.164	LS TAG #3054 IN W CB 6.1M W/O C/L BREA CYN CUT OFF RD @ S P/L HSE #1337 39M N/O C/L SEARLS DR	G 3869
OTTERBEIN (1995)	0159.851 0524.444	L&BN IN CONC FTG OF 2M STEEL FENCE POST @ SW COR YBARRA SCHOOL YD 9M E C/L BREA CYN CUT-OFF RD & 14M S/O C/L SEARLS DR	G 3870
OTTERBEIN (1995)	0180.887 0593.460	CE TAG W CB 2.7M N/O BCR @ NW COR PATHFINDER RD & PASO REAL AVE 35M N & 6.1M W/O C/L INT	G 3877
OTTERBEIN (1995)	0160.384 0526.193	CS MON IN WELL 300MM DN @ C/L INT KILLIAN AVE & OTTERBEIN AVE	G 3891
OTTERBEIN (1995)	0225.159 0738.709	RDBM TAG IN N CB GOLDEN SPRINGS DR 300MM E/O BCR 9.8M N/O C/L & 24M E/O C/L GRAND AVE	G 3901
OTTERBEIN (1995)	0248.692 0815.917	RCE TAG #8793 IN W CB DIAMOND BAR BLVD 600MM N BCR 15.2M W/O C/L & 16M S/O C/L KIOWA CREST DR	G 3908
OTTERBEIN (1995)	0252.641 0828.873	LS TAG #2602 IN N CB ACACIA HILL DR 300MM W/O BCR 5.5M N/O C/L & 23M W/O C/L DIAMOND BAR BLVD	G 3909
OTTERBEIN (1995)	0248.789 0816.235	RDBM TAG IN W CB DIAMOND BAR BLVD @ FIRE HYD 14.6M W/O C/L & 280M S/O C/L GOLDEN SPRINGS DR	G 3915
OTTERBEIN (1995)	0212.505 0697.193	RDBM TAG IN S CB SUNSET CROSSING RD 10M E/O BCR 7.6M S/O C/L & 30M E/O C/L DIAMOND BAR BLVD	G 3918
OTTERBEIN (1995)	0234.721 0770.080	LS TAG #2825 N CB HIGHLAND VALLEY RD 300MM E/O BCR 6M N/O C/L & 25M E/O C/L DIAMOND BAR BLVD	G 3921
OTTERBEIN (1995)	0207.310 0680.150	RDBM TAG N CB 600MM W BCR @ NE COR OLD TRAIL RD & SUNSET CROSSING RD 17M E & 9.8M N/O C/L INT	G 3927

JAD-YEAR	ELEV METER/FOOT	D E S C R I P T I O N (INCLUDE QUAD AND YEAR IN DESCRIPTION)	BM NUMBER
OTTERBEIN (1995)	0206.419 0677.226	RDBM TAG S CB 1.2M W BCR OF ALLEY 9.8M S & 8.5M W/O C/L INT SUNSET CROSSING RD & OLD TRAIL RD	G 3928
OTTERBEIN (1995)	0198.959 0652.751	LS TAG #2825 N CB @ NW COR SUNSET CROSSING RD & BIG FALLS DR & 9.8M N & 8M W/O C/L INT	G 3929
OTTERBEIN (1995)	0198.183 0650.205	LS TAG #2825 IN S CB SUNSET CROSSING RD 1M E/O BCR 9.8M S & 47M W/O C/L BIG FALLS DR (@ ALLEY)	G 3930
OTTERBEIN (1995)	0133.847 0439.130	L&T IN CTR OF SE CB RET 18M E & 14M S/O C/L INT AZUSA AVE & POMONA FRWY (E BOUND OFF-RAMP)	G 4037
OTTERBEIN (1995)	0139.651 0458.172	RDBM TAG IN W CB 1.8M S/O BCR @ NW COR COLIMA RD & AZUSA AVE 27M N & 12.8M W/O C/L INT	G 4038
OTTERBEIN (1995)	0139.812 0458.700	RDBM TAG IN E CB 1.2M N/O BCR @ NE COR COLIMA RD & AZUSA AVE 33M N & 18.3M E/O C/L INT	G 4039
OTTERBEIN (1995)	0142.271 0466.767	RDBM TAG IN N CB RET COLIMA RD 2M W/O BCR 13M N C/L & 17M E/O C/L DRWY TO ROBINSONS ENT 402M E/O AZUSA AVE	G 4040
OTTERBEIN (1995)	0137.511 0451.151	CITY OF INDUSTRY MON IN SE COR C B 23M W/O BCR @ SW COR COLIMA RD & WALNUT HALL RD 38M W & 14M S/O C/L INT MKD (BM CO-4)	G 4044
OTTERBEIN (1995)	0149.139 0489.300	RDBM TAG IN S CB 600MM E/O BCR @ SE COR COLIMA RD & LARKVANE RD 14M E & 12.8M S/O C/L INT	G 4046
BASELINE (1995)	0131.678 0432.014	CITY INDUSTRY BM MON IN S END CONC HDWL 21.3M S/O C/L VALLEY BL & 5.8M W/O & OPP C/L ELY MOST DRWY TO BLDG #18711 E END	G 4093
BASELINE (1995)	0176.732 0579.828	FC DISC IN NLY WALL OF CHANNEL 1.5M E/O NE COR BRIDGE 33.5M S/O C/L VALLEY BLVD & 19M E/O C/L BREA CYN RD MKD (BM 103-00005)	G 4094
BASELINE (1995)	0198.266 0650.478	L&T IN SLY CB VALLEY BLVD 12.8M S/O C/L & 16.2M E/O C/L DRWY ENT TO BLDG #22064 (W END BLDG)	G 4096
BASELINE (1995)	0198.440 0651.049	L&T IN S CB C/L MEDIAN 2.1M S/O C/L VALLEY BLVD & 15.5M E/O C/L DRWY TO BLDG #22064 (W END BLDG)	G 4097
BASELINE (1995)	0199.573 0654.766	RDBM TAG IN ELY CB VALLEY BLVD N END C B 12.8M E/O C/L & 19M NLY/O N DRWY TO BLDG #4200	G 4098
BASELINE (1995)	0206.663 0678.027	L&T IN ELY CB VALLEY BLVD 12.8M E/O C/L & 6M S/O C/L BRIDGE OVER SAN JOSE CREEK (ON S ABUT)	G 4100

JAD-YEAR	ELEV METER/FOOT	D E S C R I P T I O N (INCLUDE QUAD AND YEAR IN DESCRIPTION)	BM NUMBER
BASELINE (1995)	0206.476 0677.413	L&T IN WLY CB VALLEY BLVD 12.8M W/O C/L & 6.2M S/O C/L BRIDGE OVER SAN JOSE CREEK (ON N ABUT)	G 4101
BASELINE (1995)	0209.167 0686.242	L&T IN WLY CB VALLEY BLVD 900MM S/O S END C B 12.8M W/O C/L & 7.6M N/O C/L DRWY TO BLDG #3745	G 4102
BASELINE (1995)	0209.442 0687.144	L&T IN ELY CB VALLEY BLVD 12.8M E/O C/L & 600MM W/O C/L PROD POMONA BLVD 1.8M N/O BCR ISLE	G 4103
BASELINE (1995)	0222.841 0731.104	RDBM TAG IN ELY CB POMONA BLVD 600MM N/O BCR 9.8M E/O C/L & 10M N/O C/L DRWY TO BLDG #2882 55M N/O C/L (57 FRWY)	G 4106
BASELINE (1995)	0184.686 0605.924	CSBM MON IN NLY END C B 12.5M WLY C/L HACIENDA BLVD & 12.2M SLY/O C/L PROD RICHVIEW DR MKD (BM 38-7A 1975 RE 7078)	G 4107
BASELINE (1995)	0248.779 0816.202	L&BN IN NE COR HDWL 6.1M W/O C/L HACIENDA BLVD & 351M N/O SKYLINE DR	G 4109
BASELINE (1995)	0150.857 0494.937	RDBM TAG IN S CB 10M E/O BCR @ SE COR HACIENDA BLVD & AVACADO CREST RD 23.8M E & 5.5M S/O C/L INT (@ W END C B)	G 4112
OTTERBEIN (1995)	0212.007 0695.560	RDBM TAG IN E CB 1.2M S/O BCR @ NE COR DIAMOND BAR BLVD & SUNSET CROSSING RD 16.5M N & 13.4M E/O C/L INT	G 4195
OTTERBEIN (1995)	0222.028 0728.437	RDBM TAG IN W CB DIAMOND BAR BLVD 9M S/O BCR 15.5M W/O C/L & 23M S/O C/L PALOMINO DR IN C B	G 4197
OTTERBEIN (1995)	0207.791 0681.728	RDBM TAG IN W CB BREA CYN RD 300MM S/O BCR 9.8M W/O C/L & 21M N/O C/L DIAMOND BAR BLVD	G 4198
OTTERBEIN (1995)	0207.849 0681.918	RDBM TAG IN S CB DIAMOND BAR BLVD 300MM W/O BCR 12.8M S/O C/L & 32M W/O C/L BREA CYN RD	G 4199
OTTERBEIN (1995)	0163.178 0535.360	RDBM TAG IN W CB 300MM N/O BCR @ NW COR MESCAL ST & FULLERTON RD 13M N & 9.8M W/O C/L INT	G 4203
OTTERBEIN (1995)	0265.136 0869.867	RDBM TAG IN E CB 300MM N/O BCR @ NE COR EAST RD & SKYLINE DR 12M NLY & 4M ELY/O C/L INT	G 4205
OTTERBEIN (1995)	0177.905 0583.677	CSBM MON IN CONC BASE OF VENT PIPE 2M N/O BCR @ NW COR BREA CYN RD & GOLDEN SPRINGS RD 31M N & 14M W/O C/L INT MKD (BM 44-4A 1971)	G 4206
OTTERBEIN (1995)	0175.130 0574.572	CSBM MON E WALL C B 12.8M N C/L GOLDEN SPRINGS RD & 39M E/O C/L LEMON AVE MKD (BM 44-5A 1975)	G 4222

JAD-YEAR	ELEV METER/FOOT	D E S C R I P T I O N (INCLUDE QUAD AND YEAR IN DESCRIPTION)	BM NUMBER
OTTERBEIN (1995)	0174.352 0572.020	RDBM TAG N CB 600MM E/O BCR @ NW COR LEMON AVE & GOLDEN SPRINGS RD 15M W & 12.8M N/O C/L INT	G 4223
OTTERBEIN (1995)	0148.170 0486.121	RDBM TAG IN W END C B 14.6M E/O BCR @ SE COR WALNUT DR N & FAIRWAY DR 38M E & 7.3M S C/L INT	G 4225
OTTERBEIN (1995)	0184.655 0605.822	RDBM TAG IN N CB BALAN RD 1.5M W/O BCR 6M N/O C/L & 15M W/O C/L PEPPERDALE DR	G 4235
OTTERBEIN (1995)	0185.728 0609.343	RDBM TAG IN N CB BALAN RD 1.5M W/O BCR 6M N/O C/L & 15.5M N/O C/L ARCDALE AVE	G 4236
OTTERBEIN (1995)	0252.089 0827.062	LS TAG #2602 IN W CB DIAMOND BAR BLVD 300MM S/O BCR 15.2M W/O C/L & 15M S/O C/L ACACIA HILL RD	G 4241
OTTERBEIN (1995)	0258.539 0848.223	RDBM TAG IN S END C B 15.5M W/O C/L DIAMOND BAR BL & 130M S/O C/L MOUNTAIN LAUREL @ HSE #1729	G 4242
OTTERBEIN (1995)	0268.212 0879.959	RDBM TAG IN E CB DIAMOND BAR BL 600MM S/O BCR 15.2M E/O C/L & 14M S/O C/L QUAIL SUMMIT DR	G 4243
OTTERBEIN (1995)	0279.156 0915.864	RCE TAG #14010 IN S CB 3.4M W BCR @ SW COR TIN DR & DIAMOND BAR BLVD 23M W & 8M S/O C/L INT	G 4244
OTTERBEIN (1995)	0279.284 0916.284	RCE TAG #14010 IN N CB 3.4M W BCR @ NW COR TIN DR & DIAMOND BAR BLVD 23M W & 8M N/O C/L INT	G 4245
BASELINE (1995)	0101.320 0332.414	RCE TAG #5828 IN E CB GLENDORA AVE 12.8M E C/L 900MM N/O BCR & 13.4M N/O C/L MAIN ST	G 4418
BASELINE (1995)	0100.972 0331.272	RDBM TAG IN W CB 300MM N BCR @ NW COR STAFFORD ST & GLENDORA AVE 25M N & 9.8M W/O C/L INT	G 4419
BASELINE (1995)	0098.688 0323.779	RDBM TAG IN E CB HACIENDA BL 14M E/O C/L 300MM S/O BCR & 30.5M S/O C/L STAFFORD ST	G 4431
BASELINE (1995)	0098.803 0324.156	RDBM TAG IN S CB STAFFORD ST 14M S/O C/L 300MM W/O BCR & 21.6M W/O C/L HACIENDA BLVD	G 4432
OTTERBEIN (1995)	0148.903 0488.526	L&T IN W CB 300MM N/O BCR @ NW COR COLIMA RD & LARKVANE RD 22M N & 6.1M W/O C/L INT	G 4520
OTTERBEIN (1995)	0174.331 0571.951	RDBM TAG W END C B 21M E/O BCR @ SE COR BREA CYN CUT-OFF RD & COLIMA RD 62M E & 12.8M S/O C/L INT	G 4521
BASELINE (1995)	0169.136 0554.907	L&T IN S END C B @ BCR OF NE COR 17.7M E/O C/L HACIENDA BLVD & 5.5M N/O C/L EAST RD	G 4523
OTTERBEIN (1995)	0184.724 0606.049	RDBM TAG IN S CB BALAN RD 300MM W/O BCR 6M S/O C/L & 14M W/O C/L PEPPERDALE DR	G 4524

JAD-YEAR	ELEV METER/FOOT	D E S C R I P T I O N (INCLUDE QUAD AND YEAR IN DESCRIPTION)	BM NUMBER
OTTERBEIN (1995)	0196.264 0643.909	RDBM TAG IN SE COR C B 2.4M S/O BCR 19.5M ELY C/L BREA CUT-OFF RD & 18M SLY C/L ESQUILINE AVE	G 4525
OTTERBEIN (1995)	0148.302 0486.554	RDBM TAG IN W END C B 7.6M E/O BCR @ NE COR WALNUT DR N & FAIRWAY DR 32M E & 7.3M N C/L INT	G 4526
OTTERBEIN (1995)	0238.437 0782.272	RCE TAG #8793 IN W CB DIAMOND BAR BLVD 15.2M W/O C/L & 16.5M S/O C/L MORNING CYN DR	G 4529
OTTERBEIN (1995)	0235.672 0773.201	L&T IN E CB DIAMOND BAR BLVD 300MM N/O BCR 15.2M E/O C/L & 19.5M N/O C/L PATHFINDER RD	G 4530
OTTERBEIN (1995)	0225.875 0741.058	RD TAG IN WALK 13.4M E/O C/L DIAMOND BAR BLVD & 157M N/O C/L CROOKED CREEK DR	G 4532
OTTERBEIN (1995)	0262.391 0860.861	DPW BM TAG W CB 600MM S BCR SW COR VILLAGE LOOP RD & PHILLIPS RANCH RD 23M S & 10.7M W C/L INT	G 4608
OTTERBEIN (1995)	0295.126 0968.259	DPW BM TAG IN E CB 600MM N BCR @ NE COR SCENIC RIDGE DR & PHILLIPS RANCH RD 13M N & 12.2M E/O C/L INT	G 4611
OTTERBEIN (1995)	0278.539 0913.840	DPW BM TAG E CB 600MM S/O BCR @ SE COR VILLAGE LOOP RD & OLD WOOD RD 16.5M S & 8.5M E/O C/L INT	G 4613
OTTERBEIN (1995)	0278.818 0914.755	DPW BM TAG E CB 600MM N/O BCR @ NE COR VILLAGE LOOP RD & OLD WOOD RD 15M N & 8.5M E/O C/L INT	G 4614
OTTERBEIN (1995)	0285.366 0936.238	DPW BM TAG N CB 300MM E/O BCR @ NE COR VILLAGE LOOP RD & SANTA CLARA RD 20M E & 8.5M N C/L INT	G 4615
OTTERBEIN (1995)	0286.023 0938.394	DPW BM TAG N CB 300MM W/O BCR @ NW COR VILLAGE LOOP RD & SANTA CLARA DR 16M W & 8.5M N C/L INT	G 4616
OTTERBEIN (1995)	0321.472 1054.696	DPW BM TAG S CB 900MM W/O BCR @ SW COR SANTA CLARA DR & LOS FELIS DR 7.3M S & 17M W C/L INT	G 4617
OTTERBEIN (1995)	0321.672 1055.352	DPW BM TAG N CB 300MM W/O BCR @ NW COR SANTA CLARA DR & LOS FELIS DR 7.3M N & 16M W C/L INT	G 4618
OTTERBEIN (1995)	0293.749 0963.742	DPW BM TAG S CB 900MM E/O BCR @ SE COR TEMPLE AVE & GOLDEN SPRINGS DR 7.3M S & 21M E C/L INT	G 4619
OTTERBEIN (1995)	0292.376 0959.237	DPW BM TAG S CB 300MM W/O BCR @ SW COR TEMPLE AVE & GOLDEN SPRINGS DR 21M W & 11M S/O C/L INT	G 4620
OTTERBEIN (1995)	0274.029 0899.043	DPW BM TAG IN S CB TEMPLE AVE 600MM E/O BCR 11M S/O C/L & 27M E/O DIAMOND BAR BLVD	G 4621



JAD-YEAR	ELEV METER/FOOT	D E S C R I P T I O N (INCLUDE QUAD AND YEAR IN DESCRIPTION)	BM NUMBER
OTTERBEIN (1995)	0300.243 0985.047	DPW BM TAG IN S CB 300MM W/O BCR @ SW COR GRAND AVE & ROLLING KNOLL RD 15M W & 12.2M S/O C/L INT	G 4623
OTTERBEIN (1995)	0302.575 0992.698	RCE TAG #9757 S CB 300MM E/O BCR @ SW COR GRAND AVE & ROLLING KNOLL RD 15M E & 12.2M S/O C/L INT	G 4624
OTTERBEIN (1995)	0354.189 1162.035	DPW BM TAG S CB 7.6M W/O BCR @ SW COR GRAND AVE & SHOTGUN LN (EXIT) 17M W & 12.2M S/O C/L INT	G 4625
OTTERBEIN (1995)	0354.386 1162.681	DPW BM TAG S CB 300MM E/O BCR @ SE COR GRAND AVE & SHOTGUN LN (EXIT) 11.6M E & 12.2M S/O C/L INT	G 4626
OTTERBEIN (1995)	0314.208 1030.864	DPW BM TAG E CB 2.7M N/O BCR @ NE COR GRAND AVE & LONGVIEW DR 23M N & 7.6M E/O C/L INT	G 4628
OTTERBEIN (1995)	0317.104 1040.365	L&BR IN W CB 300MM S/O BCR @ SW COR LONGVIEW DR & STARDUST DR 12.5M S & 6.1M W/O C/L INT	G 4629
OTTERBEIN (1995)	0317.447 1041.491	L&BR IN W CB @ S END C B NW COR LONGVIEW DR & STARDUST DR 12.5M N & 6.1M W/O C/L INT	G 4630
BASELINE (1995)	0152.159 0499.208	L&BR IN SW COR CONC HDWL @ NE COR HACIENDA BLVD & WEST RD 13.7M N & 6.1M E/O C/L INT	G 4631
BASELINE (1995)	0202.829 0665.448	CE TAG IN CONC HDWL 2M S/O ANGLE PT @ N END NR C/L PROD REPOSADO DR & 8.2M W/O C/L HACIENDA BL	G 4632
BASELINE (1995)	0134.428 0441.036	DPW BM TAG IN S CB 300MM W BCR @ SW COR TETLEY ST & HACIENDA BLVD 20M W & 6.1M S/O C/L INT	G 4633
BASELINE (1995)	0105.351 0345.639	DPW BM TAG IN S CB VALLEY BLVD 6.1M S/O C/L & 12.8M S/O PP #215724E (128M E/O C/L VALLEY BLVD OVERPASS)	G 4635
BASELINE (1995)	0114.196 0374.658	DPW BM TAG IN N CB 300MM W BCR @ NW COR VALLEY BLVD & WICKFORD AVE 16.8M W & 12.8M N/O C/L INT	G 4636
BASELINE (1995)	0144.659 0474.602	RCE TAG #5828 CB 300MM E BCR @ NE COR VALLEY BLVD & SENTOUS AVE 20M E & 14.6M N/O C/L INT	G 4637
BASELINE (1995)	0186.211 0610.927	USC&GS MON IN E CB 1.2M N/O BCR @ NE COR GRAND AVE & VALLEY BLVD 27M N/O & 13.7M E/O C/L INT MKD (L 1329 1978) S END C B	G 4640
BASELINE (1995)	0222.931 0731.399	USC&GS BR DISC IN WLY CB POMONA BLVD S END C B 10.1M W/O C/L & 56M NLY/O C/L (57 FRWY) MKD (G 1329 1978)	G 4641
BASELINE (1995)	0231.042 0758.010	L&T IN ELY CB POMONA BLVD 9.8M E/O C/L ON C/L PROD PIONEER PL	G 4642

JAD-YEAR	ELEV METER/FOOT	D E S C R I P T I O N (INCLUDE QUAD AND YEAR IN DESCRIPTION)	BM NUMBER
BASELINE (1995)	0274.194 0899.585	DPW BM TAG IN E CB 1.5M S/O BCR @ SE COR 1ST ST & EAST END AVE 18.3M S & 12.2M E/O C/L INT	G 4643
OTTERBEIN (1995)	0271.508 0890.772	DPW BM TAG IN N CB TEMPLE AVE 900MM E/O BCR 14M E/O C/L & 26M W/O C/L DIAMOND BAR BLVD	G 4673
OTTERBEIN (1995)	0266.992 0875.956	DPW BM TAG IN N CB DIAMOND BAR BL @ BCR W END C B 12.8M N/O C/L & 15.5M E/O C/L SOLTAIRE ST	G 4674
OTTERBEIN (1995)	0234.942 0770.806	RDBM TAG IN E CB DIAMOND BAR BLVD 1.2M S/O BCR 13M E/O C/L & 18M S/O C/L HIGHLAND VALLEY RD	G 4675
OTTERBEIN (1995)	0249.205 0817.600	DPW BM TAG W CB DIAMOND BAR BLVD 1.5M N/O BCR 15.2M W C/L & 19M N C/L KIOWA CREST DR S END C B	G 4676
OTTERBEIN (1995)	0236.041 0774.411	DPW BM TAG W CB DIAMOND BAR BL S END C B 8M N/O BCR 15.2M W/O C/L & 31M N/O C/L PATHFINDER BL	G 4677
OTTERBEIN (1995)	0271.168 0889.657	DPW BM TAG W END C B 12M W/O BCR 9.8M N/O C/L PATHFINDER RD & 32M W/O C/L BREA CYN CUT-OFF RD	G 4681
OTTERBEIN (1995)	0270.111 0886.189	DPW BM TAG IN S END C B 46M N/O C/L PATHFINDER RD & 11M E/O C/L BREA CYN CUT-OFF RD	G 4682
OTTERBEIN (1995)	0246.335 0808.184	L&T IN W CB BREA CYN CUT-OFF RD @ N END C B 9.8M W/O C/L & 13M S/O C/L OAKLEAF CYN RD	G 4683
OTTERBEIN (1995)	0245.239 0804.588	L&T IN N CB OAKLEAF CYN RD @ E END C B 5.5M N/O C/L & 18M W/O C/L BREA CYN CUT-OF RD	G 4684
OTTERBEIN (1995)	0224.222 0735.635	DPW BM TAG E CB BREA CYN CUT-OFF RD 2.5M S/O BCR 10.7M E/O C/L & M S/O C/L BICKFORD DR	G 4685
OTTERBEIN (1995)	0194.227 0637.226	DPW BM TAG IN ELY CB BREA CYN CUT-OFF RD 3M N BCR 14M E/O C/L & 16M N/O C/L ESQUILINE AVE	G 4686
OTTERBEIN (1995)	0203.391 0667.292	DPW BM TAG IN S CB BALAN RD 1.5M E/O BCR @ W END C B 6M S/O C/L & 15M E/O C/L FRANCES LN	G 4687
OTTERBEIN (1995)	0202.726 0665.110	DPW BM TAG IN W CB FRANCES LN 1.5M S/O BCR N END C B 6M W/O C/L & 15M S/O C/L BALAN RD	G 4688
OTTERBEIN (1995)	0188.095 0617.108	DPW BM TAG IN S CB BALAN RD 7M E/O BCR @ E END C B 6M S/O C/L & 19M E/O C/L ARCDALE AVE	G 4689
OTTERBEIN (1995)	0193.857 0636.013	DPW BM TAG IN S CB PATHFINDER RD @ BCR 9.8M S/O C/L & 14M W/O C/L ANNADEL AVE	G 4691
OTTERBEIN (1995)	0216.297 0709.634	L&BR @ SW COR CONC DR TO HSE #2360 FULLERTON RD 11M E/O C/L & 775MM ELY/O SE COR BRICK PILLAR	G 4695

JAD-YEAR	ELEV METER/FOOT	D E S C R I P T I O N (INCLUDE QUAD AND YEAR IN DESCRIPTION)	BM NUMBER
OTTERBEIN (1995)	0238.182 0781.435	DPW BM TAG IN CONC HDWL OPP DRWY TO HSE #1409 EAST RD 5.5M S/O C/L & 21.6M E/O C/L CORBIN RD	G 4696
OTTERBEIN (1995)	0220.845 0724.556	CS TAG IN N END CONC HDWL @ SW COR EAST RD & TUMIN RD 28M W & 3.7M S/O C/L INT	G 4697
OTTERBEIN (1995)	0160.649 0527.063	DPW BM TAG IN W CB LEMON AVE 300MM N/O BCR 12.2M W/O C/L & 26M N/O C/L BUSINESS PKWY	G 4735
OTTERBEIN (1995)	0160.939 0528.014	DPW BM TAG IN W CB 1.5M S/O BCR @ SW COR LEMON AVE & BUSINESS PKWY 27M S & 12.2M W/O C/L INT	G 4736
OTTERBEIN (1995)	0171.550 0562.827	DPW BM TAG IN N CB 300MM W/O BCR @ NW COR BREA CYN RD & LYCOMING ST 26M W & 6.1M N/O C/L INT	G 4738
OTTERBEIN (1995)	0177.569 0582.574	DPW BM TAG E CB 14M N/O BCR @ NE COR BREA CYN RD & GOLDEN SPRINGS DR 37M N & 12.8M E/O C/L INT	G 4739
OTTERBEIN (1995)	0154.466 0506.777	DPW BM TAG N CB 300MM W/O BCR @ NW COR WALNUT DR S & FAIRWAY DR 17M N & 13M W/O C/L INT	G 4740
OTTERBEIN (1995)	0154.950 0508.365	L&T IN W CB 300MM S/O BCR @ SW COR FAIRWAY DR & WALNUT DR 15M S & 13M W/O C/L INT	G 4741
OTTERBEIN (1995)	0173.890 0570.504	L&T IN CB 1FT N/O BCR @ NE COR FAIRWAY DR & COLIMA RD 90FT N & 42FT E/O C/L INT	G 4742
OTTERBEIN (1995)	0128.921 0422.968	DPW BM TAG E CB 300MM N BCR @ NE COR STIMPSON AVE & HALLIBURTON RD 34M N & 9.1M E/O C/L INT	G 4743
OTTERBEIN (1995)	0146.982 0482.223	DPW BM TAG S CB 300MM E BCR @ SE COR PASO VERDE DR & HALLIBURTON RD 14.3M E & 14M S/O C/L INT	G 4744
OTTERBEIN (1995)	0148.115 0485.941	DPW BM TAG S CB 1.5M W BCR @ SW COR PASO VERDE DR & HALLIBURTON RD 13M W & 14M S/O C/L INT	G 4745
OTTERBEIN (1995)	0131.117 0430.173	RCE TAG #20330 N CB 1.5M N BCR @ NW COR RAILROAD ST & FULLERTON RD 21M N & 9.8M N/O C/L INT	G 4747
OTTERBEIN (1995)	0131.105 0430.134	RCE TAG #20330 E CB 1.5M N BCR @ NE COR RAILROAD ST & FULLERTON RD 23M N & 9.8M E/O C/L INT	G 4748
BASELINE (1995)	0244.180 0801.114	L&N IN S CB 2ND ST NR E END C B 8.8M S/O C/L & 100M E/O C/L HWY 71	G 4750
OTTERBEIN (1995)	0155.162 0509.061	DPW BM TAG W CB 300MM N/O BCR @ NW COR COLIMA RD & OTTERBEIN AVE 23.5M N & 6.4M W/O C/L INT	G 4752
OTTERBEIN (1995)	0143.633 0471.236	RCE TAG #10915 IN N CB 300MM W/O BCR @ NW COR COLIMA RD & DESIRE AVE 20M W & 12.8M N/O C/L INT	G 4753

JAD-YEAR	ELEV METER/FOOT	D E S C R I P T I O N (INCLUDE QUAD AND YEAR IN DESCRIPTION)	BM NUMBER
OTTERBEIN (1995)	0141.903 0465.560	DPW BM TAG IN S CB 1.2M E/O BCR @ SE COR COLIMA RD & BATSON AVE 18M E & 12.8M S/O C/L INT	G 4754
BASELINE (1995)	0125.509 0411.774	DPW BM TAG IN N CB @ NW COR VALLEY BLVD & YORBITA RD 12.8M N & 13M W/O C/L INT	G 4755
BASELINE (1995)	0139.762 0458.536	RDBM TAG IN W CB NR N END C B @ NW COR VALLEY BLVD & NOGALES ST 43M W & 13M W/O C/L INT	G 4756
BASELINE (1995)	0139.811 0458.697	DPW BM TAG IN E CB 17M N/O BCR NR N END C B @ NE COR VALLEY BLVD & NOGALES ST 43M N & 12.8M E/O C/L INT	G 4757
BASELINE (1995)	0143.854 0471.961	RCE TAG #5828 N CB 300MM W/O BCR @ NW COR VALLEY BLVD & SENTOUS AVE 21.3M W & 12.8M N/O C/L INT	G 4758
BASELINE (1995)	0184.808 0606.324	L&BR IN S CB VALLEY BLVD 10M W/O BCR 12.8M S/O C/L & 35M W/O C/L GRAND AVE	G 4759
OTTERBEIN (1995)	0185.072 0607.190	L&BR IN W CB NW COR BRIDGE OVER SAN JOSE CREEK 228M S C/L VALLEY BL & 13.7M W/O C/L GRAND AVE	G 4760
OTTERBEIN (1995)	0212.074 0695.779	40MM IP WITH SPK&W 19M W/O C/L GRAND AVE 5.5M W/O CF 16M S/O LT STD #4174791E & 930M N/O C/L OLD BREA CYN RD	G 4766
OTTERBEIN (1995)	0223.771 0734.155	L&BR IN CONC FTG OF 2M CHAIN LINK FENCE 16.5M W C/L GRAND AVE & 483M N/O C/L OLD BREA CYN RD (OPP CONC HDWL)	G 4767
OTTERBEIN (1995)	0223.033 0731.734	L&BR IN CONC HDWL 19M E/O C/L GRAND AVE & 483M N/O C/L OLD BREA CYN RD	G 4768
OTTERBEIN (1995)	0213.804 0701.455	L&T E CB GRAND AVE 12.8M E/O C/L & 65M S/O C/L OLD BREA CYN RD (60 FRWY ON-OFF RAMP) 38M S BCR	G 4769
OTTERBEIN (1995)	0214.007 0702.121	L&T IN E CB OF ISL @ C/L GRAND AVE & 65M S/O C/L OLD BREA CYN RD (60 FRWY ON-OFF RAMP)	G 4770
BASELINE (1995)	0102.831 0337.371	RCE TAG #5828 IN N CB 300MM E BCR @ NE COR OLD VALLEY BL & ALBERT ST 13.7M E & 6.1M N/O C/L INT NR W END C B	G 4804
OTTERBEIN (1995)	0137.460 0450.983	DPW BM TAG N CB W END C B 19M W/O BCR @ NW COR COLIMA RD & HALL RD 37M W & 12.8M N/O C/L INT	G 4806
OTTERBEIN (1995)	0139.727 0458.421	DPW BM TAG E CB 300MM N/O BCR @ NE COR COLIMA RD & ALBATROSS ST 24M N & 9.8M E/O C/L INT	G 4807

JAD-YEAR	ELEV METER/FOOT	D E S C R I P T I O N (INCLUDE QUAD AND YEAR IN DESCRIPTION)	BM NUMBER
OTTERBEIN (1995)	0139.511 0457.712	DPW BM TAG W CB 300MM N/O BCR @ NW COR COLIMA RD & ALBATROSS ST 35M N & 9.8M W/O C/L INT	G 4808
OTTERBEIN (1995)	0168.604 0553.162	DPW BM TAG IN E CB 600MM S BCR @ SE COR SENTENO ST & FULLERTON RD 13.4M S & 9M E/O C/L INT	G 4809
BASELINE (1995)	0151.422 0496.790	DPW BM TAG IN CONC HDWL 150MM S/O N END DRAIN CULV @ NW COR 13.8M N/O C/L PROD WEST RD & 7M W/O C/L HACIENDA BLVD (720MM S/O PP NO#)	G 4810
BASELINE (1995)	0209.483 0687.279	DPW BM TAG IN E CB @ ST LT #4088180E 3.7M S/O N END CB 17M E/O C/L HACIENDA BLVD & 144M S/O C/L GLENMARK DR (OPP EQUESTRIAN CROSSING UNDERPASS)	G 4811
BASELINE (1995)	0143.040 0469.290	L&T IN W CB N END C B 1.5M S/O BCR @ SW COR LA SUBIDA DR & HACIENDA BL 18.7M S & 13M W C/L INT	G 4812
BASELINE (1995)	0115.135 0377.739	DPW BM TAG IN E CB 3M N/O BCR @ NE COR HACIENDA BLVD & LUJON ST 18.6M N & 13M E/O C/L INT	G 4813
BASELINE (1995)	0104.842 0343.969	DPW BM TAG IN E CB HACIENDA BLVD 13M E/O C/L & 8M S/O C/L OF W BOUND OFF-RAMP (60 FRWY)	G 4814
BASELINE (1995)	0101.633 0333.440	CE TAG IN N CB 100MM E/O BCR @ NE COR HACIENDA BLVD & WALBROOK DR 23M E & 5.5M N/O C/L INT	G 4853
BASELINE (1995)	0101.609 0333.362	DPW BM TAG E CB 41.5M N BCR @ NE COR HACIENDA BLVD & WALBROOK DR 60M N & 12.8M E/O C/L INT @ ST LT #2271712E	G 4854
BASELINE (1995)	0097.814 0320.911	DPW BM TAG IN E CB 1M N/O BCR @ NE COR HACIENDA BLVD & PARRIOTT PL TO E 21M N & 14M E/O C/L INT	G 4855
BASELINE (1995)	0097.819 0320.928	DPW BM TAG IN E CB 1M N/O BCR @ NE COR VALLEY BLVD & HACIENDA BLVD 23.5M N & 14M E/O C/L INT	G 4856
BASELINE (1995)	0109.796 0360.222	DPW BM TAG IN N CB W END C B 5M E BCR @ NE COR VALLEY BL & FERRERO LN 24M E & 12.2M N C/L INT	G 4857
BASELINE (1995)	0114.381 0375.265	DPW BM TAG IN N CB W END C B 1.2M E/O BCR @ NE COR VALLEY BLVD & WICKFORD AVE 17.3M E & 12.8M N/O C/L INT	G 4858
BASELINE (1995)	0116.530 0382.316	DPW BM TAG IN E CB 1M N/O BCR @ NE COR VALLEY BLVD & AZUSA WAY 28M N & 8.8M E/O C/L INT	G 4859
BASELINE (1995)	0108.508 0355.997	L&BN 2M W/O E END CONC HDWL CULV 520MM S/O SLY CF NEW VALLEY BLVD 40M S/O C/L & 17M W/O APPROX C/L INT WITH OLD VALLEY BLVD	G 4883

JAD-YEAR	ELEV METER/FOOT	D E S C R I P T I O N (INCLUDE QUAD AND YEAR IN DESCRIPTION)	BM NUMBER
BASELINE (1995)	0117.287 0384.799	L&BR IN W END C B 150MM E/O BCR @ NE COR VALLEY BLVD & HURLEY ST 25.6M E & 12.8M N/O C/L INT	G 4906
BASELINE (1995)	0120.800 0396.325	L&BR IN N CB 1.5M W/O BCR @ NW COR VALLEY BLVD & ALDERTON AVE 19.2M W & 12.8M N/O C/L INT	G 4907
BASELINE (1995)	0122.140 0400.721	L&BR IN N CB 600MM E/O BCR @ NE COR VALLEY BLVD & GIANO AVE 14M E & 12.8M N/O C/L INT	G 4908
BASELINE (1995)	0128.724 0422.322	L&BR IN CTR OF C B 7.2M N/O BCR @ NW COR VALLEY BLVD & LA SEDA RD 30.5M N & 5.5M W/O C/L INT	G 4909
BASELINE (1995)	0146.766 0481.515	L&SPK IN NLY CB VALLEY BLVD 1.8M ELY BCR 12.8M N/O C/L & 21M E/O C/L MORGANFIELD AVE NR C B	G 4910
BASELINE (1995)	0149.104 0489.185	DPW BM TAG IN ELY CB CAMINO DE THEODORO 750MM N/O BCR 6.1M E/O C/L & 30.5M N/O C/L VALLEY BLVD NR SLY END C B	G 4911
BASELINE (1995)	0159.069 0521.879	DPW BM TAG IN NLY CB VALLEY BLVD 5M E/O BCR 12.8M N/O C/L & 30.2M E/O C/L LEMON AVE @ C B	G 4912
BASELINE (1995)	0160.854 0527.735	L&BR IN ELY CB PASEO TESORO 300MM N/O BCR 7.3M E/O C/L & 23.8M N/O C/L VALLEY BLVD	G 4913
BASELINE (1995)	0163.634 0536.856	DPW BM TAG IN NLY CB VALLEY BLVD 12.8M N/O C/L NR CTR OF BLDG #20747 (GTE) @ LT STD #4275370E	G 4914
BASELINE (1995)	0169.479 0556.032	L&BR IN NLY CB VALLEY BL 1.5M W/O BCR 1.4M E/O END OF CB 16.2M N/O C/L & 18M W/O C/L SUZANNE RD	G 4915
BASELINE (1995)	0171.932 0564.080	DPW BM TAG IN NLY CB VALLEY BLVD 300MM W/O BCR 12.8M N/O C/L & 21.3M W/O C/L MORNINGSIDE DR	G 4916
BASELINE (1995)	0180.675 0592.765	L&BR IN WLY CB VALLEY BLVD 300MM N/O BCR 12.8M W/O C/L & 19.7M N/O C/L SOMERSET DR NR S END C B	G 4917
BASELINE (1995)	0188.409 0618.139	DPW BM TAG IN NLY CB VALLEY BLVD 12.8M N/O C/L & 11.3M E/O C/L PROD BENTON RD NR W END C B	G 4918
BASELINE (1995)	0197.473 0647.876	DPW BM TAG IN ELY CB VALLEY BLVD 12.8M E/O C/L & 5.8M S/O S END DRWY 15M S/O S END BLDG #4200	G 4919
BASELINE (1995)	0206.567 0677.712	NGS BR DISC IN WLY CB VALLEY BLVD @ SWLY COR BRIDGE ABUT 12.8M W/O C/L & 6.2M S/O C/L BRIDGE OVER SAN JOSE CREEK MKD (H 1329 1978)	G 4920
BASELINE (1995)	0215.650 0707.512	DPW BM TAG IN WLY CB POMONA BL 24M N/O BCR 9.8M W/O C/L & 41M N/O C/L TEMPLE AVE NR S END C B	G 4921

JAD-YEAR	ELEV METER/FOOT	D E S C R I P T I O N (INCLUDE QUAD AND YEAR IN DESCRIPTION)	BM NUMBER
BASELINE (1995)	0221.645 0727.180	DPW BM TAG IN ELY CB POMONA BLVD @ S END C B 9.6M E/O C/L & 18.6M N/O C/L VOYAGE ST	G 4922
BASELINE (1995)	0247.668 0812.557	DPW BM TAG IN S CB 2ND ST 1M E/O E END C B 7M S/O C/L & 530M E/O C/L HWY 71 CORONA EXPRESS WY 2.6M W/O PP #G782Y	G 4965
BASELINE (1995)	0261.454 0857.787	DPW BM TAG IN S CB 1M W/O BCR @ SW COR FIRST ST & PARK AVE 19.2M W & 6.1M S/O C/L INT @ F HYD	G 4966
BASELINE (1995)	0262.079 0859.838	DPW BM TAG IN E CB NR N END PARKWAY DRAIN 11M S/O C/L FIRST ST & 7.3M E/O C/L MAIN ST	G 4967
BASELINE (1995)	0265.016 0869.473	DPW BM TAG IN W CB 2.4M S/O S END RAMP 11M S/O C/L FIRST ST & 8.5M W/O C/L PALOMARES ST	G 4968
BASELINE (1995)	0265.095 0869.733	DPW BM TAG IN E CB 1M S/O S END RAMP 10.4M S/O C/L FIRST ST & 8.5M W/O C/L PALOMARES ST	G 4969
BASELINE (1995)	0267.850 0878.771	DPW BM TAG IN S CB 1M E/O BCR @ SE COR FIRST ST & SAN ANTONIO AVE 21M E & 6.1M S/O C/L INT	G 4970
OTTERBEIN (1995)	0192.543 0631.701	L&T IN S CB 5M W/O BCR @ SE COR COLIMA RD & ALLEN TON AVE 14M S & 11M E/O C/L INT	G 5030
OTTERBEIN (1995)	0193.632 0635.274	BR DISC IN S CB 300MM E/O BCR @ SE COR COLIMA RD & SIERRA PEAK WAY 13.7M E & 12.8M S/O C/L INT MKD (PAS 4)	G 5031
OTTERBEIN (1995)	0156.189 0512.430	L&T 300MM S/O S CB 6.7M W/O BCR @ SW COR COLIMA RD & DAWN HAVEN RD 25M W & 13.1M S/O C/L INT NR CTR C B	G 5032
OTTERBEIN (1995)	0138.338 0453.864	DPW BM TAG IN S CB COLIMA RD 12.8M S/O C/L & 17.6M W/O C/L PROD STONER CREEK RD	G 5033
OTTERBEIN (1995)	0146.248 0479.815	CE TAG IN S CB 2M E/O BCR @ SW COR COLIMA RD & FULLERTON RD 18M W & 13.1M S/O C/L INT	G 5034
OTTERBEIN (1995)	0160.212 0525.629	L&BR IN N CB 300MM E/O BCR @ NE COR COLIMA RD & BANIDA AVE 14.3M E & 12.8M N/O C/L INT	G 5035
OTTERBEIN (1995)	0178.189 0584.608	CSBM MON IN S CB E END C B @ BCR SW COR GOLDEN SPRINGS RD & CALBOURNE DR 14M W & 13.1M S/O C/L INT MKD (BM 44-6A 1975 RE 7078)	G 5036
OTTERBEIN (1995)	0178.961 0587.141	L&T IN S CB 2M W/O BCR @ SW COR GOLDEN SPRINGS RD & RAPIDVIEW DR 15M W & 12.8M S/O C/L INT	G 5037

JAD-YEAR	ELEV METER/FOOT	D E S C R I P T I O N (INCLUDE QUAD AND YEAR IN DESCRIPTION)	BM NUMBER
OTTERBEIN (1995)	0119.325 0391.485	L&T IN W CB 1M S/O BCR @ SW COR STIMSON AVE & LUJON ST 20M S & 9.1M W/O C/L INT	G 5038
OTTERBEIN (1995)	0121.378 0398.221	CITY OF INDUSTRY BR CAP IN S CB @ C B 46M E/O C/L AZUSA AVE & 11M S/O C/L GALE AVE MKD (G-26)	G 5039
OTTERBEIN (1995)	0121.267 0397.857	DPW BM TAG IN N CB 1M E/O BCR @ NE COR AZUSA AVE & GALE AVE 28M E & 11M N/O C/L INT	G 5040
OTTERBEIN (1995)	0116.532 0382.322	DPW BM TAG IN S CB 1M E/O BCR @ SE COR AZUSA AVE & RAILROAD ST 28M E & 7.3M S/O C/L INT	G 5041
OTTERBEIN (1995)	0121.667 0399.169	DPW BM TAG IN S CB 1M W/O BCR @ SW COR RAILROAD ST & HATCHER AVE 26M W & 11.6M S/O C/L INT	G 5042
OTTERBEIN (1995)	0123.198 0404.192	DPW BM TAG IN N CB 1M W/O BCR @ NW COR ROWLAND ST & RADECKI CT 27M W & 9.4M N/O C/L INT	G 5043
OTTERBEIN (1995)	0129.425 0424.622	DPW BM TAG IN N CB 1M E/O BCR @ NE COR ROWLAND ST & AJAX AVE 15M E & 9.4M N/O C/L INT	G 5044
OTTERBEIN (1995)	0128.989 0423.191	CITY OF INDUSTRY BR CAP IN S CB 9M E/O BCR @ SE COR ROWLAND ST & LAWSON ST 27M E & 9.4M S/O C/L INT MKD (BM R-1)	G 5045
OTTERBEIN (1995)	0135.588 0444.842	RCE TAG #5828 IN W CB 5M N/O BCR 13M N & 9.8M W/O C/L INT FULLERTON RD & POMONA (60) FRWY E BOUND OFF RAMP	G 5046
OTTERBEIN (1995)	0175.938 0577.223	DPW BM TAG IN NW COR OF (ELY MOST) GOLF CART PATH 4M N/O C/L & 402M E/O HACIENDA BLVD	G 5047
OTTERBEIN (1995)	0186.610 0612.236	CE TAG IN WLY CB EAST RD 4M S/O BC & 4M W/O C/L 63.4M SLY/O C/L DRWY TO HSE #365	G 5048
OTTERBEIN (1995)	0224.150 0735.399	DPW BM TAG IN E EDGE CONC DR TO HSE #500 EAST RD 3.7M S/O C/L & 9.4M E/O C/L PROD CHURCHHILL RD (WLY INT)	G 5049
OTTERBEIN (1995)	0223.065 0731.839	GEAR HD SPK & WASH ON C/L PAPAYA DR & EAST RD P.I. INT	G 5050
OTTERBEIN (1995)	0252.513 0828.453	DPW BM TAG IN CONC DRWY TO HSE #1505 EAST RD 3.7M N/O C/L & 500MM E/O W EDGE DRWY	G 5051
OTTERBEIN (1995)	0197.205 0646.997	DPW BM TAG IN SLY CB 1M W/O BCR @ SW COR HARBOR BLVD & FULLERTON RD 24.5M W & 6.1M S/L C/L INT	G 5052
OTTERBEIN (1995)	0189.933 0623.139	DPW BM TAG IN ELY CB 1M N/O BCR @ NE COR HARBOR BLVD & PATHFINDER RD 22M N & 12.8M E/O C/L INT	G 5053



JAD-YEAR	ELEV METER/FOOT	D E S C R I P T I O N (INCLUDE QUAD AND YEAR IN DESCRIPTION)	BM NUMBER
OTTERBEIN (1995)	0174.541 0572.640	L&BR IN W CB 1M S/O BCR @ SW COR FULLERTON RD & SUNRISE DR 15M S & 10.7M W/O C/L INT	G 5054
OTTERBEIN (1995)	0163.269 0535.658	DPW BM TAG IN N CB 1M E/O BCR @ NE COR MESCAL ST & FULLERTON RD 15M E & 6M N/O C/L INT	G 5055
OTTERBEIN (1995)	0154.526 0506.974	DPW BM TAG N CB 1M W/O BCR @ NW COR FULLERTON RD & CROSSHAVEN DR 18M W & 6M N/O C/L INT	G 5056
OTTERBEIN (1995)	0197.434 0647.748	DPW BM TAG IN N CB 1M E/O BCR @ NE COR NATIVE AVE & PATHFINDER RD 14M E & 9.8M N/O C/L INT	G 5057
OTTERBEIN (1995)	0193.636 0635.287	DPW BM TAG S CB 1M E/O BCR @ SE COR PATHFINDER RD & BUTTWOOD LN 14MN & 9.8M S/O C/L INT	G 5058
OTTERBEIN (1995)	0191.142 0627.105	RCE TAG #23956 N CB 300MM E BCR @ NW COR GALLIO AVE & PATHFINDER RD 11M W & 9.8M N/O C/L INT	G 5059
OTTERBEIN (1995)	0190.989 0626.603	DPW BM TAG IN W CB 1M N/O BCR @ NW COR GALLIO AVE & PATHFINDER RD 17M N & 5.8M W/O C/L INT	G 5060
OTTERBEIN (1995)	0187.500 0615.156	DPW BM TAG S CB 1M E/O BCR @ SE COR PATHFINDER RD & BLANDFORD DR 18M E & 9.8M S/O C/L INT	G 5061
OTTERBEIN (1995)	0177.437 0582.141	DPW BM TAG IN S CB @ BCR SW COR PATHFINDER RD & WELLESLEY DR 15.4MW & 9.8M S/O C/L INT	G 5062
OTTERBEIN (1995)	0177.593 0582.653	DPW BM TAG S CB 1M E/O BCR @ SE COR PATHFINDER RD & WELLESLEY DR 15M E & 9.8M S/O C/L INT	G 5063
OTTERBEIN (1995)	0189.084 0620.353	DPW BM TAG IN S CB 1M E/O BCR @ SE COR SONGBIRD LN & PATHFINDER RD 15M E & 9.8M S/L C/L INT	G 5064
OTTERBEIN (1995)	0189.498 0621.711	DPW BM TAG N CB 1M E/O BCR @ NE COR PATHFINDER RD & ALEXDALE LN 14M E & 9.8M S/O C/L INT	G 5065
OTTERBEIN (1995)	0186.395 0611.531	DPW BM TAG IN S CB 1M E/O BCR @ SE COR BALAN RD & ANNADEL AVE 15M E & 6M S/O C/L INT	G 5066
OTTERBEIN (1995)	0182.429 0598.519	DPW BM TAG W CB 1M N BCR @ NW COR BREA CYN CUT OFF RD & REEDVIEW DR 18M N & 11.3M W/O C/L INT	G 5067
OTTERBEIN (1995)	0162.279 0532.410	CITY OF INDUSTRY BR DISC IN S CB 21M E/O BCR @ SE COR LYCOMING ST & LEMON AVE 42M E & 6.1M S/O C/L INT MKD (C.I. W-12) @ E END C B	G 5068
OTTERBEIN (1995)	0223.029 0731.721	GEAR HD SPK&W IN AC PAV 6.7M W/O C/L BREA CYN CUT-OFF RD ON C/L PROD BICKFORD DR 5M E/O WEST EDGE PVMT MKD (RCE 16362)	G 5069

UAD-YEAR	ELEV METER/FOOT	D E S C R I P T I O N (INCLUDE QUAD AND YEAR IN DESCRIPTION)	BM NUMBER
OTTERBEIN (1995)	0268.174 0879.834	CE TAG IN N CB CUT-OFF CT @ E END C B 5.8M N/O C/L & 18M W/O C/L BREA CYN CUT-OFF RD	G 5070
OTTERBEIN (1995)	0251.823 0826.189	DPW BM TAG IN S CB BREA CYN CUT-OFF RD 9.8M S/O C/L & 370M S/O PATHFINDER RD 1M N/O N END C B	G 5071
OTTERBEIN (1995)	0234.564 0769.565	L&T IN ELY CB BREA CYN CUT-OFF RD 9.8M E/O C/L ON C/L PROD OAK CREST DR	G 5072
OTTERBEIN (1995)	0221.530 0726.803	LACO DPW TAG IN E CB DIAMOND BAR BLVD 12.8M E/O C/L & 29M N/O C/L CROOKED CREEK DR	G 5073
OTTERBEIN (1995)	0227.783 0747.318	LACO DPW TAG IN W CB DIAMOND BAR BL 300MM S/O BCR 12.8M W/O C/L & 17M N/O C/L COLD SPRINGS LN	G 5074
OTTERBEIN (1995)	0224.636 0736.993	DPW BM TAG IN W CB DIAMOND BAR BLVD 1M N/O BCR 12.8M W/O C/L & 18M N/O C/L FOUNTAIN SPRINGS RD	G 5075
OTTERBEIN (1995)	0273.613 0897.679	DPW BM TAG S CB 1M E/O BCR @ SE COR GRAND AVE & DIAMOND BAR BLVD 26M E & 12.8M S/O C/L INT	G 5076
OTTERBEIN (1995)	0273.831 0898.394	DPW BM TAG IN E CB 1M N/O BCR @ NE COR DIAMOND BAR BLVD & GRAND AVE 25M N & 15.2M E/O C/L INT	G 5077
OTTERBEIN (1995)	0268.274 0880.162	L&T S CB W END C B 11M E/O BCR @ SE COR STEEP CYN RD & DIAMOND BAR BLVD 32M E & 6M S C/L INT	G 5078
OTTERBEIN (1995)	0267.969 0879.162	L&T IN N CB @ BCR NE COR DIAMOND BAR BLVD & STEEP CYN RD 21M E & 6M N/O C/L INT	G 5079
OTTERBEIN (1995)	0256.252 0840.720	L&T IN W CB RET 3M S/O BCR @ NW COR DIAMOND BAR BLVD & GOLDRUSH DR 15.5M W & 16M N/O C/L INT	G 5080
OTTERBEIN (1995)	0217.707 0717.260	L&T IN E CB DIAMOND BAR BLVD 300MM N/O BCR 12.8M E/O C/L & 23M N/O C/L ON-OFF RAMP 60 FRWY (N SIDE FRWY)	G 5081
OTTERBEIN (1995)	0218.395 0716.518	LACO DPW TAG IN E CB DIAMOND BAR BLVD @ BLDG #724 12.8M E/O C/L @ LT STD #2220804E	G 5082
OTTERBEIN (1995)	0338.873 1111.786	L&BR IN S CB 600MM E/O BCR @ SE COR GRAND AVE & COUNTRY VIEW DR 14M E & 12.2M S/O C/L INT	G 5083
OTTERBEIN (1995)	0314.274 1031.081	L&BR IN S CB 2.4M E/O BCR @ SE COR GRAND AVE & LONGVIEW DR 16M E & 12.8M S/O C/L INT	G 5084
OTTERBEIN (1995)	0225.696 0740.471	DPW BM TAG IN SLY CB GOLDEN SPRINGS DR 1M E/O BCR 9.8M S/O C/L & 23M E/O C/L GRAND AVE	G 5085

JAD-YEAR	ELEV METER/FOOT	D E S C R I P T I O N (INCLUDE QUAD AND YEAR IN DESCRIPTION)	BM NUMBER
OTTERBEIN (1995)	0209.197 0686.340	LACO DPW TAG IN W CB GRAND AVE 20M N/O LT STD #4174791E 13.7M W/O C/L & 1K N/O OLD BREA CYN RD	G 5086
OTTERBEIN (1995)	0195.424 0641.154	CITY OF INDUSTRY BR DISC @ SW COR BRIDGE #B1942 OVER RR TRACKS 2M W/O CF 15.8M W/O C/L GRAND AVE & 1K S/O VALLEY BLVD MKD (C.I. GR-1)	G 5087
OTTERBEIN (1995)	0195.637 0641.852	DPW BM TAG W CB 10.4M N/O N ABUT BRIDGE #B1942 @ LT STD #4174830E 13.7M W/O C/L GRAND AVE & 971M S/O VALLEY BLVD	G 5088
OTTERBEIN (1995)	0271.847 0891.885	DPW BM TAG IN N CB GRAND AVE 1M E/O BCR 13M N/O C/L & 15M E/O C/L CAHILL PL	G 5089
OTTERBEIN (1995)	0194.427 0637.883	L&BR IN E CB @ SE COR BRIDGE #B1940 OVER RR TRACKS 13.7M E/O C/L GRAND AVE & 680M S/O C/L VALLEY BLVD	G 5090
OTTERBEIN (1995)	0262.909 0862.561	L&BR IN N CB VILLAGE LOOP RD 10M N/O C/L ON C/L PROD PHILLIPS RANCH RD	G 5091
OTTERBEIN (1995)	0276.962 0908.666	CAL TRANS BR DISC IN CONC WK 6M S & 1M W/O NW COR BRIDGE #53-2080 OVER (60 FRWY) & 13.8M S/O C/L PHILLIPS RANCH RD	G 5092
OTTERBEIN (1995)	0282.834 0927.931	SPK IN WALK @ SW COR BRIDGE #53-2080 OVER 60 FRWY & PHILLIPS RANCH RD	G 5093
OTTERBEIN (1995)	0253.994 0833.312	DPW BM TAG IN W CB 300MM S/O BCR @ SW COR RIO RANCHO RD & COUNTRY MILE RD 22M S & 4.3M W/O C/L INT	G 5094
OTTERBEIN (1995)	0253.889 0832.967	RCE TAG #27366 IN E CB 300MM N/O BCR @ SE COR RIO RANCHO RD & COUNTRY MILE RD 16M S & 4.3M E/O C/L INT	G 5095
OTTERBEIN (1995)	0250.600 0822.177	MWD BR DISC IN S CB @ SW COR RIO RANCHO RD & MEADOW VIEW DR 18M W & 13M S/O C/L INT MKD (P.O.T. STA 460+50.28)	G 5096
OTTERBEIN (1995)	0250.722 0822.577	DPW BM TAG IN E CB 600MM N/O BCR @ NE COR RIO RANCHO RD & MEADOW VIEW DR 24M N & 7M E C/L INT	G 5097
OTTERBEIN (1995)	0245.141 0804.267	BR DISC IN S CB 17M E/O BCR @ SE COR RIO RANCHO RD & LONE RIDGE RD 36M E & 12.8M S/O C/L INT MKD (R.P. TO P.I.)	G 5098
OTTERBEIN (1995)	0245.121 0804.201	BR DISC IN N CB W END C B @ NE COR RIO RANCHO RD & LONE RIDGE RD 29M E & 14M N/O C/L INT MKD (YLF 109 1994)	G 5099

JAD-YEAR	ELEV METER/FOOT	D E S C R I P T I O N (INCLUDE QUAD AND YEAR IN DESCRIPTION)	BM NUMBER
OTTERBEIN (1995)	0244.681 0802.758	L&BR IN S CB 1.2M E/O BCR @ SE COR RIO RANCHO RD & AUTO CTR DR 30M E & 11.3M S/O C/L INT	G 5100
OTTERBEIN (1995)	0237.088 0777.846	L&BR IN S CB 5M W/O BCR @ SW COR RIO RANCHO RD & PARK AVE 15.5M W & 15M S/O C/L INT	G 5101
OTTERBEIN (1995)	0237.227 0778.302	L&BR IN E CB 11M N/O BCR @ NE COR RIO RANCHO RD & PARK AVE 26M N & 9.1M E/O C/L INT	G 5102
OTTERBEIN (1995)	0239.700 0786.416	FC TAG IN W CB 4M N/O BCR @ NW COR PARK AVE & LEXINGTON AVE 21M N & 9.1M W/O C/L INT	G 5103
OTTERBEIN (1995)	0239.056 0784.303	BR DISC IN S CB 1.8M W/O BCR @ SW COR WHITE AVE & LEXINGTON AVE 20M W & 5M S/O C/L INT	G 5104
OTTERBEIN (1995)	0239.169 0784.674	PK NAIL IN N CB @ BCR NW COR LEXINGTON AVE & WHITE AVE 21M W & 7M N/O C/L INT	G 5105
OTTERBEIN (1995)	0242.567 0795.822	PK NAIL IN E CB 600MM N/O BCR @ NE COR WHITE AVE & FRANKLIN AVE 16M N & 10.4M E/O C/L INT	G 5106
OTTERBEIN (1995)	0245.239 0804.588	PK NAIL IN S CB 1M W/O BCR @ SW COR WHITE AVE & PHILLIPS BLVD 23M W & 10M S/O C/L INT	G 5107
OTTERBEIN (1995)	0245.491 0805.415	BR DISC IN W CB N END C B 12M N/O BCR @ NW COR WHITE AVE & PHILLIPS BLVD 31M N & 11M W/O C/L INT MKD (YLF 107 1994)	G 5108
OTTERBEIN (1995)	0249.176 0817.505	PK NAIL IN S CB @ BCR SW COR WHITE AVE & GRAND AVE 21M W & 10.4M S/O C/L INT	G 5109
OTTERBEIN (1995)	0253.552 0831.862	BR DISC IN E CB 9M N/O BCR @ NE COR WHITE AVE & NINTH ST 27M N & 10.4M E/O C/L INT	G 5110
OTTERBEIN (1995)	0252.865 0829.608	SPK IN S CB 1.5M W/O BCR @ SW COR WHITE AVE & NINTH ST 22M W & 9.4M S/O C/L INT	G 5111
OTTERBEIN (1995)	0256.140 0840.353	PK NAIL IN N CB 7M W/O BCR @ NW COR WHITE AVE & MISSION BLVD 22M W & 10.4M N/O C/L INT	G 5112