

**COUNTY OF LOS ANGELES**

**ROAD DEPARTMENT**



**RIVERA QUAD**

**BENCH MARKS**

**1960**

## PREFACE

The Road Department level net is composed of more than 1,000 miles of levels supporting in excess of 10,000 bench marks. In 1964-65, a major readjustment of the net was undertaken. To emphasize the complete break with previous elevations, the SY, SG & SL series bench marks have been re-labeled BY, BG & BL, respectively.

To facilitate the adjustment, indexing, and distribution of adjusted values of the net, the County territory was divided into 31 quads or areas. For identification purposes each quad was given a name, viz., "Rosemead," "La Mirada," "Santa Fe," etc. When bench marks and elevations in the Road Department net are used, the name of the quad in which the bench mark is located and the date of the adjustment of the elevation must be included in the bench mark description, e.g.,

BG 1887 --L+BN IN CONC HDWL OF DRAIN PIPE UNDER DR 218 FT  
NE +18 FT SE C/L INT SAN JOSE HILLS RD +CAMERON AVE MKD (BM)  
(COVINA --1965) ELEV. 696.238

It is expected that this general adjustment will, for the most part, remain sound for the next 8 to 12 years. As new circuits are completed, however, re-adjustment of individual quads may become advisable. It is expected that these subsequent adjustments will be in the nature of a few hundredths of a foot. When a quad is re-adjusted, new elevation lists will be published and the date of the re-adjustment will replace the "1965" at the end of the bench mark description. Two bench marks in the same quad with different adjustment dates will not normally join each other. Since all adjustments taper out to nothing at the periphery of the quad, any bench mark in one quad will join any bench mark in another quad regardless of their respective adjustment dates.

The basic accuracy of the net is reflected by an indicated field probable error of plus or minus 0.012 foot per mile of leveling as determined from 298 conditions of closure. However, many years experience in vertical control in the greater Los Angeles basin and Antelope Valley indicate that because of varying degrees of subsidence and heaving, the true datum is recovered only by obtaining substantial agreement of a number of bench marks.

The users of this net are invited to assist in its maintenance by notifying this Department of cases of obliteration, apparent mistakes in descriptions or elevations, and proven disturbance of bench marks.

---

DATUM: U. S. Coast and Geodetic Survey Sea Level Datum  
of 1929, through the medium of the Los Angeles  
County Engineer Precise Level Net, 1963 Adjust-  
ment.

## Abbreviations Used in Bench Mark Listings

ABUT--Abutment	L+BN--Lead and Bench Mark Nail
ANG PT--Angle Point	L+BR--Lead and Brad
BC--Beginning of Curve	L+N--Lead and Nail
BCR--Beginning of Curb Return	L+PK--Lead and PK Nail
BLDG--Building	L+SPK--Lead and Spike
BT SPK--Boat or Bolt Spike	L+T--Lead and Tack
CB RET--Curb Return	MCR--Middle of Curb Return
C/L INT--Center Line Intersection	MKD--Marked
C/L PROD--Center Line Produced	NR--Near
COE--Corps of Engineers	OPP--Opposite
CONC--Concrete	PI--Point of Intersection
CS MON--County Surveyor Monument	PK+W--PK Nail and Washer
CS BR CAP--County Surveyor Brass Cap Monument	P/L--Property Line
CT SPK--Cut Spike	P O S T--Point on Semi-tangent
CTR--Center	PP--Power Pole
DN--Down	PVMT--Pavement
DR--Driveway	R D--Road Department
EC--End of Curve	RDBM--Road Department Bench Mark
ENT--Entrance	RR--Railroad
FC--Flood Control (Dept. LA County)	SPK T+W--Spike, Tin and Washer
FTG--Footing	USC+GS--United States Coast and Geodetic Survey
HDWL--Headwall	USGS--United States Geological Survey
HSE--House	WK--Walk
IP--Iron Pipe	±--Plus or Minus
LACE--Los Angeles City Engineer	+--And

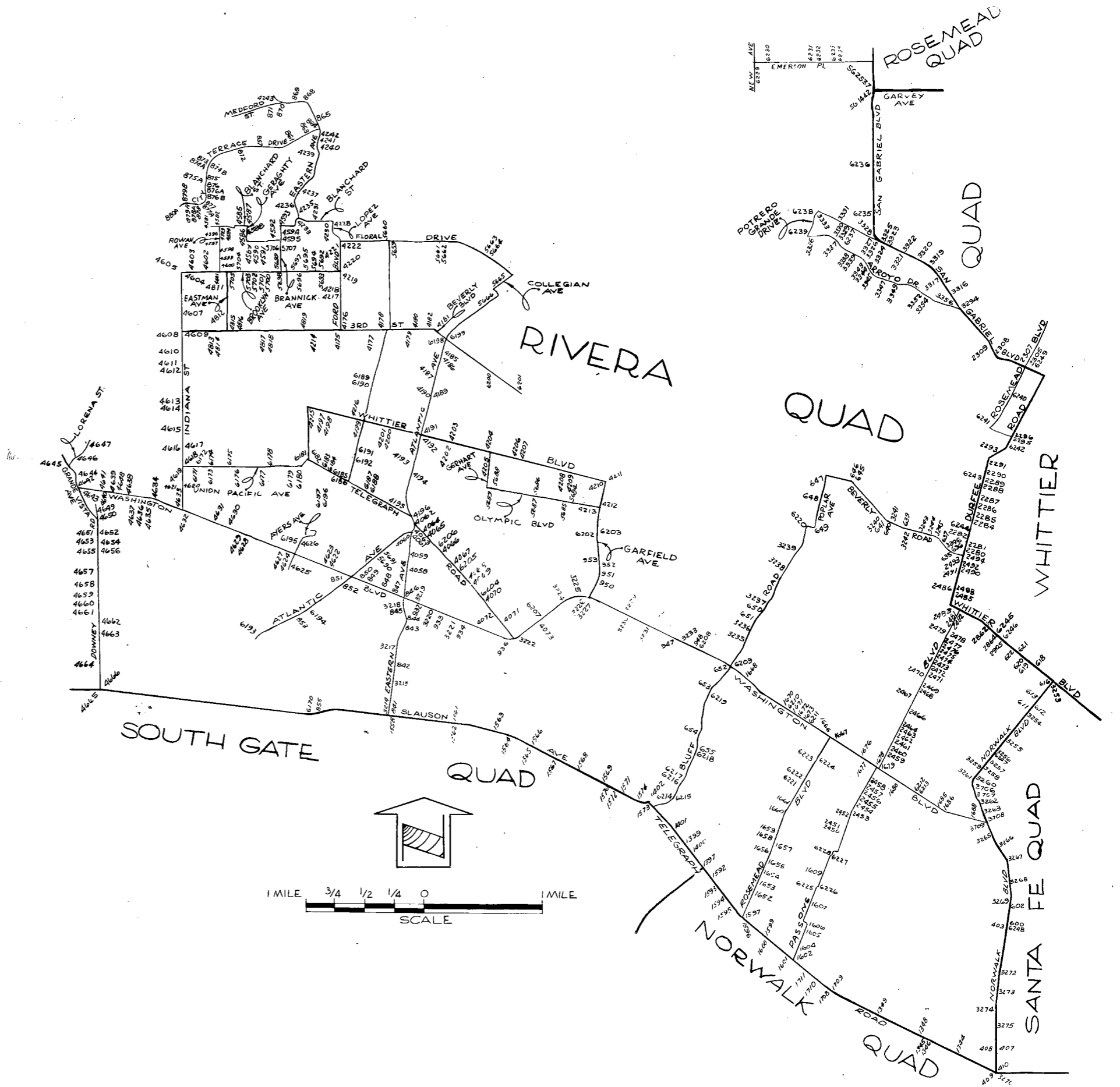

QUAD-YEAR	ELEV	DESCRIPTION (INCLUDE QUAD AND YEAR IN DESCRIPTION)	BM NUMBER
BASELINE (1955)	271.710	CS MON IN WELL 23FT S C/L GARVEY AVE + 14FT W C/L SAN GABRIEL BLVD	SG 1442
BASELINE (1955)	276.063	FC BR CAP IN W WINGWALL 73FT N C/L GARVEY AVE + 225FT W C/L SAN GABRIEL BLVD MKD (BM 55-24)	SG 2537
BASELINE (1955)	143.270	CUT SPK N END CULV HDWL 16FT E C/L NORWALK BLVD + 720FT N C/L TELEGRAPH RD	SY 407A
BASELINE (1955)	143.193	CUT SPK S END CULV HDWL 15FT W C/L NORWALK BLVD + 900FT N TELEGRAPH RD	SY 408A
BASELINE (1955)	169.992	L+SPK CTR OF WK 3FT E FLAGPOLE @ WEST WHITTIER SCHOOL 51FT W C/L NORWALK BLVD + 250FT N C/L BEXLEY DR	SY 611
BASELINE (1955)	169.853	L+T N CB 13FT N C/L LOCH LOMOND DR + 60FT E C/L NORWALK BLVD	SY 612A
BASELINE (1955)	170.153	L+T W CB 3FT N BCR @ NW COR LOCH AVON DR TO THE W + NORWALK BLVD 28FT W + 42FT N C/L INT	SY 613A
BASELINE (1955)	176.255	L+T E CB 1FT N BCR @ NE COR WHITTIER BLVD + MCNEES AVE 15FT E + 52FT N C/L INT	SY 618
BASELINE (1955)	175.699	L+T S CB WHITTIER BLVD 28FT S C/L + ON C/L PROD REDMAN AVE TO THE N	SY 619
RIVERA (1960)	183.599	L+N S CB BEVERLY RD 35FT S PI NR OLYMPIC BLVD	SY 635
RIVERA (1960)	184.946	L+SPK 5FT W BCR BEVERLY RD 122FT W C/L OLYMPIC BLVD	SY 636
RIVERA (1960)	183.063	L+T PI 150FT E INT ROSEMEAD BLVD + BEVERLY RD	SY 637
RIVERA (1960)	179.696	S L+T OF 2 @ PI E OF INT LEXINGTON RD + BEVERLY RD	SY 639
RIVERA (1960)	178.894	L+T PI 11FT S C/L BEVERLY RD 100FT W HOOVER DAM POWER LINE	SY 640
RIVERA (1960)	178.095	L+T CONC PVMT ON C/L PINE ST 19FT S C/L BEVERLY RD	SY 641
RIVERA (1960)	205.878	L+BN E CB 1FT N BCR @ NE COR BEVERLY BLVD + RD LEADING TO (GRANT REA MEMORIAL PARK) 75FT N + 20FT E C/L INT MKD (BM)	SY 645A
RIVERA (1960)	205.984	CS MON N CB @ ANG PT OF ROAD DIVIDER LEADING TO (GRANT REA MEMORIAL PARK) 49FT N OF N CB BEVERLY BLVD + 85FT W OF W EDGE OF BRIDGE NO B 976 MKD (BM 51 10 A 1961)	SY 646A
RIVERA (1960)	207.441	L+N E CB POPLAR AVE NR S END BCR @ SE COR BEVERLY RD + POPLAR AVE	SY 647A
RIVERA (1960)	210.391	L+T 3FT W BCR @ NW COR POPLAR AVE + WASHINGTON AVE	SY 648A
RIVERA (1960)	209.062	L+N 1FT W BCR @ NW COR WHITTIER BLVD + 1ST ST	SY 649A
RIVERA (1960)	207.735	L+N W CB FRONT OF HSE NO 637 BLUFF RD	SY 650
RIVERA (1960)	205.367	L+T NR S END BCR @ SW COR HUGHES AVE + BLUFF RD	SY 651

QUAD-YEAR	ELEV	DESCRIPTION (INCLUDE QUAD AND YEAR IN DESCRIPTION)	BM NUMBER
RIVERA (1960)	190.220	L+N SW COR RIO HONDO BRIDGE @ WASHINGTON BLVD + BLUFF RD	SY 652
RIVERA (1960)	178.724	L+N 1FT N CATCH BASIN W SIDE BLUFF RD NR HSE NO 1217	SY 653
RIVERA (1960)	173.025	L+N 1FT N CATCH BASIN W SIDE BLUFF RD NR HSE NO 1425	SY 654
RIVERA (1960)	164.483	L+N SW COR SIGNAL BASE ON S SIDE AT+SFRR E SIDE OF BLUFF RD 100FT S C/L SCYMORE AVE	SY 655
RIVERA (1960)	138.071	L+N E CB EASTERN AVE 30FT N OF N LINE CONSOLIDATED STEEL CO NR S END CB 15FT JCT RR	SY 842
RIVERA (1960)	143.221	L+N 1FT FROM S END E CB ON EASTERN AVE 35FT N C/L AT+SFRR (MAIN LINE) NR 26TH ST	SY 843
RIVERA (1960)	139.614	L+T NR CTR CB RET @ NE COR EASTERN AVE + EASTLAND AVE 12FT S OF N END BCR	SY 844
RIVERA (1960)	138.887	L+T E CB EASTERN AVE 4FT S BCR @ SE COR SHEILA ST + EASTERN AVE	SY 845
RIVERA (1960)	139.782	L+T NR CTR CB RET @ NE COR WASHINGTON BLVD + EASTERN AVE	SY 846A
RIVERA (1960)	140.466	L+T NR CTR CB RET @ SE COR WASHINGTON BLVD + FITZGERALD ST	SY 847
RIVERA (1960)	141.455	L+N N CB NR E END BCR @ NE COR O NEIL AVE + WASHINGTON BLVD	SY 848A
RIVERA (1960)	143.119	CUT SPK E CB 5FT N BCR @ NE COR STRONG AVE + WASHINGTON BLVD	SY 849
RIVERA (1960)	144.617	CUT SPK E CB 5FT N BCR @ NE COR WILMA AVE + WASHINGTON BLVD	SY 850
RIVERA (1960)	146.400	L+T S CB 70FT W BCR @ SW COR WASHINGTON BLVD + ATLANTIC BLVD 40FT S + 160FT W C/L INT	SY 851A
RIVERA (1960)	146.341	L+T N CB 6FT FROM BCR @ NW COR ATLANTIC BLVD + SHEILA ST	SY 852A
RIVERA (1960)	149.093	L+T NR BCR @ SE COR ATLANTIC BLVD + BANDINI BLVD 100FT E + 35FT S C/L INT	SY 853A
BASELINE (1955)	158.084	U S E D L+N W END N HDWL LA RIVER BRIDGE ON SLAUSON AVE	SY 855A
RIVERA (1960)	430.711	L+N 25FT N BCR @ NE COR CARMELITA AVE + CITY TERRACE DR	SY 861
RIVERA (1960)	447.043	L+N 20FT N BCR @ NE COR MCGILVREY AVE + CITY TERRACE DR	SY 863
RIVERA (1960)	443.864	L+TW CB 5FT N BCR @ SW COR EASTERN AVE + ROGERS ST 31FT W + 30FT S C/L INT	SY 865A
RIVERA (1960)	447.737	L+N 1FT E BCR @ NE COR TIM AVE + EASTERN AVE + S OF BARNETT RD	SY 868
RIVERA (1960)	423.810	L+N @ BCR @ NW COR EASTERN AVE + LANSDOWNE AVE	SY 869
RIVERA (1960)	413.433	L+T S CB 11FT E BCR @ SE COR EASTERN AVE + MEDFORD ST 35FT S + 45FT E C/L INT	SY 870A

QUAD-YEAR	ELEV	D E S C R I P T I O N (INCLUDE QUAD AND YEAR IN DESCRIPTION)	BM NUMBER
RIVERA (1960)	400.719	L+N CONC WK 47FT S OF S CB MEDFORD ST + 33FT E OF E CB MILLER AVE	SY 871
RIVERA (1960)	424.217	L+N CONC WALK 21FT S BCR @ SW COR HERBERT AVE + RAMONA BLVD	SY 872
RIVERA (1960)	399.689	R D MON IN WELL C/L INT ROWAN AVE + CITY TERRACE DR	SY 873A
RIVERA (1960)	403.377	L+T E CB CITY TERRACE DR @ C/L PROCD MARENGO ST	SY 874A
RIVERA (1960)	402.967	R D MON IN WELL C/L INT MARENGO ST + CITY TERRACE DR	SY 874B
RIVERA (1960)	419.928	L+N 20FT E BCR N CB RAMBOZ DR + CITY TERRACE DR	SY 875
RIVERA (1960)	415.162	R D MON IN WELL C/L INT RAMBOZ DR + CITY TERRACE DR	SY 875A
RIVERA (1960)	441.761	L+N NE CB TRIANGULAR ISLAND 20FT E BCR POMEROY ST + CITY TERRACE DR	SY 876
RIVERA (1960)	439.710	R D MON IN WELL C/L INT POMEROY ST + CITY TERRACE DR	SY 876A
RIVERA (1960)	440.073	R D MON IN WELL C/L INT MEISNER ST + CITY TERRACE DR	SY 876B
RIVERA (1960)	426.540	L+N N CB TOWNSEND AVE 70FT E C/L CITY TERRACE DR	SY 877
RIVERA (1960)	423.090	R D MON IN WELL P O S T TOWNSEND AVE + CITY TERRACE DR	SY 877A
RIVERA (1960)	415.678	L+N E CB OF N DITMAN AVE 20FT S BCR @ SE COR DITMAN AVE + CITY TERRACE DR	SY 878
RIVERA (1960)	419.066	R D MON IN WELL P O S T DITMAN AVE + CITY TERRACE DR	SY 878A
RIVERA (1960)	420.660	L+T CONC WK FRONT OF STORE N SIDE CITY TERRACE DR NO 3259 45FT N C/L CITY TERRACE DR @ HICKS ST	SY 879A
RIVERA (1960)	416.958	R D MON IN WELL P O S T @ HICKS ST + CITY TERRACE DR	SY 879B
RIVERA (1960)	409.483	R D MON IN WELL P O S T @ DOBINSON ST + CITY TERRACE DR	SY 880A
RIVERA (1960)	138.026	L+T 2FT NW MARKER @ SW COR EASTLAND AVE + WASHINGTON BLVD	SY 932
RIVERA (1960)	140.002	L+N 4FT NW MARKER @ SW COR ELKGROVE AVE + WASHINGTON BLVD	SY 933
RIVERA (1960)	143.177	L+SPK 5FT W BCR @ SW COR FIDELIA AVE + WASHINGTON BLVD	SY 934A
RIVERA (1960)	147.994	LACE TAG IN W CB OF TRIANGLE SHAPED ISLAND @ SW COR TELEGRAPH RD + WASHINGTON BLVD 63FT S + 56FT W C/L INT	SY 936A
RIVERA (1960)	185.750	L+T CTR CB RET @ SW COR GREENWOOD AVE + WASHINGTON BLVD	SY 947

QUAD-YEAR	ELEV	DESCRIPTION (INCLUDE QUAD AND YEAR IN DESCRIPTION)	BM NUMBER
RIVERA (1960)	190.259	L+T W SIDE CONC DRWY FRONT HSE NO 800 WASHINGTON BLVD 40FT N C/L @ NW COR WASHINGTON BLVD + MONTEBELLO BLVD	SY 948
RIVERA (1960)	172.324	L+BN E CB GARFIELD AVE 2FT N MC 2100FT S C/L FERGUSON DR	SY 950A
RIVERA (1960)	172.015	R D MON IN WELL 8IN DN POST 318FT S BC 25FT E C/L GARFIELD AVE 1924FT S C/L FERGUSON DR	SY 951A
RIVERA (1960)	173.986	RDBM TAG @ SE COR GARFIELD AVE + FLOTILLA ST 30FT S + 81FT W C/L INT 6FT E BCR	SY 952A
RIVERA (1960)	173.982	RDBM TAG @NW COR GARFIELD AVE + FLOTILLA ST 2FT N ANG PT @ BCR 40FT W + 75FT N C/L INT	SY 953A
BASELINE (1955)	131.842	RDBM TAG IN S CB TELEGRAPH RD 2FT# W/O SW CB RET @ MIAN DRWY TO SANTA FE SPRINGS FIRE STA BLDG NO 11736 40FT# S/O C/L TELEGRAPH RD + 390FT# W/O C/L PIONEER BLVD	SY 1345A
BASELINE (1955)	131.198	L+BN 6IN CONC RETAINING WALL 55FT# S C/L TELEGRAPH RD 300FT# W C/L PIONEER BLVD	SY 1346A
BASELINE (1955)	132.177	CS MON IN WELL @ C/L INT TELEGRAPH RD + ALBURTIS AVE NLY MKD (LACS CON SYS TRA STA WHITTIER B-7 RE2177 1941)	SY 1348A
BASELINE (1955)	133.241	L+T NEAR CTR CB RT @ NE COR TELEGRAPH RD + ORR + DAY RD	SY 1349A
BASELINE (1955)	133.111	RDBM TAG IN W CB 1FT# S BCR 68FT# S + 38FT# W C/L INT TELEGRAPH RD + ORR + DAY RD	SY 1350A
BASELINE (1955)	142.240	CS MON IN WELL 8IN DN ON C/L TELEGRAPH RD 20FT# WLY C/L PARAMOUNT BLVD MKD (BELL K4 1941)	SY 1397A
BASELINE (1955)	143.927	RAM NAIL IN N CB TELEGRAPH RD 16FT# E/O CB END 38FT# N/O C/L TELEGRAPH RD + 110FT# W/O C/L CRIDER AVE	SY 1400A
BASELINE (1955)	145.817	RAM SET NAIL IN CONC ISLAND @ CTR OF DRWY TO KAYNAR CO BLDG 7875 42FT# N OF C/L TELEGRAPH RD + 4IN# E OF C/L INT SLAUSON AVE + TELEGRAPH RD 300FT# E OF E END BRIDGE 53-212 OVER RIO HONDO	SY 1401A
BASELINE (1955)	151.909	L+T IN N CB TELEGRAPH RD 4FT# E OF CB RET @ NE COR SLAUSON AVE 40 FT# N + 105FT#E OF C/L INT	SY 1402A
BASELINE (1955)	135.775	L+T CTR CB RET SE COR EASTERN AVE + SLAUSON AVE	SY 1558
BASELINE (1955)	140.217	L+T N CB SLAUSON AVE @ WLY END OF CURVE 42FT# N C/L SLAUSON AVE + 300FT# E BOXFORD AVE	SY 1561A
BASELINE (1955)	140.294	L+T CONC WK TO (THOR POWER TOOL CO) OFFICE BLDG NO 6200 48FT# S C/L SLAUSON AVE @ WLY END CURVE 300FT# E BOXFORD AVE	SY 1562A
BASELINE (1955)	142.545	L+LS 1742 TAG W CB MALT AVE 1FT# N CB RET @ NW COR SLAUSON AVE 50FT# S + 26FT# W C/L INT	SY 1563A
BASELINE (1955)	146.107	L+T S CB SLAUSON AVE @ WLY END OF CURVE 38FT# S C/L SLAUSON AVE + 620FT# E MALT AVE	SY 1564A
BASELINE (1955)	148.466	L+T 3FT# E CTR CB RET @ SE COR SLAUSON AVE + GARFIELD AVE 41FT# S + 53FT# E C/L INT	SY 1565



QUAD-YEAR	ELEV	DESCRIPTION (INCLUDE QUAD AND YEAR IN DESCRIPTION)	BM NUMBER
BASELINE (1955)	148.687	L+T N CB SLAUSON AVE 2FT± E CB RET @ NE COR GARFIELD AVE 38FT± N + 65FT± E C/L INT	SY 1566
BASELINE (1955)	152.781	L+BN S CB SLAUSON AVE 3FT± N PP NO 666256E ON LINE W/CHAIN LINK FENCE @ ELY P/L APEX STEEL CO 0.4MI± E GARFIELD AVE	SY 1567A
BASELINE (1955)	159.464	L+T RETAINING WALL N SIDE SLAUSON AVE FRONT OLIVE MEMORIAL PK 50FT± N C/L SLAUSON AVE 5FT± W OF E P/L OF PARK	SY 1568
BASELINE (1955)	158.337	RD MON IN WELL W/COVER ON C/L SLAUSON AVE 25FT± W C/L GREENWOOD AVE	SY 1569
BASELINE (1955)	159.426	L+T S CB 3FT± E BCR @ SE COR SLAUSON AVE + GREENWOOD AVE	SY 1570
BASELINE (1955)	158.115	CS MON IN WELL C/L INT TODD AVE + SLAUSON AVE	SY 1571
BASELINE (1955)	159.148	L+BN 5FT± S BCR @ SW COR TODD AVE + SLAUSON AVE	SY 1572
BASELINE (1955)	152.510	L+T IN S CB TELEGRAPH RD 5FT6IN± E/O CB RET @ SE COR SLAUSON AV 40FT± S + 48FT± E OF C/L INT	SY 1573A
BASELINE (1955)	157.196	TOP RD MON IN WELL C/L INT GAGE AVE + SLAUSON AVE	SY 1574A
BASELINE (1955)	140.657	L+T 1FT± E BCR @ NE COR FERNADEL ST + TELEGRAPH RD (IN SERVICE RD CB)	SY 1592
BASELINE (1955)	142.851	L+BN 4FT± S BCR @ SW COR BIRCHBARK AVE + TELEGRAPH RD	SY 1593
BASELINE (1955)	145.227	L+BN 4FT± S BCR @ SW COR STAMPS RD + TELEGRAPH RD	SY 1594
BASELINE (1955)	142.440	L+BN 30FT± S BCR @ SW COR STOAKES AVE + TELEGRAPH RD	SY 1595
BASELINE (1955)	138.869	RAM SET CTR CB RET SE COR LAKEWOOD BLVD + TELEGRAPH RD 55FT± S + 55FT± E C/L INT	SY 1596
BASELINE (1955)	138.066	CS MON MKD (LACO SUR CONT SUST TRA STA BELL K-5A RE2177 1941) IN WELL W/COVER @ CL INT TELEGRAPH RD + LAKEWOOD BLVD	SY 1597A
BASELINE (1955)	138.724	L+T S END W GAS ISLAND NE COR TELEGRAPH RD + SERAPIS AVE	SY 1599A
BASELINE (1955)	137.421	L+T IN S CB TELEGRAPH RD 6FT± W/O CB RET @ SE COR SERAPIS AVE 40FT± S + 50FT± E/O C/L INT	SY 1600/
BASELINE (1955)	141.486	L+BN 1FT FROM BCR SERVICE RD N CB @ PASSONS BLVD + TELEGRAPH RD 50FT± S C/L TELEGRAPH RD	SY 1601/
BASELINE (1955)	140.274	CS MON IN WELL @ C/L INT TELEGRAPH RD + PASSONS BLVD MKD (LA CO SUR CONT SYST TRA STA BELL 1-6 RE 2177 1941)	SY 1602
RIVERA (1960)	142.159	L+BN 1FT N BCR @ NE COR CLAYMORE ST + PASSONS BLVD	SY 1604
RIVERA (1960)	146.377	L+BN 2FT N BCR @ NE COR SUNGLOW ST + PASSONS BLVD	SY 1605
RIVERA (1960)	146.914	L+BN 1FT N BCR @ NE COR PASSONS BLVD FRONT HSE NO 8430 PASSONS BLVD	SY 1606

QUAD-YEAR	ELEV	DESCRIPTION (INCLUDE QUAD AND YEAR IN DESCRIPTION)	BM NUMBER
RIVERA (1960)	148.512	L+BN 1FT N BCR @ NE COR PASSONS BLVD + LA DOCEÑA LANE	SY 1607
RIVERA (1960)	147.852	L+BN 1FT W BCR @ NW COR MYRON ST + PASSONS BLVD	SY 1609
RIVERA (1960)	142.148	RAM SET CTR CB RET @ NE COR TERRADELL AVE + ROSEMEAD BLVD	SY 1652
RIVERA (1960)	143.453	RAM SET 5FT S CTR CB RET @ SE COR MAXINE AVE + ROSEMEAD BLVD	SY 1653
RIVERA (1960)	145.348	RAM SET E CB ROSEMEAD BLVD 45FT S C/L SHADE LANE	SY 1654
RIVERA (1960)	146.758	L+BN 1FT E BCR @ NE COR AERO DR + ROSEMEAD BLVD	SY 1655
RIVERA (1960)	150.698	L+BN SE COR GAS CO VALVE BOX 45FT N C/L PERR W SIDE ROSEMEAD BLVD (PE LA HABRA LINE)	SY 1656
RIVERA (1960)	149.495	RAM SET W CB ROSEMEAD BLVD 30FT S C/L PROD BURKE ST	SY 1657
RIVERA (1960)	149.917	L+T SW CB RET 15FT N BCR @ SW COR SLAUSON AVE + ROSEMEAD BLVD 50FT S+ 40FT W C/L INT	SY 1658A
RIVERA (1960)	150.020	L+T NW CB RET 12FT E BCR @ NW COR SLAUSON AVE + ROSEMEAD BLVD 40FT N + 50FT W C/L INT	SY 1659A
RIVERA (1960)	151.543	L+BN S END W RETAINING WALL SANTA FE RR BRIDGE 75 FT N HSE NO 7679 ON ROSEMEAD BLVD	SY 1660
RIVERA (1960)	156.382	SPK SW COR CONC SPILLWAY OF UNDERPASS DRAIN PUMP NW SIDE SFRR UNDERPASS @ ROSEMEAD BLVD	SY 1661
RIVERA (1960)	161.308	RDBM TAG N CB 50FT W BCR @ NW COR ROSEMEAD BLVD + WASHINGTON BLVD 38FT N + 120FT W C/L INT	SY 1666A
RIVERA (1960)	161.391	RDBM TAG E CB 30FT N BCR @ NE COR ROSEMEAD BLVD + WASHINGTON BLVD 108FT N + 40FT E C/L INT	SY 1667A
RIVERA (1960)	172.938	FC COPPER DISC TOP CONC ABUT @ NE COR BRIDGE NO 799 OVER TH RIO HONDD RIV 27FT N C/L WASHINGTON BLVD + 512FT E C/L BLUFF RD MKD (BM 53 40)	SY 1668
RIVERA (1960)	161.316	L+BN N CB 1FT W BCR @ NW COR PARAMOUNT BLVD + WASHINGTON BLVD 45FT N + 70FT W C/L INT	SY 1670A
RIVERA (1960)	161.529	L+BN N CB 1FT E BCR @ NE COR CANDACE AVE + WASHINGTON BLVD 38FT N + 41FT E C/L INT	SY 1671
RIVERA (1960)	162.117	L+BN N CB 1FT W BCR @ NW COR BOLLINGBACKER DR + WASHINGTON BLVD 38FT N + 51FT W C/L INT	SY 1672
RIVERA (1960)	161.725	L+T W CB 2FT N BCR @ NW COR CROSSWAY DR + WASHINGTON BLVD 73FT N + 16FT W C/L INT	SY 1673A
RIVERA (1960)	161.064	L+BN N CB 1FT E BCR @ NE COR LINDSEY AVE + WASHINGTON BLVD 38FT N + 56FT E C/L INT	SY 1676
RIVERA (1960)	160.485	L+T CTR ISLAND CB RET @ SW COR KILGARRY AVE + WASHINGTON BLVD 45FT S + 28FT W C/L INT	SY 1677
RIVERA (1960)	160.384	RDBM TAG N CB 1FT W BCR @ NW COR PASSONS BLVD + WASHINGTON BLVD 38FT N + 18FT W C/L INT	SY 1678A

QUAD-YEAR	ELEV	DESCRIPTION (INCLUDE QUAD AND YEAR IN DESCRIPTION)	BM NUMBER
RIVERA (1960)	159.922	RDBM TAG N CB 1FT E BCR @ NE COR PASSONS BLVD + WASHINGTON BLVD 38FT N + 120FT E C/L INT	SY 1679A
RIVERA (1960)	158.211	L+T S CB 1FT W BCR @ SW COR WASHINGTON BLVD + HASTY AVE 38FT S + 35FT W C/L INT MKD (SY 1680)	SY 1680
RIVERA (1960)	158.376	L+BN 1FT E BCR @ NE COR WASHINGTON BLVD + PIIONEER BLVD 35FT N + 75FT E C/L INT	SY 1686
RIVERA (1960)	157.621	L+BN 1FT E BCR @ NE COR WASHINGTON BLVD + MORRILL AVE 35FT N + 51FT E C/L INT	SY 1688
BASELINE (1955)	138.596	L+B W ECR @ SW COR TRUE AVE + TELEGRAPH RD (SERVICE RD)	SY 1708A
BASELINE (1955)	137.695	CS BR CAP CONC MDN IN CASING + COVER PI 6.82FT E C/L INT TRUE AVE + TELEGRAPH RD	SY 1709
BASELINE (1955)	140.164	L+BN 1FT± E ECR SERVICE RD N CB NE COR SONGFEST DR + TELEGRAPH RD	SY 1710
BASELINE (1955)	140.524	L+T 2FT± S BCR @ SW COR HASTY AVE + TELEGRAPH RD	SY 1711
BASELINE (1955)	183.690	L+SPK S CB 7FT E BCR @ SE COR BARTOLO AVE + DURFEE AVE 15FT S + 63FT E C/L INT	SY 2280
BASELINE (1955)	184.179	L+T W CB 4FT N BCR @ NW COR DURFEE AVE + FIRST ALLEY N BARTOLO AVE TO THE E 20FT W + 184FT N C/L INT DURFEE AVE + BARTOLO AVE	SY 2281
BASELINE (1955)	185.463	L+BN W CB DURFEE AVE 20FT W C/L 35FT N DRWY TO HSE NO 4503 + 400FT S BEVERLY BLVD	SY 2282A
BASELINE (1955)	187.218	L+BN E CB 15FT N BCR @ NE COR BEVERLY BLVD + DURFEE AVE 20FT E + 100FT N C/L INT	SY 2284
BASELINE (1955)	188.946	L+BN S CB 2FT E BCR @ SE COR TILMONT ST + DURFEE AVE 15FT S + 48FT E C/L INT	SY 2285
BASELINE (1955)	190.624	SPK N END FIRST STEP HSE NO 4252 60FT E + 40FT N C/L INT DURFEE AVE + DORK ST	SY 2286A
BASELINE (1955)	191.022	L+T E CB 2FT N BCR @ NE COR HARRELL AVE + DURFEE AVE 20FT E + 48FT N C/L INT	SY 2287A
BASELINE (1955)	192.600	L+T CTR CB RET @ NE COR DURFEE AVE + BANTA RD 26FT N + 28FT E C/L INT	SY 2288A
BASELINE (1955)	193.389	L+T E CB 28FT E C/L DURFEE AVE + 18FT S C/L PROD ISORA ST	SY 2289A
BASELINE (1955)	196.057	L+T 1FT FROM NW COR CONC DRWY HSE NO 3918 35FT E + 40FT S C/L INT GALLATIN RD + DURFEE AVE	SY 2290A
BASELINE (1955)	195.074	L+T CTR CONC WK TO HSE 3860 DURFEE AVE 68FT E + 30FT N C/L INT FRIENDSHIP AVE + DURFEE AVE	SY 2291A
BASELINE (1955)	195.967	L+T NR CTR CONC DRWY TO HSE NO 3754 DURFEE AVE 53FT E C/L DURFEE AVE + 6FT E BEG OF DRWY	SY 2293A
BASELINE (1955)	195.060	L+T CONC FOUNDATION OF SW LEG BP+L TOWER NO 253D4 73FT E C/L DURFEE AVE + 93FT N C/L KRUSE RD	SY 2295A
BASELINE (1955)	195.042	BR CAP IN CONC 4IN UP 6FT NE OF SW LEG OF BP+L TOWER NO 253D4 75FT E C/L DURFEE AVE + 95FT N C/L KRUSE RD MKD (U S E D WN 31949)	SY 2296A

QUAD-YEAR	ELEV	DESCRIPTION (INCLUDE QUAD AND YEAR IN DESCRIPTION)	BM NUMBER
BASELINE (1955)	206.326	RDBM TAG NR E END OF CULV HDWL @ NE COR SAN GABRIEL BLVD + ROSEMEAD BLVD 35FT N + 95FT E C/L INT	SY 2305A
BASELINE (1955)	202.050	L+SPK NR CTR HDWL UNDER EDISON TOWER NO M3T5 40FT N C/L SAN GABRIEL BLVD + 350FT W C/L ROSEMEAD BLVD	SY 2307A
BASELINE (1955)	206.774	FLT HD SPK 3FT E OF W END OF ABANDONED OIL WELL PUMP BASE 43FT NE C/L SAN GABRIEL BLVD + 355FT SE LINCOLN AVE	SY 2308A
BASELINE (1955)	218.033	L+BR CONC WK TO (SITE OF MISSION VIEJA) HISTORICAL MON 85FT NW C/L LINCOLN AVE + 33FT SW C/L SAN GABRIEL BLVD	SY 2309A
RIVERA (1960)	154.026	L+BN W CB PASSONS BLVD 2FT N OF N EDGE OF DRWY HSE NO 7525	SY 2450A
RIVERA (1960)	154.378	L+TW CB PASSONS BLVD 1FT N OF N EDGE DRWY TO HSE NO 7503 24FT S OF END OF CB	SY 2451
RIVERA (1960)	154.879	L+T CTR CB RET @ NE COR PASSONS BLVD + REX AVE	SY 2452
RIVERA (1960)	155.939	L+T E CB PASSONS BLVD 3FT N OF S P/L HSE NO 7276 @ SPLIT OF ANG PT OF PI 3FT N PP NO 784138E	SY 2453
RIVERA (1960)	156.635	L+T E CB 4FT S BCR @ SE COR FOXBURY WAY + PASSONS BLVD	SY 2454
RIVERA (1960)	157.470	L+T E CB PASSONS BLVD 1FT N OF N EDGE DRWY HSE NO 7202 30FT S C/L PROD DANBRIDGE ST	SY 2455
RIVERA (1960)	158.493	L+T CTR CB RET @ NE COR PASSONS BLVD + BERT ST	SY 2456
RIVERA (1960)	158.853	L+T CTR CB RET @ NE COR PASSONS BLVD + NAN ST	SY 2457
RIVERA (1960)	159.200	L+T E CB 2FT S BCR @ SE COR LOCHINVAR ST + PASSONS BLVD	SY 2458
RIVERA (1960)	162.507	L+T E CB 1FT N ECR @ NE COR PASSONS BLVD + GOODBEE ST	SY 2459
RIVERA (1960)	163.103	L+T E CB 1FT N BCR @ NE COR PASSONS BLVD + HAMPLER ST	SY 2460
RIVERA (1960)	163.739	L+T E CB 6FT N BCR @ NE COR PASSONS BLVD + CARRON DR	SY 2461
RIVERA (1960)	164.017	L+T E CB 1FT N BCR @ NE COR PASSONS BLVD + HOMEBROOK ST	SY 2462
RIVERA (1960)	164.165	L+T N CB 1FT E ECR @ NE COR PASSONS BLVD + HANEY ST	SY 2463
RIVERA (1960)	164.727	L+T N CB 2FT E BCR @ NE COR PASSONS BLVD + MARJORIE ST	SY 2464
RIVERA (1960)	166.272	L+T CTR CB RET @ NE COR PASSONS BLVD + BALFOUR ST	SY 2466
RIVERA (1960)	167.721	L+T W CB 1FT N ECR @ SW COR PASSONS BLVD + COSGROVE ST	SY 2467

QUAD-YEAR	ELEV	DESCRIPTION (INCLUDE QUAD AND YEAR IN DESCRIPTION)	BM NUMBER
RIVERA (1960)	168.888	L+T E CR @ BCR NE COR PASSONS BLVD + DUNLAP CROSSING RD	SY 2468
RIVERA (1960)	169.555	L+T 12FT S BCR @ NE COR PASSONS BLVD + ALDRICH ST	SY 2469
RIVERA (1960)	171.294	L+T W CB 2FT N BCR @ NW COR PASSONS BLVD + ROSE HEDGE DR	SY 2470
RIVERA (1960)	172.022	L+T E CB PASSONS BLVD ON C/L PROD REICHLING LANE	SY 2471
RIVERA (1960)	173.146	L+T CTR CB RET @ SE COR PASSONS BLVD + TOWNLEY DR	SY 2472
RIVERA (1960)	173.983	L+BR CTR CB RET @ NE COR BEXLEY DR + PASSONS BLVD	SY 2473
RIVERA (1960)	174.550	L+BR CTR CB RET @ NE COR HAVENWOOD ST + PASSONS BLVD	SY 2474
RIVERA (1960)	175.362	L+BR CTR CB RET @ NE COR LOCH LOMOND DR + PASSONS BLVD	SY 2475
RIVERA (1960)	176.174	L+BR CTR CB RET @ NE COR LOCH AVON DR + PASSONS BLVD	SY 2476
RIVERA (1960)	177.006	L+BR CTR CB RET @ NE COR HOLBROOK ST + PASSONS BLVD	SY 2477
RIVERA (1960)	177.077	CS MON NR INT ALMO ST + PASSONS BLVD TO THE W 22FT N C/L INT GLENCANNON DR + PASSONS BLVD	SY 2478
RIVERA (1960)	177.630	L+T 12FT N BCR @ SW COR ALMO ST + PASSONS BLVD	SY 2479
BASELINE (1955)	179.319	L+SPK @ CTR CB RET @ SE COR PASSONS BLVD + WHITTIER BLVD MKD (BM 2B)	SY 2481
BASELINE (1955)	179.372	L+SPK S CB 2FT E BCR @ SE COR PASSONS BLVD + WHITTIER BLVD MKD (P145)	SY 2482
BASELINE (1955)	179.399	L+T CTR CB RET @ SW COR PASSONS BLVD + WHITTIER BLVD	SY 2483
BASELINE (1955)	178.152	CS MON 150FT N C/L INT DURFEE AVE + WHITTIER BLVD	SY 2485
BASELINE (1955)	178.779	L+SPK W CE 6FT N BCR @ NW COR DURFEE AVE + FIRST ALLEY N WHITTIER BLVD MKD (P 28)	SY 2486
BASELINE (1955)	179.643	L+SPK S CB 10FT W BCR @ SW COR DURFEE AVE + WEST BLVD TO THE W MKD (P 27)	SY 2488
BASELINE (1955)	181.880	L+SPK S CB 6FT E BCR @ SE COR DURFEE AVE + WALNUT AVE MKD (P 59)	SY 2490
BASELINE (1955)	182.804	CS MON @ C/L INT DURFEE AVE + OLYMPIC BLVD	SY 2491
BASELINE (1955)	182.856	L+SPK S CB 3FT E BCR @ SE COR DURFEE AVE + OLYMPIC BLVD MKD (P 60)	SY 2492
RIVERA (1960)	183.012	L+BN W CB 25FT S BCR @ SE COR DURFEE AVE + BEVERLY BLVD 5FT S OF S EDGE OF N DRWY TO MOBIL GAS STA NO 9254 E BEVERLY BLVD	SY 2493
BASELINE (1955)	176.666	L+BN N CB WHITTIER BLVD NR E SIDE (PICO PALACE SALES) BLDG NO 9561 30FT N C/L WHITTIER BLVD CB IS AROUND STREET LIGHT NO 65 FOUNDATION	SY 2862

QUAD-YEAR	ELEV	DESCRIPTION (INCLUDE QUAD AND YEAR IN DESCRIPTION)	BM NUMBER
BASELINE (1955)	181.731	L+N S CB @ SW COR BRIDGE NO 53 06 OVER SAN GABRIEL RIV 22FT S C/L WHITTIER BLVD + 550FT W SPRR BRIDGE OVER WHITTIER BLVD	SY 2864
BASELINE (1955)	181.379	L+BN NE COR CONC WALK @ SE COR WHITTIER BLVD BRIDGE ACROSS SAN GABRIEL RIVER	SY 2905
BASELINE (1955)	135.722	FC BR DISC 2FT± E OF E CB EASTERN AVE OPP THE END CB RET @ NE COR SLAUSON AVE + EASTERN AVE FLUSH W/MAC PKWY MKD (BM 5-130)	SY 3214
RIVERA (1960)	136.738	L+BN E CB EASTERN AVE 4FT W TP NO 404008H 1000FT N SLAUSON AVE	SY 3215
RIVERA (1960)	137.899	L+BN SE COR CONC CATCH BASIN C/L ENT TO HELI AIR FORCE ON EASTERN AVE 60FT W C/L + 800FT S SFATTR	SY 3217
RIVERA (1960)	139.616	L+T 20FT W BCR @ SE COR WASHINGTON BLVD + EASTERN AVE	SY 3218
RIVERA (1960)	139.043	L+T CTR CB RET @ SW COR DANIEL AVE + WASHINGTON BLVD	SY 3219
RIVERA (1960)	138.384	L+T 4FT NW OF MC IN CB RET @ SW COR WASHINGTON BLVD + SENTA ST	SY 3220
RIVERA (1960)	141.799	L+T CTR CB RET @ SW COR WASHINGTON BLVD + LEO ST	SY 3221
RIVERA (1960)	148.861	L+T CTR CB RET @ NE COR WASHINGTON BLVD + TELEGRAPH RD	SY 3222E
RIVERA (1960)	160.738	BR CAP C/L WASHINGTON BLVD @ BC FLUSH 153FT S C/L GAYHART ST	SY 3224
RIVERA (1960)	167.246	BR CAP C/L WASHINGTON BLVD @ MC FLUSH 357FT W C/L GARFIELD AVE	SY 3225
RIVERA (1960)	167.990	L+BN CTR CB RET PARKING AREA @ N COR GOODYEAR TIRE CO PROP 70FT S C/L WASHINGTON BLVD + 150FT W C/L GARFIELD AVE	SY 3226
RIVERA (1960)	168.356	GARFIELD AVE L+T S CB 1FT W BCR @ SW COR WASHINGTON BLVD +	SY 3227A
RIVERA (1960)	174.786	RDBM TAG N CB 1FT W BCR @ NW COR WASHINGTON BLVD + VAIL AVE 38FT N + 45FT W C/L INT	SY 3229A
RIVERA (1960)	173.638	RD MON IN WELL 8IN DN @ C/L INT WASHINGTON BLVD + VAIL AVE MKD (LA RD DEPT 1954)	SY 3230A
RIVERA (1960)	175.954	RD MON IN WELL 8IN DN @ C/L INT WASHINGTON BLVD + MAPLE AVE MKD (LA RD DEPT 1954)	SY 3231A
RIVERA (1960)	177.023	L+T CTR CB RET ON NE COR WASHINGTON BLVD + MAPLE AVE 35FT N + 25FT E C/L INT MKD (BM 1A)	SY 3232A
RIVERA (1960)	185.834	L+T CB RET 12FT W BCR @ NE COR WASHINGTON BLVD + GREENWOOD AVE	SY 3233A
RIVERA (1960)	200.465	L+N CTR 2FT CONC WK TO HSE NO 837 BLUFF RD 8FT W OF W CB	SY 3235
RIVERA (1960)	202.924	L+T 1FT N BCR @ NW COR BEACH ST + BLUFF RD	SY 3236
RIVERA (1960)	211.362	L+N W CB 1FT S BCR @ SW COR MINES AVE + BLUFF RD	SY 3237A

QUAD-YEAR	ELEV	DESCRIPTION (INCLUDE QUAD AND YEAR IN DESCRIPTION)	BM NUMBER
RIVERA (1960)	211.427	L+N CTR CB RET @ NW COR MOUNTAIN VIEW AVE + BLUFF RD	SY 3238
RIVERA (1960)	211.951	CHIS (X) S CB 1FT W BCR @ SW COR LOS ANGELES AVE + BLUFF RD	SY 3239
RIVERA (1960)	179.889	L+BN @ N END 1FT RETAINING WALL 85FT S C/L BEVERLY BLVD 25FT W C/L PINE ST 2FT S END OF WALL	SY 3240
RIVERA (1960)	179.279	L+DN CONC BASE @ SW COR HIGH VOLTAGE POWER LINE 75FT N C/L BEVERLY RD BTW PINE ST + LEXINGTON RD (TOWER NO 255D L)	SY 3241
RIVERA (1960)	179.858	L+BN S CB 2FT E BCR @ SE COR BEVERLY RD + LEXINGTON RD	SY 3242A
RIVERA (1960)	181.016	L+BN N CB 1FT W BCR @ NW COR MARIS AVE + BEVERLY RD	SY 3243
RIVERA (1960)	182.129	L+T CTR CB RET @ NW COR ROSEMEAD BLVD + BEVERLY RD	SY 3244
RIVERA (1960)	183.089	L+T E CB ROSEMEAD BLVD 6FT N BCR @ NE COR ROSEMEAD BLVD + BEVERLY RD	SY 3245
RIVERA (1960)	185.845	L+BN N CB 4FT W BCR @ NW COR LAYMAN AVE + BEVERLY RD	SY 3246
BASELINE (1955)	176.345	CS MON NR C/L INT NORWALK BLVD + WHITTIER BLVD	SY 3253A
BASELINE (1955)	168.692	L+B W CB 16FT S BCR @ SW COR BEXLEY DR + NORWALK BLVD	SY 3254
BASELINE (1955)	167.956	L+B W CB 3FT S BCR @ NW COR REICHLING LANE + NORWALK BLVD	SY 3255
BASELINE (1955)	167.050	L+B W CB 2FT S BCR @ NW COR ROSE HEDGE DR + NORWALK BLVD	SY 3256
BASELINE (1955)	165.122	L+SPK E CB 5FT S BCR @ SE COR DUNLAP CROSSING RD (MINES BLVD) + NORWALK BLVD 38FT E + 77FT S C/L INT	SY 3257A
BASELINE (1955)	163.822	L+BR W CB 3FT N BCR @ NW COR COOLHURST DR + NORWALK BLVD 38FT W + 56FT N C/L INT	SY 3258
BASELINE (1955)	163.205	LS 1102 TAG E CB 2FT N BCR @ NE COR BALFOUR ST + NORWALK BLVD	SY 3259
BASELINE (1955)	162.415	L+BN E CB 1FT S BCR @ SE COR FLORY ST + NORWALK BLVD	SY 3260
BASELINE (1955)	161.022	CS MON 16FT W OF E CB FRONT HSE NO 7440 NORWALK BLVD	SY 3261
BASELINE (1955)	161.215	NE 2059 TAG NE EDGE CONC WK FRONT OF HSE NO 7608 NORWALK BLVD 6FT NW WK 50FT E C/L NORWALK BLVD + 112FT S CHOISSER ST	SY 3262
BASELINE (1955)	159.293	L+BN NE CB 2FT NW BCR BRONT HSE NO 7744 38FT E C/L NORWALK BLVD + 56FT S C/L PROD ROCKNE AVE TO THE W	SY 3263
BASELINE (1955)	155.761	L+T W EDGE CONC DRWY TO HSE NO 8111 NORWALK BLVD 32FT W C/L + 19FT S C/L PROD BOER ST TO THE E	SY 3265

QUAD-YEAR	ELEV	DESCRIPTION (INCLUDE QUAD AND YEAR IN DESCRIPTION)	BM NUMBER
BASELINE (1955)	154.457	L+BN W CB 1FT N BCR @ NW COR WADDELL ST + NORWALK BLVD 38FT W + 60FT N C/L INT	SY 3266A
BASELINE (1955)	154.084	L+T E CB NR N SIDE HSE NO 8308 NORWALK BLVD 45FT E + 35FT S C/L INT BROADWAY + NORWALK BLVD	SY 3267A
BASELINE (1955)	152.448	L+BN W CB 2FT N BCR @ NW COR AEOLIAN ST + SERVICE RD NORWALK BLVD 50FT N + 70FT W C/L INT	SY 3268A
BASELINE (1955)	156.903	L+T IN SWLY COR OF CONC CBING AROUND A FIRE HYDRANT 44FT E/D C/L NORWALK BLVD + 44FT N/D CTR OF MAIN DRWY ENTRANCE TO PACIFIC CLAY PRODUCTS YARD	SY 3272B
BASELINE (1955)	234.318	CS MON @ C/L INT SAN GABRIEL BLVD + ARROYO DR	SY 3294A
BASELINE (1955)	275.754	L+SPK ELY CB SAN GABRIEL BLVD 15FT S CB RET @ S ELY COR MUSCATEL AVE + SAN GABRIEL BLVD	SY 3316A
BASELINE (1955)	297.550	L+BN N ELY COR CONC DAIRY LOADING PLATFORM 125FT ELY DIRECTION FROM C/L SAN GABRIEL BLVD (MIDWAY BET MUSCATEL AVE + WALNUT GROVE AVE)	SY 3317A
BASELINE (1955)	306.099	CS MON C/L WALNUT GROVE AVE PI SAN GABRIEL BLVD TO N	SY 3319A
BASELINE (1955)	313.387	CS MON C/L SAN GABRIEL BLVD 550FT WLY WALNUT GROVE AVE FRONT HSE NO 1042 SAN GABRIEL BLVD	SY 3320A
BASELINE (1955)	315.976	CS MON @ C/L INT DELTA ST + SAN GABRIEL BLVD	SY 3321A
BASELINE (1955)	317.416	L+SPK SW COR CONC BASE OF GAS ISLAND @ NE COR DELTA ST + SAN GABRIEL BLVD	SY 3322A
BASELINE (1955)	328.888	L+SPK N CB SAN GABRIEL BLVD 15FT E DR TO HSE NO 1254 SAN GABRIEL BLVD	SY 3323A
BASELINE (1955)	337.804	L+SPK SLY CB SAN GABRIEL BLVD 4FT E BCR @ SE COR D LAWRENCE AVE 38FT S + 50FT E C/L INT	SY 3324A
BASELINE (1955)	337.180	CS MON INT LAWRENCE AVE + SAN GABRIEL BLVD	SY 3325A
BASELINE (1955)	341.100	CS MON @ INT GRAND VIEW AVE + SAN GABRIEL BLVD	SY 3326A
BASELINE (1955)	340.529	L+SPK SLY CB SAN GABRIEL BLVD 3FT W CB RET @ SW COR GRAND VIEW AVE	SY 3327A
BASELINE (1955)	335.905	CS MON @ INT HILL DR + SAN GABRIEL BLVD	SY 3328A
RIVERA (1960)	345.447	L+SPK SLY CB HILL DR 37FT W C/L ARLAND ST PROD 4FT W OF DR TO SCHOOL HSE YARD	SY 3330
RIVERA (1960)	351.492	CS MON C/L HILL DR E PROP LINE HSE NO 7044 HILL DR	SY 3331
RIVERA (1960)	340.757	L+T W END CONC HDWL 8FT S C/L ARROYO DR 330FT E C/L POTRERO-GRANDE DR	SY 3336
RIVERA (1960)	315.145	CS MON 6FT N C/L ARROYO DR @ 1363FT E POTRERO- GRANDE DR	SY 3338
RIVERA (1960)	315.787	L+N @ W END CONC HDWL 27FT NLY C/L ARROYO DR @ 1425FT E C/L POTRERO GRANDE DR	SY 3339



QUAD-YEAR	ELEV	DESCRIPTION (INCLUDE QUAD AND YEAR IN DESCRIPTION)	BM NUMBER
RIVERA (1960)	296.669	L+N IN ELY CULV WINGWALL 40FT NLY OF C/L ARROYO DR + 25FT WLY OF C/L GRAND VIEW AVE	SY 3343A
RIVERA (1960)	295.488	L+SPK @ E END OF CONC HDWL 35FT SLY C/L ARROYO DR 25FT E C/L GRANDVIEW AVE 5FT W OF E END	SY 3344
RIVERA (1960)	290.063	L+BN CTR OF CONC HDWL DRAIN 27FT S C/L ARROYO DR 50FT W C/L LAWRENCE AVE PRDD	SY 3345
RIVERA (1960)	281.346	L+BN CTR CONC HDWL 30FT S C/L ARROYO DR + 850 FT E LAWRENCE AVE	SY 3347
RIVERA (1960)	271.541	L+T CTR OF E WING CONC HDWL 30FT S C/L ARROYO DR 1285FT E C/L LAWRENCE AVE	SY 3349
RIVERA (1960)	256.650	L+N E END CONC HDWL 22FT NLY C/L ARROYO DR 375FT E DRWY TO HSE NO 8539 ARROYO DR	SY 3352A
RIVERA (1960)	249.042	L+BN W END CB 12FT N C/L ARROYO DR 1225FT W C/L SAN GABRIEL BLVD	SY 3354A
BASELINE (1955)	237.480	L+BN NR CTR CONC HDWL 25FT S W C/L SAN GABRIEL BLVD 30FT N C/L ARROYO DR	SY 3356A
BASELINE (1955)	161.557	L+T E CB 4FT S OF S P/L OF HSE NO 7440 NORWALK BLVD (FRONT OF PP NO 246625E) 38FT E C/L NORWALK BLVD 100FT N C/L SAROGOSA ST PRDD FROM W	SY 3706A
BASELINE (1955)	161.173	RAM SET NR CTR CB RET ON SE COR CHOISSER ST + NORWALK BLVD	SY 3707
BASELINE (1955)	158.104	RAM SET 3FT N OF NW CB RET ON WASHINGTON + NORWALK BLVD	SY 3708
BASELINE (1955)	158.495	CS MON FLUSH IN ISL @ NW COR NORWALK BLVD + WASHINGTON BLVD 40FT N + 35FT W C/L INT MKD (BM 2-14A 1961 RE5869)	SY 3709A
RIVERA (1960)	141.547	L+T 3FT N CB RET SE COR EASTERN AVE + HARBOR ST	SY 4058
RIVERA (1960)	144.435	L+BN E CB 1ST N CB RET @ NE COR EASTERN AVE + EVERINGTON ST	SY 4059
RIVERA (1960)	145.462	BR CAP MKD STATE OF CALIF DEPT OF PUB WORKS 10FT S CB RET N DRWY TO LA CO LIVE STOCK BLDG ON EASTERN AVE	SY 4060
RIVERA (1960)	150.784	RAM SET CB RET @ NE COR EASTERN AVE + COMD ST	SY 4061
RIVERA (1960)	149.819	L+BN N CB TELEGRAPH RD 30FT N + 125 FT E C/L INT TELEGRAPH RD + ATLANTIC BLVD	SY 4062
RIVERA (1960)	149.909	L+BN S CB TELEGRAPH RD 30FT S + 175FT E C/L INT TELEGRAPH RD + ATLANTIC BLVD	SY 4063
RIVERA (1960)	149.151	L+T S CB TELEGRAPH RD C/L PRDD CAMFIELD AVE	SY 4064
RIVERA (1960)	148.643	L+BN E EDGE WK BLDG NO5515 TELEGRAPH RD 43FT N C/L TELEGRAPH RD	SY 4065
RIVERA (1960)	147.285	L+SPK NE CB RET TELEGRAPH RD + HOEFNER AVE 15FT E BCR	SY 4066
RIVERA (1960)	148.657	L+SPK N CB TELEGRAPH RD 35FT N C/L OPPOSITE MAIN ENT US TIRE BLDG	SY 4067

QUAD-YEAR	ELEV	DESCRIPTION (INCLUDE QUAD AND YEAR IN DESCRIPTION)	BK NUMBER
RIVERA (1960)	150.117	L+BN N CB TELEGRAPH RD IN MC 60FT E TP NO 5412-07-H 254FT W C/L GASPAR AVE	SY 4068
RIVERA (1960)	150.799	L+BN N CB W OF CB RET @ NW COR TELEGRAPH RD + GASPAR AVE	SY 4069
RIVERA (1960)	150.199	RD BM TAG CB 38FT N C/L TELEGRAPH RD + 5FT W DRWY TO OWENS CORNING FIBERGLASS BLDG NO5933 TELEGRAPH RD APPROX STA 122+40	SY 4070A
RIVERA (1960)	148.516	L+BN FOUNDATION STEEL FENCE POST @ W ENT BRASS WELL MOTOR FREIGHT LINES 62FT N C/L TELEGRAPH RD	SY 4071
RIVERA (1960)	146.412	SPK + L SLY CB 4FT WLY BCR @ S WLY COR ENT FREE-WAY + TELEGRAPH RD 40FT SLY + 65FT WLY C/L INT CB MKD (SD 2135)	SY 4072A
RIVERA (1960)	153.112	L+T E CB WASHINGTON BLVD 65FT S OF N DRWY TO (CONTINENTAL CAN CO) ON C/L PROD OF CORSAIR ST 40FT E C/L WASHINGTON BLVD	SY 4073
RIVERA (1960)	294.158	RD BM TAG @ SW COR 3RD ST + FORD BLVD 60FT W + 40FT S C/L INT 13FT W BCR	SY 4175
RIVERA (1960)	294.068	L+BN @ NE COR 3RD ST + FORD BLVD 40FT N + 54FT E C/L INT 10FT E BCR	SY 4176
RIVERA (1960)	274.168	L+T @ SW COR 3RD ST + ARIZONA AVE 40FT S + 33FT W C/L INT 5FT W BCR	SY 4177
RIVERA (1960)	274.378	L+T 5FT E BCR @ NW COR 3RD ST + ARIZONA AVE 41FT N + 27FT W C/L INT	SY 4178
RIVERA (1960)	262.817	L+BN N CB 3RD ST 40FT N C/L + 11FT W C/L PROD LA VERNE AVE	SY 4180
RIVERA (1960)	255.041	L+T N CB 3RD ST @ NE COR WOODS AVE 40FT N + 90FT E C/L INT 45FT E BCR	SY 4181
RIVERA (1960)	257.255	CS BRASS CAP MON 23FT W/O BCR 8IN N/O NCB E 3RD ST @ WOODS AVE 70FT W + 41FT N C/L INT (MKD 51-2A)	SY 4182A
RIVERA (1960)	227.664	L+T @ NW COR ATLANTIC BLVD + REPETTO ST 66FT N + 33FT W C/L INT 1FT N BCR	SY 4185
RIVERA (1960)	226.013	L+T W CB ATLANTIC BLVD @ SW COR REPETTO ST 45FT S + 27FT W C/L INT 28FT S BCR + 9FT N ANGLE PT IN CB	SY 4186
RIVERA (1960)	213.732	L+BN @ NW COR ATLANTIC BLVD + EAGLE ST 30FT N + 27FT W C/L INT 7FT N BCR	SY 4187
RIVERA (1960)	206.734	L+BN @ NE COR ATLANTIC BLVD + 6TH ST 63FT N + 27FT E C/L INT 3FT N BCR	SY 4189
RIVERA (1960)	206.150	L+BN @ NW COR ATLANTIC BLVD + 6TH ST 36FT N + 27 FT W OF C/L INT 6FT N BCR	SY 4190
RIVERA (1960)	192.162	SQ HD SPK WK 6IN E OF CLEAN OUT TO CONC CULV @ NE COR OF ATLANTIC BLVD + WHITTIER BLVDS 42FT N + 42FT E C/L INT 6FT NE CTR CB RET	SY 4191
RIVERA (1960)	191.654	L+BN TOP OF CONC BOX 10IN FROM E EDGE @ SE COR ATLANTIC BLVD + WHITTIER BLVD 39FT S + 42FT E C/L INT 3FT N CB	SY 4192

QUAD-YEAR	ELEV	DESCRIPTION (INCLUDE QUAD AND YEAR IN DESCRIPTION)	BM NUMBER
RIVERA (1960)	174.662	L+BN CONC AROUND TRAFFIC SIGNAL POLE CTR OF RET @ NW COR ATLANTIC BLVD + OLYMPIC BLVD 42FT N + 51FT W C/L INT	SY 4193
RIVERA (1960)	173.680	L+BN CONC AROUND SIGNAL POLE @ SE COR ATLANTIC BLVD + OLYMPIC BLVD 36FT S + 52FT E C/L INT	SY 4194
RIVERA (1960)	154.807	CUT SPK NR CTR CB RET @ THE NW COR ATLANTIC BLVD + TELEGRAPH RD 54FT N + 69FT W C/L INT (MKD ZZZ)	SY 4195
RIVERA (1960)	152.797	RD HD SPK CB 90FT E + 27FT S C/L INT ATLANTIC BLVD + TELEGRAPH RD	SY 4196
RIVERA (1960)	191.429	SQ HD SPK @ SW COR FORD BLVD + WHITTIER BLVD 27FT S + 39FT W C/L INT 6FT W BCR	SY 4197
RIVERA (1960)	191.627	SQ HD SPK @ BCR SE COR WHITTIER BLVD + FORD BLVD 27FT S + 33FT E C/L INT	SY 4198
RIVERA (1960)	194.498	L+BN @ SE COR ARIZONA AVE + WHITTIER BLVD 27FT S + 36FT E C/L INT 13FT E BCR	SY 4199
RIVERA (1960)	191.732	L+BN SW COR WHITTIER BLVD + LA VERNE AVE 27FT W + 27FT S C/L INT 2FT W BCR	SY 4200
RIVERA (1960)	191.814	CUT SPK @ SE COR WHITTIER BLVD + LA VERNE AVE 30FT E + 27FT S C/L INT 3FT E BCR	SY 4201
RIVERA (1960)	191.952	CUT SPK NR CTR RET @ SW COR WHITTIER BLVD + GOODRICH BLVD 37FT S + 45FT W C/L INT (MKD Z 143)	SY 4202
RIVERA (1960)	191.843	RD BM TAG @ SE COR WHITTIER BLVD + GOODRICH BLVD 30FT E + 58FT S C/L INT 1FT S ECR	SY 4203
RIVERA (1960)	189.675	SQ HD SPK NR CTR CB RET @ NW COR WHITTIER BLVD + GERHART AVE 30FT N + 18FT W C/L INT	SY 4204
RIVERA (1960)	188.026	RD BM TAG @ THE SW COR WHITTIER BLVD + GERHART AVE 66FT S + 13FT W C/L INT 1FT S ECR	SY 4205
RIVERA (1960)	189.381	L+T NR CTR CB RET @ NW COR WHITTIER BLVD + LEONARD AVE 30FT N + 18FT W C/L INT	SY 4206
RIVERA (1960)	189.640	SQ HD SPK @ NE COR WHITTIER BLVD + LEONARD AVE 27FT N + 34FT E C/L INT 7FT E BCR	SY 4207
RIVERA (1960)	193.188	L+BN @ SE COR WHITTIER BLVD + WESTSIDE DR 27FT S + 78FT E C/L INT 6FT E BCR	SY 4208
RIVERA (1960)	194.941	CUT SPK @ SE COR WHITTIER BLVD + SAYBROOK AVE 27FT S + 66FT E C/L INT 1FT E BCR	SY 4209
RIVERA (1960)	201.863	L+BN @ SW COR WHITTIER BLVD + GARFIELD AVE 72FT S + 30FT W C/L INT 1FT S ECR	SY 4210
RIVERA (1960)	201.606	CT SPK N CB 10FT W BCR @ NE COR GARFIELD AVE + WHITTIER BLVD 30FT N + 65FT E BCR	SY 4211
RIVERA (1960)	194.364	L+B N CB 35FT E BCR @ NE COR OLYMPIC BLVD + GARFIELD AVE 36FT N + 115FT E C/L INT	SY 4212
RIVERA (1960)	191.419	L+T @ NW COR GARFIELD AVE + FAIRFIELD ST 20FT N + 80FT W C/L INT 5FT W ECR	SY 4213
RIVERA (1960)	299.774	EASTERN AVE + THIRD ST @ SE COR 2FT W PP ND 1118369 + TRAFFIC SIGNAL 1FT S CB SET IN WELL A CS MON MKD (BM 31-10 1953 RE 63)	SY 4214

QUAD-YEAR	ELEV	DESCRIPTION (INCLUDE QUAD AND YEAR IN DESCRIPTION)	BM NUMBER
RIVERA (1960)	193.659	CS MON @ EASTERN AVE + WHITTIER BLVD 34FT S + 45FT E C/L INT 1FT N OF WALK MKD (BM 31-9)	SY 4215
RIVERA (1960)	194.884	L+BN NW COR ARIZONA AVE + WHITTIER BLVD 40FT N + 15FT W C/L INT 5FT N ECR	SY 4216
RIVERA (1960)	310.092	L+T W CB FORD BLVD 21FT N CB RET @ NW COR N FORD BLVD @ E 1ST ST	SY 4217
RIVERA (1960)	312.223	L+T W CB FORD BLVD 1FT S CB RET @ SW COR E EUGENE ST + N FORD BLVD (MKD WITH BM ARROW)	SY 4218
RIVERA (1960)	313.413	CS MON CI WELL 30FT W C/L FORD BLVD + 38FT S C/L BROOKLYN AVE FLUSH W MAC PAVEMENT	SY 4219
RIVERA (1960)	313.495	SPK WPM N CB BROOKLYN AVE 1FT E CB RET @ NE COR N FORD BLVD @ BROOKLYN AVE	SY 4220
RIVERA (1960)	313.221	L+BN @ NE COR CONC APRON GAS STA ISLAND 40FT S OF E FLORAL DR 60FT W C/L N FORD BLVD	SY 4221
RIVERA (1960)	314.205	L+T S CB S FLORAL DR 1FT E CB RET @ SE COR E FLORAL DR + N FORD BLVD (MKD BM)	SY 4222
RIVERA (1960)	302.956	L+BN N END BOTTOM CONC STEP HSE NO848 LOPEZ AVE @ SE COR LOPEZ AVE + BLANCHARD ST	SY 4228
RIVERA (1960)	317.812	L+T W CB HUMPHREYS AVE 1FT S CB RET @ SW COR HUMPHREYS AVE + BLANCHARD ST	SY 4230
RIVERA (1960)	331.516	L+BN BOTTOM STEP HSE NO4327 BLANCHARD ST 5FT E C/L SYDNEY DR PROD 26FT N C/L BLANCHARD ST	SY 4231A
RIVERA (1960)	358.374	L+T TOP RET WALL ON S SIDE OF LOADING ZONE OF (COMBINATION GARAGE + WAREHOUSE ) @ 1016 N EASTERN AVE 15FT W SW COR OF ABOVE BLDG	SY 4235
RIVERA (1960)	379.741	L+BN 1FT IN FROM E END CONC RET WALL NR N SIDE OF CALIF WATER SERVICE PUMP HSE 65FT W C/L EASTERN AVE 710FT NLY FROM C/L MARIANNA ST	SY 4236A
RIVERA (1960)	447.220	L+T W CB EASTERN AVE OPPOSITE 1ST PI S LOTTA DR 28FT W C/L EASTERN AVE + 500FT S LOTTA DR	SY 4239E
RIVERA (1960)	477.750	RD BM TAG @ SE COR CONC SLAB OF A CALIF WATER SERVICE CO PUMP HSE 40FT E C/L EASTERN AVE + 100FT N C/L LOTTA DR PROD	SY 4240
RIVERA (1960)	507.462	L+T TOP CONC RET WALL 17FT S C/L ROSILYN DR 55FT W C/L EASTERN AVE 16FT E STEP WK TO HSE NO 4298 ROSILYN DR	SY 4241
RIVERA (1960)	473.568	RD BM TAG N CB DRWY LA CO FIRE DEPT ENGIN CO NO32 3FT E BLDG 50FT W C/L EASTERN AVE 90FT N C/L WOOLWINE DR @ NO1407 EASTERN AVE	SY 4242
RIVERA (1960)	388.611	RD BM TAG W CB 30FT W C/L MILLER AVE 118FT S C/L WORTH ST 2FT N CATCH BASIN	SY 4243
RIVERA (1960)	408.326	L+T CONC STEP HSE NO901 TOWNSEND AVE 30FT W C/L + 45FT N C/L BLANCHARD ST MKD (BM)	SY 4581
RIVERA (1960)	418.016	L+T CONC RET WALL OF HSE NO 901 ROWAN AVE 30FT W C/L + 50FT N C/L BLANCHARD ST MKD (BM)	SY 4582
RIVERA (1960)	418.074	L+T CONC RET WALL @ 27FT S C/L BLANCHARD ST + 30FT E C/L ROWAN AVE MKD (BM)	SY 4583

QUAD-YEAR	ELEV	DESCRIPTION (INCLUDE QUAD AND YEAR IN DESCRIPTION)	BM NUMBER
RIVERA (1960)	408.669	L+T CONC STEP HSE NO827 EASTMAN AVE 30FT W C/L + 45FT S C/L BLANCHARD ST MKD (BM)	SY 4584
RIVERA (1960)	388.116	L+T E CB GAGE AVE 18FT E C/L 18FT N C/L PROD BLANCHARD ST	SY 4585
RIVERA (1960)	429.512	L+T E CB 7FT S BCR 35FT S C/L BLANCHARD ST + 12FT E C/L HERBERT AVE	SY 4586
RIVERA (1960)	434.144	L+T S CB 10FT W BCR 35FT W C/L GERAGHTY AVE + 18FT S C/L BLANCHARD	SY 4587
RIVERA (1960)	406.014	L+T CONC DRWY @ HSE NO3841 FOLSOM ST 50FT N C/L + 50FT W C/L GERAGHTY AVE MKD (BM)	SY 4588
RIVERA (1960)	345.063	L+T E CB S END CATCH BASIN 20FT E C/L RECORD AVE 36FT N C/L FLORAL DR MKD (BM)	SY 4589
RIVERA (1960)	357.429	L+T E CB 5FT N BCR 20FT E C/L BONNIE BEACH PL 35FT N C/L FLORAL DR MKD (BM)	SY 4590
RIVERA (1960)	310.627	L+T W CB C/L PROD FLORAL DR 45FT S BCR 18FT W C/L BRANNICK AVE	SY 4592
RIVERA (1960)	340.763	SQ HD SPK S CB 5FT W BCR 35FT W C/L BRANNICK AVE 25FT S C/L FOLSOM ST	SY 4593
RIVERA (1960)	331.708	L+T N CB 6FT E FUTURE BCR 15FT N BLANCHARD ST 50FT E C/L BRANNICK AVE MKD (BM)	SY 4594
RIVERA (1960)	322.999	SQ HD SPK E CB 2.5FT S BCR 33FT S BLANCHARD ST + 20FT E C/L MARIANNA AVE	SY 4595
RIVERA (1960)	414.332	L+B CONC WK @ HSE NO3547 WINTER ST 30FT N C/L + 30FT W C/L ROWAN AVE	SY 4596
RIVERA (1960)	406.245	L+BN S CB 3FT W BCR 35FT W C/L ROWAN AVE 18FT + S C/L FOLSOM ST MKD (BM)	SY 4597
RIVERA (1960)	364.463	L+BN CB 6FT E BCR 18FT N FLORAL DR 35FT E C/L ROWAN AVE	SY 4598
RIVERA (1960)	322.787	L+BN N CB 15FT E BCR 20FT N C/L HAMMEL ST 45FT E C/L ROWAN AVE	SY 4599
RIVERA (1960)	308.246	L+T W CB 20FT W C/L ROWAN AVE C/L PROD DOZIER ST	SY 4600
RIVERA (1960)	300.279	L+BN W CB 1FT S BCR 20FT W C/L ROWAN AVE 36FT S C/L BROOKLYN AVE MKD (BM)	SY 4601
RIVERA (1960)	298.016	L+BN E CB 7FT N BCR 20FT E C/L DITMAN AVE 55FT N C/L BROOKLYN AVE MKD (BM)	SY 4602
RIVERA (1960)	296.825	CUT SPK W CB @ BCR 20FT W C/L ALMA AVE + 45FT N C/L BROOKLYN AVE	SY 4603
RIVERA (1960)	290.141	CUT SPK E CB INDIANA ST 20FT S C/L PROD BROOKLYN PL	SY 4604
RIVERA (1960)	289.649	LACE MON C/L INT INDIANA ST + C/L INT BROOKLYN PL	SY 4605
RIVERA (1960)	317.611	CS MON 17.57FT S <b>OUT</b> INT INDIANA ST + 1ST ST MKD (ALHAMBRA A-8)	SY 4607
RIVERA (1960)	317.040	CUT SPK CB 5FT W BCR 37FT S C/L 3RD PL + 53FT W C/L INDIANA ST	SY 4608

QUAD-YEAR	ELEV	DESCRIPTION (INCLUDE QUAD AND YEAR IN DESCRIPTION)	BM NUMBER
RIVERA (1960)	296.770	CUT SPK CB 5FT N ECR 68FT N C/L 5TH ST 23FT W C/L INDIANA ST	SY 4610
RIVERA (1960)	275.848	LACE MON @ C/L INT INDIANA ST + 6TH ST W	SY 4611
RIVERA (1960)	276.582	WIRE SPK CB 5FT W BCR 20FT S C/L 6TH ST 35FT W C/L INDIANA ST	SY 4612
RIVERA (1960)	222.933	CUT SPK CB 112FT W C/L INDIANA ST 30FT N C/L WHITTIER BLVD	SY 4613
RIVERA (1960)	220.402	LACE MON C/L INDIANA ST 40FT S C/L WHITTIER BLVD	SY 4614
RIVERA (1960)	201.308	CUT SPK CB 5FT N BCE 23FT W C/L INDIANA ST 42FT N C/L 7TH ST	SY 4615
RIVERA (1960)	186.255	LACE MON @ C/L INT INDIANA ST + OLYMPIC BLVD	SY 4616
RIVERA (1960)	187.609	WIRE SPK CB E END CB 45FT N C/L INDIANA ST 37FT N C/L OLYMPIC BLVD	SY 4617
RIVERA (1960)	182.581	LACE MON WELL BIN DN @ C/L INT INDIANA ST + UNION PACIFIC AVE	SY 4618
RIVERA (1960)	183.716	WIRE SPK S CB UNION PACIFIC AVE 1FT W BCR 25FT S C/L + 40FT W INDIANA ST	SY 4619
RIVERA (1960)	179.727	CS MON WELL BIN DN NE COR INDIANA ST + NOAKES ST 10FT N + 17FT E C/L INT	SY 4620
RIVERA (1960)	180.267	L+T C/L NOAKES ST 15FT W C/L INDIANA ST	SY 4621
RIVERA (1960)	150.432	WIRE SPK + L E CB 10FT N BCR @ NE COR WASHINGTON BLVD + RANSOM ST 75FT N + 15FT E C/L INT	SY 4622A
RIVERA (1960)	151.220	L+BN 1FT W BCR @ NW COR WASHINGTON BLVD + HEPWORTH AVE PROD 48FT N + 85FT W C/L INT	SY 4623
RIVERA (1960)	158.667	L+BN 3FT S BCR @ SW COR WASHINGTON BLVD + COBB ST 15FT W + 63FT S C/L INT	SY 4624
RIVERA (1960)	155.402	CS MON WELL 1FT DN C/L SHEILA ST 65FT W C/L AYERS AVE MKD (BM 31-5 1953 RE 63)	SY 4625
RIVERA (1960)	157.949	CS MON 1FT DN C/L LEONIS ST 80FT E C/L AYERS MKD (BM 31-6 1953 RE-63)	SY 4626A
RIVERA (1960)	159.797	L+BN S CB WASHINGTON BLVD 30FT S C/L + 308 FT W C/L COBB ST	SY 4627
RIVERA (1960)	168.081	L+BN SE COR RR SIGNAL 41FT S C/L WASHINGTON BLVD + 43FT E C/L ELM ST	SY 4628
RIVERA (1960)	168.276	L+BN S EDGE STEP BLDG NO 4260 WASHINGTON BLVD 56FT S C/L + 29FT W C/L ELM ST	SY 4629
RIVERA (1960)	169.558	L+T N CB WASHINGTON BLVD 25FT N C/L PROD OAK ST	SY 4630
RIVERA (1960)	171.713	L+T CB 25FT N C/L WASHINGTON BLVD C/L PROD PINE ST	SY 4631
RIVERA (1960)	177.736	L+BN S CB WASHINGTON BLVD 2FT E BCR 30FT S C/L + 48FT E C/L INDIANA ST MKD (BM)	SY 4632

QUAD-YEAR	ELEV	DESCRIPTION (INCLUDE QUAD AND YEAR IN DESCRIPTION)	AM	NUMBER
RIVERA (1960)	178.116	L+BN N CB WASHINGTON BLVD 5FT W DRWY TO UP YARD 30FT N C/L 30FT W C/L INDIANA ST MKD (BM)	SY	4633
RIVERA (1960)	181.702	L+BN CONC FOOTING RR GATE POST 33FT S C/L WASH- INGTON BLVD + 1300FT W INDIANA ST MKD (BM)	SY	4634
RIVERA (1960)	182.227	L+T S CB WASHINGTON BLVD 30FT S C/L + 1330FT W C/L INDIANA ST	SY	4635
RIVERA (1960)	184.080	L+T S CB WASHINGTON BLVD 30FT S C/L + 60 FT E C/L DRWY CALIF COTTON OIL CORP 1500FT E C/L INDUSTRIAL WY	SY	4636
RIVERA (1960)	185.239	L+T CONC RETAINING WALL CALIF COTTON OIL CORP 33FT S C/L WASHINGTON BLVD 1450FT E C/L INDUSTRIAL WY	SY	4637
RIVERA (1960)	193.067	L+T NE WING WALL RR BRIDGE 58FT N C/L WASH- INGTON BLVD (3RD BRIDGE E OF GRANDE VISTA AVE) 350FT E C/L INDUSTRIAL WY	SY	4638
RIVERA (1960)	189.366	L+T CTR ELY CONC PILLAR OF BRIDGE SUPPORTING GAS LINE ON C/L WASHINGTON BLVD (2ND BRIDGE E OF GRANDE VISTA AVE) 560FT E C/L INDUSTRIAL WY	SY	4639
RIVERA (1960)	185.217	L+T S CB WASHINGTON BLVD 4FT W BCR 28FT S C/L + 8IN W C/L INT INDUSTRIAL WY	SY	4640
RIVERA (1960)	182.177	L+T N CB WASHINGTON BLVD 26FT N C/L + 59FT E C/L INT INDUSTRIAL WY	SY	4641
RIVERA (1960)	191.364	L+T E CB GRANDE VISTA AVE 1FT S BCR @ SE COR WASHINGTON BLVD	SY	4642
RIVERA (1960)	189.850	BR DISC CONC MON C/L INT WASHINGTON BLVD DOWNEY RD GRANDE VISTA AVE (W EDGE)	SY	4643
RIVERA (1960)	188.934	WIRE SPK N CB EMERY ST 123FT E BCR @ NE COR GRANDE VISTA AVE 3FT E OF CATCH BASIN	SY	4644
RIVERA (1960)	202.974	WIRE SPK W CB GRANDE VISTA AVE 9.2FT N BCR TO UNION PACIFIC AVE N END CATCH BASIN	SY	4645
RIVERA (1960)	198.616	WIRE SPK W CB LORENA ST 10FT S BCR SW COR PICO BLVD S OF CATCH BASIN	SY	4646
RIVERA (1960)	198.199	WIRE SPK 3FT N N CB OLYMPIC BLVD 5FT E BCR NE COR LORENA ST NW COR CATCH BASIN	SY	4647
RIVERA (1960)	200.867	LACE MON WELL 1FT DN C/L WASHINGTON BLVD 1100FT W DOWNEY AVE	SY	4648
RIVERA (1960)	194.529	L+N SIGNAL BASE S SIDE SANTA FE RR NW COR 26TH S + DOWNEY	SY	4649
RIVERA (1960)	191.138	L+SQ HD SPK 4FT W CB RET SW COR 26TH ST + DOWNEY RD 100FT S SANTA FE RR	SY	4650
RIVERA (1960)	187.539	L+SPK W CB DOWNEY RD 230FT N BANDINI BLVD W	SY	4651
RIVERA (1960)	187.298	L+T E CB DOWNEY RD 32FT N BANDINI BLVD W	SY	4652
RIVERA (1960)	190.075	L+SPK NW END DOWNEY RD BRIDGE OVER LA RIV (ON W CB)	SY	4653
RIVERA (1960)	190.147	FC/BRONZE DISC MKD (BM 7-31) 40FT S NE COR DOWNEY RD BRIDGE OVER LA RIV	SY	4654

QUAD-YEAR	ELEV	DESCRIPTION (INCLUDE QUAD AND YEAR IN DESCRIPTION)	BM NUMBER
RIVERA (1960)	190.103	FC BRONZE DISC MKD (BM 7-30) CB SE COR DOWNEY RD BRIDGE OVER LA RIV	SY 4655
RIVERA (1960)	190.132	L+SPK SW END BRIDGE OVER LA RIV 200FT N VERNON AVE ON DOWNEY RD	SY 4656
RIVERA (1960)	184.071	L+B N CB 45TH ST 63FT W C/L DOWNEY RD	SY 4657
RIVERA (1960)	182.764	L+SQ DT W CB DOWNEY RD 50FT S C/L PACKERS AVE	SY 4658
RIVERA (1960)	182.522	L+SQ BT CB 28FT N C/L LEONIS BLVD 60FT W C/L DOWNEY RD	SY 4659
RIVERA (1960)	182.331	L+SQ BT CB 28FT S C/L LEONIS BLVD 62FT W C/L DOWNEY RD	SY 4660
RIVERA (1960)	181.364	BOLT SPK CB 20FT N C/L 50TH ST 86FT W C/L DOWNEY RD	SY 4661
RIVERA (1960)	180.275	SQ HD SPK @ NW COR CONC BASE RR SIGNAL TOWER NO42 35FT S C/L FRUITLAND AVE 35FT E C/L DOWNEY RD	SY 4663
RIVERA (1960)	173.520	L+BN CONC PORCH BLDG 39FT W C/L DOWNEY RD 940FT N C/L SLAUSON AVE	SY 4664
BASELINE (1955)	165.289	L+T S CB SLAUSON AVE 192FT W + 21FT S C/L INT DOWNEY RD + SLAUSON AVE FRONT OF POWER POLE	SY 4665
BASELINE (1955)	162.523	CS MON WELL 2IN DN 32FT NLY S CB LINE SLAUSON AVE PRDC 11FT ELY W CB LINE EVERETT AVE PRDC MKD (LA CO SUR CONTROL SYS TRAVERSE STA WATTS L-2B RE4233)	SY 4666
RIVERA (1960)	315.659	L+BN N CB 1FT W BCR @ NW EASTMAN AVE + MICHIGAN AVE 20FT N + 36FT W C/L INT MKD (BM)	SY 4811
RIVERA (1960)	320.839	L+BN W CB 1FT S BCR @ SW COR 1ST ST + EAST- MAN AVE 40FT S + 20FT W C/L INT	SY 4812
RIVERA (1960)	312.224	L+T W CB 9FT S BCR @ SW COR 3RD ST + ROWAN AVE 75FT S + 20FT W C/L INT	SY 4813
RIVERA (1960)	312.305	L+T E CB 9FT S BCR @ SE COR 3RD ST + ROWAN AVE 75FT S + 20FT E C/L INT	SY 4814
RIVERA (1960)	302.842	RD BM TAG N CB 1FT W BCR @ NW COR 3RD ST + GAGE AVE 40FT N + 36FT W C/L INT	SY 4815
RIVERA (1960)	300.838	L+WIRE NAIL N CB 28FT E BCR @ NE COR 3RD ST + GAGE AVE 40FT N + 65FT E C/L INT (MKD BM NO14)	SY 4816
RIVERA (1960)	243.275	FC BR CAP CONC DROP INLET ON SW COR 3RD ST + DOWNEY RD 45FT W + 41FT S C/L INT MKD (BM 6-104)	SY 4817
RIVERA (1960)	244.146	RD BM TAG S CB 1FT E BCR @ SE COR 3RD ST + DOWNEY RD 40FT S + 40FT E C/L INT	SY 4818
RIVERA (1960)	308.711	L+T W CB 24FT S FUTURE BCR @ SW COR MEDNIK AVE + FLORAL DR 20FT W + 63FT S C/L INT MKD (BM NO25)	SY 5659
RIVERA (1960)	309.952	L+BN E CB 40FT N BCR @ NE COR MEDNIK AVE + FLORA DR 85FT N + 35FT E C/L INT MKD (BM)	SY 5660



QUAD-YEAR	ELEV	DESCRIPTION (INCLUDE QUAD AND YEAR IN DESCRIPTION)	BM NUMBER
RIVERA (1960)	327.892	L+BN CB 3FT S BCR @ SW COR FLORAL DR + BLEAKWOOD AVE 51FT S + 18FT W C/L INT MKD (BM)	SY 5661
RIVERA (1960)	330.322	L+BN S CB 1FT E BCR @ SE COR FLORAL DR + BLEAKWOOD AVE 20FT S + 40FT W C/L INT MKD (BM)	SY 5662
RIVERA (1960)	334.227	L+BN N CB 1FT W BCR @ NW COR FLORAL DR + CREST VISTA DR 15FT N + 45FT W C/L INT MKD (BM)	SY 5663
RIVERA (1960)	333.892	L+BN N CB 1FT E BCR @ NE COR FLORAL DR + CREST VISTA DR 15FT N + 45FT E C/L INT MKD (BM)	SY 5664
RIVERA (1960)	271.486	L+BN N CB 2FT W BCR @ NW COR BROOKLYN AVE + COLLEGIAN AVE 30FT N + 40FT W C/L INT MKD (BM)	SY 5665
RIVERA (1960)	268.636	L+BN S CB 1FT E BCR @ SE COR BROOKLYN AVE + COLLEGIAN AVE 57FT E + 30FT S C/L INT MKD (BM)	SY 5666
RIVERA (1960)	187.966	L+T N CB 12FT E BCR @ NE COR OLYMPIC BLVD + SERVER AVE 36FT N + 65FT E C/L INT	SY 5684
RIVERA (1960)	186.561	L+T S CB 12FT W BCR @ SW COR OLYMPIC BLVD + SERVER AVE 36FT S + 60FT W C/L INT	SY 5685
RIVERA (1960)	177.998	CO ENG TAG N CB 3FT E BCR @ NE COR OLYMPIC BLVD + HENDRICKS AVE 36FT N + 60FT E C/L INT	SY 5686
RIVERA (1960)	177.058	CO ENG TAG N CB 3FT W BCR @ NW COR OLYMPIC BLVD + HENDRICKS AVE 36FT N + 63FT W C/L INT	SY 5687
RIVERA (1960)	168.026	SQ HD SPK E CB 2FT N BCR @ SE COR OLYMPIC BLVD + GERHART AVE 75FT S + 18FT E C/L INT	SY 5688
RIVERA (1960)	168.915	RD BM TAG N CB 7FT W BCR @ NW COR OLYMPIC BLVD + GERHART AVE 36FT N + 60FT W C/L INT	SY 5689
RIVERA (1960)	145.535	CT SPK @ BCR SE COR ATLANTIC BLVD + HARBOR ST 46FT S + 30FT E C/L INT	SY 5690
RIVERA (1960)	145.257	RD BM TAG E CB 1FT N BCR @ NE COR ATLANTIC BLVD + HARBOR ST 48FT N 30FT E C/L INT	SY 5691
RIVERA (1960)	316.540	SQ HD SPK N CB 1FT W BCR @ NW COR BROOKLYN AVE + HUMPHREYS AVE 18FT N + 35FT W C/L INT CB MKD (BM N17)	SY 5692
RIVERA (1960)	316.529	L+T S CB 1FT W BCR @ SW COR BROOKLYN AVE + HUMPHREYS AVE 28FT S + 35FT W C/L INT	SY 5693
RIVERA (1960)	301.140	L+BN N CB 4FT E BCR @ NE COR BROOKLYN AVE + EASTERN AVE 18FT N + 66FT E C/L INT	SY 5694
RIVERA (1960)	268.064	L+BN E CB 12FT S BCR @ SE COR BROOKLYN AVE + MARIANNA AVE 55FT S + 21FT E C/L INT MKD (BM)	SY 5696
RIVERA (1960)	263.093	SQ HD SPK N CB 1FT W BCR @ NW COR BROOKLYN AVE + MARIANNA AVE 28FT N + 32FT W C/L INT CB MKD (BM N19)	SY 5697
RIVERA (1960)	269.185	RD MON IN WELL 8IN BELOW SURFACE @ OR NR C/L INT BROOKLYN AVE + BRANNICK AVE MKD (LA CO RD DEPT 1957)	SY 5698
RIVERA (1960)	270.396	SQ HD SPK N CB 1FT W BCR @ NW COR BROOKLYN AVE + BRANNICK AVE 30FT N + 37FT W C/L INT CB MKD (BM N21)	SY 5699
RIVERA (1960)	288.918	L+T S CB BROOKLYN AVE ON OR NR C/L PROD HAZARD AVE 28FT S C/L	SY 5700

QUAD-YEAR	ELEV	DESCRIPTION (INCLUDE QUAD AND YEAR IN DESCRIPTION)	BM NUMBER
RIVERA (1960)	290.019	L+BN N CB 3FT W BCR @ NW COR BROOKLYN AVE + HAZARD AVE 28FT N + 50FT W C/L INT MKD (BM)	SY 5701
RIVERA (1960)	312.463	L+T N CB 2FT E BCR @ NE COR BROOKLYN AVE + RECORD AVE 28FT N + 38FT E C/L INT	SY 5702
RIVERA (1960)	314.605	L+T S CB 2FT E BCR @ SE COR BROCKLYN AVE + RECORD AVE 28FT S + 37FT E C/L INT	SY 5703
RIVERA (1960)	306.292	L+BN W CB 1FT S BCR @ NW COR BROOKLYN AVE + GAGE AVE 45FT N + 20FT W C/L INT MKD (BM)	SY 5705
RIVERA (1960)	312.820	L+BN E CB 2FT S BCR @ SE COR BRANNICK AVE + HAMMEL ST 38FT S 20FT E C/L INT MKD (BM)	SY 5706
RIVERA (1960)	312.299	L+T N CB 1FT W BCR @ NW COR BRANNICK AVE + HAMMEL ST 20FT N + 38FT W C/L INT	SY 5707
BASELINE (1955)	139.933	MON IN WELL 12IN DN 57FT N/O + 41FT E/O C/L INT OF SLAUSON AVE + ALAMO AVE MRKD (BM 4-21 1951)	SY 6170
RIVERA (1960)	188.942	L+BR S CB UNION PACIFIC AVE 20FT S C/L + 20FT W C/L DITMAN AVE	SY 6171
RIVERA (1960)	188.850	RD BM TAG N CB 1FT E BCR @ NE COR UNION PACI- FIC AVE + DITMORE AVE 20FT N + 38FT E C/L INT	SY 6172
RIVERA (1960)	187.278	FD L+T S CB 12FT E BCR @ SE COR UNION PACIFIC AVE + ROWAN AVE 20FT S + 36FT E C/L INT	SY 6173
RIVERA (1960)	187.481	FD L+ BRAD N CB 9FT E BCR @ NE COR UNION PACIFIC AVE + ROWAN AVE 20FT N + 33FT E C/L INT	SY 6174
RIVERA (1960)	189.870	RD BM TAG N CB 3FT W BCR @ NW COR UNION PACIFIC AVE + HERBERT AVE 20FT N + 33FT W C/L INT	SY 6175
RIVERA (1960)	189.169	RD BM TAG E CB 1FT S BCR @ SE COR UNION PACI- FIC AVE + HERBERT AVE 33FT S + 18FT E C/L INT	SY 6176
RIVERA (1960)	189.435	RD BM TAG S CB 1.5FT W BCR @ SW COR UNION PACIFIC AVE + DOWNEY RD 20FT S + 33FT W C/L INT	SY 6177
RIVERA (1960)	189.599	L+ T N CB 0.5FT E BCR @ NE COR UNION PACIFIC AVE + DOWNEY RD 20FT N + 30FT E C/L INT	SY 6178
RIVERA (1960)	180.487	L+BRAD W CB 2FT S BCR @ SW COR UNION PACIFIC AVE + MARANNA AVE 33FT S + 15 FT W C/L INT	SY 6179
RIVERA (1960)	180.360	CT SPK @ BCR ON SE COR UNION PACIFIC AVE + MARIANNA AVE 30FT S + 15FT E C/L INT	SY 6180
RIVERA (1960)	173.199	L+T S CB 3FT W BCR @ SW COR OLYMPIC BLVD + EASTERN AVE 36FT S + 74FT W C/L INT	SY 6181
RIVERA (1960)	181.523	CS MON IN WELL 10IN DN ON SE COR OLYMPIC BLVD + EASTERN AVE 36.6FT S + 67.1FT E C/L INT MKD (BM 31-B)	SY 6182
RIVERA (1960)	174.866	L+T W CB 3FT N BCR @ NW COR TELEGRAPH RD + DUNCAN AVE 100FT N + 15FT W C/L INT	SY 6183
RIVERA (1960)	174.020	RAM SET N CB 1FT E BCR @ NE COR TELEGRAPH RD + DUNCAN AVE 35FT N + 26FT E C/L INT MKD (BM 6-D)	SY 6184
RIVERA (1960)	165.727	RD BM TAG N CB TELEGRAPH RD 35FT N C/L + 200FT W C/L KERN AV: OPP LIGHT STD	SY 6185

QUAD-YEAR	ELEV	DESCRIPTION (INCLUDE QUAD AND YEAR IN DESCRIPTION)	BM NUMBER
RIVERA (1960)	166.077	RD BM TAG S CB TELEGRAPH RD 25FT S TELEGRAPH RD + 200FT W C/L KERN AVE	SY 6186
RIVERA (1960)	160.613	RD BM TAG W CB @ CATCH BASIN ON LA VERNE AVE 15FT W C/L + 80FT N C/L TELEGRAPH RD	SY 6187
RIVERA (1960)	160.420	RD BM TAG E CB 1FT N BCR @ NE COR TELEGRAPH RD + LA VERNE AVE 65FT N + 15FT E C/L INT	SY 6188
RIVERA (1960)	220.139	RD BM TAG N CB 6TH ST 15FT N C/L + 182FT W C/L KERN AVE OPP PP	SY 6189
RIVERA (1960)	219.433	RD BM TAG S CB 6TH ST 15FT S C/L + 182FT W C/L KERN AVE OPP PP	SY 6190
RIVERA (1960)	175.267	RD BM TAG N CB OLYMPIC BLVD 35FT N C/L + 184FT E C/L KERN AVE	SY 6191
RIVERA (1960)	174.915	RD BM TAG S CB OLYMPIC BLVD 35FT S C/L + 184FT E C/L KERN AVE OPP LIGHT STD	SY 6192
RIVERA (1960)	155.717	PK IN L S WLY COR POWER LINE TOWER NO265115 NW COR ATLANTIC BLVD + LA RIVER	SY 6193A
RIVERA (1960)	149.194	RD BM TAG N CB 1FT E BCR ISLAND AT ENT CHELI AF STA 27FT N + 165FT E C/L INT ATLANTIC BLVD + BANDINI BLVD	SY 6194
RIVERA (1960)	158.830	B+SPK W CB AYERS AVE 32FT S C/L PROD LEONIS ST	SY 6195
RIVERA (1960)	160.399	L+SPK 5FT W OF BCR @ NW COR NOAKES ST + SIDNEY ST	SY 6196
RIVERA (1960)	159.614	L+SPK 100FT E OF BCR @ NE COR NOAKES ST + SIDNEY ST	SY 6197
RIVERA (1960)	233.417	L+T W CB ATLANTIC BLVD @ BEVERLY BLVD 45FT S BCR 105FT S + 35FT W C/L INT	SY 6198
RIVERA (1960)	236.903	BM TAG IN N CB OF BEVERLY BLVD @ ATLANTIC BLVD 1FT E/O BCR 40FT N 75FT W/O C/L INT	SY 6199
RIVERA (1960)	238.518	CS MON IN CONC POST 1FT S OF S CB BEVERLY BLVD + 15FT W OF BCR @ SW COR BEVERLY BLVD + SADLER AVE MKD (BM 51-3 1957)	SY 6200
RIVERA (1960)	181.924	L+T W CB 9FT S BCR W SW COR GARFIELD AVE + FERGUSON DR 50FT N + 35FT E C/L INT	SY 6202
RIVERA (1960)	151.295	L+BN SELY COR CONC SLAB S MH + FIRE SPRINKLER PLUG 51FT W C/L TELEGRAPH RD + 750FT ELY C/L GASPER AVE	SY 6204
RIVERA (1960)	148.781	L+T WLY CB TELEGRAPH RD 35FT N C/L 110FT ELY ENT TO US TIRE CO BLDGS 800FT WLY C/L GASPAR AVE	SY 6205
RIVERA (1960)	147.430	L+T SLY CB TELEGRAPH RD 40FT SLY C/L + 15FT ELY PROD HOFNER AVE NEAR WLY ENT CB	SY 6206
RIVERA (1960)	153.421	LA CO ENG TAG W CB 118FT N + 33FT W C/L INT WASHINGTON BLVD + CORSAIR ST	SY 6207
RIVERA (1960)	190.015	RD MON IN WELL 8IN DN ON C/L INT WASHINGTON BLVD + MONTEBELLO BLVD MKD (LA CO RD DEPT 1954)	SY 6208
RIVERA (1960)	190.276	L+T CONC ABUT BRIDGE NOB799 28FT N C/L WASHINGTON BLVD + 26FT E C/L BLUFF RD	SY 6209

QUAD-YEAR	ELEV	DESCRIPTION (INCLUDE QUAD AND YEAR IN DESCRIPTION)	BM NUMBER
RIVERA (1960)	161.419	L+B N CB @ BCR SERVICE ISLAND 38FT N + 35FT W C/L INT CANDACE AVE + WASHINGTON BLVD	SY 6210
RIVERA (1960)	161.820	L+T NO CB 1.0FT W BCR 38FT N + 54FT E C/L INT CROSSWAY DR + WASHINGTON BLVD	SY 6211
RIVERA (1960)	156.214	L+T N CB SERVICE RD WASHINGTON BLVD 78FT N C/L 25FT W BCR + 50FT W C/L PICOVISTA RD	SY 6212
RIVERA (1960)	157.186	L+T N CB WASHINGTON BLVD 38FT N C/L + 55FT E C/L PROD PICOVISTA	SY 6213
RIVERA (1960)	155.873	L+T SLY CB SLAUSON AVE 25FT SLY C/L + DN C/L PROD BLUFF RD	SY 6214
RIVERA (1960)	158.316	STEEL BOX IN CONC MDN N WLY COR BRIDGE NO B 1045 RIO HONDO 35FT N C/L SLAUSON AVE + 75FT E C/L BLUFF RD	SY 6215
RIVERA (1960)	162.027	L+B CONC STEP ENT BLDG NO1629 BLUFF RD 24FT W C/L + 0.2FT N SLAUSON AVE (MKD BM)	SY 6216
RIVERA (1960)	164.464	2IN IP FLUSH W FC TAG DN SE COR BLUFF RD + SEYMORE AVE 20FT S + 28FT E C/L INT	SY 6218
RIVERA (1960)	178.428	RD BM TAG 1FT N CB 20FT E C/L BLUFF RD + 270 S C/L DATE ST NR HSE NO1217	SY 6219
RIVERA (1960)	205.443	RD BM TAG N CB 1FT E BCR @ NE COR WHITTIER BLVD + 1ST ST BLUFF RD 28FT N + 45FT E C/L INT	SY 6220
RIVERA (1960)	156.125	L+BN E CB 3FT S BCR @ SE COR ROSEMEAD BLVD + REX RD 51FT S + 30FT E C/L INT MKD (BM)	SY 6221
RIVERA (1960)	156.754	L+BN E CB 1FT N BCR + NE COR REX RD + ROSE- MEAD BLVD 40FT N + 30FT E C/L INT MKD (BM)	SY 6222
RIVERA (1960)	159.275	L+BN E CB 5FT S BCR @ SE COR ROSEMEAD BLVD + DAN BRIDGE ST 60FT S + 40FT E C/L INT MKD (BM)	SY 6223
RIVERA (1960)	159.335	L+T W CB ROSEMEAD BLVD 40FT W C/L + DN C/L PROD DANBRIDGE ST	SY 6224
RIVERA (1960)	149.041	L+T W CB 7FT S ANG PT OF CB ON SW COR PASSONS BLVD + SHADE LANE 43FT S + 20FT W C/L INT	SY 6225
RIVERA (1960)	148.699	L+BN N CB 1FT E BCR @ NE COR PASSONS BLVD + SHADE LANE 18FT N + 46FT E C/L INT MKD (BM)	SY 6226
RIVERA (1960)	150.987	L+T N CB 1FT W BCR @ NE COR PASSONS BLVD + SLAUSON AVE 40FT N + 62FT E C/L INT	SY 6227
RIVERA (1960)	356.042	SPK 14FT S OF BCR @ SE COR EMERSON AVE + NEW AVE	SY 6229
RIVERA (1960)	349.567	CS MON CONC CULV 43FT N + 15FT E C/L INT EMERSON PL + STEVENS AVE MKD (BM 31-20A 1961)	SY 6230
RIVERA (1960)	305.205	SPK 22FT N OF BCR @ NE COR EMERSON PL + DEL MAR AVE	SY 6231
RIVERA (1960)	302.286	CS MON 9IN DN @ C/L INT EMERSON PL + WILSON WAY	SY 6232
RIVERA (1960)	299.053	CS MON IN S WALK TO GARVEY MEMORIAL PARK 97FT N C/L EMERSON PL + 330FT W C/L KELBURN AVE	SY 6233
RIVERA (1960)	302.358	CS MON S WALK TO GARVEY MEMORIAL PARK 330FT N C/L EMERSON PL + 330FT W C/L KELBURN AVE	SY 6234

QUAD-YEAR	ELEV	DESCRIPTION (INCLUDE QUAD AND YEAR IN DESCRIPTION)	BM NUMBER
BASELINE (1955)	324.734	CS MON IN WELL ON C/L SAN GABRIEL BLVD 46FT S C/L BLEEKER ST MKD (EL MONTE B-7A 1940)	SY 6235
BASELINE (1955)	283.640	CS MON IN WELL ON C/L SAN GABRIEL BLVD 2.5FT S C/L GRAVES AVE MKD (EL MONTE B-8 1940)	SY 6236
RIVERA (1960)	335.792	RDBM TAG IN SLY CB HILL DR 2FT W/O CB RET @ SWLY COR KENNYDALE AVE 40FT SLY + 52FT WLY OF C/L INT	SY 6237
RIVERA (1960)	345.938	L+T IN NE COR OF CONC DRWS TO HSE NO 1557 @ SW COR POTRERA GRANDE DR + MOONEY DR 80FT S + 31FT W/O C/L INT	SY 6238
RIVERA (1960)	350.674	L+BRAD IN WLY CB POTRERA GRANDE DR 1FT N/O CB RET @ N WLY COR ARROYO DR 40FT WLY + 57FT NLY OF C/L INT	SY 6239
RIVERA (1960)	216.503	RDBM TAG IN W CB ROSEMEAD BLVD @ SE COR OF BRIDG NO BR 53-534 N/O WHITTIER NARROWS DAM 42FT W/O C/L ROSEMEAD BLVD + 0.25MI S/O SAN GABRIEL BLVD	SY 6240
RIVERA (1960)	236.458	RDBM TAG IN NW COR OF DROP CATCH BASIN 55FT W C/L ROSEMEAD BLVD 175FT NW TOP WHITTIER NARROWS DAM 0.5MI S SAN GABRIEL BLVD	SY 6241
BASELINE (1955)	192.621	RD MON IN WELL W/COVER ON C/L DURFEE AVE 16FT S/O C/L ISORA ST	SY 6243
BASELINE (1955)	186.125	RD MON IN WALL W/COVER @ C/L INT DURFEE AVE + BEVERLY BLVD	SY 6244
BASELINE (1955)	181.701	COE BR CAP STAMPED (SG 48 1959 LA DISTRICT) SET IN N CB WHITTIER BLVD @ NW COR BRIDGE NO53-06 OVER SAN GABRIEL RIVER 22FT N/O C/L WHITTIER BLVD + 550 W/O SPRR BRIDGE OVER WHITTIER BLVD	SY 6245
BASELINE (1955)	181.605	COE BR DISK STAMPED (SG 47 1959) SET IN N CB WHITTIER BLVD @ NE COR BRIDGE NO 53-06 OVER SAN GABRIEL RIVER 22FT N/O C/L WHITTIER BLVD + 122FT W/O SPRR BRIDGE OVER WHITTIER BLVD	SY 6246
BASELINE (1955)	167.076	CS BR CAP STAMPED (BM 2-16 RE 5869 1961) SET IN NLY EDGE OF CATCH BASIN 2FT W/O W CB NORWALK BLV 24FT N/O CB RET @ NW COR ROSE HEDGE DR 37FT W + 79FT N/O C/L INT	SY 6247
BASELINE (1955)	207.393	BR CAP MON STAMPED (A-15 1922) FLUSH WITH GROUND UNDER CTR OF SO CALIF EDISON CO TOWER NO 105 44FT N/O C/L SAN GABRIEL BLVD + 160FT W/O C/L DURFEE AVE	SY 6249