

GENERAL CONSTRUCTION NOTES

1. BEFORE STARTING ANY WORK ON THIS PROJECT, THE CONTRACTOR SHALL:
 - A) HAVE SUBMITTED, IN SEXTUPLT, A WRITTEN LISTING OF ALL MATERIAL ITEMS TO BE FURNISHED TO AND/OR INSTALLED ON THE PROJECT, TO THE ENGINEER AND POSSESS A RETURNED COPY OF SUCH MARKED "APPROVED" FOR THIS PROJECT BY THE ENGINEER.
 - B) HAVE SUBMITTED TO THE ENGINEER PROOF THAT THE AGENCY IS NAMED INSURED BY THE CONTRACTOR'S INSURERS IN ACCORDANCE WITH THE GENERAL PROVISIONS OF THE CONTRACT.
 - C) HAVE GIVEN THE ENGINEER THE TELEPHONE NUMBER, BUSINESS OR HOME ADDRESS AND MAILING ADDRESS AND NAMES OF THE PERSONS WHO CAN BE CONTACTED IN THE EVENT OF AN EMERGENCY OCCURRENCE ON THE PROJECT DURING THE TIME THE WORK IS IN PROGRESS, 24 HOURS PER DAY, 7 DAYS PER WEEK.
 - D) HAVE GIVEN THE ENGINEER 2 DAYS IN ADVANCE OF START OF WORK, NOTICE, IN WRITING, OF THE TIME OF START OF WORK.
2. IT IS RECOMMENDED THAT THE DEVELOPER CHECK THIS PLAN WITH HIS PLANS BEFORE COMMENCING CONSTRUCTION OF THE WATER SYSTEM. THE WATER DISTRIBUTION SYSTEM PLAN FOR THIS PROJECT WAS PREPARED BY THE DEVELOPER'S ENGINEER. THE ACCURACY OF THE LOCATION OR THE EXISTENCE OR NON-EXISTENCE OF ANY UTILITY PIPE OR STRUCTURE WITHIN THE LIMITS OF THIS PROJECT SHOWN ON THESE PLANS DOES NOT CONSTITUTE A GUARANTEE AS TO THEIR LOCATION BY THE AGENCY. NEW PAVING, CURBS, AND SIDEWALKS INDICATED ON THESE DRAWINGS ARE SHOWN FOR INFORMATION ONLY. THE CONTRACTOR FOR THE WATER SYSTEM SHOULD VERIFY THE LOCATION AND THE PROPOSED SCHEDULING OF THE NEW PAVING, ETC., WORK BEFORE HE PROCEEDS.
3. ALL WATER SYSTEM MATERIALS AND CONSTRUCTION METHODS SHALL COMPLY WITH THE REQUIREMENTS OF THE DISTRICT THESE PLANS AND THIS LIST OF MATERIALS HAVE BEEN DETAILED FOR USE OF STEEL CEMENT MORTAR LINED AND COATED APPURTENANCES AS SHOWN. THE CONTRACTOR'S MATERIAL LISTING APPROVED BY THE ENGINEER SHALL BE IN THE CONTRACTOR'S POSSESSION PRIOR TO HIS PURCHASE OR FABRICATION OF SUCH MATERIALS. STEEL FITTING SHALL BE MINIMUM SCHEDULE 40. ALL VALVES SHALL BE DESIGNED FOR A MINIMUM WORKING PRESSURE OF 200 P.S.I. CONTRACTOR SHALL APPLY TWO COATS OF HEAVY DUTY RED PRIMER AND TWO FINISH COATS OF PAINT TO FIRE HYDRANTS AND FLUSHOUTS, AS SPECIFIED IN THE APPLICABLE STANDARD DRAWINGS.
4. ALL WORK IS SUBJECT TO THE REQUIREMENTS OF THE PERMIT(S) OF THE CITY OF PALMDALE REGARDING BARRICADES, TRAFFIC CONTROL, BACKFILL, COMPACTION, PAVEMENT REPAIRS, ETC.
5. ALL SURVEYING SERVICES ARE TO BE FURNISHED BY THE DEVELOPER'S ENGINEER.
6. ALL 4" AND 6" DIAMETER PIPE SHALL HAVE A MINIMUM COVER OF 36"; 8" AND 10" DIAMETER PIPE SHALL HAVE A MINIMUM COVER OF 42"; 12" DIAMETER PIPE SHALL HAVE A MINIMUM COVER OF 48"; AND ALL SERVICE CONNECTIONS SHALL HAVE A MINIMUM COVER OF 24" MEASURED VERTICALLY FROM TOP OF SERVICE CONNECTION TO APPROVED GUTTER SURFACE FLOW LINE CROSSED BY THE SERVICE CONNECTION. WHERE CONSTRUCTION OF PERMANENT GUTTER SURFACES IS NOT COMPLETE OR ESTABLISHED ADJACENT TO THE WATER MAIN WORK, WATER MAINS SHALL BE CONSTRUCTED WITH THE MINIMUM REQUIRED COVER MEASURED FROM THE PROPOSED ADJACENT FLOW LINES.
7. EARTH COVER OVER TOP OF THE PIPE AT FITTING IS CONTROLLED BY LARGEST PIPE OUTLET.
8. ALL SERVICE CONNECTIONS SHALL BE INSTALLED FROM THE MAIN IN THE STREET FROM WHICH THE HOUSE IS NUMBERED AND INSTALLED AT RIGHT ANGLES TO THE WATER MAIN AND AS POSSIBLE TO THE CENTER OF THE ROAD. NO CLOSURE TO ANY DRIVEWAY, WALKWAY, CURB RETURN OR OTHER UTILITY (UNLESS NOTED OTHERWISE ON THE PLANS). WATER METER BOX AND SERVICE CONNECTION SHALL BE INSTALLED BETWEEN THE BACK OF CURB AND PROPERTY LINE PER STANDARD W-5 OR W-7, AS APPLICABLE. METERS SHALL BE INSTALLED BY THE CONTRACTOR AFTER:
 - A) AN APPLICATION FOR EACH METER HAS BEEN SUBMITTED TO THE AGENCY.
 - B) ALL APPLICABLE CHARGES HAVE BEEN PAID.
 - C) THE CONTRACTOR HAS BROUGHT THE WATER METER BOXES AND SERVICE CONNECTIONS TO FINISHED CURB AND SIDEWALK GRADE.
9. IT SHALL BE THE DEVELOPER'S DUTY TO CAUSE THE SEWER OR LATERALS TO MEET THE REQUIREMENTS OF STANDARD 2100-0 OF THE LOS ANGELES COUNTY DEPARTMENT OF PUBLIC WORKS AND WATERWORKS DISTRICT STANDARD W-50.
10. PROPOSED UTILITY INFORMATION, AND LOCATIONS SHOWN ON THIS PLAN ARE SUBJECT TO CONTRACTUAL ARRANGEMENTS WITH THE DEVELOPER. CONTRACTOR SHALL CHECK THIS INFORMATION WITH THE APPROPRIATE UTILITY COMPANY.
11. FIRE HYDRANT RISERS SHALL BE INSTALLED AS SHOWN IN THE APPLICABLE DISTRICT STANDARD DRAWINGS. ANY NECESSARY ADJUSTMENT OF FIRE HYDRANT FLANGE ELEVATION SHALL BE DEVELOPER'S EXPENSE AT TIME FINAL FINISH GRADE IS DEVELOPED.
12. ALL NEW WORK SHALL BE TESTED VALVE TO VALVE AT 200 P.S.I. FOR FOUR HOURS, UNLESS OTHERWISE SPECIFIED. PRESSURE TESTING SHALL NOT BE CONDUCTED AGAINST ANY NEW OR EXISTING VALVE THAT IS CONNECTED TO THE DISTRICT'S EXISTING DISTRIBUTION SYSTEM. THE CONTRACTOR SHALL DESIGN, FURNISH AND INSTALL ANY NECESSARY THRUST BLOCKS IN ACCORDANCE WITH STANDARD W-21, OR AS SHOWN ON THESE PLANS.
13. DISINFECTION: CONTRACTOR SHALL TAKE ALL MEASURES NECESSARY TO ASSURE SANITARY INSTALLATION. HE SHALL ENDEAVOR TO KEEP ALL DIRT, RODENTS, INSECTS, ETC. AWAY FROM WATERWAY. DISINFECTION VALVES SHALL BE KEPT CLOSED (EXCEPT DURING FILLING AND FLUSHING, WHEN VALVES SHALL BE OPERATED TO INSURE FLOW TOWARD NEW DISCHARGE) AND LEFT CLOSED AT ALL OTHER TIMES UNTIL AFTER PRESSURE TEST, DISINFECTION, FLUSHING AND BACTERIAL TEST HAS BEEN PASSED. CONTRACTOR SHALL NOTIFY AGENCY AT LEAST 24 HOURS IN ADVANCE OF ANY OPERATION OF ISOLATION VALVES WHICH SHALL BE OPERATED ONLY BY AGENCY PERSONNEL. AGENCY WILL ARRANGE FOR BACTERIOLOGICAL TEST SAMPLING OF WATER MAINS UPON NOTIFICATION BY CONTRACTOR. AGENCY WILL ALSO ARRANGE FOR CONCURRENT BACTERIOLOGICAL TEST SAMPLING OF SUPPLY.
14. IF THE DEVELOPER DESIRES TEMPORARY WATER SERVICE FOR CONSTRUCTION AND TO OPERATE HOUSE PLUMBING PRIOR TO INSTALLATION OF PERMANENT WATER METER, THE CONTRACTOR SHALL APPLY FOR INSTALLATION BY THE DISTRICT, OF TEMPORARY CONSTRUCTION METER(S) OFF FIRE HYDRANTS OR FLUSHOUTS. THE ISSUANCE OF TEMPORARY CONSTRUCTION METER(S) DURING THE SUMMER MONTHS MAY BE RESTRICTED BASED ON AVAILABLE WATER SUPPLY.
15. INTERCONNECTIONS: CONTRACTOR SHALL NOTIFY THE AGENCY, IN WRITING, TWO WORKING DAYS IN ADVANCE THAT HE IS PREPARED WITH ALL LABOR, MATERIAL, EQUIPMENT AND NECESSARY TO MAKE THE CONNECTION. THE AGENCY WILL MARK ON THE SURFACE THE DISTRICT'S EXISTING FACILITIES, AND WILL PROVIDE SUPERVISION ONLY FOR CONTRACTOR TO MAKE INSTALLATION. THE CONTRACTOR SHALL EXCAVATE, INSTALL CONNECTIONS, BACKFILL AND REPAIR ANY DAMAGES AT HIS EXPENSE.
16. ANY MATERIAL SALVAGED FROM THE EXISTING WATER SYSTEM BY THE CONTRACTOR SHALL BE RETURNED BY THE CONTRACTOR TO THE AGENCY (260 EAST AVENUE, LANCASTER, CA 93330) UNLESS SUCH MATERIAL IS DETERMINED BY THE ENGINEER TO BE OF A TYPE OR QUALITY WHICH IS EQUIVALENT TO NEW MATERIAL REQUIRED FOR THIS WORK, IN WHICH CASE THE CONTRACTOR WILL BE ALLOWED TO USE SUCH EQUIVALENT SALVAGED MATERIAL IN PLACE OF NEW MATERIAL. CONTRACTOR SHALL RECOAT, REPAINT, REWORK, CLEAN AND TEST SUCH MATERIAL TO THE SATISFACTION OF THE ENGINEER BEFORE RE-INSTALLING SAME.
17. PIPE LENGTHS IN ENGINEER'S "ESTIMATED" QUANTITIES WERE CALCULATED ON A HORIZONTAL OFFSET. PIPE LENGTHS ADJUSTMENT FOR JOGS, SLOPES, VALVES, AND FITTINGS HAS NOT BEEN MADE.
18. CONTRACTOR SHALL MAKE ARRANGEMENTS TO ADJUST VALVE BOXES, FIRE HYDRANT FLANGES, METER BOXES, VAULTS, ETC. TO SUBDIVISION FINISH GRADE AT TIMES WHEN FINISH GRADES ARE ESTABLISHED BY OTHERS AT NO COST TO AGENCY.
19. CONTRACTOR SHALL NOT UNREASONABLY RESTRICT THE USE OF PUBLIC RIGHT-OF-WAY OR ACCESS TO ADJACENT PREMISES.
20. IN ADDITION TO ITEMS IN LIST OF MATERIALS, CONTRACTOR SHALL FURNISH ALL NECESSARY ADAPTORS, COUPLINGS, BOLTS, GASKETS, CAULKING MATERIALS, AND REPAVING MATERIALS AS REQUIRED TO COMPLETE THE WORK.
21. BEFORE BACKFILLING TRENCH, ALL EXPOSED UNDERGROUND METAL SURFACES, UNLESS NOTED OTHERWISE OR SPECIFIED ELSEWHERE IN THE PLANS AND SPECIFICATIONS, SHALL BE COATED WITH A 2-INCH MINIMUM THICKNESS OF 1,000 LB. CEMENT MORTAR, [THREE (3) PARTS SAND TO ONE (1) PART PORTLAND CEMENT TO ONE (1) PART LIME.]
22. CLEARANCE: (EXCEPT SEWERS - SEE NOTE 3) UNLESS NOTED OTHERWISE IN THE PLANS AND SPECIFICATIONS, IT SHALL BE THE DEVELOPER'S DUTY TO ARRANGE ALL OTHER EXISTING OR PROPOSED PROJECT IMPROVEMENTS INCLUDING ALL UNDERGROUND STRUCTURES AND UTILITY LINES TO PROPERLY CLEAR WATER PIPE AS SPECIFIED BELOW.
 - A) HORIZONTAL : 48 - INCHES OUTSIDE - TO - OUTSIDE FROM STORM DRAINS; 24 - INCHES OUTSIDE - TO - OUTSIDE FROM ALL OTHER;
 - B) VERTICAL : 12 - INCHES OUTSIDE - TO - OUTSIDE
23. THE CONTRACTOR IS TO NOTIFY THE AGENCY, TELEPHONE (661-940-9270, LANCASTER), AT LEAST THREE (3) WORKING DAYS BEFORE STARTING ANY WORK ON THIS PROJECT.
24. THE CONTRACTOR SHALL VERIFY THE SIZE, TYPE, CLASS, PROTECTIVE LINING AND COATING, AND DEPTH OF THE EXISTING WATER MAIN AND SHALL BE RESPONSIBLE FOR MAKING THE PROPER CONNECTIONS.
25. THE DEVELOPER MUST PROCEED WITH, AND COMPLETE, THE REQUIRED WATER SYSTEM IMPROVEMENTS WITHIN ONE YEAR OF THE DATE OF THE DISTRICT APPROVAL OF THE PLANS. AFTER THE 12-MONTH PERIOD, THE DISTRICT REQUIREMENTS ARE SUBJECT TO CHANGE. IF NO IMPROVEMENTS HAVE COMMENCED WITHIN A 24-MONTH PERIOD FROM APPROVAL DATE, THE PLANS MUST BE RE-ISSUED BY THE DISTRICT.
26. METERED WATER SERVICE CONNECTIONS MAY ONLY BE INSTALLED AFTER RECEIPT AND PROCESSING OF WATER SERVICE APPLICATION BY THE AGENCY AND PAYMENT OF APPLICABLE CHARGES. IF SERVICES ARE NOT TO BE INSTALLED PER THIS PLAN, SEPARATE SPECIFICATIONS WILL THEN BE ISSUED BY THE AGENCY THEREFOR.
27. WHERE PUBLIC FIRE HYDRANTS ARE INSTALLED OR UPGRADED, THE CONTRACTOR SHALL INSTALL A TWO-WAY BLUE REFLECTIVE RAISED PAVEMENT MARKER ALSO COMMONLY CALLED "BLUE DOTS". REFLECTORS SHALL COMPLY AND BE INSTALLED PER SECTION 214, "PAVEMENT MARKERS" OF THE LATEST EDITION OF THE STANDARD SPECIFICATIONS FOR PUBLIC WORKS CONSTRUCTION. ONE MARKER SHALL BE INSTALLED PERPENDICULARLY OPPOSITE EACH HYDRANT, APPROXIMATELY 6 INCHES OFFSET FROM THE CENTERLINE OF THE STREET ON THE HYDRANT SIDE OF THE STREET. (TWO MARKERS SHALL BE REQUIRED IN THE CITY OF LANCASTER).
28. THE EXISTENCE AND LOCATION OF ANY UNDERGROUND UTILITIES, PIPES AND/OR STRUCTURES SHOWN ON THESE PLANS WERE OBTAINED BY A SEARCH OF AVAILABLE RECORDS, TO THE BEST OF OUR KNOWLEDGE. THERE ARE NO EXISTING UTILITIES EXCEPT AS SHOWN ON THESE PLANS. THE CONTRACTOR SHALL ASCERTAIN THE TRUE LOCATION OF ANY UNDERGROUND UTILITIES AND SHALL BE RESPONSIBLE FOR DAMAGE TO ANY PUBLIC OR PRIVATE UTILITIES SHOWN OR NOT SHOWN HEREON. IT IS ALSO SUGGESTED THAT THE CONTRACTOR POTHOLE THE AREA PRIOR TO INSTALLATION TO MAKE SURE CONNECTIONS CAN BE MADE ACCORDING TO PLAN. ANY CHANGES TO THE PLANS MUST BE APPROVED BY THE ENGINEER.
29. ASBESTOS CEMENT PIPE SHALL NOT BE CUT. A WHOLE SECTION LENGTH OF ACP SHALL BE REMOVED BY BREAKING THE JOINTS WHEN REQUIRED. REMOVAL SHALL BE IN ACCORDANCE WITH STANDARD AND THE LAW OF THE STATE OF CALIFORNIA. SAW CUTTING THIS PIPE SHALL NOT BE USED. ALL ASBESTOS RESIDUE SHALL BE REMOVED FROM THE JOB SITE AND DISPOSED IN ACCORDANCE TO STATE LAW. THE CONTRACTOR WORKING WITH ASBESTOS MATERIALS MUST HAVE REGISTRATION FOR THIS WORK FROM CAL-OSHA.
30. CONTRACTOR SHALL POSSESS A VALID "A", "C-34", OR "SC-34" CONTRACTORS LICENSE.
31. A DISTRICT APPROVED BACKFLOW PREVENTION ASSEMBLY, OF THE TYPE SPECIFIED IS REQUIRED WHEN POTENTIAL BACKFLOW HAZARDS TO THE DISTRICT WATER SUPPLY EXIST. THE BACKFLOW PREVENTION ASSEMBLY SHALL BE INSTALLED ABOVE GROUND DIRECTLY AFTER THE METER. NO CONNECTIONS ARE ALLOWED BETWEEN THE METER AND THE BACKFLOW ASSEMBLY. THE VALVE SHALL BE CONTINUOUSLY LUBRICATING AND OIL FILLED PER STANDARD PLAN W-22 AND THE REMAINING VOID SHALL BE FILLED WITH TYPE "A" BASE OR APPROVED EQUIVALENT. IF THE VOID IS WITHIN THE SIDEWALK, THE VOID SHALL BE FILL WITH TYPE "A" BASE OR APPROVED EQUIVALENT. IN SIDEWALK AREAS THE CONCRETE SIDEWALK SHALL BE REPAIRED AND REPLACED TO THE SATISFACTION OF THE PERMIT INSPECTOR.
32. WATER MAINS TO BE ABANDONED:
 - A) THE WATER MAIN TO BE ABANDONED SHALL BE COMPLETELY DRAINED.
 - B) APPROXIMATELY EVERY 250 FEET MORE OR LESS, A SHORT SECTION OF WATER MAIN IS TO BE REMOVED AND EACH END OF THE WATER MAIN TO BE ABANDONED SHALL BE CONCRETE SEALED PER STANDARD PLAN W-22.
 - C) WHERE VALVES OR FITTINGS ARE REQUIRED TO BE REMOVED, THE EXISTING WATER MAIN OR FITTING TO REMAIN IN SERVICE SHALL BE BLIND FLANGED. VALVES OR FITTINGS ARE REQUIRED TO BE REMOVED, THE EXISTING WATER MAIN OR FITTING TO REMAIN IN SERVICE SHALL BE BLIND FLANGED.
 - D) FOR ALL GATE VALVES THAT ARE ON A WATER MAIN, FIRE HYDRANT LATERAL, SERVICE CONNECTION LARGER THAN 2" DIAMETER, OR OTHER APPURTENANCES, EXCEPT SERVICE CONNECTIONS AND METERS, AND SMALLER IN DIAMETER, THE CONTRACTOR SHALL REMOVE AND SALVAGE VALVES AND FITTINGS AND THE REMAINING VOID SHALL BE FILLED WITH TYPE "A" BASE OR APPROVED EQUIVALENT. IF THE VOID IS WITHIN THE SIDEWALK, THE VOID SHALL BE FILL WITH TYPE "A" BASE OR APPROVED EQUIVALENT. IN SIDEWALK AREAS THE CONCRETE SIDEWALK SHALL BE REPAIRED AND REPLACED TO THE SATISFACTION OF THE PERMIT INSPECTOR.
 - E) FOR ALL ABANDONED FIRE HYDRANTS AND AIR & VACUUM RELEASE VALVE ASSEMBLIES (ARV) ON AN ABANDONED WATER MAIN, THE FIRE HYDRANT BASE SHALL BE REMOVED AND BELOW GROUND FIRE HYDRANT OR ARV RISER SHALL BE CUT OFF BELOW GROUND DOWN TO THE FINISHED LEVEL WITH THE SURROUNDING AREA USING NATIVE MATERIAL OR CONCRETE, AS REQUIRED.
33. ALL BURIED PIPING, INCLUDING MAINS, HYDRANT LATERALS, FLUSHOUT LATERALS, AIR RELEASE VALVE LATERALS, AND OTHER APPURTENANCES SHALL BE INSTALLED WITH FACILITY IDENTIFICATION WARNING TAPE (SEE SPECIFICATIONS).

LEGEND

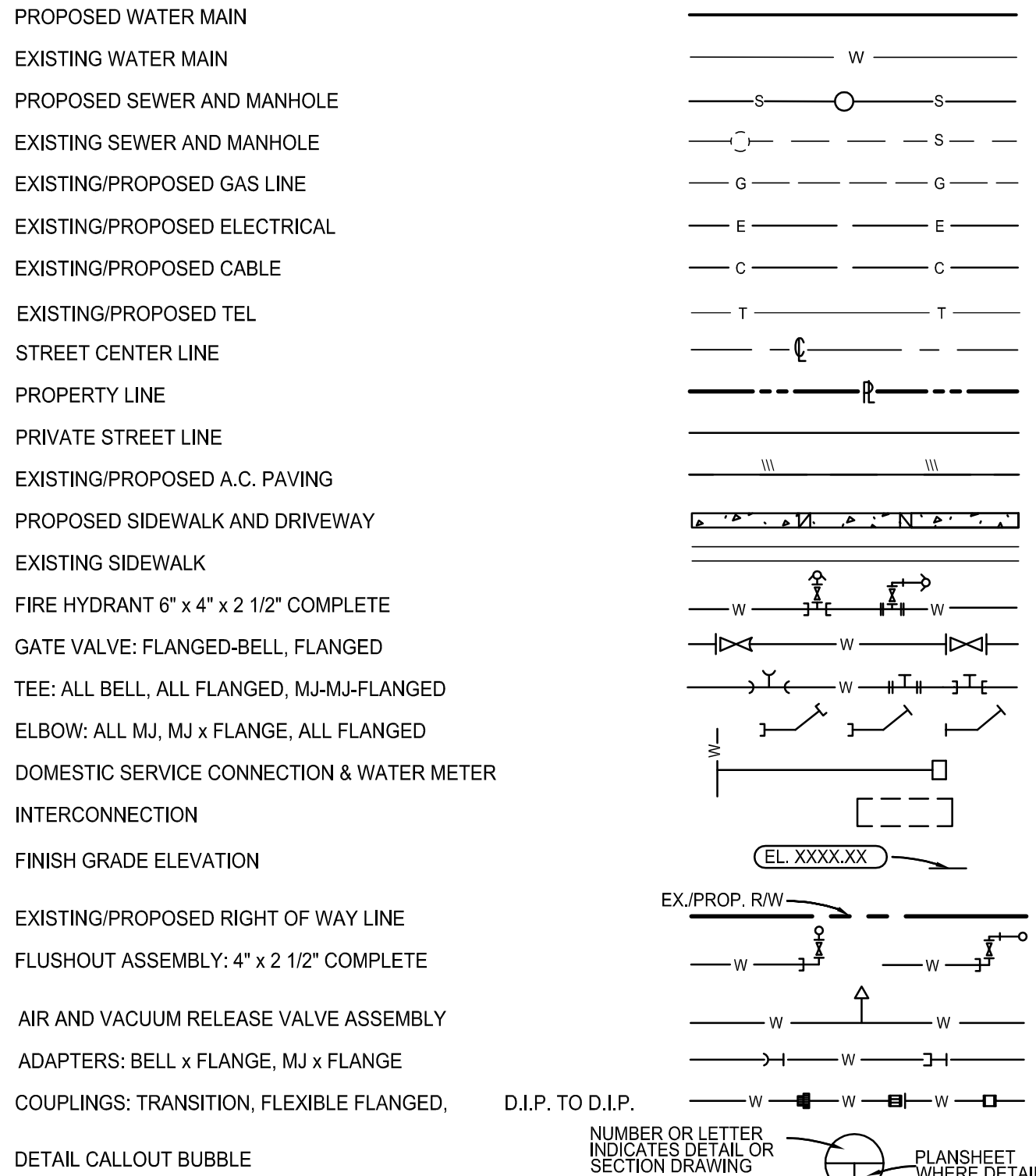

STATISTICS

NUMBER OF LOTS	1
NUMBER OF ACRES	9.53
LANDSCAPE / IRRIGATION AREA SQ. FT / ACRES	9.0
FEET OF WATERMAIN	45
PUBLIC FIRE FLOW, G.P.M. @ 20 PSI RESIDUAL *	1500
DURATION OF PUBLIC FIRE FLOW, HOURS *	2
FIRE SPRINKLER DEMAND, G.P.M. *	506.4 GPM

* SUBJECT TO FIRE DEPARTMENT APPROVAL

HWL OF PRESSURE ZONE	2750
DISTRIBUTION SHEET.	M-06W

UNDERGROUND SERVICE ALERT



Know what's below.
Call before you dig.

TWO (2) WORKING DAYS BEFORE YOU DIG

ARTICLE 2, SECTION 4216 OF THE GOVERNMENT CODE REQUIRES A DIG ALERT IDENTIFICATION NUMBER BE ISSUED BEFORE A "PERMIT TO EXCAVATE" WILL BE VALID. FOR YOUR DIG ALERT I.D. NUMBER CALL UNDERGROUND SERVICE ALERT AT THE NUMBER ABOVE.

NOTES:

1. APPROVAL OF THESE PLANS DO NOT CONSTITUTE, IN ANY WAY, A COMMITMENT BY THE DISTRICT TO PROVIDE WATER SERVICE TO THIS PROJECT OR THE DEVELOPMENT.
2. FOR ALL DOMESTIC WATER METERS WITH STATIC PRESSURE OF 80 PSI OR GREATER, PRESSURE REGULATORS ARE REQUIRED TO BE INSTALLED AND MAINTAINED BY THE OWNER / DEVELOPER ON HIGHER SIDE OF THE WATER METER PER LOS ANGELES COUNTY PLUMBING CODE, SECTION 1007.

LIST OF MATERIALS

ITEM NO.	DESCRIPTION	ENGINEER'S "ESTIMATED" QUANTITIES					
		SHEET NUMBER					UNIT
1	6 1/2" O.D. STEEL PIPE, SCH. 40 MIN. CML & CMC (SEE NOTE 33)	45					45 LF
2	12" X 6" TAPPING SLEEVE (AC PIPE), W/6" FLANGED OUTLET, (CL-125), EPOXY-LINED & CMC	1					1 EA
3	6" FLANGED TAPPING GATE VALVE, 200 PSI WWP, NRS FLANGED ENDS (CL-125) W/ ADJUSTABLE VALVE BOX PER LACWD STD. PLAN W-15.	1					1 EA
4	6" SLIP-ON WELD FLG. STL, CL 150, CMC	1					1 EA
5	6" REDUCED PRESSURE PRINCIPLE DETECTOR CHECK ASSEMBLY, W/ 1/2" BYPASS METER, AMR/AMI COMPATIBLE & BALL VALVES COMPLETE PER LACWD STD PLAN W-6. (NOTE: ALL ABOVE GROUND PARTS TO BE INSULATED) (SEE GENERAL NOTE 3)	1					1 EA
6*	STREET REPAIR AS REQUIRED PER CITY OF PALMDALE ENCROACHMENT PERMIT	AS REQ					AS REQ SF
7	P.C.C. THRUST BLOCK PER LACWD STD. W-21 (AS REQUIRED EVEN IF NOT SHOWN).	1					1 EA

* NOT A PART OF DISTRICT APPROVAL

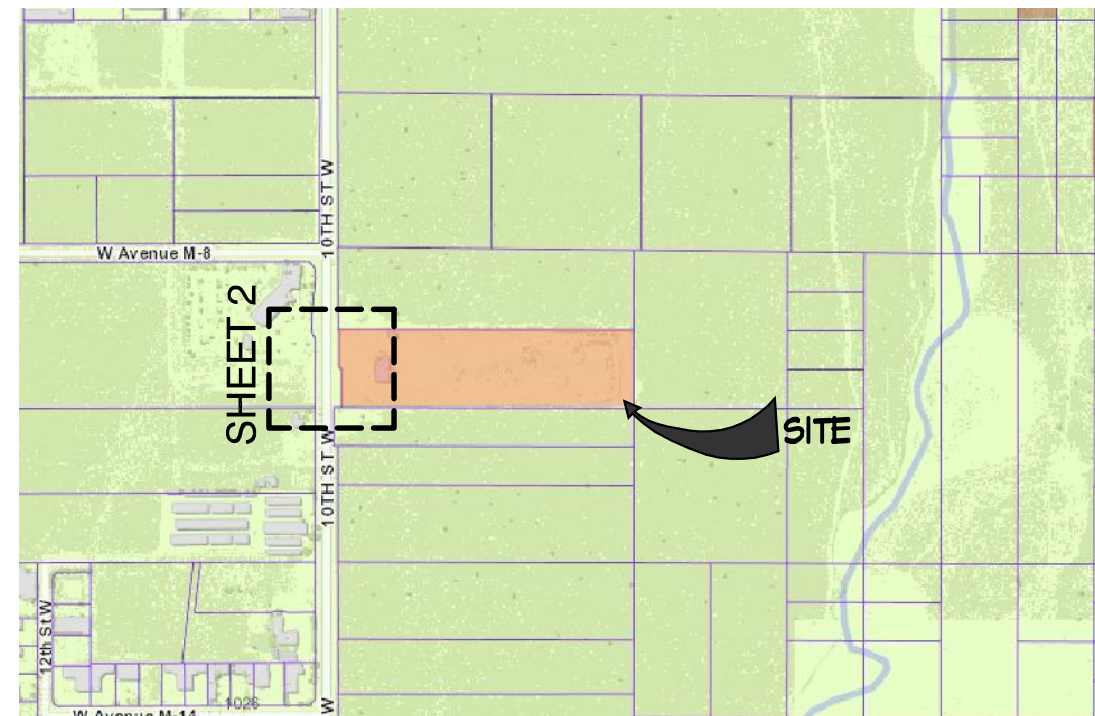

LOCATION MAP

NOT TO SCALE

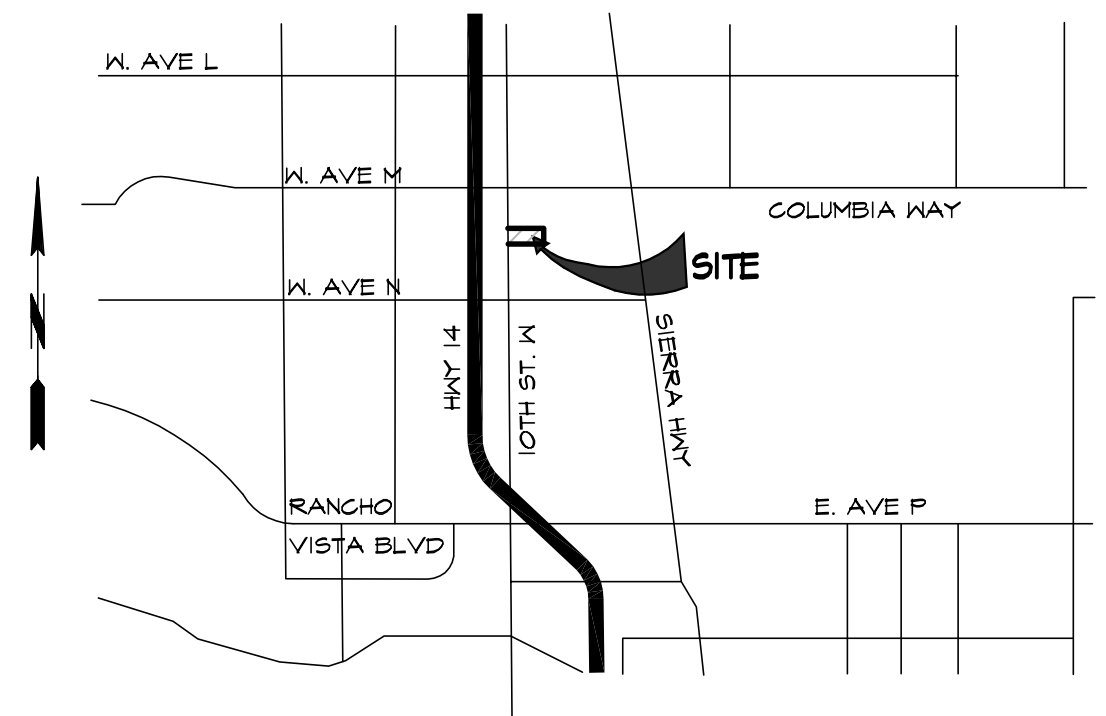

VICINITY MAP

T.G. PAGE 4105-G7
NOT TO SCALE

SHEET INDEX MAP

SHEET No.	DRAWING TITLE
1	TITLE SHEET, SHEET INDEX, VICINITY AND LOCATION MAPS
2	WATER PLAN

THIS DRAWING IS THE PROPERTY OF THE LOS ANGELES COUNTY WATERWORKS DISTRICTS. THE INFORMATION SHOWN HEREON IS NOT REPRESENTED OR WARRANTED TO BE COMPLETE, ACCURATE OR UP-TO-DATE. NO PERMISSION IS GRANTED FOR IT TO BE REPRODUCED OR COPIED.

CITY OF PALMDALE - PLANNING DEPARTMENT
APPROVAL OF RPDA WALL/SCREENING COMPLIANCE

Jasmine Almora
SIGNATURE
08/20/2024
DATE
Jasmine Almora, Associate Planner
NAME/TITLE

LOS ANGELES COUNTY WATERWORKS DISTRICT NO. 40, ANTELOPE VALLEY SPEC. NO. WWD 4-2212 (PC)		SHEET 1
DEVELOPER: CLASICO SPORTS, LLC 39626 10th St. West, Suite F Palmdale, CA 93551	JOB NO. Y5046679	OF
IMPROVEMENTS: 6-INCH RPDA FOR FIRE SERVICE	INQUIRY NO. I 38065-04	2
LOCATION: 41520 10TH STREET WEST APN: 3128-016-040	DWG. NO. 4-2212.PC.1	SHEETS

CRC Enterprises

27600 Bouquet Canyon Road, Suite 200
Santa Clarita, CA 91350
Telephone (661) 297-2336
email:

PLANS PREPARED UNDER THE DIRECTION OF:

RON KOESTER ROE # 42399
08-08-24
DATE

REVIEWED FOR COMPLIANCE
WITH DISTRICT REQUIREMENTS



LACWD

LOS ANGELES COUNTY WATERWORKS DISTRICTS
LOS ANGELES COUNTY PUBLIC WORKS

FOR DISTRICT USE ONLY
PLAN CHECKER
APPROVED BY:
ASSISTANT DEPUTY DIRECTOR
9/26/2024
DATE

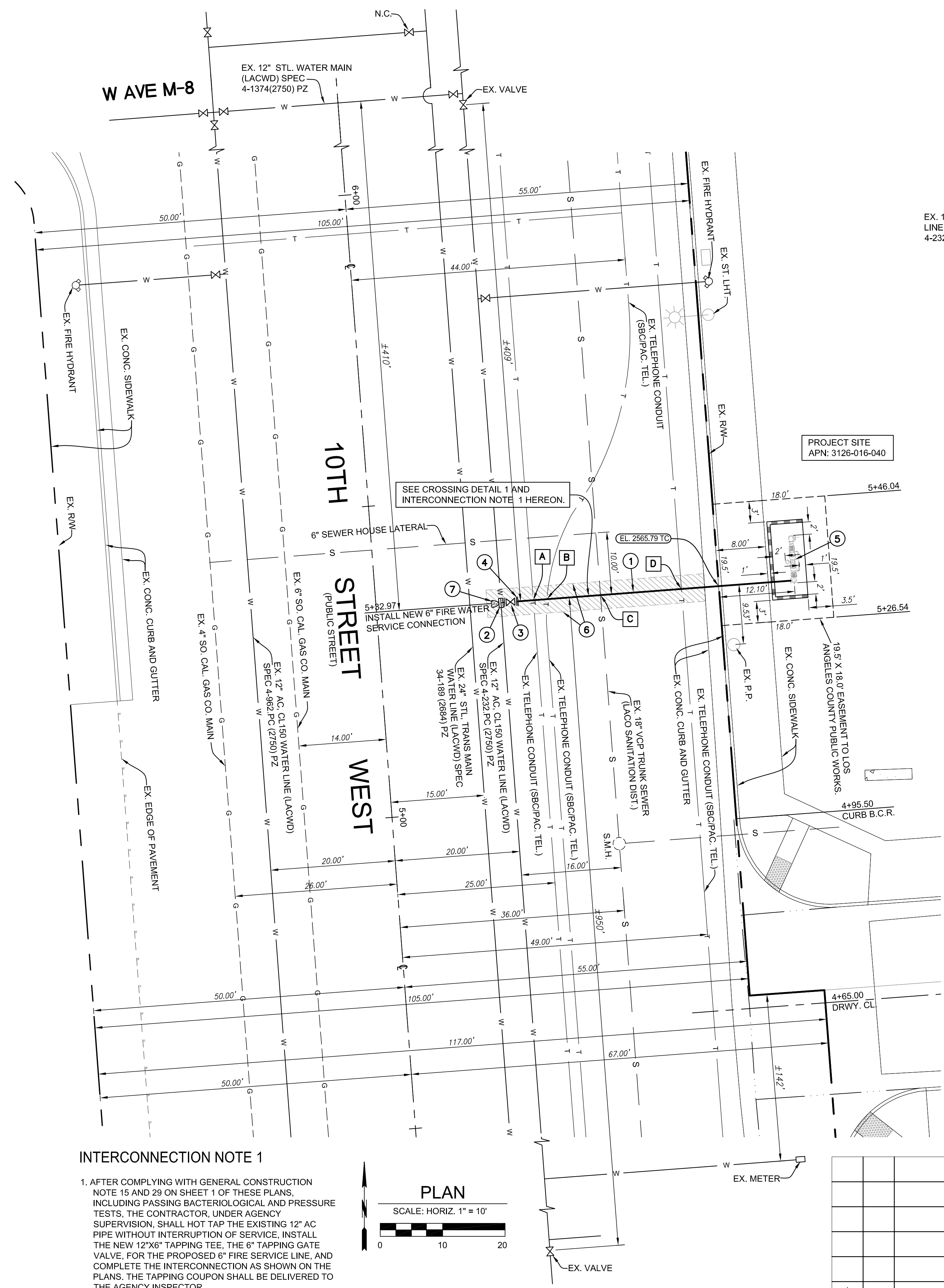

INTERCONNECTION NOTE 1

1. AFTER COMPLYING WITH GENERAL CONSTRUCTION NOTE 15 AND 29 ON SHEET 1 OF THESE PLANS, INCLUDING PASSING BACTERIOLOGICAL AND PRESSURE TESTS, THE CONTRACTOR, UNDER AGENCY SUPERVISION, SHALL HOT TAP THE EXISTING 12" AC PIPE WITHOUT INTERRUPTION OF SERVICE, INSTALL THE NEW 12"x6" TAPPING TEE, THE 6" TAPPING GATE VALVE, FOR THE PROPOSED 6" FIRE SERVICE LINE, AND COMPLETE THE INTERCONNECTION AS SHOWN ON THE PLANS. THE TAPPING COUPON SHALL BE DELIVERED TO THE AGENCY INSPECTOR.

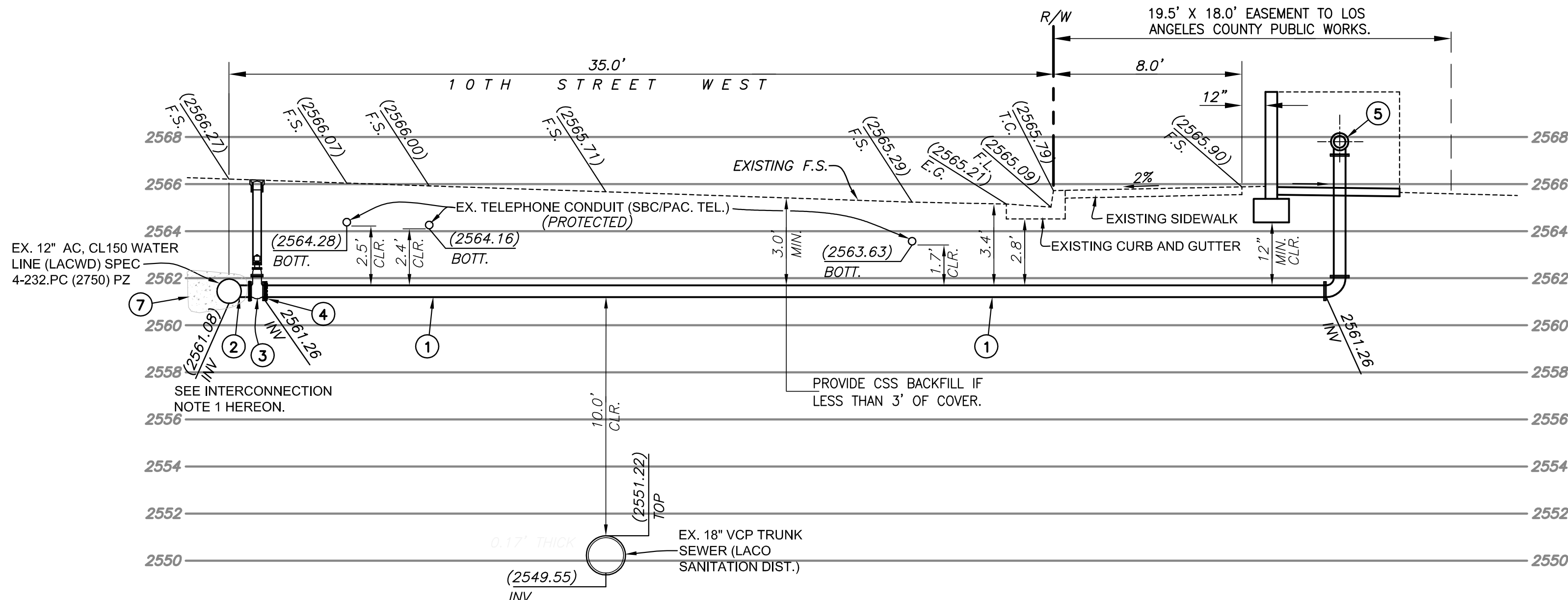
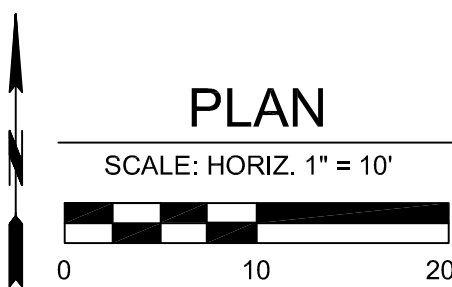

CROSSING DETAIL 1

STA. 5+38.18
SCALE: 1"=4'

LOCATION OF CROSSINGS	6" RPDA FIRE WATER LATERAL		SEWER MAIN		TEL. CONDUIT		F.S. ELEV.	CLEARANCE
	T.O.P. ELEV.	B.O.P. ELEV.	T.O.P. ELEV.	B.O.P. ELEV.	T.O.P. ELEV.	B.O.P. ELEV.		
A 25' E/O ST. CENTERLINE	2561.78	2561.24			2564.44	2564.28	(2566.07)	2.5' CLEARANCE
B APROX. 28.5' E/O ST. CL.	2561.78	2561.24			2564.32	2564.16	(2566.00)	2.4' CLEARANCE
C 36' E/O ST. CENTERLINE	2561.78	2561.24	2551.22	2549.38			(2565.71)	10.0' CLEARANCE
D 49' E/O ST. CENTERLINE	2561.78	2561.24			2563.79	2563.63	(2565.29)	1.9' CLEARANCE

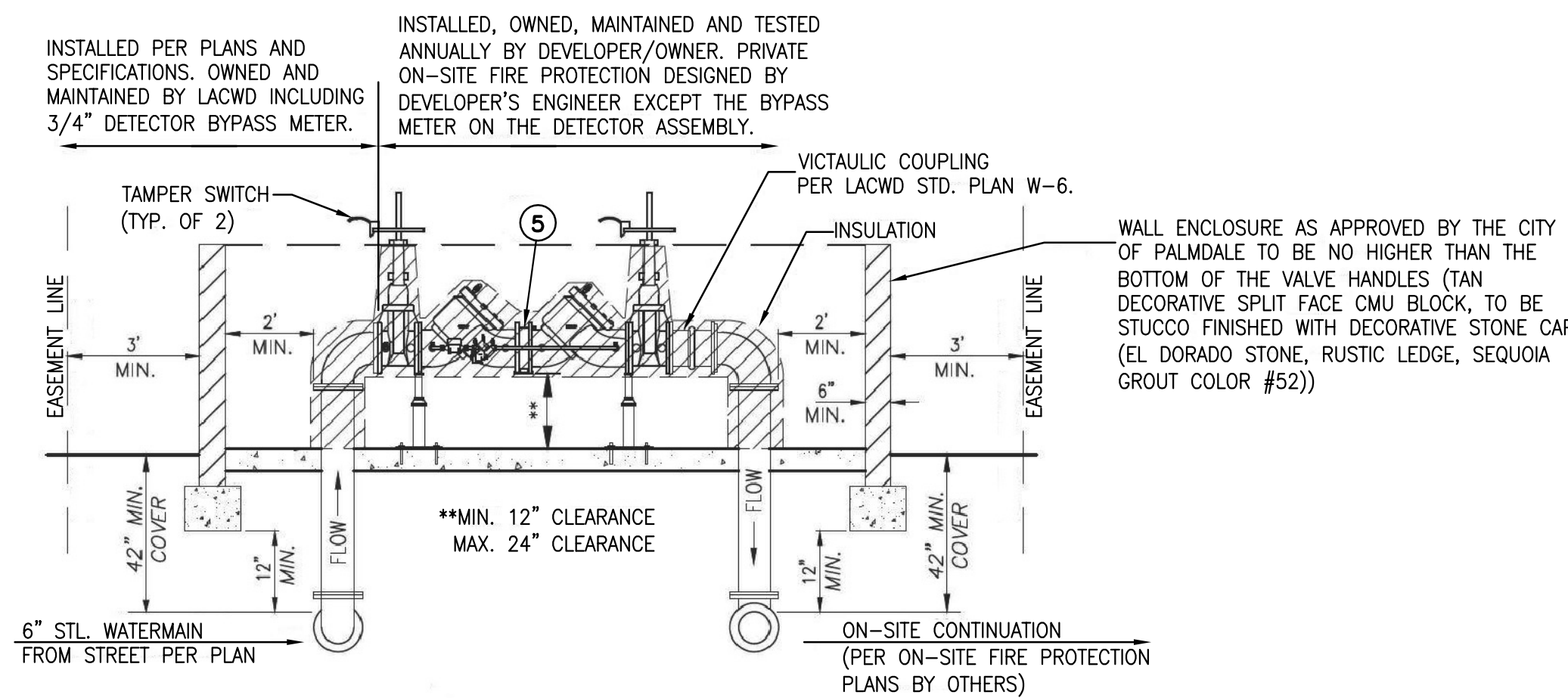

R.P.D.A. SECTION

N.T.S.
SEE LACWD STANDARD W-6 FOR COMPLETE DETAILS

REFER TO SECTION 7-10.4.1 OF THE STANDARD SPECIFICATIONS REGARDING SAFETY ORDERS

THIS DRAWING IS THE PROPERTY OF THE LOS ANGELES COUNTY WATERWORKS DISTRICTS. THE INFORMATION SHOWN HEREON IS NOT REPRESENTED OR WARRANTED TO BE COMPLETE, ACCURATE OR UP-TO-DATE. NO PERMISSION IS GRANTED FOR IT TO BE REPRODUCED OR COPIED.

NO.	DATE	REVISION	SUBMIT BY	APPROV BY

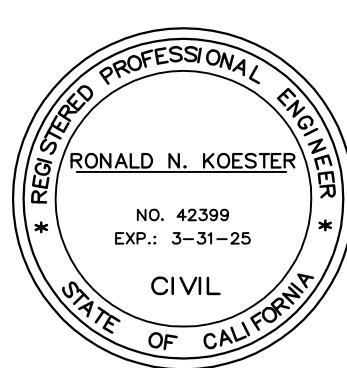

CRC Enterprises
27600 Bouquet Canyon Road, Suite 200
Santa Clarita, CA 91350
Telephone (661) 297-2336
email:

PLANS PREPARED UNDER THE DIRECTION OF:

RON KOESTER ROE # 42399

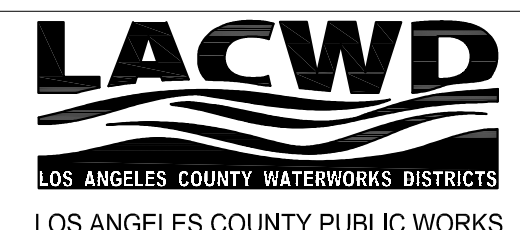

FOR DISTRICT USE ONLY
APPROVED BY: *[Signature]*
DATE: 08-08-24
ASSISTANT DEPUTY DIRECTOR

LOS ANGELES COUNTY WATERWORKS DISTRICT NO. 40, ANTELOPE VALLEY SPEC. NO. WWD 4-2212 (PC)	
DEVELOPER: CLASICO SPORTS, LLC 39626 10th St. West, Suite F Palmdale, CA 93551	JOB NO. Y5046679
IMPROVEMENTS: 6-INCH RPDA FOR FIRE SERVICE	INQUIRY NO. I 38065-04
LOCATION: 41520 10TH STREET WEST APN: 3128-016-040	DWG. NO. 4-2212.PC.2

SHEET
2
OF
2
SHEETS