

City of Lynwood Annexations

NO	TYPE	NAME	SEC. OF STATE	CNTY RECORDER	ANNEX AREA	TOTAL AREA
1	A	Incorporation	07-16-24			
2	A	Addition No. 1	06-13-24			
3	A	Addition No. 2	07-08-24			
4	A	Addition No. 3	07-08-24			
5	A	Addition No. 4	07-12-24			
6	A	Addition No. 6	08-30-24			
7	A	Addition No. 7	10-14-24			
8	A	Wawona Park Addition	08-15-27			
9	A	Uninhabited Territory	10-14-27			
10	A	Bulls Addition	11-25-27			
11	A	East Lynwood Addition	11-25-27			
12	A	Palomar Addition	12-16-27			
13	A	Broadacres Annexation	07-19-41	07-30-41	0.143 Sq. miles	3,433 Sq. miles
14	A	Ozell Manor Annexation	07-12-48	11-03-48	0.024	3,457
15	A	Ozell Manor Annex. No. 2	11-15-48	11-17-48	0.001	3,458
16	A	Caress St. Annex. No. 1	05-19-49	05-25-49	0.000	3,458
17	A	Wright Rd. Annex. No. 2	11-09-49	11-18-49	0.014	3,472
18	A	Wright Rd. Annex. No. 1	12-27-49	12-29-49	0.032	3,504
19	A	Bulls Rd. Annex. No. 1	05-27-50	06-05-50	0.001	3,505
20	A	Wright Rd. Annex. No. 3	06-12-50	06-19-50	0.107	3,612
21	A	Ozell Manor Annex. No. 3	07-10-50	07-19-50	0.024	3,636
22	A	Alameda Annex. No. 1	09-25-50	09-29-50	0.030	3,666
23	A	Wright Rd. Annex. No. 4	02-26-51	03-06-51	0.003	3,669
24	A	Wright Rd. Annex. No. 5	08-25-52	09-04-52	0.036	3,705
25	A	Ozell Manor Annex. No. 4	11-01-54		0.018	3,723
26	A	Wright Rd. Annex. No. 6	11-08-54		0.018	3,741
27	A	Wright Rd. Annex. No. 7	02-07-55		0.005	3,746
28	A	Wright Rd. Annex. No. 8	05-09-55		0.014	3,750
29	A	Wright Rd. Annex. No. 9	10-17-55		0.003	3,763
30	A	Ozell Manor Annex. No. 5	12-27-55		0.004	3,767
31	A	Wright Rd. Annex. No. 10	07-30-56		0.009	3,776
32	A	Ozell Manor Annex. No. 6	09-11-56		0.008	3,784
33	A	Alameda St. Annex. No. 2	12-20-56		0.068	3,852
34	A	Alameda St. Annex. No. 3	01-07-57		0.003	3,855
35	A	Ozell Manor Annex. No. 8	06-10-57	06-17-57	0.031	3,886
36	A	Ferwood Ave. Annex. No. 1	12-21-62	12-27-62	0.003	3,889
37	A	Atlantic Ave. Annex. No. 1	12-21-62	12-27-62	0.005	3,894
38	A	Atlantic Ave. Annex. No. 2	12-21-62	12-27-62	0.006	3,900
39	A	Atlantic Ave. Annex. No. 3	08-19-63	08-29-63	0.001	3,901
40	A	Alameda St. Annex. No. 5	04-21-64	04-28-64	0.002	3,903
41	A	Atlantic Ave. Annex. No. 5	09-03-64	09-03-64	0.002	3,905
42	A	Ferwood Ave. Annexation No. 3	09-28-64	09-28-64	0.000	3,905
43	A	Alameda St. Annex. No. 5-A	03-11-65		0.001	3,906
44	A	Alameda St. Annex. No. 7	05-24-65		0.026	3,931
45	A	El Granada Ave. Annex. No. 1	06-29-65		0.002	3,933
46	A	Duncan Ave. Annex. No. 1	08-16-65		0.045	3,978
47	A	Atlantic Ave. Annex. No. 7-A	11-02-65		0.531	4,509
48	A	Atlantic Ave. Annex. No. 6	12-06-65		0.003	4,512
49	A	Olinda St. Annex. No. 1	08-30-66		0.032	4,544
50	A	Century Blvd. Annex. No. 2	11-10-66		0.252	4,796
51	A	Mona Blvd. Annex. No. 1	07-25-69		0.007	4,803
52	A	Jorgensen Annexation	09-03-69		0.039	4,842
53	A	Annex. No. 1 (Jones Lumber)	01-23-79		0.004	4,846
54	A	Annex. No. 2 (Jones Lumber)	11-02-82		0.002	4,848

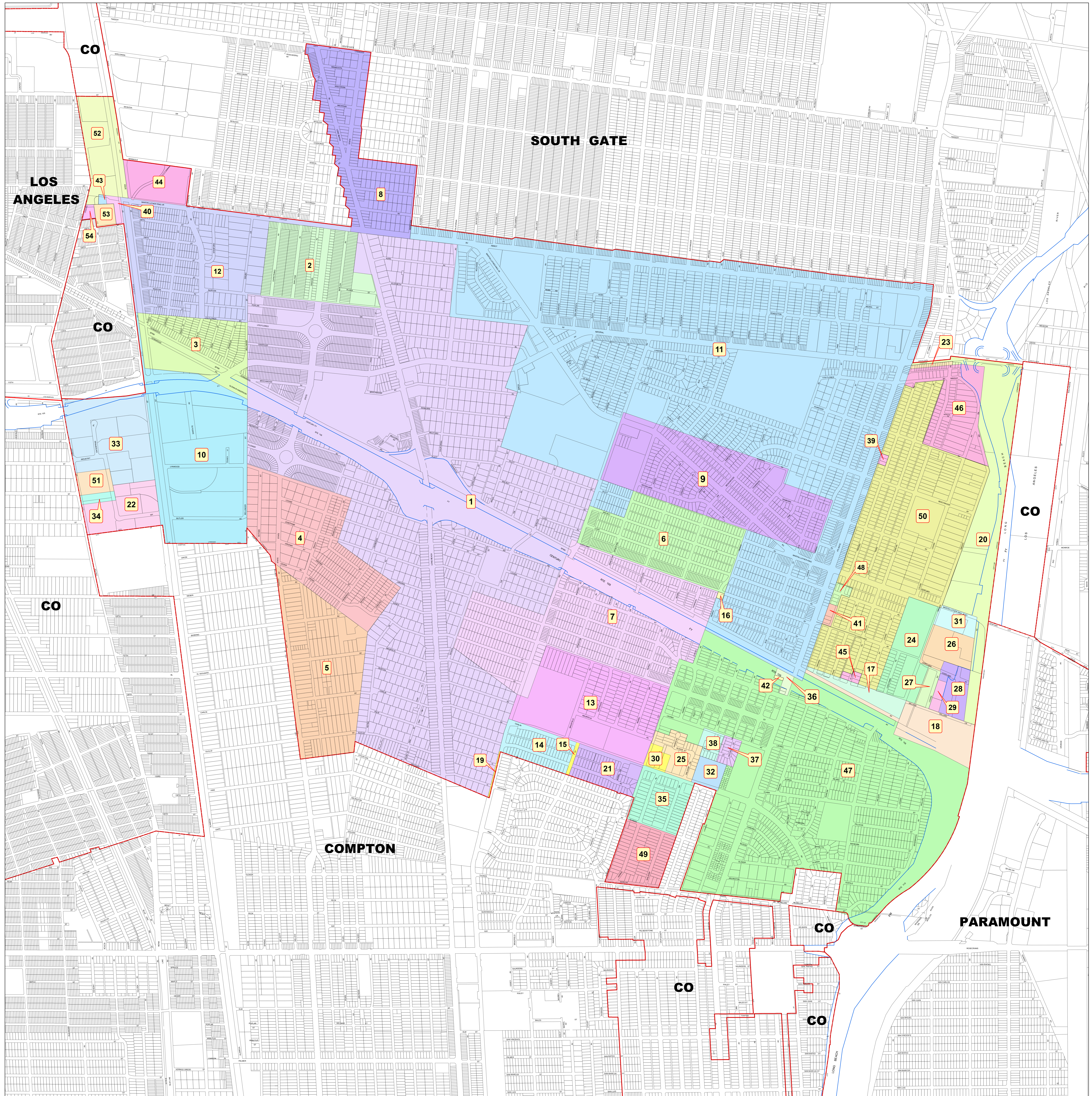

LEGEND:
 City Boundary

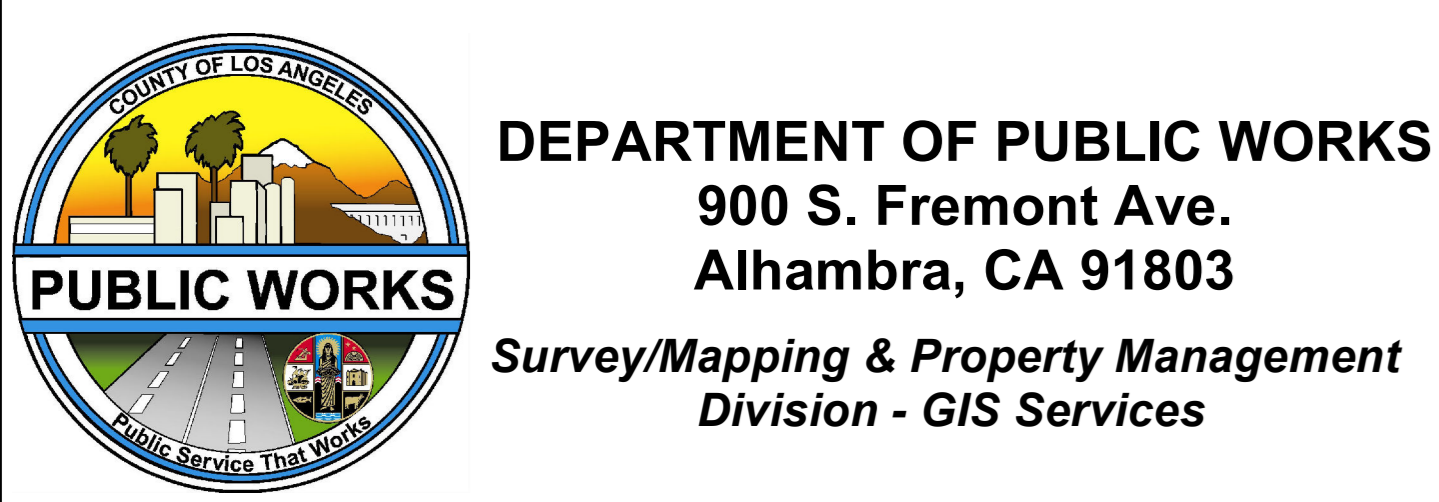
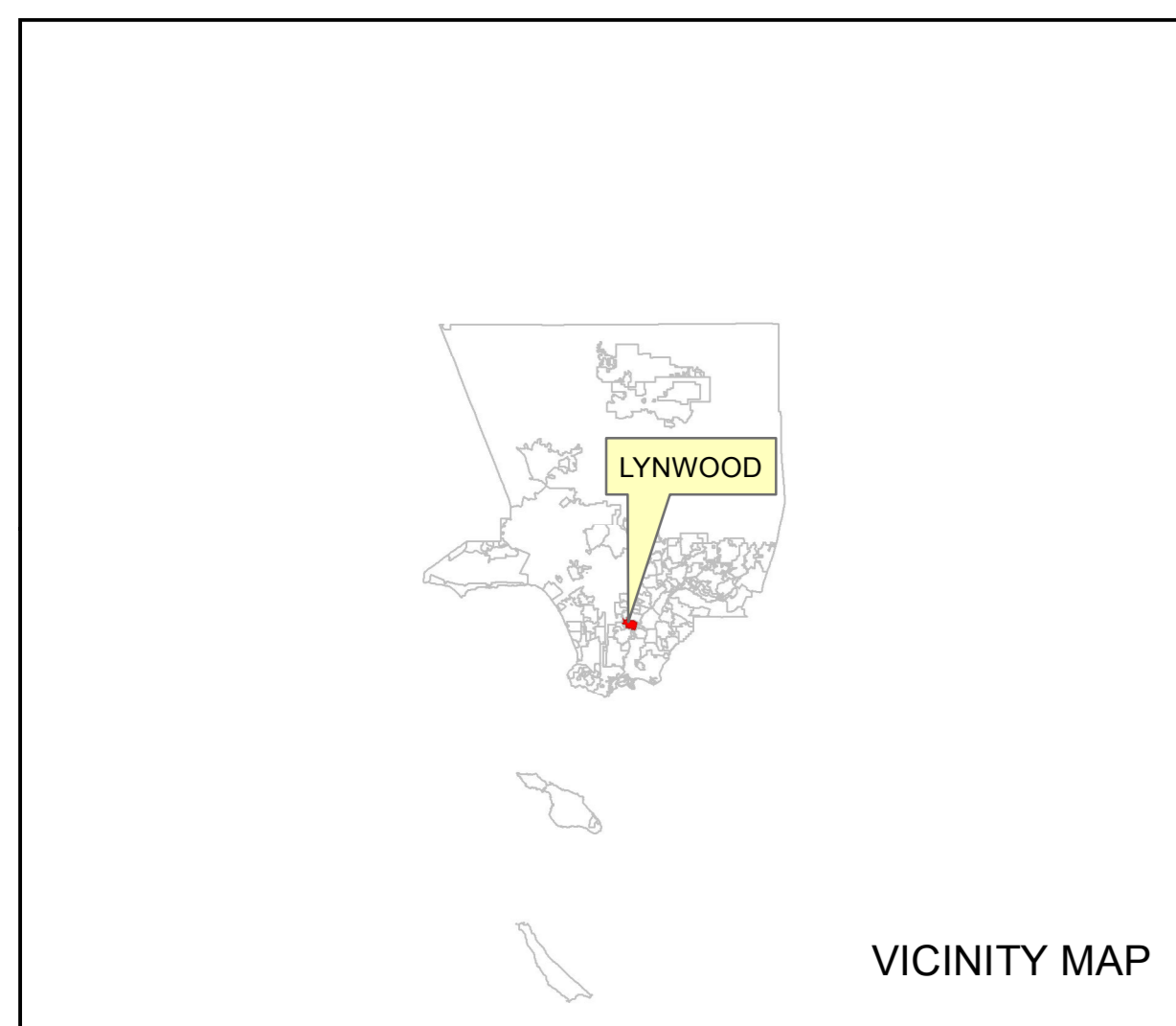
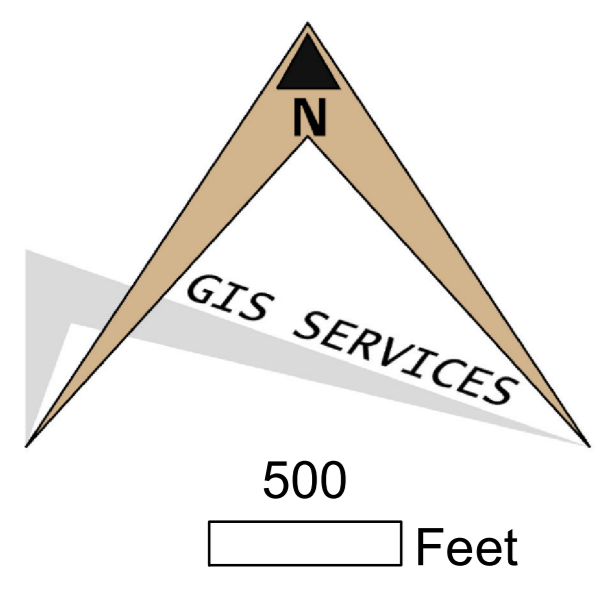

LOS ANGELES COUNTY EXPRESSLY DISCLAIMS ANY LIABILITY FOR INACCURACIES WHICH MAY BE PRESENT IN THIS MAP.
 Data contained in this map is produced in whole or part from the Los Angeles County Department of Public Works' digital database.